

SCALE IN FEET

RESTORATION OF WORK AREA. RESTORATION OF THE TRAFFIC SIGNAL WORK AREA SHALL BE INCLUDED IN THE COST OF THE RELATED PAY ITEM SUCH AS FOUNDATION, CONDUIT, HANDHOLE, TRENCH AND BACKFILL, ETC., AND NO EXTRA COMPENSATION SHALL BE ALLOWED. ALL ROADWAY SURFACES SUCH AS SHOULDERS, MEDIANS, SIDEWALKS, PAVEMENT, ETC. SHALL BE REPLACED IN KIND. ALL DAMAGE TO MOWED LAWNS SHALL BE REPLACED WITH AN APPROVED SOD, AND ALL DAMAGE TO UNMOWED FIELDS SHALL BE SEED IN ACCORDANCE WITH STANDARD SPECIFICATIONS 252 AND 250 RESPECTIVELY.

SIGN (A)

LEFT ON GREEN ARROW ONLY

R10-5  
24"x30"  
4-REQUIRED  
KDOT TO FURNISH AND INSTALL THESE SIGNS

DATE	
BY	
NO.	
NO.	
NO.	
NO.	
NO.	
NO.	
NO.	

DATE	
BY	
NO.	
NO.	
NO.	
NO.	
NO.	
NO.	
NO.	

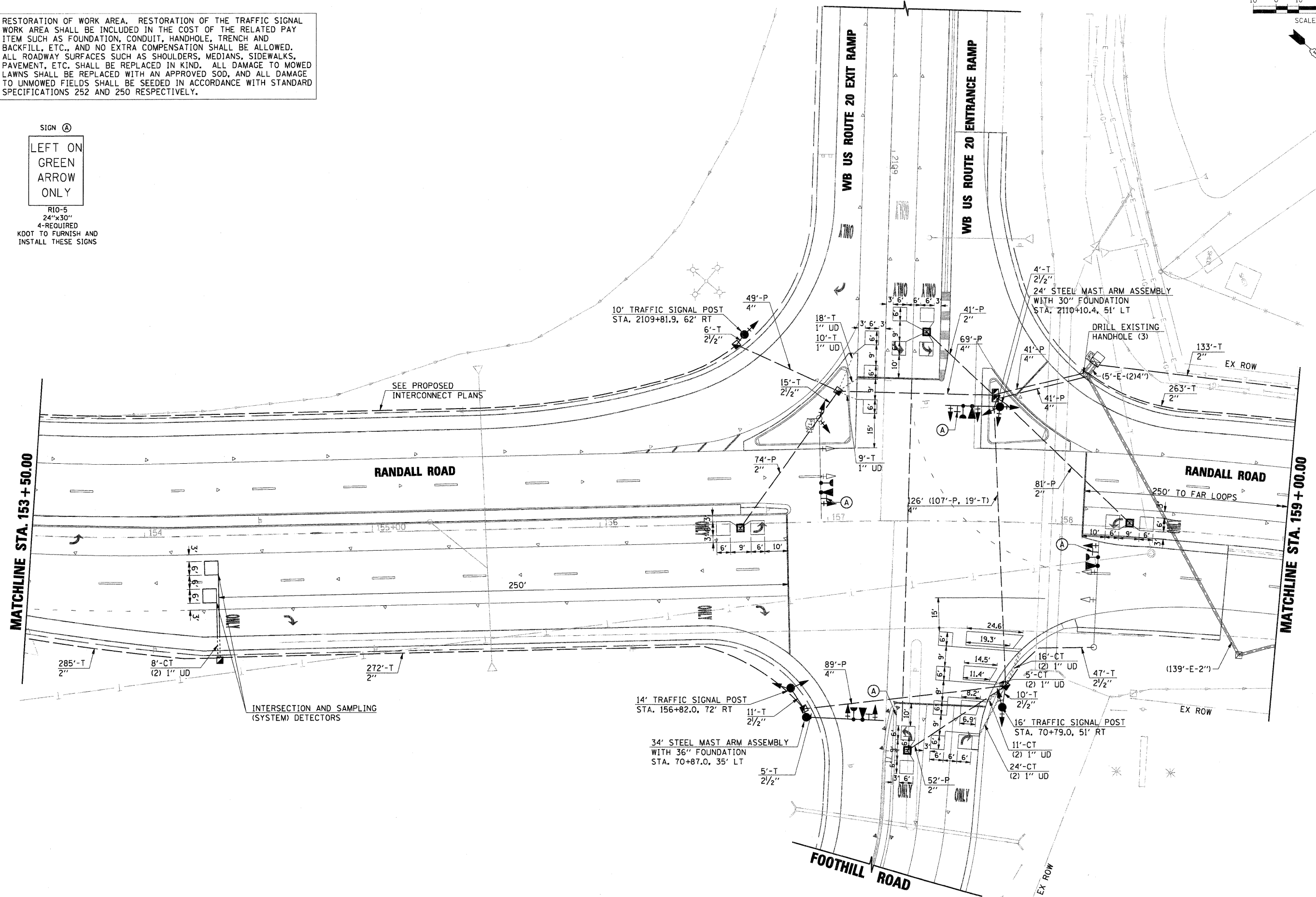

FILE NAME = D1157287-SHT-TS06-PLAN.DGN	USER NAME = melopez	DESIGNED - BH	REVISED -	STATE OF ILLINOIS DEPARTMENT OF TRANSPORTATION	PROPOSED TRAFFIC SIGNAL INSTALLATION PLAN RANDALL RD AT US RTE 20 WB OFF RAMP (FOOTHILL RD)	F.A.P. RTE. 336	SECTION 06-00345-00-CH	COUNTY KANE	TOTAL SHEETS 92	SHEET NO. 36
	PLOT SCALE = *SCALE*	CHECKED - DWW	REVISED -			SCALE:	SHEET NO. OF SHEETS	STA. TO STA.	FED. ROAD DIST. NO. 1	ILLINOIS FED. AID PROJECT
PLOT DATE = 11/29/2011	DATE = 05-09-2011	REVISIONS	REVISIONS							