

FINAL SURVEY	DATE
SURVEYED	BY
PLANS	
TEMPLATE	
NOTE BOOK	
AREAS CHECKED	
NO.	

ORIGINAL SURVEY	DATE
SURVEYED	BY
PLANS	
TEMPLATE	
NOTE BOOK	
AREAS CHECKED	
NO.	

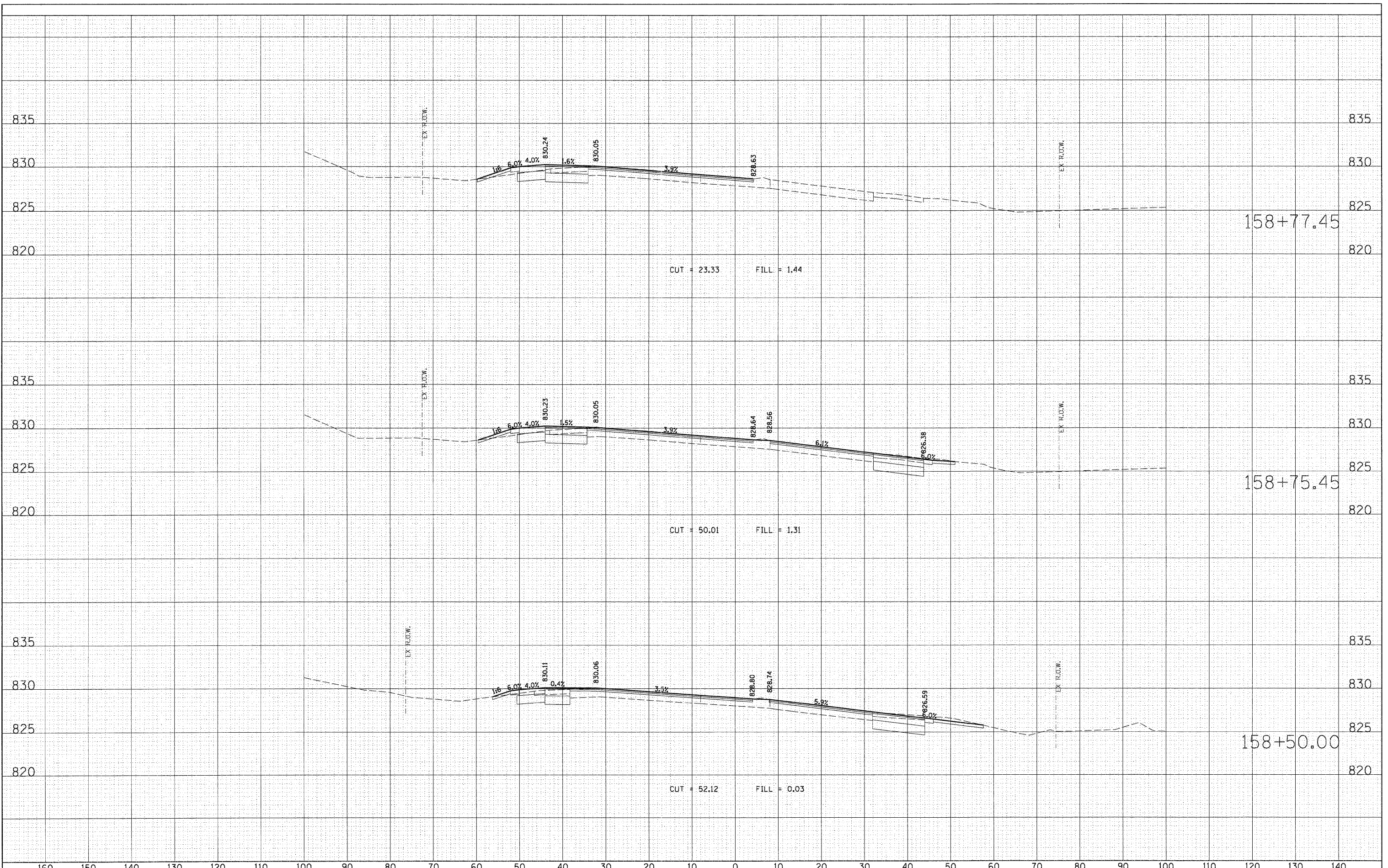

FILE NAME = D:\157207.SHT_XS.RANDALL.DGN	USER NAME = malopez	DESIGNED -	REVISED -	STATE OF ILLINOIS DEPARTMENT OF TRANSPORTATION	RANDALL ROAD AT US ROUTE 20 (FOOTHILL ROAD) CROSS SECTION SHEET - RANDALL ROAD			F.A.P. RTE. 336	SECTION 06-00345-00-CH	COUNTY KANE	TOTAL SHEETS 92	SHEET NO. 67
PLOT SCALE = #SCALE#	CHECKED -	REVISED -	REVISED -		SCALE: 1" = 10'	SHEET NO. OF SHEETS	STA. 158+50.00 TO STA. 158+77.45	CONTRACT NO. 63623				
PLOT DATE = 10/24/2011	DATE -	REVISED -	REVISED -		FED. ROAD DIST. NO. 1 ILLINOIS FED. AID PROJECT							