

F.A.S. RTE.	SECTION	COUNTY	TOTAL SHEETS	SHEET NO.
1190	(125BY)BR,(125-B)BR	KNOX		
	STA. 153+50	TO STA. 159+00		
FED. AID PROJECT		ILLINOIS	CONTRACT NO. 68087	

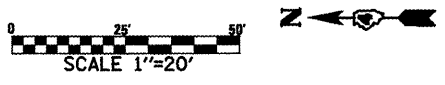

DATE	BY	REVIEWED	DATE
PLAN	DATE	BY	REVIEWED

DATE	BY	REVIEWED	DATE
PROFILE	DATE	BY	REVIEWED

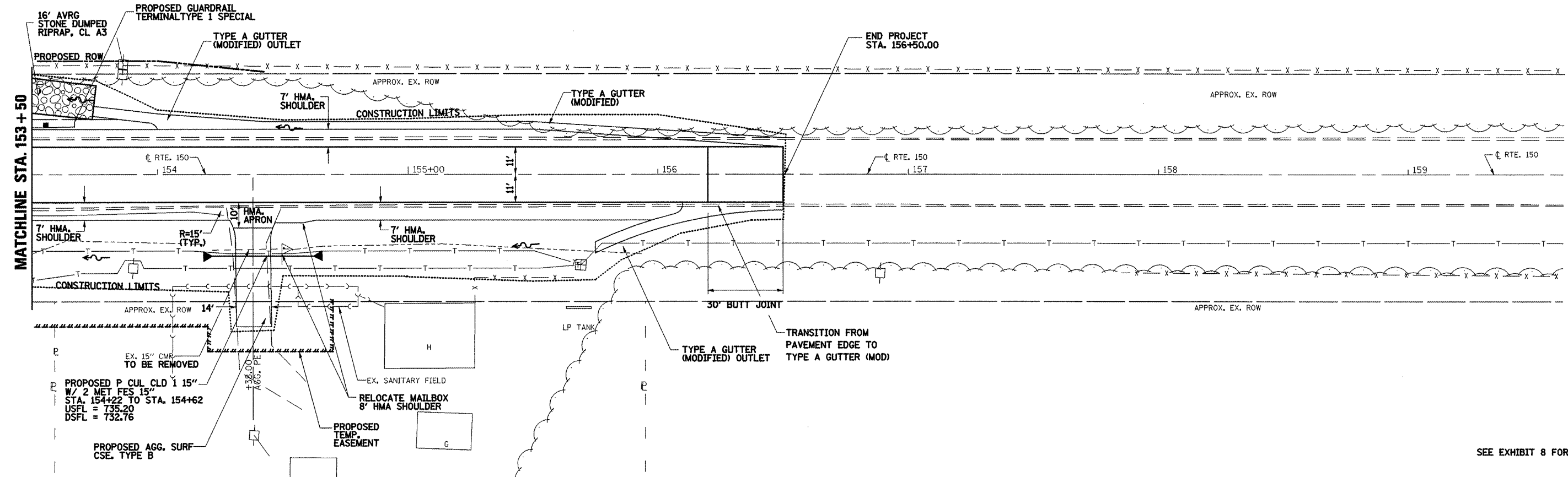

SEE EXHIBIT 8 FOR R.O.W.

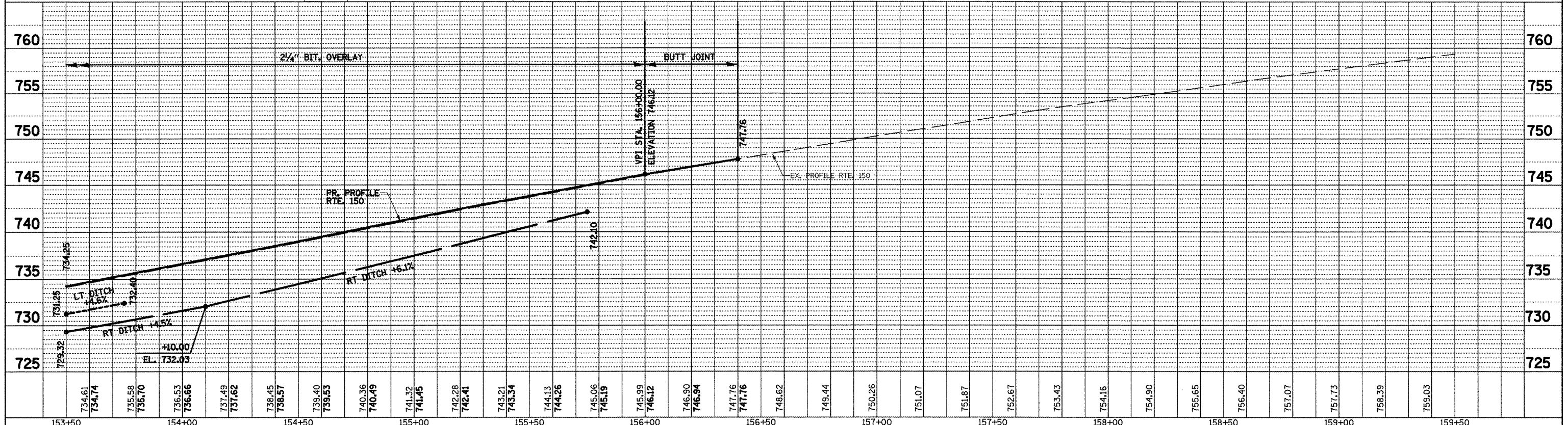

FILE NAME = mikesht@l.dgn	USER NAME = lebebidsm	DESIGNED -	REVISED -	<b>STATE OF ILLINOIS</b> <b>DEPARTMENT OF TRANSPORTATION</b>	<b>PLAN AND PROFILE</b>	F.A.S. RTE. 1190	SECTION (125BY)BR	COUNTY KNOX	TOTAL SHEETS 94	SHEET NO. 22
	PLOT SCALE = 42,353' / in.	CHECKED -	REVISED -			STA 153+50 TO STA 159	CONTRACT NO. 68087			
	PLOT DATE = 10/17/2011	DATE -	REVISED -			ILLINOIS FED. AID PROJECT				
						SCALE:	SHEET NO. 3 OF 3 SHEETS	STA. 153+50 TO STA. 156+50		