

F.A.I. RTE.	SECTION	COUNTY	TOTAL SHEETS	SHEET NO.
90/94	2003-0311	COOK	976	242
STA. 1506+50.00		TO STA. 1518+00.00		
FED. ROAD DIST. NO. 1		ILLINOIS FED. AID PROJECT		

62583

**NOTES:**

1. SEE DRAWINGS ME-01 AND ME-02 FOR ELECTRICAL SYMBOLS AND ABBREVIATIONS.
2. SEE DRAWINGS ES-05 AND ES-06 FOR HIGH MAST LIGHT TOWER SCHEDULE.

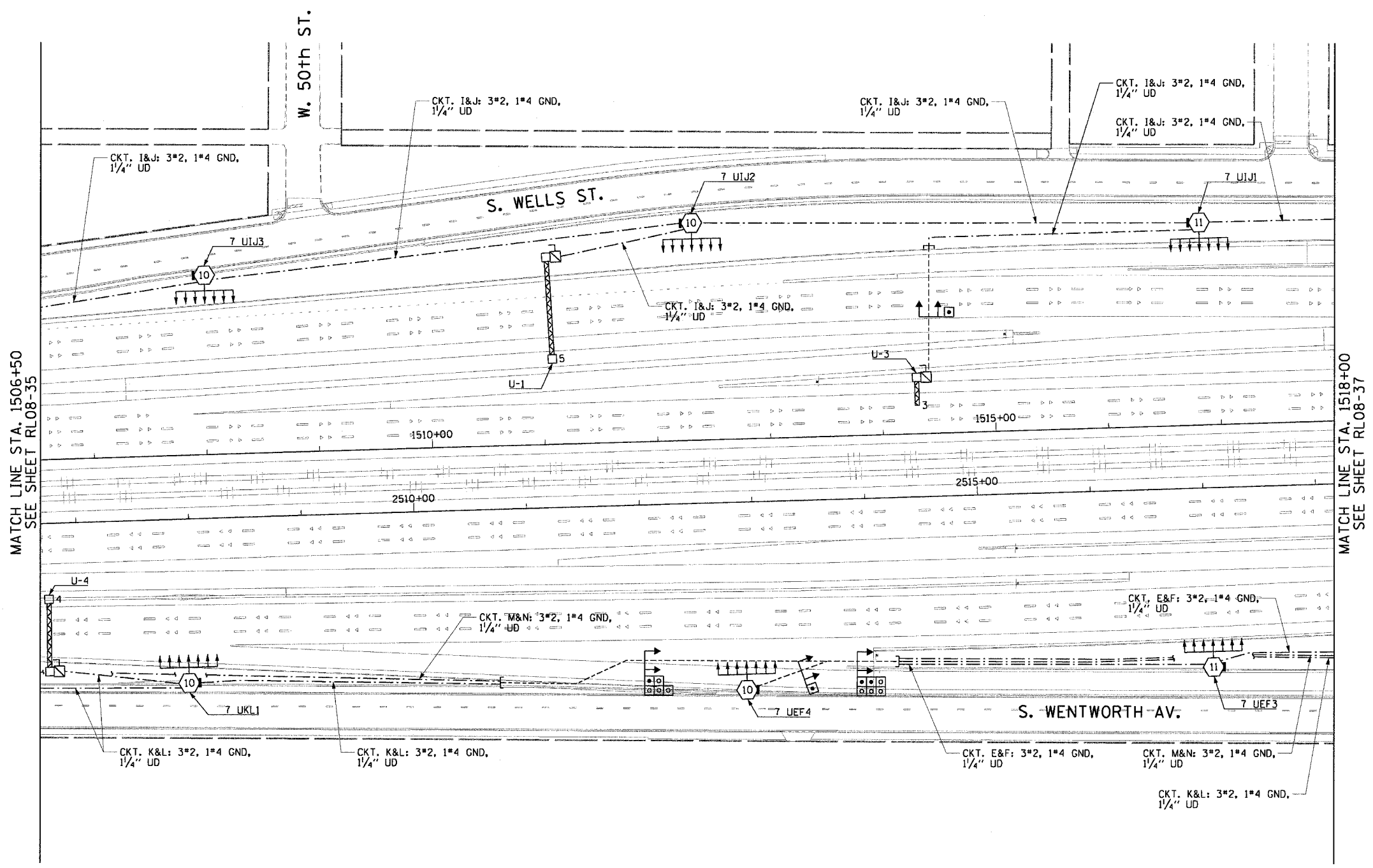

MATCH LINE STA. 1506+50  
SEE SHEET RL08-35

MATCH LINE STA. 1518+00  
SEE SHEET RL08-37

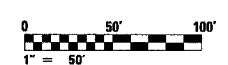

RL08-36

REVISIONS	
NAME	DATE

ILLINOIS DEPARTMENT OF TRANSPORTATION  
F.A.I. 90/94 (DAN RYAN EXPRESSWAY)  
31st STREET TO I-57  
  
ROADWAY LIGHTING PLANS  
FINAL CONDITIONS

SCALE: 1"=50'  
DATE: October 29, 2004  
DRAWN BY: CJM  
CHECKED BY: WDS

**CTE ENGINEERS**  
CONSIDER TOWNSEND ENVIRONMENTAL ENGINEERS, INC.  
303 EAST WACKER DRIVE, SUITE 600  
CHICAGO, ILLINOIS 60601-5226, PHONE: (312) 938-0300

17/19/2004 0405:23 PM