

PROF. FILE
 REVIEWED
 GRADES CHECKED
 B.M. NOTED
 STRUCTURE NOTATIONS OK'D

| F.A.I. RTE. | SECTION | COUNTY | TOTAL SHEETS | SHEET NO. |
|---------------------|-----------|---------------------------|--------------|-----------|
| 90/94 | 2003-0311 | COOK | 976 | 512 |
| STA. 2200+00.00 | | TO STA. 2362+00.00 | | |
| FED. ROAD DIST. NO. | | ILLINOIS FED. AID PROJECT | | 62583 |

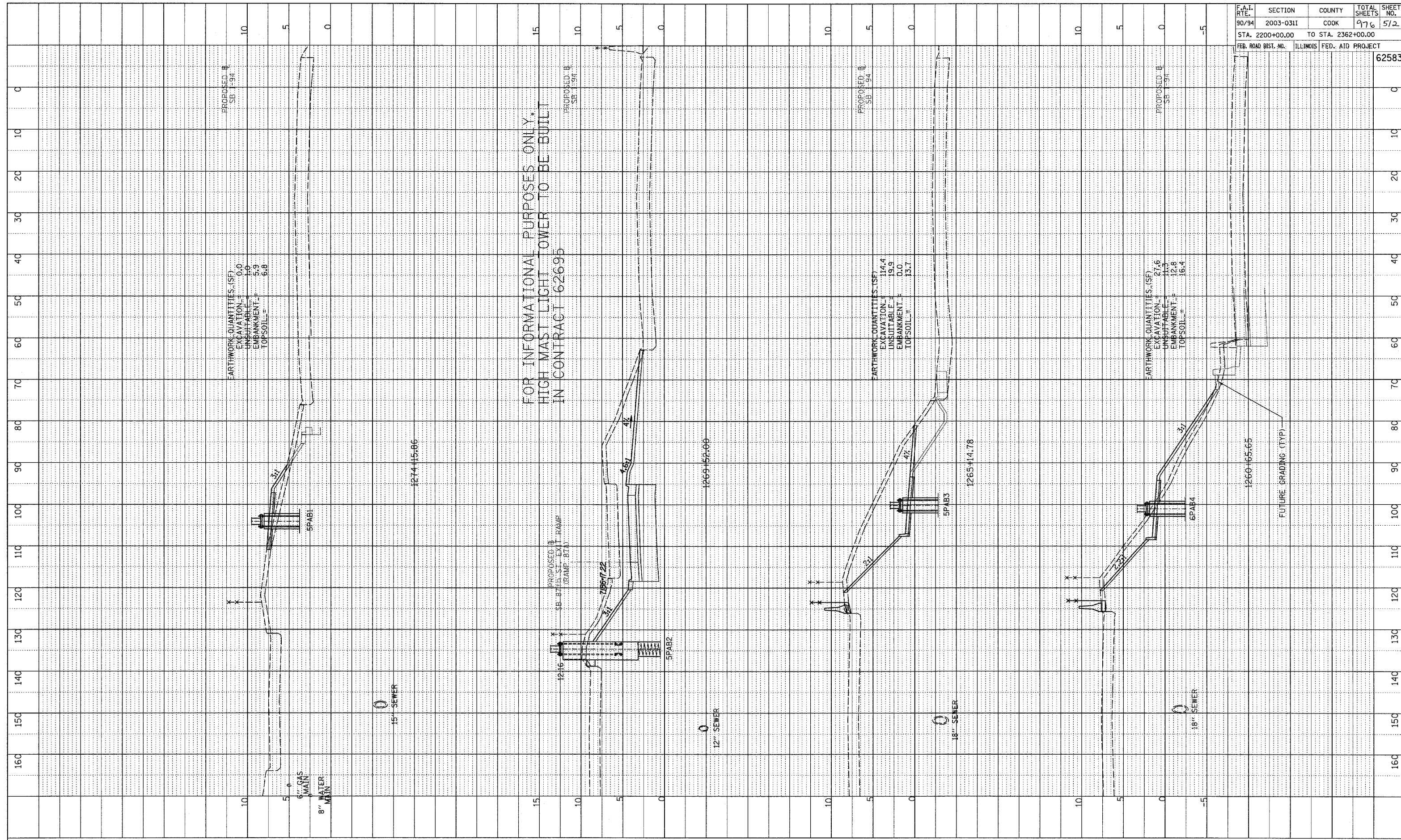

TYLIN INTERNATIONAL

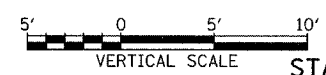
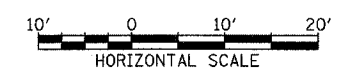

SB I-94 (DAN RYAN EXPRESSWAY)
 STA. 1260+65.65 TO STA. 1274+15.86