

PROF. ILL. SURVEYED
 CHECKED
 BROOKS
 NO. 1
 NOTE BOOK
 B.M. NOTED
 STRUCTURE NOTATIONS
 CIPFD

F.A.I. RTE.	SECTION	COUNTY	TOTAL SHEETS	SHEET NO.
90/94	2003-0311	COOK	976	526
STA. 2200+00.00 TO STA. 2362+00.00		62583		
FED. ROAD DIST. NO.		ILLINOIS	FED. AID PROJECT	

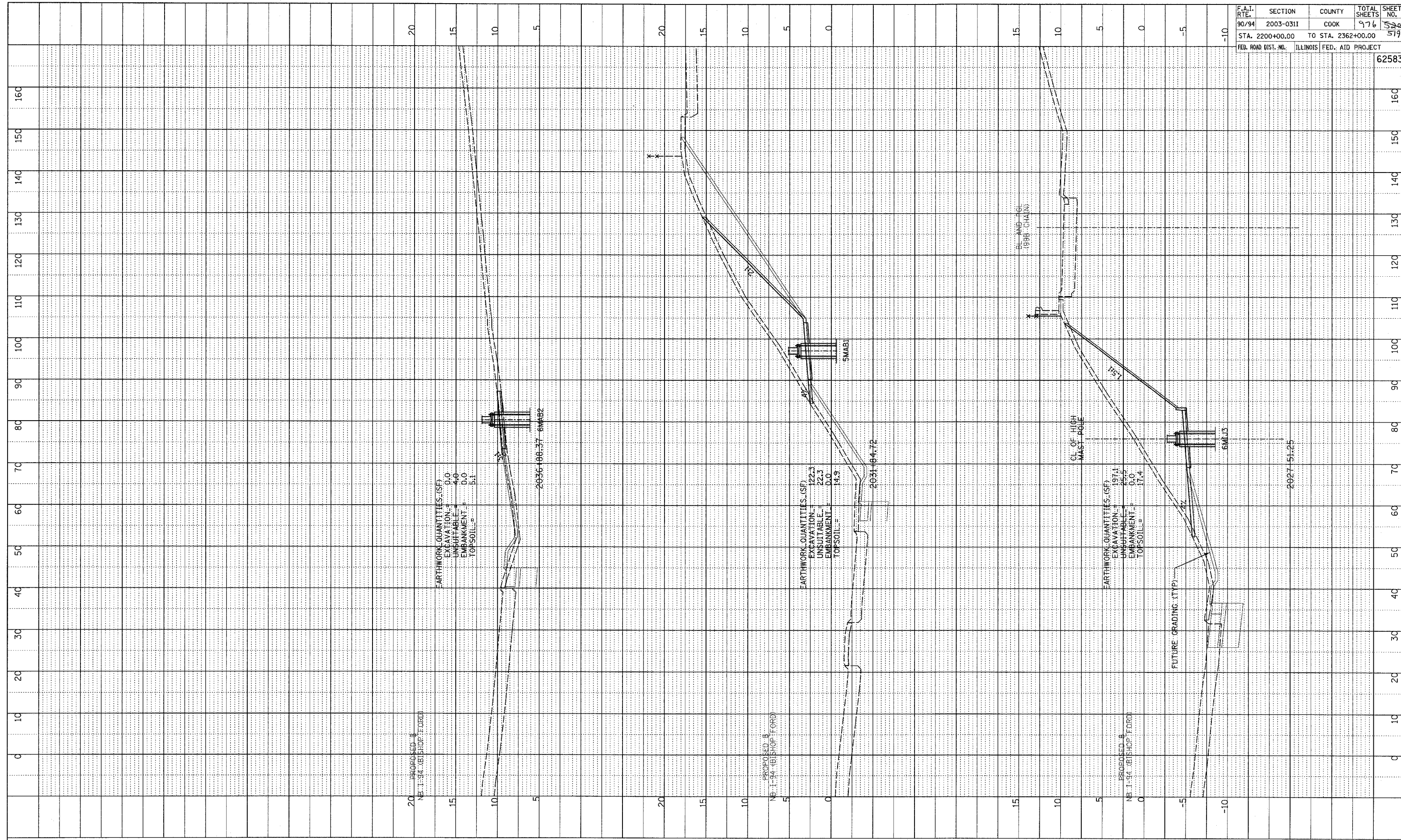

TYLIN INTERNATIONAL

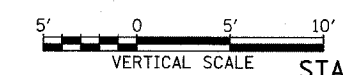
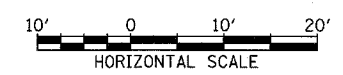

NB I-94 (BISHOP FORD FREEWAY)
 STA. 2027+51.25 TO STA. 2036+88.37

P:\0231\3\road\02\94\K02\ssm\ford_f.dgn