

SECTION	COUNTY	TOTAL SHEETS	SHEET NO.
2003-0311	COOK	976	699
STA. 1560+00 TO STA. 1572+00		ILLINOIS FED. AID PROJECT	
62583			

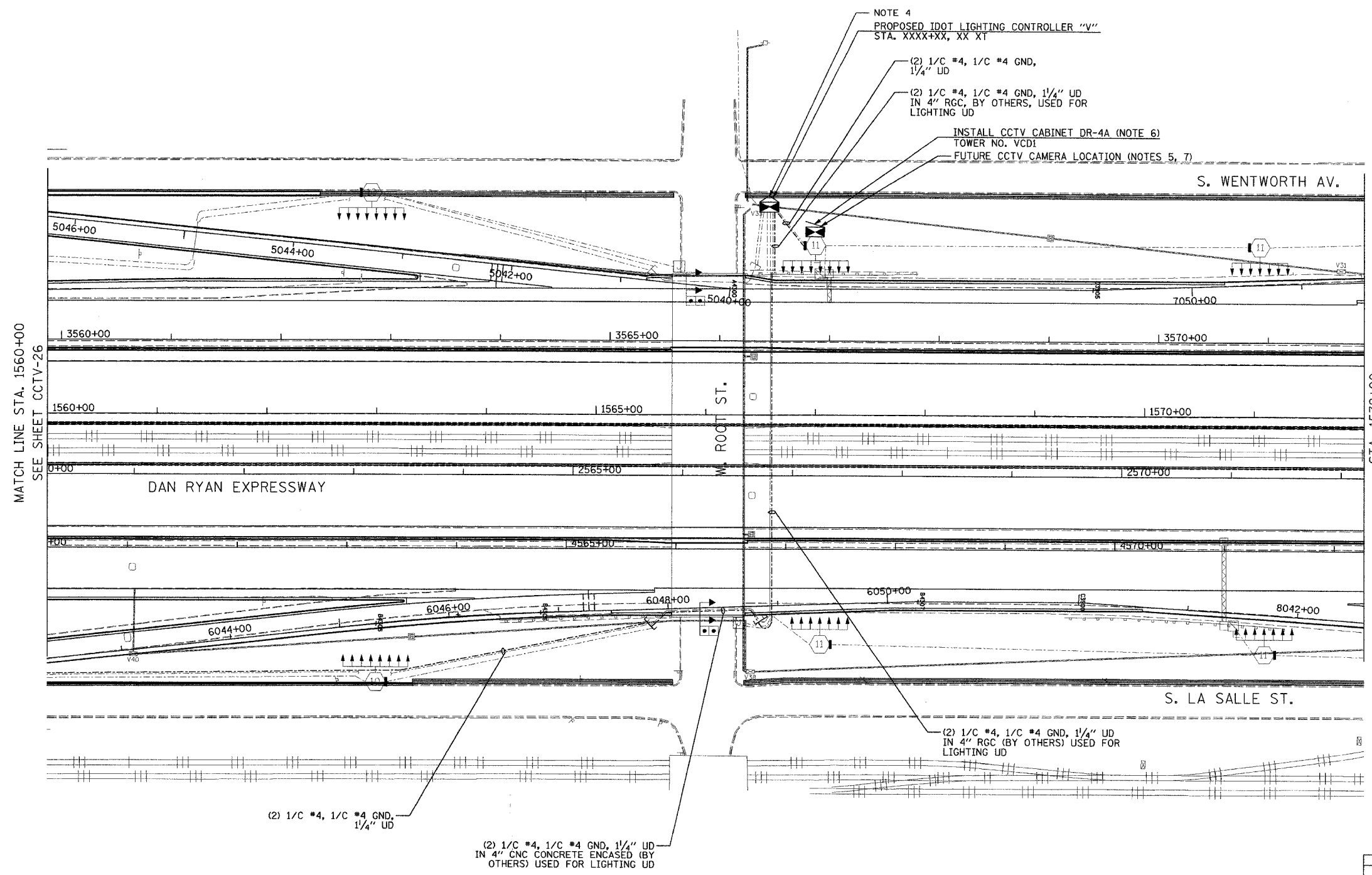

- NOTES:**
- SEE DRAWINGS ME-01 AND ME-02 FOR ELECTRICAL SYMBOLS AND ABBREVIATIONS.
 - UNLESS OTHERWISE STATED, ALL NOTED CABLE AND CONDUIT TO BE FURNISHED AND INSTALLED UNDER THIS CONTRACT.
 - THIS SHEET ONLY DEPICTS INSTALLATION OF CLOSED CIRCUIT TELEVISION ELEMENTS. SEE LIGHTING PLANS FOR LIGHTING ELEMENT INSTALLATION.
 - CONTRACTOR SHALL CONNECT CAMERA POWER FEED TO THE AUXILIARY BREAKER IN THE LIGHTING CONTROLLER CABINET AS SHOWN ON DRAWING ME-19.
 - SEE DRAWING COMM-41 FOR CCTV COMMUNICATIONS SYSTEM CONDUIT AND CABLE LAYOUT.
 - SEE DRAWING DT-17 FOR CCTV CABINET MOUNTING DETAILS ON A HIGH-MAST LIGHT TOWER.
 - CONTRACTOR SHALL COIL A MINIMUM OF 20 FEET OF 120-VOLT POWER CABLE AT THE BASE OF THE LIGHT TOWER FOR FUTURE CCTV CAMERA.

MATCH LINE STA. 1560+00
SEE SHEET CCTV-26

STA. 1572+00

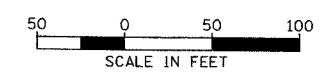

CCTV-27

Edwards AND Kelcey
 ONE NORTH FRANKLIN
 CHICAGO, IL 60606
 PHONE: (312) 251-3000
 FAX: (312) 251-3015
 WEB: WWW.EKCORP.COM

REVISIONS		ILLINOIS DEPARTMENT OF TRANSPORTATION F.A.I. 94/90 (DAN RYAN EXPRESSWAY) 31st STREET to I-57 CLOSED CIRCUIT TELEVISION SITE LAYOUT CAMERA DR-4C (SHEET 3 OF 3) CAMERA DR-4A, DR-4B (SHEET 2 OF 2)
NAME	DATE	
		SCALE: 1"=50'
		DATE: October 29, 2004
		DRAWN BY: DHI
		CHECKED BY: MJL

10/14/2004 09:23:34 AM