

SECTION	COUNTY	TOTAL SHEETS	SHEET NO.
2003-0311	COOK	976	741
STA. 1416+00	TO STA. 1426+00		
FED. ROAD DIST. NO.	ILLINOIS	FED. AID PROJECT	
62583			

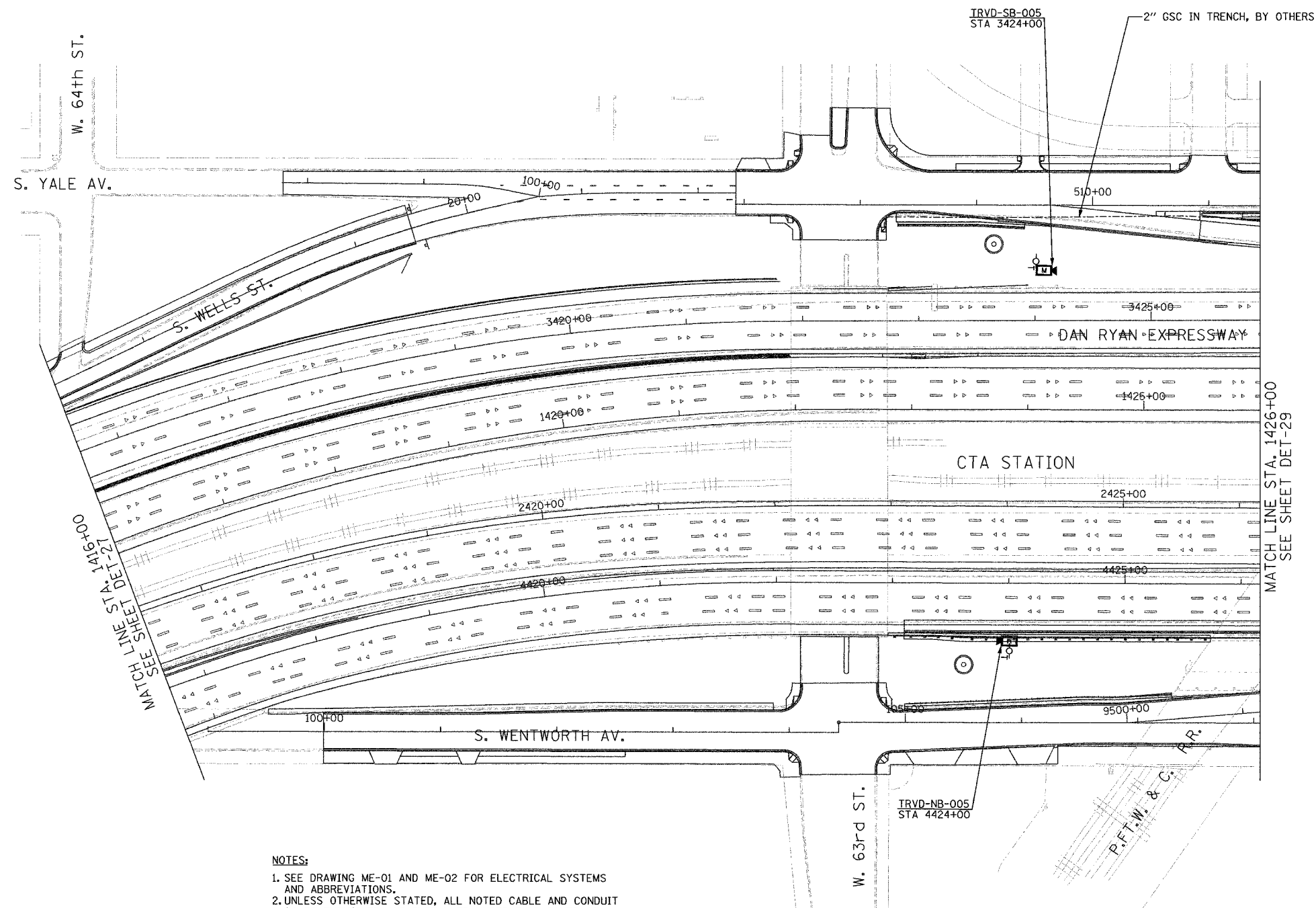

NOTES:

1. SEE DRAWING ME-01 AND ME-02 FOR ELECTRICAL SYSTEMS AND ABBREVIATIONS.
2. UNLESS OTHERWISE STATED, ALL NOTED CABLE AND CONDUIT TO BE FURNISHED AND INSTALLED UNDER THIS CONTRACT.
3. TRENCHED CONDUITS INSTALLED IN PARALLEL ARE TO BE INSTALLED IN COMMON TRENCH.
4. THIS SHEET ONLY DEPICTS INSTALLATION OF DETECTION/RAMP METER ELEMENTS. REFER TO SHEETS FOR OTHER SUBSYSTEMS FOR ADDITIONAL ELEMENTS IN THE AREA SHOWN.
5. CONTRACTOR TO ROD AND CLEAN EXISTING CONDUITS PRIOR TO INSTALLING AND PULLING INNERDUCTS AND CABLES IN CONDUITS.
6. DETECTION/RAMP METER CONDUIT SHALL NOT BE INSTALLED IN ELECTRIC HANDHOLES (SEE DETAIL SHEET DT-45).
7. FOR HANDHOLE DETAILS, SEE SHEET DT-44 AND DT-46.
8. FOR WIRING DETAILS, SEE SHEETS DET-48 THROUGH DET-53.
9. FOR TEMPORARY DETECTION DETAILS SEE SHEETS DT-53 TO DT-55.



SCALE IN FEET DET-28

**Edwards
AND Kelcey**
ONE NORTH FRANKLIN
CHICAGO, IL 60606
PHONE: (312) 251-3000
FAX: (312) 251-3015
WEB: WWW.EKCORP.COM

REVISIONS		ILLINOIS DEPARTMENT OF TRANSPORTATION F.A.I. 94/90 (DAN RYAN EXPRESSWAY) 31st STREET TO I-57 SURVEILLANCE SYSTEM STATION DETECTOR SYSTEM 63RD ST. SITE LAYOUT DET-32
NAME	DATE	

SCALE: 1"=50'
DATE: October 29, 2004
DRAWN BY: CJH
CHECKED BY: MJL

P:\030019\035\16\cadd\102028\28-rft 11/23/2004 10:23:37 AM