

F.A.I. RTE.	SECTION	COUNTY	TOTAL SHEETS	SHEET NO.
90/94	2021-922PT.1-AC	COOK	460	41
STA. 113+00	TO STA. 118+00			
FED. ROAD DIST. NO. 1	ILLINOIS	FED. AID PROJECT		

62693

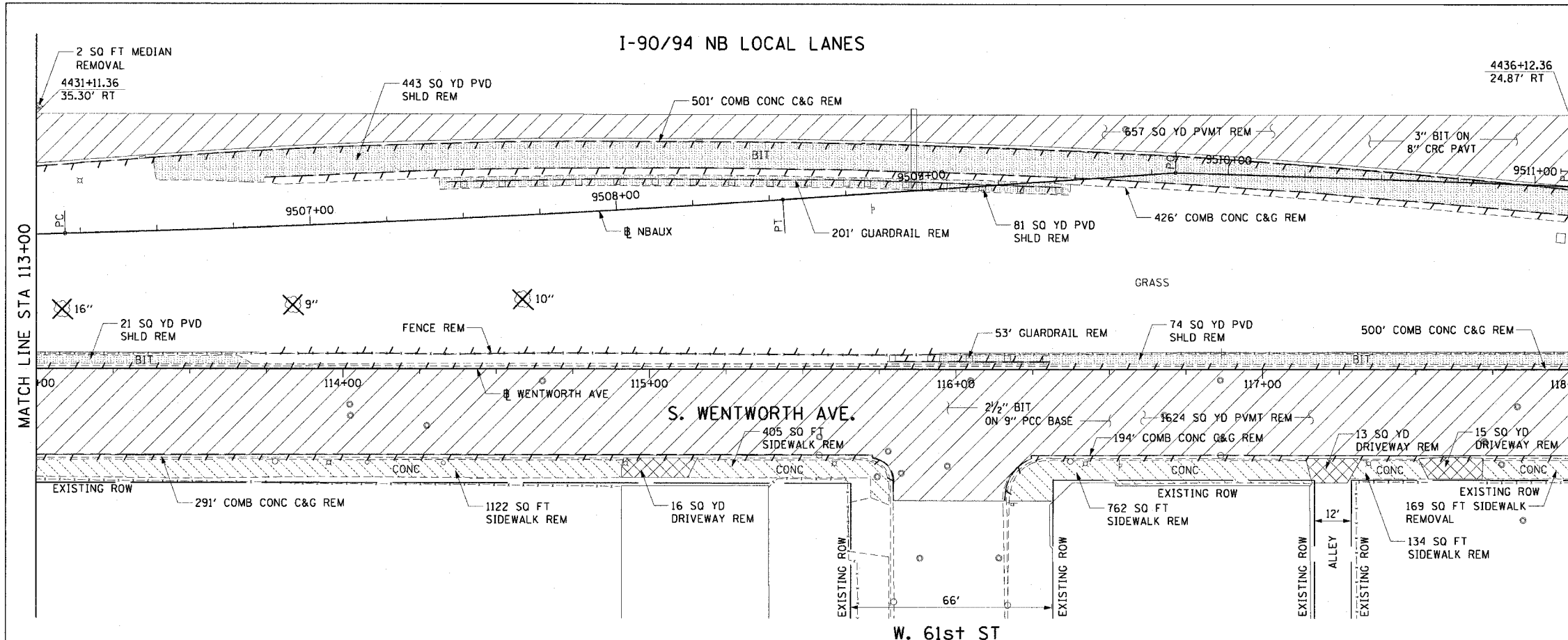

- LEGEND:**
- PAVEMENT REMOVAL
  - MEDIAN REMOVAL
  - LINEAR REMOVALS
  - SIDEWALK REMOVAL
  - APPROACH SLAB REMOVAL
  - DRIVEWAY PAVEMENT REMOVAL
  - PAVED SHOULDER REMOVAL
  - TREE REMOVAL (BY OTHERS)
- NOTES:**
- SEE CONTRACT 62583 FOR REMOVAL OF EXISTING ROADWAY LIGHTING AND ITS EQUIPMENT.
  - SEE STRUCTURAL SHEETS FOR RETAINING WALL REMOVALS AND IMPROVEMENTS.
  - SEE DRAINAGE AND UTILITY SHEETS FOR REMOVALS AND IMPROVEMENTS.
  - FOUNDATIONS FOR ROADWAY LIGHTING AND ITS EQUIPMENT ARE REMOVED IN CONTRACT 62693. SEE ELECTRICAL EXISTING CONDITIONS AND DEMOLITION PLANS.
  - SEE SIGNING SHEETS FOR MAINLINE REMOVAL AND IMPROVEMENTS.
  - ALL EXISTING DRIVEWAYS SHOWN ARE CONCRETE UNLESS NOTED OTHERWISE.

**EXISTING CONDITIONS AND REMOVAL**

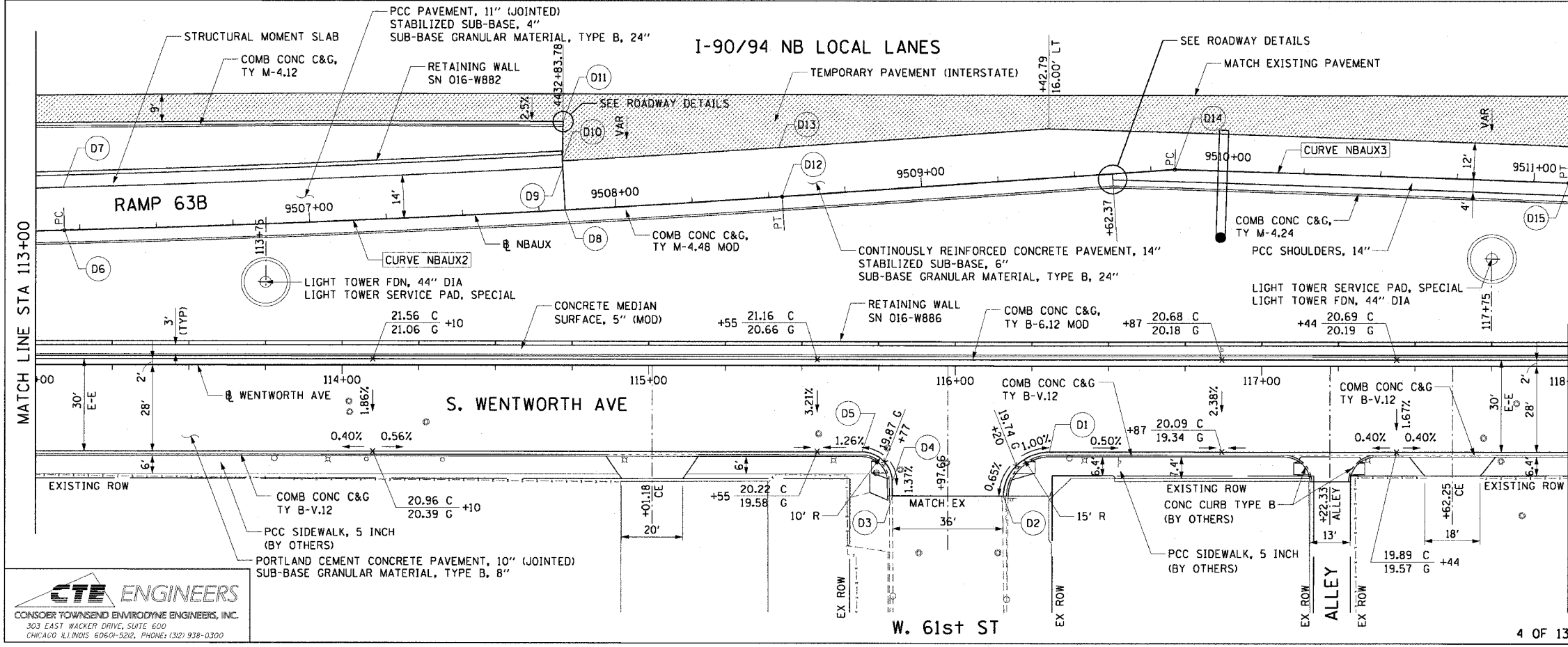

- LEGEND:**
- TEMPORARY PAVEMENT (INTERSTATE)
- NOTES:**
- STATIONS AND OFFSETS FOR TEMPORARY PAVEMENT AND RAMP 63B ARE FROM NBAUX BASELINE.
  - SEE ALIGNMENT PLANS FOR CURVE DATA.
  - SEE PAVEMENT JOINT AND ELEVATION PLANS FOR RAMP GRADING.
  - SEE STRUCTURAL SHEETS FOR MOMENT SLAB DETAILS.
  - SEE ELECTRICAL INFRASTRUCTURE SHEETS FOR IMPROVEMENTS.
  - PROPOSED PCC ALLEY AND DRIVEWAY PAVEMENT, 8 INCH WORK TO BE PERFORMED BY OTHERS.

PT.	STATION	OFFSET	LOC	PT.	STATION	OFFSET	LOC
D1	116+30.77	28.00' RT	EOP	D9	9507+83.45	14.00' LT	EOP
D2	116+15.77	42.86' RT	EOP	D10	9507+83.45	16.00' LT	EOP
D3	115+79.55	42.86' RT	EOP	D11	9507+84.38	28.71' LT	EOP
D4	115+79.52	37.93' RT	EOP	D12	9508+54.39	0.00	EOP
D5	115+69.52	28.00' RT	EOP	D13	9508+54.39	16.00' LT	EOP
D6	9506+20.03	0.00	EOP	D14	9509+82.81	0.00	EOP
D7	9506+20.03	14.00' LT	EOP	D15	9511+11.27	0.00	EOP
D8	9507+83.45	0.00	EOP				

REVISIONS	
NAME	DATE

ILLINOIS DEPARTMENT OF TRANSPORTATION  
 F.A.I. 90/94 (DAN RYAN EXPRESSWAY)  
 63rd ST TO 59th ST (FRONTAGE ROAD & RAMPS)

**EXISTING AND PROPOSED ROADWAY PLANS  
 WENTWORTH AVENUE**

SCALE: 1"=20'  
 DATE: October 29, 2004  
 DRAWN BY: NJH  
 CHECKED BY: RMG

