

F.A.I. RTE.	SECTION	COUNTY	TOTAL SHEETS	SHEET NO.
90/94	2021-922PT.1-AC	COOK	460	107
STA.	TO STA.			
FED. ROAD DIST. NO. 1	ILLINOIS	FED. AID PROJECT		

62693

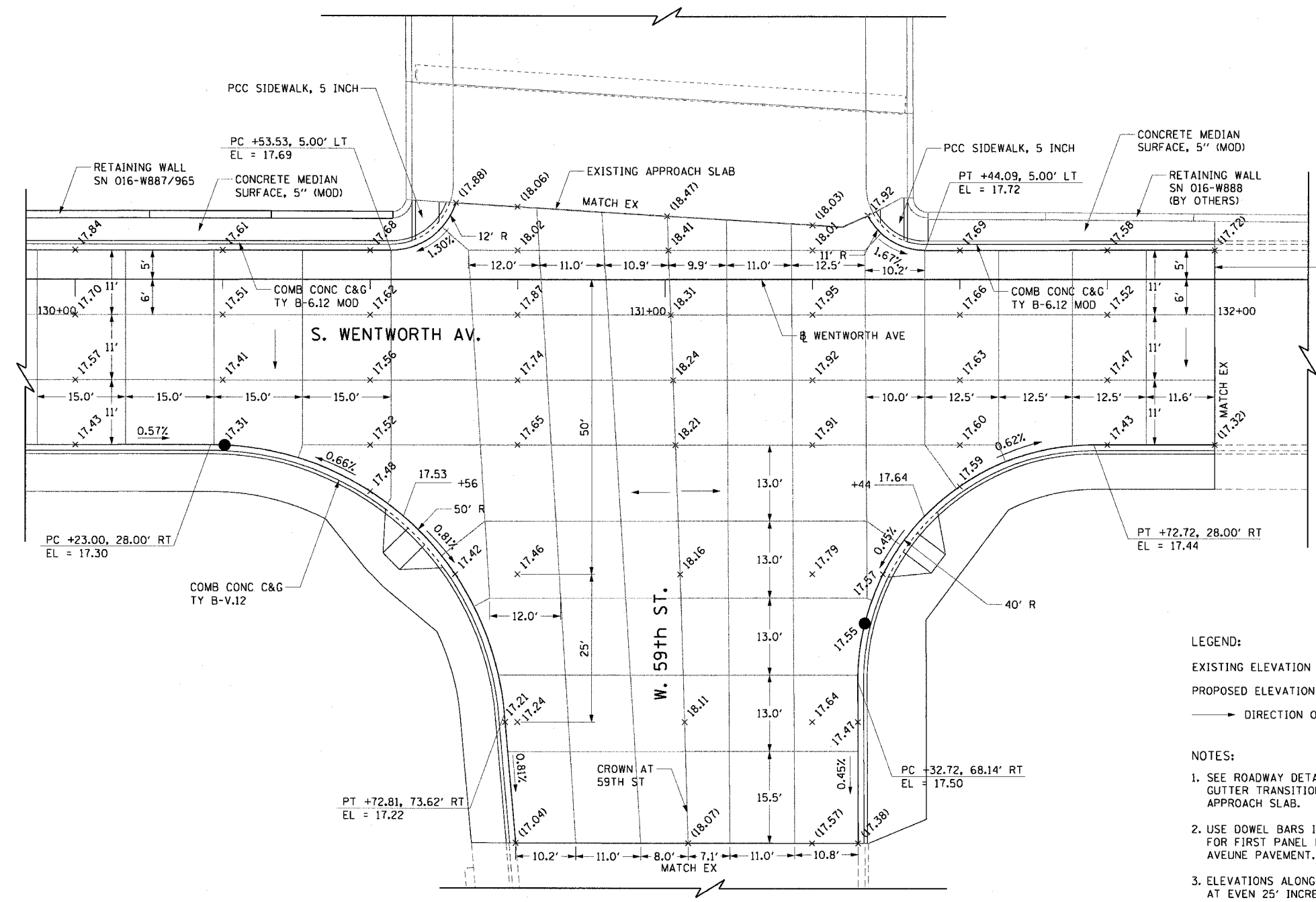

PROJECT LIMITS
STA. 131+93.21

LEGEND:
 EXISTING ELEVATION (XX.XX)
 PROPOSED ELEVATION XX.XX
 —> DIRECTION OF PAVEMENT SLOPE

NOTES:
 1. SEE ROADWAY DETAILS FOR CURB AND GUTTER TRANSITION DETAILS AT THE APPROACH SLAB.
 2. USE DOWEL BARS INSTEAD OF TIE BARS FOR FIRST PANEL NEXT TO WENTWORTH AVENUE PAVEMENT.
 3. ELEVATIONS ALONG BASELINE ARE LOCATED AT EVEN 25' INCREMENTS UNLESS NOTED.

REVISIONS	
NAME	DATE

ILLINOIS DEPARTMENT OF TRANSPORTATION
 F.A.I. 90/94 (DAN RYAN EXPRESSWAY)
 63rd ST TO 59th ST (FRONTAGE ROAD & RAMPS)

INTERSECTION DETAILS
 WENTWORTH AVENUE
 W. 59th STREET INTERSECTION

SCALE: 1"=10'
 DATE: October 29, 2004

DRAWN BY: NJH
 CHECKED BY: RMG



m:\p\0465\civil\7\17\17-c-r\94\94-01\94-01-107.dwg 10/25/2004 9:46:56 AM