

F.A.I. RTE.	SECTION	COUNTY	TOTAL SHEETS	SHEET NO.
90/94	2021-922PT.1-AC	COOK	460	180
STA. 1446+50.00		TO STA. 1458+50.00		
FED. ROAD DIST. NO. 1		ILLINOIS FED. AID PROJECT		

62693

NOTES:

- SEE DRAWINGS EI-100 AND EI-101 FOR ELECTRICAL SYMBOLS AND ABBREVIATIONS.
- SEE DRAWING ES-01 FOR HIGH MAST LIGHT TOWER FOUNDATION SCHEDULE.
- SEE DRAWINGS EI-102 AND EI-103 FOR ELECTRICAL DUCTBANK DETAILS.
- SEE DRAWING EI-117 FOR CONDUIT INSTALLATION DETAILS FOR LIGHTING CONTROLLER ELECTRIC SERVICE THROUGH RETAINING WALL.
- PVCC RGC CONDUIT MUST BE STUBBED UP ALONGSIDE THE LIGHTING CONTROLLER FOUNDATION TO FACILITATE FUTURE CONNECTION TO EXTERNAL ELECTRIC METER.
- SEE DRAWING EI-115 FOR CONDUIT INSTALLATION THROUGH RETAINING WALL.
- EXISTING CITY MANHOLE MUST BE DRILLED TO FACILITATE INSTALLATION OF 2" RGC CONDUIT AS SHOWN.
- RUN PARALLEL RACEWAYS IN COMMON TRENCH.
- RGC AND LIGHTING CONDUITS MUST BE INSTALLED IN THE TOP ROW OF THE DUCTBANK.
- DUCTBANKS INSTALLED AT THE LOCATIONS LISTED IN THE TABLE MUST BE INSTALLED AT THE SPECIFIED DEPTH TO AVOID CONFLICTS WITH FUTURE IDOT CONTRACTS 62301 AND 62303. DUCTBANK INSTALLED BETWEEN LOCATIONS LISTED IN THE TABLE MUST BE INSTALLED SUCH THAT ELEVATION TRANSITIONS BETWEEN THE DESIGNATED POINTS ARE SMOOTH AND GRADUAL. AT NO POINT ALONG THE RUN SHALL THE DUCTBANK BE INSTALLED ABOVE THE DEPTHS GIVEN ON DRAWING EI-102.
- COORDINATE ALL WORK WITH CIVIL WORK, STRUCTURAL WORK, SUGGESTED STAGES OF CONSTRUCTION AND TRAFFIC CONTROL PLANS, AND IDOT CONTRACT NOS. 62583, 62586 & 62839.
- CONTRACTOR MUST CORE DRILL THE EXISTING RETAINING WALL TO ACCOMMODATE FOR (2)-7" CONDUIT SLEEVES, REFER TO THE STRUCTURAL PLANS FOR THE EXISTING RETAINING WALL DETAILS.
- CONTRACTOR MUST NOT IMPACT THE EXISTING REINFORCEMENT BARS WHEN CORE DRILLING THROUGH THE EXISTING RETAINING WALL.

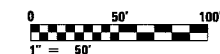
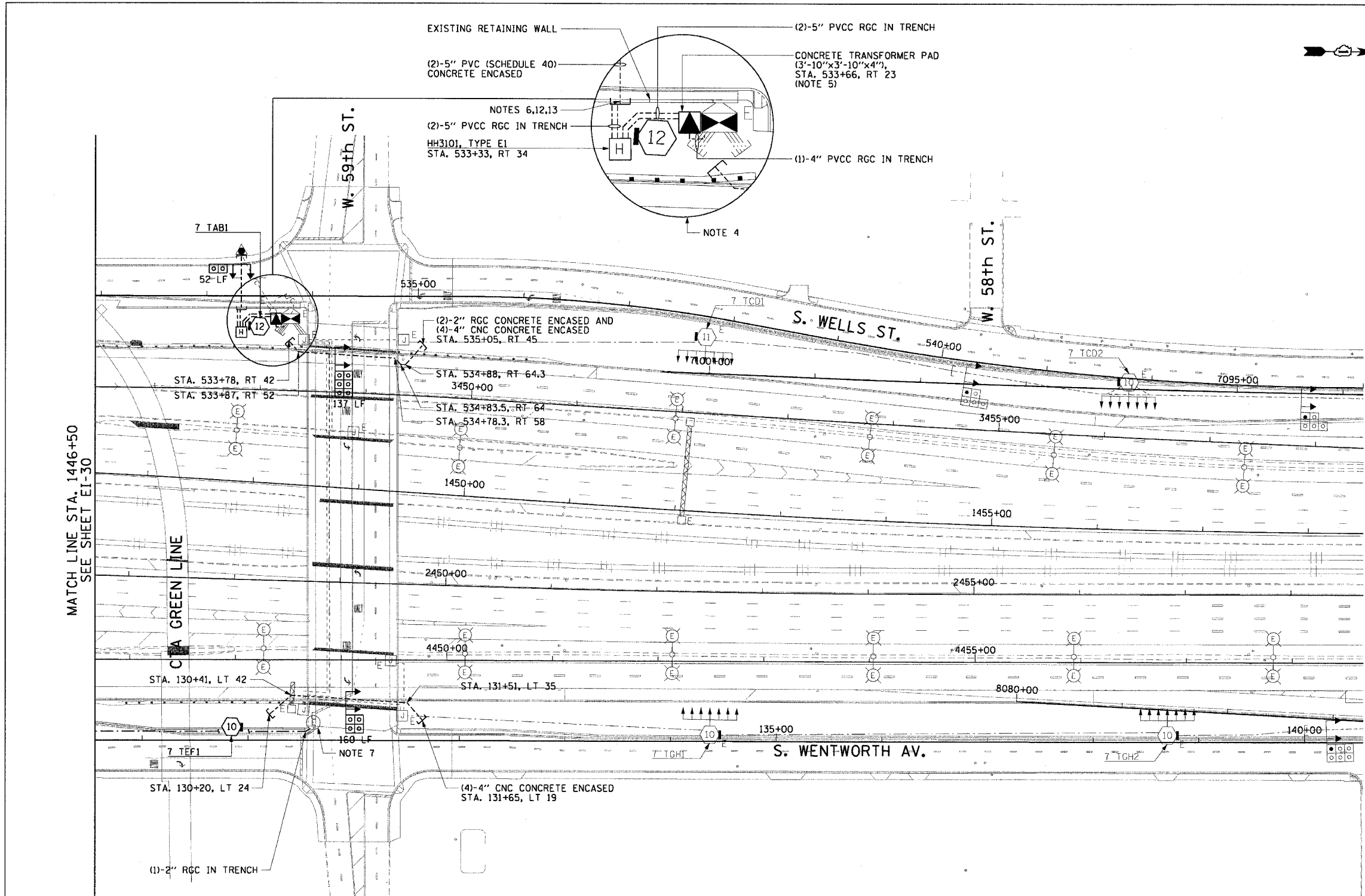

EI-31

LOCATION #1	LOCATION #2	TOP OF DUCTBANK ELEVATION, CCD
533+78, RT 42	-	-6.68
533+87, RT 52	-	-6.55
534+78.3, RT 58	-	-7.59
534+83.5, RT 64	-	-7.77
534+88, RT 64.3	-	-7.81
535+05, RT 45	-	-7.81
130+20, LT 24	-	-6.90
130+41, LT 42	-	-6.79
131+51, LT 35	-	-7.80
131+65, LT 19	-	-8.02

REVISIONS	
NAME	DATE

ILLINOIS DEPARTMENT OF TRANSPORTATION
 F.A.I. 90/94 (DAN RYAN EXPRESSWAY)
 63rd ST TO 59th ST (FRONTAGE ROAD & RAMPS)
ELECTRICAL INFRASTRUCTURE PLANS

SCALE: 1"=50'
 DATE: October 29, 2004

DRAWN BY: CJM
 CHECKED BY: BMW

11/23/2004 08:50:45 AM