

F.A.I. RYE.	SECTION	COUNTY	TOTAL SHEETS	SHEET NO.
90/94	2021-922PT.1-AC	COOK	460	200
STA.	TO STA.			
FED. ROAD DIST. NO. 1	ILLINOIS	FED. AID PROJECT	62693	

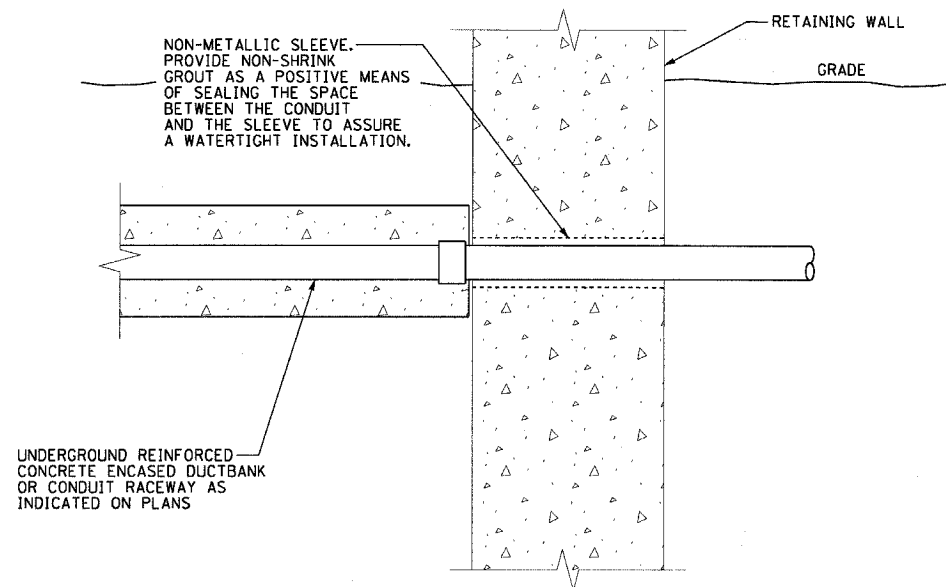

**CONDUIT SLEEVE IN RETAINING WALL DETAIL**  
SCALE: 1" = 1'-0"  
(NOTE 2)

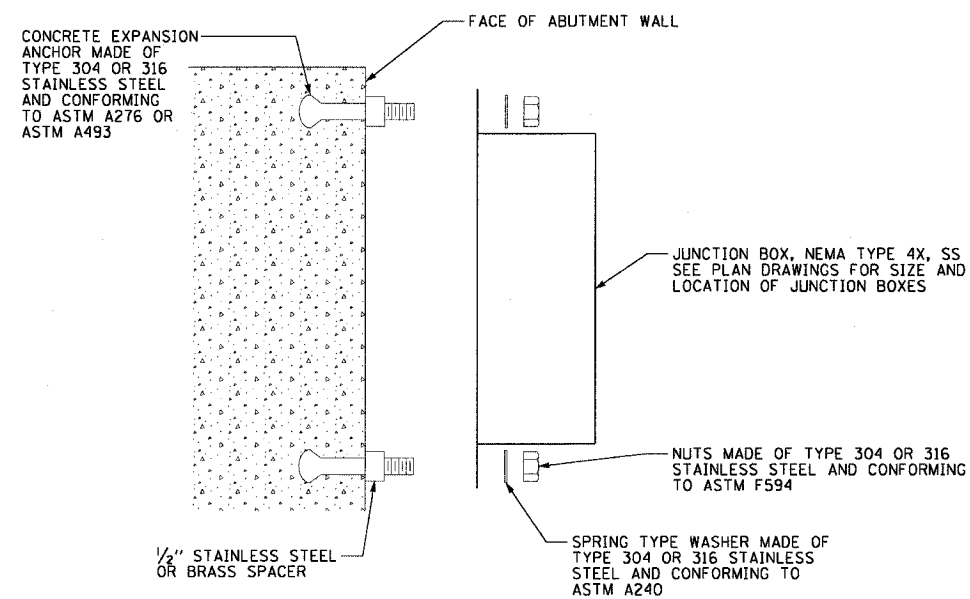

**JUNCTION BOX MOUNTED TO STRUCTURE**  
NOT TO SCALE

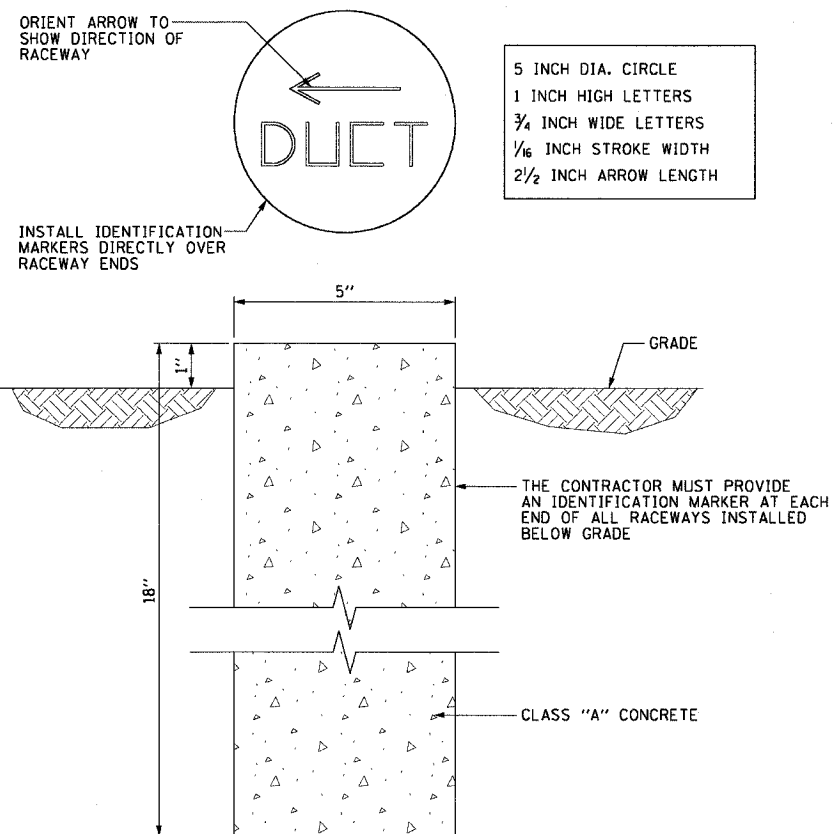

**IDENTIFICATION MARKER DETAIL**  
SCALE: 6" = 1'-0"

**NOTES:**

1. SEE DRAWINGS EI-100 AND EI-101 FOR ELECTRICAL SYMBOLS AND ABBREVIATIONS.
2. REFER TO THE STRUCTURAL PLANS FOR SIZE, TYPE, AND LOCATION OF CONDUIT SLEEVES IN RETAINING WALLS.

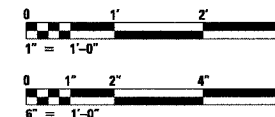

EI-118

REVISIONS	
NAME	DATE

ILLINOIS DEPARTMENT OF TRANSPORTATION  
F.A.I. 90/94 (DAN RYAN EXPRESSWAY)  
63rd ST TO 59th ST (FRONTAGE ROAD & RAMP)  
ELECTRICAL MISCELLANEOUS DETAILS

SCALE: AS SHOWN  
DATE: October 29, 2004  
DRAWN BY: CJM  
CHECKED BY: WDS

11/23/2004 08:50:48 AM