

STATE OF ILLINOIS
DEPARTMENT OF TRANSPORTATION

F.A.I. RTE.	SECTION	COUNTY	TOTAL SHEETS	SHEET NO.
90/94	2021-922PT.1-AC	COOK	460	214
STA. TO STA.		FED. ROAD DIST. NO. 1 ILLINOIS FED. AID PROJECT		
		62693		

Bench Mark:
No. 3535. Found cross cut on Southerly flange bolt of fire hydrant at the Northeast corner of 59th St. and Wentworth Ave. El 19.31

Existing Structure:
1. Cast-in-place Cantilever retaining wall E-1 on spread footing with variable height and 355'-0" long.

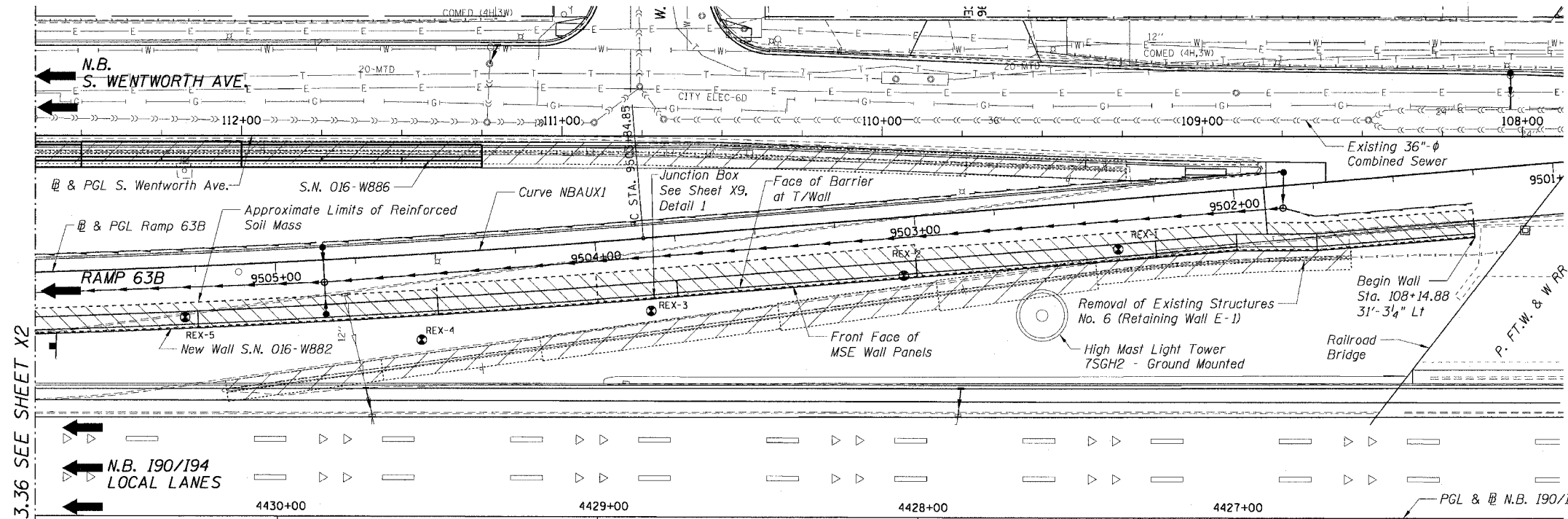

PLAN

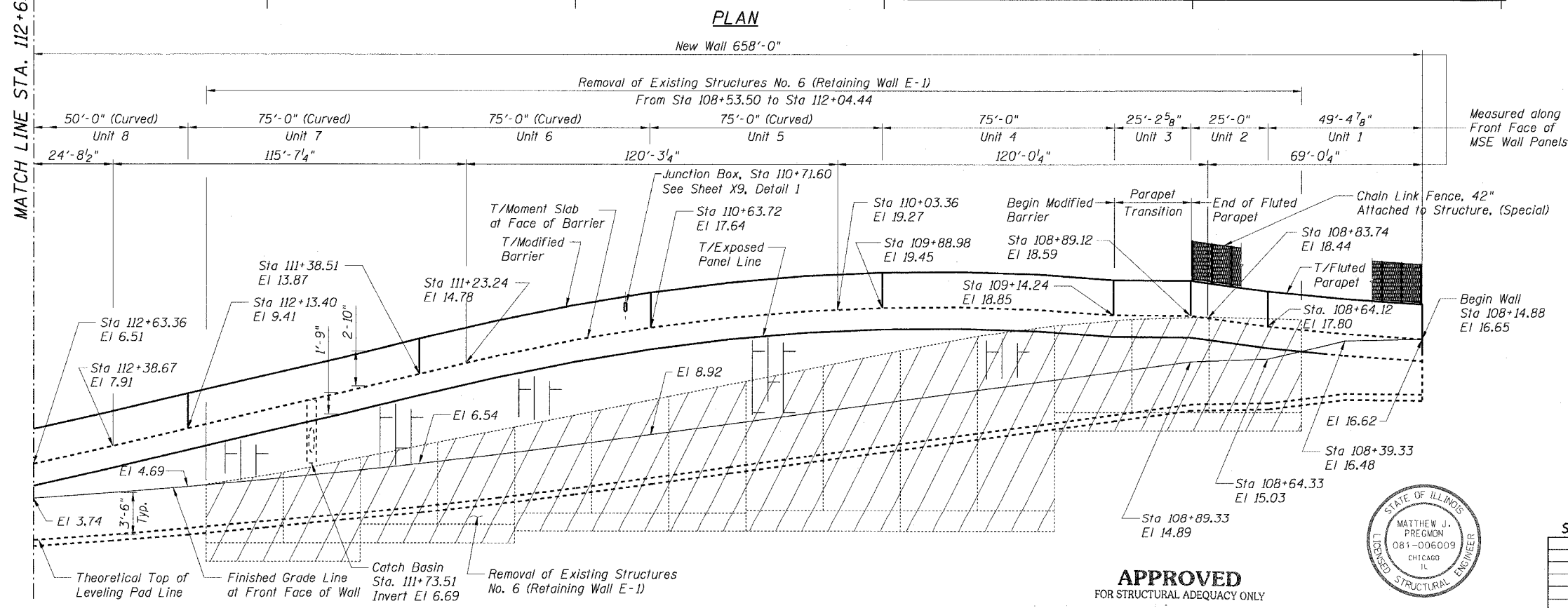

FRONT FACE ELEVATION
(Looking East)

TOTAL BILL OF MATERIAL

Item	Unit	Quantity
Removal of Existing Structures No. 6	Each	1
Porous Granular Embankment	Cu Yd	466
Structure Excavation	Cu Yd	802
Concrete Structures	Cu Yd	320
Mechanically Stabilized Earth Retaining Wall	Sq Ft	3,980
Protective Coat	Sq Yd	560
Rustication Finish	Sq Ft	140
Reinforcement Bars, Epoxy Coated	Pound	45,240
Chain Link Fence, 42" Attached to Structure (Special)	Foot	75

DESIGN SPECIFICATIONS:

2002 AASHTO, Standard Specifications for Highway Bridges

DESIGN STRESSES:

FIELD UNITS

f'c = 3,500 psi
fy = 60,000 psi (Reinf.)

PRECAST UNITS

f'c = 4,500 psi (Precast Face Panels)

NOTES:

1. For Index of Sheets and General Notes see Sheet X2.
2. For Legend and Abbreviations see Sheet X2.
3. For Offset Sketch, Profiles and Curve Data, see Sheet X3.
4. For Typical Sections see Sheets X4 and X5.
5. For Moment Slab Details see Sheets X6 through X10.
6. For Modified Barrier and Fluted Parapet Details, see Sheet X11.
7. For Soil Boring Logs, see Sheets X13 and X14.
8. For Chain Link Fence, 42" Attached to Structure (Special), see Sheet SD1.
9. For limits of Porous Granular Embankment, see Roadway Cross Sections.

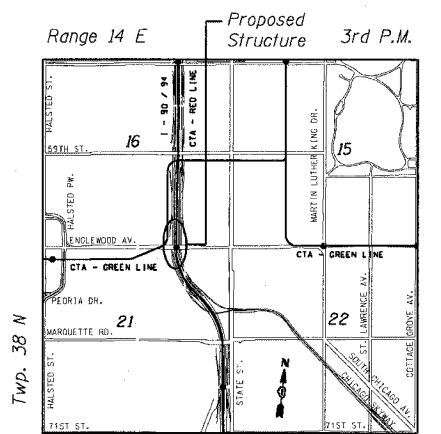

LOCATION SKETCH



APPROVED
FOR STRUCTURAL ADEQUACY ONLY

Ralph E. Anderson
ENGINEER OF BRIDGES AND STRUCTURES



M-H-SP 10-29-04

EXPIRATION DATE: 11-30-2004

Sheet X1 of 14

REVISIONS	
NAME	DATE

ILLINOIS DEPARTMENT OF TRANSPORTATION
F.A.I. 90/94 (DAN RYAN EXPRESSWAY)
GENERAL PLAN I
SOUTH WENTWORTH AVENUE RETAINING WALL
WEST 63RD STREET TO WEST 59TH STREET
SECTION 2021-922 PT.1-AC
STATION 108+14.88 TO 114+71.57
COOK COUNTY S.N. 016-W882

SCALE: None DRAWN BY: CHD
DATE: October 29, 2004 CHECKED BY: MJP

17/24/2004 08:23:56 AM