

STATE OF ILLINOIS
DEPARTMENT OF TRANSPORTATION

F.A.I. RTE.	SECTION	COUNTY	TOTAL SHEETS	SHEET NO.
90/94	2021-922PT.1-AC	COOK	460	257
STA.	TO STA.			
FED. ROAD DIST. NO. 1	ILLINOIS		FED. AID PROJECT	

62693

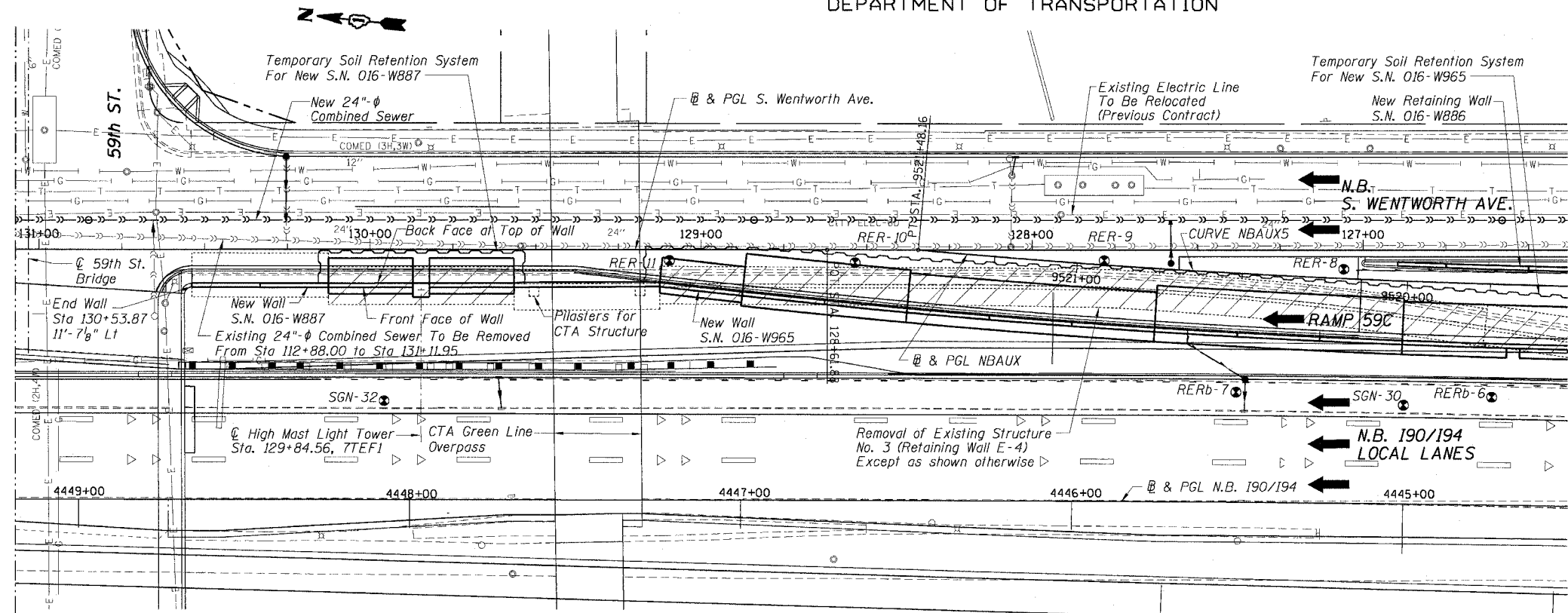

PLAN

MATCH LINE STA 126+38.21 SEE SHEET Z1

GENERAL NOTES:

- Stations and offsets are measured from @ & PGL S. Wentworth Ave. to the front face of the retaining wall.
- Existing utilities in conflict with retaining wall shall be abandoned or relocated according to directions given in the Roadway Plans.
- All construction joints shall be bonded.
- All exposed concrete edges shall have a 3/4" by 45° chamfer except where shown otherwise. Chamfer on vertical edges shall be continued a minimum of 1 foot below the finished ground line.
- A protective coat shall be applied according to Section 503.19 of the Standard Specifications to all concrete surfaces not in contact with soil.
- The back face of Retaining Wall shall be waterproofed according to Article 503.18 of Standard Specifications.
- Reinforcement bars shall conform to the requirements of AASHTO M31 or M322, Grade 60.
- Reinforcement bars designated "E" shall be epoxy coated.
- Plan Dimensions and Details relating to Existing Structures have been taken from Existing Plans and are subject to Nominal Construction Variations. It shall be The Contractor's responsibility to verify such Dimensions and Details in the Field and make necessary approved adjustments prior to Construction or ordering of Materials. Such variations shall not be cause for additional compensation or a change in the Scope of Work. However The Contractor will be paid for the Quantity actually furnished at the Unit Price for the Work.
- Light Tower Foundation and Pad Construction: The Contractor shall protect the earth in front of existing and proposed retaining walls during construction of light tower foundations and service pads. For light tower foundations in front of the new retaining walls, the Contractor shall coordinate the construction of the retaining walls, light tower foundations, and service pads to occur concurrently. If the Contractor does not perform the work concurrently he shall provide a temporary soil retention system to protect the retaining wall from being undermined during light tower construction work which shall be included in the Cost of the Light Tower Foundation work.

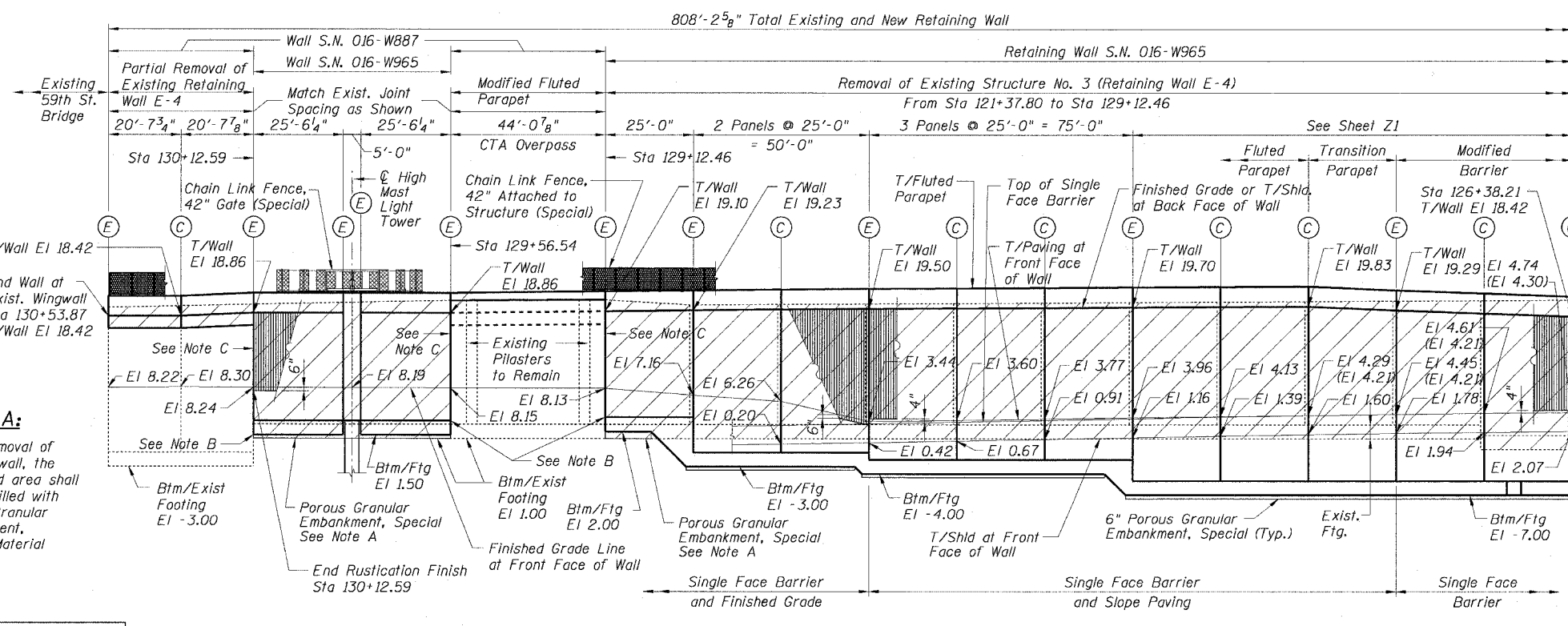

FRONT FACE ELEVATION
(Looking East)

NOTE B:

Contractor must protect the Existing Retaining Wall to Remain, just to the North of the proposed wall. Limit excavation under the existing footing to a minimum. Backfill and properly compact excavated area underneath the existing footing. Contractor to prepare and submit means and method of supporting existing wall for Engineer's review and approval. Maintain Existing pipe underdrain behind "existing wall to remain".

NOTE A:

After removal of existing wall, the excavated area shall be backfilled with Porous Granular Embankment, Special Material

NOTE C:

Match Proposed Front Face of Wall with the Front Face of the Existing Wall.

CTE ENGINEERS
CONSOER TOWNSEND ENVIRONMENTAL ENGINEERS, INC.
303 EAST WACKER DRIVE, SUITE 600
CHICAGO, ILLINOIS 60601-5212, PHONE: (312) 938-0300

REVISIONS	
NAME	DATE

Sheet Z2 of Z1

ILLINOIS DEPARTMENT OF TRANSPORTATION
F.A.I. 90/94 (DAN RYAN EXPRESSWAY)
GENERAL PLAN II
SOUTH WENTWORTH AVENUE RETAINING WALL
WEST 59TH STREET TO WEST 63RD STREET
SECTION 2021-922 PT.1-AC
STATION 122+46.54 TO 130+53.87
COOK COUNTY S.N. 016-W887-W965

SCALE: None DRAWN BY: ET
DATE: October 29, 2004 CHECKED BY: JSS/JMM

11/23/2004 01:24:20 PM