

STATE OF ILLINOIS
DEPARTMENT OF TRANSPORTATION

F.A.I. RTE.	SECTION	COUNTY	TOTAL SHEETS	SHEET NO.
90/94	2021-922PT.1-AC	COOK	460	258
STA.	TO STA.			
FED. ROAD DIST. NO. 1	ILLINOIS	FED. AID PROJECT		

62693

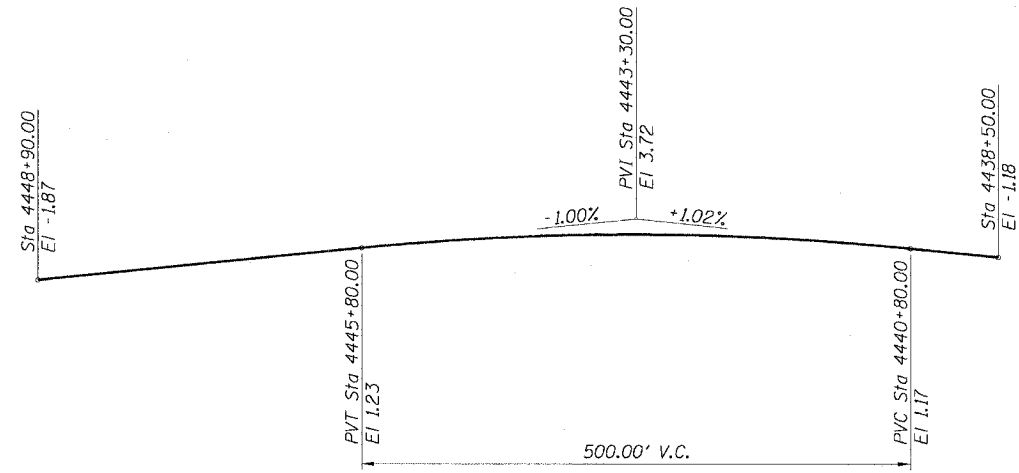

PROFILE GRADE - 190/194 N.B. LOCAL LANES
(Along \square of Roadway)

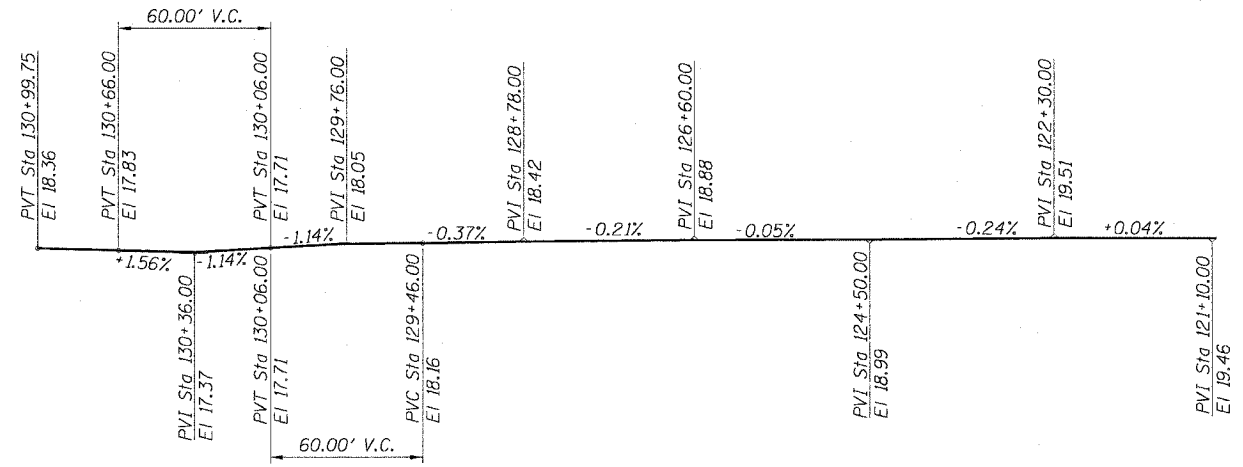

PROFILE GRADE - SOUTH WENTWORTH AVENUE
(Along \square of Roadway)

CURVE NBLOC04
P.I. STA= 4443+61.67
N= 1,865,294.49
E= 1,175,902.60
 Δ = 2° 24' 19"
D= 0° 24' 33"
R= 14000.00'
T= 293.90'
L= 587.72'
E= 3.08'
e= NC
T.R.= N/A
S.E. RUN= N/A
P.C. STA= 4440+67.76
N= 1,865,000.61
E= 1,175,898.31
P.T. STA= 4446+55.48
N= 1,865,588.28
E= 1,175,894.56

CURVE NBAUX4
P.I. STA= 9514+90.68
N= 1,864,923.14
E= 1,175,977.06
 Δ = 7° 14' 54"
D= 1° 02' 30"
R= 5500.00'
T= 348.36'
L= 695.79'
E= 11.02'
e= N/A
T.R.= N/A
S.E. RUN= N/A
P.C. STA= 9511+42.32
N= 1,864,576.47
E= 1,175,942.80
P.T. STA= 9518+38.12
N= 1,865,271.36
E= 1,175,967.30

CURVE NBAUX5
P.I. STA= 9520+14.51
N= 1,865,447.69
E= 1,175,962.35
 Δ = 5° 06' 31"
D= 1° 54' 35"
R= 3000.00'
T= 133.83'
L= 267.48'
E= 2.98'
e= 2.4
T.R.= 11' (0')
S.E. RUN= 66' (0')
P.C. STA= 9518+80.68
N= 1,865,313.91
E= 1,175,966.10
P.T. STA= 9521+48.16
N= 1,865,581.27
E= 1,175,970.53

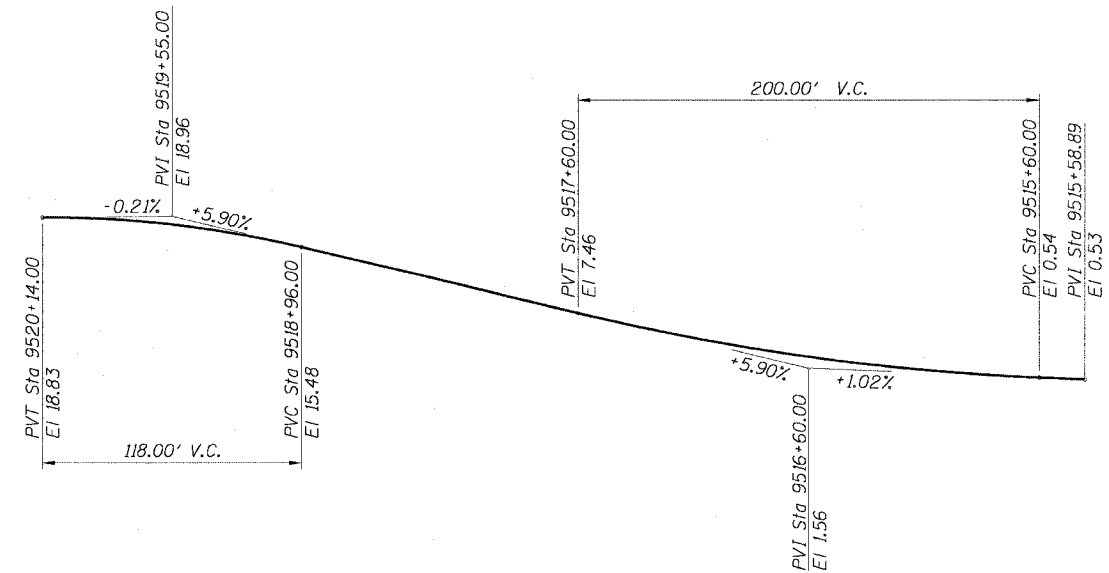

PGL - RAMP 59C
(Along \square of Roadway)



REVISIONS	
NAME	DATE

Sheet 23 of 21
ILLINOIS DEPARTMENT OF TRANSPORTATION
F.A.I. 90/94 (DAN RYAN EXPRESSWAY)
PROFILE GRADES
SOUTH WENTWORTH AVENUE RETAINING WALL
WEST 59TH STREET TO WEST 63RD STREET
SECTION 2021-922 PT.1-AC
STATION 122+46.54 TO 130+53.87
COOK COUNTY S.N. 016-W887-W965
SCALE: None DRAWN BY: ET
DATE: October 29, 2004 CHECKED BY: JSS/JMM

m:\p\90468\struc\47-cnt\965\p\w965\1250\302016-w965.sst