

F.A. RTE.	SECTION	COUNTY	TOTAL SHEETS	SHEET NO.
90/94	2021-922PT.1-AC	COOK	460	457
STA.	TO STA.			
FED. ROAD DIST. NO.	ILLINOIS	FED. AID PROJECT		

62693

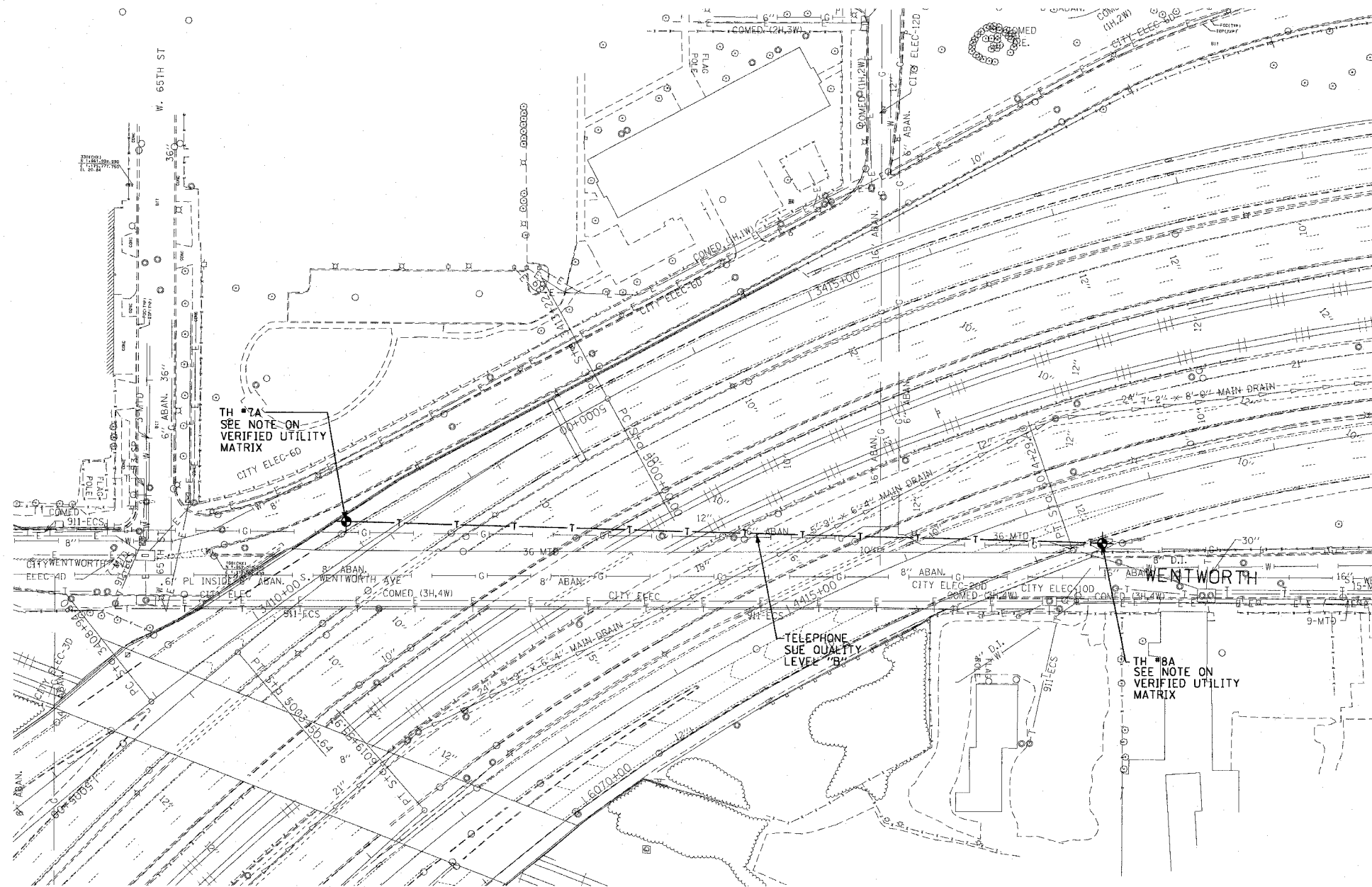

TH #7A
SEE NOTE ON
VERIFIED UTILITY
MATRIX

TELEPHONE
SUE QUALITY
LEVEL "B"

TH #8A
SEE NOTE ON
VERIFIED UTILITY
MATRIX



TBE GROUP, INC.
 CIVIL ENGINEERING • TRANSPORTATION • ENVIRONMENTAL
 PLANNING • UTILITY ENGINEERING/LOCATING
 SOUTHERN REGION: FL, GA, SC, NC
 NORTHERN REGION: IL, IN, MI, OH, MD, NJ, NY
 PA, VA, CANADA
 WESTERN REGION: AZ, NV, NM, TX, CA, OR, UT, WA

IL09500170, 171, 204, 211, 221
 TBE SUE PAGE NO: 2 of 11
 Checked by: _____
 SUE Quality Level "A" : Test Holes
 SUE Quality Level "B" : Designating

— SL —	— SL —	STREET LIGHT
— TS —	— TS —	TRAFFIC SIGNAL
— T —	— T —	TELEPHONE
— W —	— W —	WATER
— G —	— G —	GAS
— FO —	— FO —	FIBER OPTIC CABLE
— COCE —	— COCE —	CITY OF CHICAGO ELECTRIC
— E —	— E —	ELECTRIC
●	●	TEST HOLE

Utilities shown on these plans as depicted in the legend have been investigated by TBE Group, Inc in accordance with SUE Industry Standards. All other information shown has been provided to TBE Group, Inc by others.

 205 W. WACKER DRIVE
 SUITE 1020
 CHICAGO, IL 60606
 (312) 704-1970

REVISIONS	
NAME	DATE

ILLINOIS DEPARTMENT OF TRANSPORTATION
 SUE Investigation of Underground Utilities
 I-94 NB & SB of Dan Ryan Expressway
 at 47th Street to 63rd Street.
 Contract No: 62586, 62589
 SQL "A" DATE : 8/25/2004
 SQL "B" DATE : 8/20/2003
 DRAWN BY : KLC
 SCALE 1" = 50'