

**HORIZONTAL CURVE DATA**  
P.I. STA. 1000+35.41  
P.C. STA. 995+13.61  
P.T. STA. 1005+35.92  
 $\Delta = 28^{\circ}-17'-46''$   
T = 521.80  
R = 2070.04'  
L = 1022.31'  
E = 64.75'  
EXISTING  $e = 2.8\%$

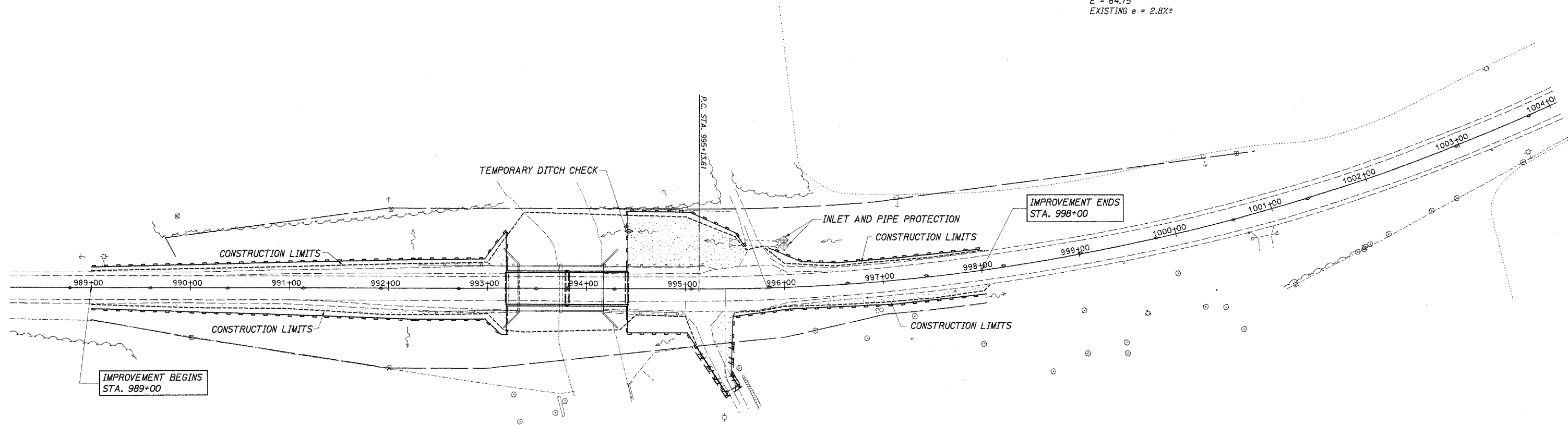
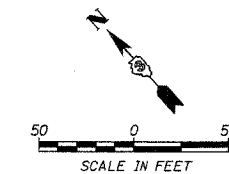

**LEGEND FOR STORM WATER POLLUTION PREVENTION PLAN**

ITEM	SYMBOL
TEMPORARY DITCH CHECKS (HAY OR STRAW BALE DITCH CHECKS OR APPROVED SUBSTITUTION)	
INLET PIPE PROTECTION (I&PP) (HAY OR STRAW BALE DITCH CHECKS OR APPROVED SUBSTITUTION)	
PERIMETER EROSION BARRIER	
DIRECTION OF OVERLAND FLOW	

**ESTIMATED QUANTITIES  
TEMPORARY**

ITEM	UNIT	QUANTITY
PERIMETER EROSION BARRIER	FOOT	1,776
TEMPORARY EROSION CONTROL SEEDINGS	POUND	28
MULCH, METHOD 2	ACRE	0.28
TEMPORARY DITCH CHECKS	EACH	1
INLET AND PIPE PROTECTION	EACH	2

**ESTIMATED QUANTITIES  
PERMANENT**

ITEM	UNIT	QUANTITY
SEEDING, CLASS 2	ACRE	0.25
NITROGEN FERTILIZER NUTRIENTS	POUND	23
PHOSPHORUS FERTILIZER NUTRIENTS	POUND	23
POTASSIUM FERTILIZER NUTRIENTS	POUND	23
MULCH, METHOD 2	ACRE	0.25
* STONE RIPRAP, CLASS A4	SQ YD	155

\*SEE SHEET 21 OF 42 FOR  
PLACEMENT OF STONE RIPRAP.

**GENERAL NOTES**

THESE ITEMS ARE ESTIMATED ONLY AND THERE WILL BE NO ADJUSTMENT IN UNIT PRICE DUE TO A CHANGE IN PLAN QUANTITY.

ALL ITEMS SHALL BE CONSTRUCTED AS SHOWN ON THIS SHEET, ON STANDARD 280001, AND AS DIRECTED BY THE ENGINEER.

THE SYMBOLOGY ON THIS SHEET DOES NOT REPRESENT THE SIZE OR QUANTITY OF BALES, FOR NUMBER OF BALES REFER TO STANDARD 280001 AND/OR AS DIRECTED BY THE ENGINEER.

**EROSION CONTROL PLAN**  
FAP 697 (IL. RTE. 9) OVER  
WALL TOWN DRAINAGE DITCH  
SECTION 17BR-1  
FORD COUNTY  
S.N. 027-0094

4440 ASH GROVE  
SPRINGFIELD, IL. 62707  
(217) 793-8800  
oasinc@famvid.com

**OZYURT AND STONE, INC.**  
CONSULTING ENGINEERS

JOB NO.: 0306.2  
FILE: ECP01.DWG  
DATE: 08-17-0