

SEC. 32, T. 19 N., R. 14 W., 2ND P.M.

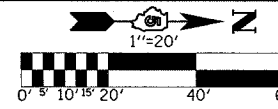

F.A.P. RTE. 836	SECTION 1119R1BR	COUNTY CHAMPAIGN	TOTAL SHEETS 43	SHEET NO. 9
STA. 1012+00		TO STA. 1018+00		
FED. ROAD DIST. NO. ILLINOIS		FED. AID PROJECT		

CONTRACT NO. 70355

PLAN	SURVEYED	BY	DATE
	PLOTTED		
	CHECKED		
	BY		
	NO. OF WAY CHECKED		
	NO. OF FILE NAME		

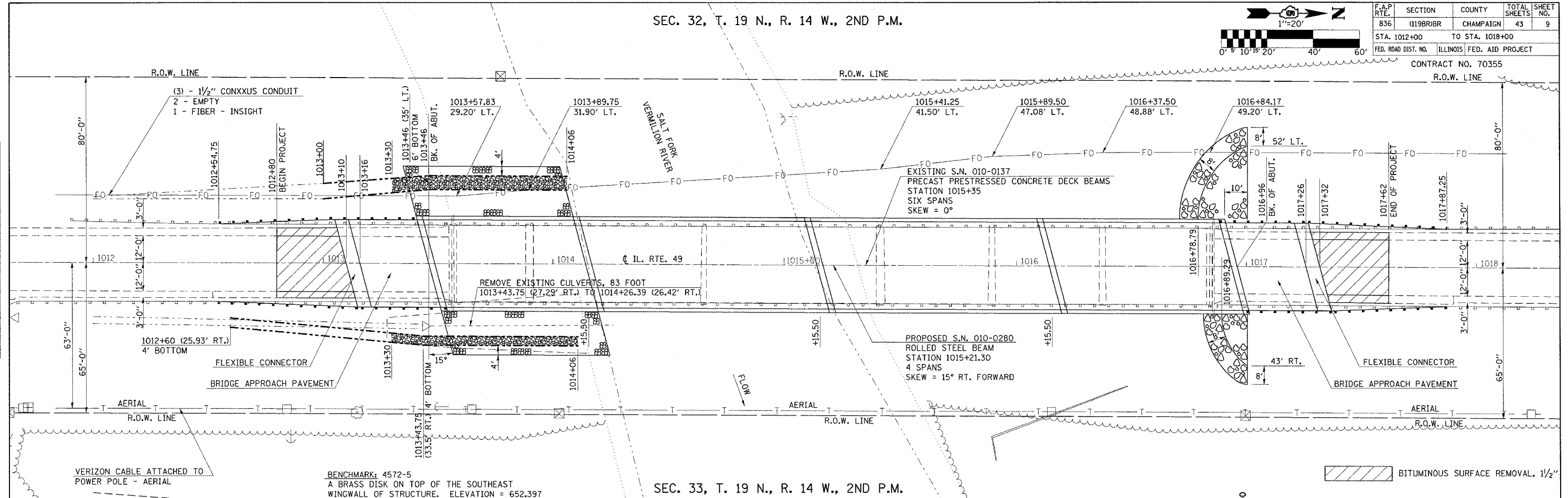

BENCHMARK: 4572-5
A BRASS DISK ON TOP OF THE SOUTHEAST WINGWALL OF STRUCTURE. ELEVATION = 652.397

SEC. 33, T. 19 N., R. 14 W., 2ND P.M.

PROFILE	SURVEYED	BY	DATE
	PLOTTED		
	CHECKED		
	BY		
	NO. OF WAY CHECKED		
	NO. OF STRUCTURE NOTATIONS CHD		

