

F.A.U. R.T.E.	SECTION	COUNTY	TOTAL SHEETS	SHEET NO.
1636	92-00037-03-PV	WILL	39	16
STA.		TO STA.		
FED. ROAD DIST. NO.	ILLINOIS	FED. AID PROJECT		

83680

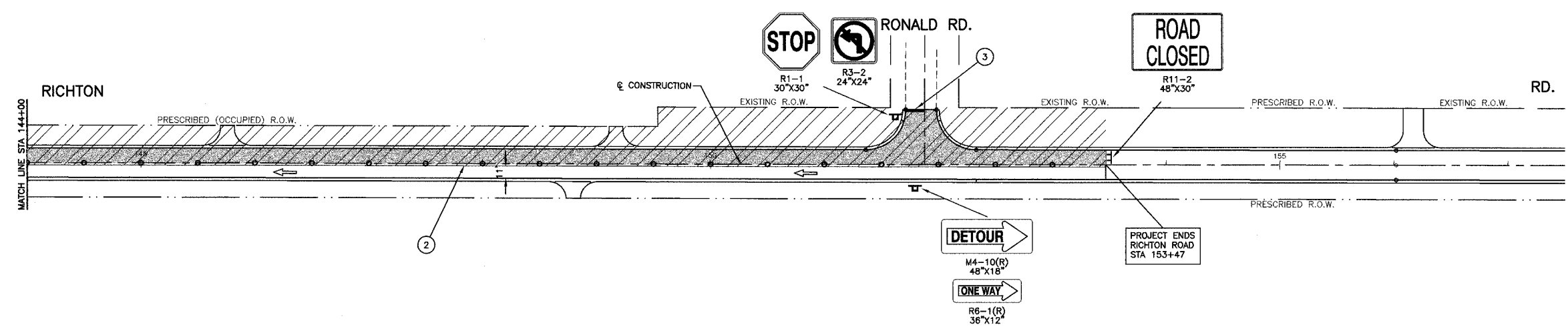

**LEGEND**

- |   |   |
|---|---|
| WORK AREA   | ① 4" YELLOW EDGE LINE - TEMPORARY PAVEMENT MARKINGS         |
| TEMPORARY PAVEMENT TO BE CONSTRUCTED (8")                           | ② 4" WHITE EDGE LINE - TEMPORARY PAVEMENT MARKINGS          |
| PAVEMENT CONSTRUCTION LIMITS  | ③ 24" WHITE STOP BAR - TEMPORARY PAVEMENT MARKINGS          |
| VERTICAL PANEL WITH STEADY BURNING LIGHT (50' C-C)                  | ④ 4" DOUBLE YELLOW CENTER LINE - TEMPORARY PAVEMENT MARKING |
| TYPE I OR II BARRICADE OR DRUM WITH STEADY BURNING LIGHTS (50' C-C) |   |
| TYPE III BARRICADE WITH STEADY BURNING LIGHT                        |   |
| SIGN  |   |

REVISIONS	
NAME	DATE

ILLINOIS DEPARTMENT OF TRANSPORTATION  
 F.A.U. 1636 RICHTON ROAD  
 SUGGESTED CONSTRUCTION STAGING  
 STAGE 3 - RICHTON RD  
 STA 144+00 TO END PROJECT  
 SCALE: VERT. 1"=50'  
 HORIZ. 1"=50'  
 DATE 02-17-03  
 DRAWN BY  
 CHECKED BY