

F.A.U. RTE.	SECTION	COUNTY	TOTAL SHEETS	SHEET NO.
1636	92-00037-03-PV	WILL	39	18
STA.	TO STA.			
FED. ROAD DIST. NO.	ILLMOIS	FED. AID PROJECT		

83680

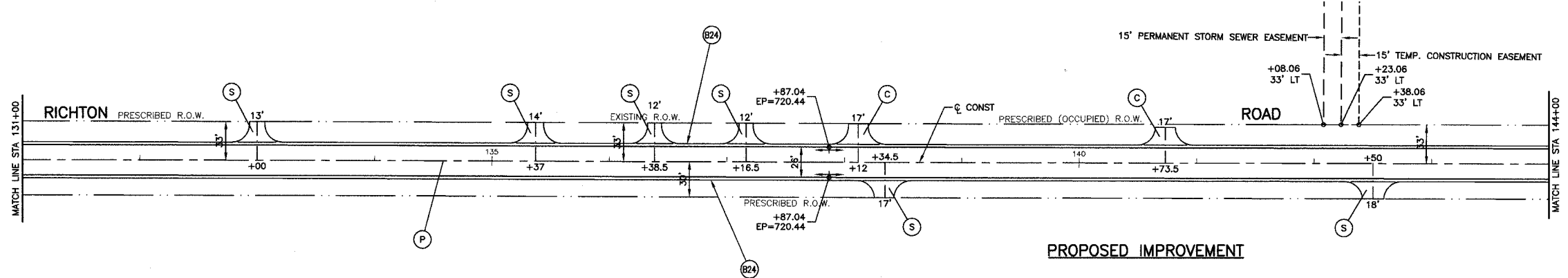

- PROPOSED LEGEND**
- (P) FULL DEPTH PAVEMENT
 - (C) CONCRETE DRIVEWAY
 - (S) STABILIZED DRIVEWAY
 - (B24) COMBINATION CONCRETE CURB AND GUTTER, TYPE B-6.24
 - (T) TRANSITION FROM TYPE B-6.24 CURB AND GUTTER TO 0" CURB HEIGHT
 - /// PAVEMENT/DRIVEWAY REMOVAL
 - ⊗ TREE TO BE REMOVED

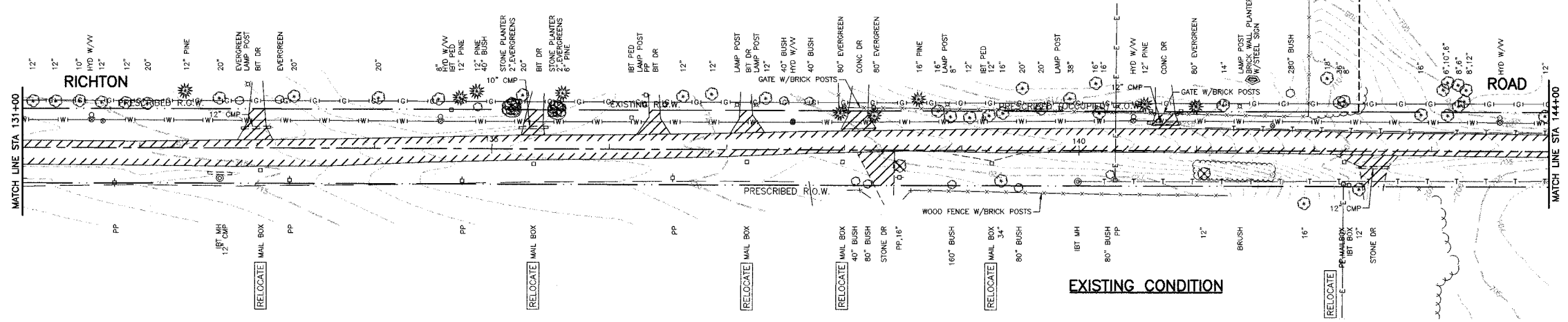
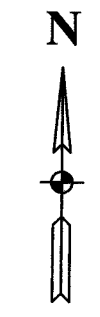
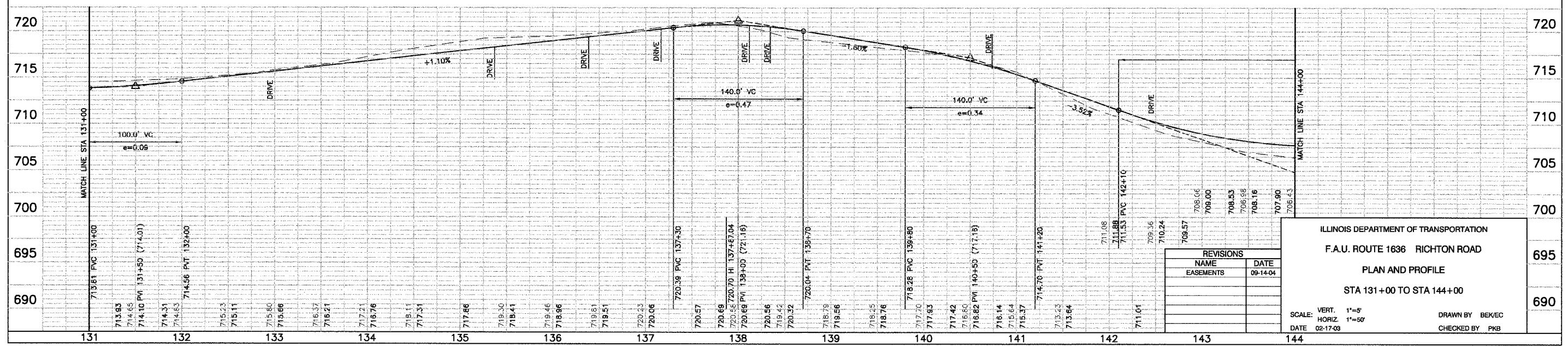

REVISIONS	
NAME	DATE
EASEMENTS	09-14-04

ILLINOIS DEPARTMENT OF TRANSPORTATION
 F.A.U. ROUTE 1636 RICHTON ROAD
 PLAN AND PROFILE
 STA 131+00 TO STA 144+00

SCALE: VERT. 1"=5'
 HORIZ. 1"=50'
 DATE 02-17-03

DRAWN BY BEVEC
 CHECKED BY PKB