

INDEX OF SHEETS

- 1 TITLE SHEET / INDEX OF SHEETS
- 2 STATE STANDARDS, PLAN NOTES
- 3-5 SUMMARY OF QUANTITIES
- 6-9 TYPICAL SECTIONS
- 10-13 QUANTITY SCHEDULES
- 14-33 TRAIL PLAN AND PROFILE
- 34-41 MISC. DETAILS
- 42-69 STRUCTURE PLANS
- 70-117 CROSS SECTIONS

STATE OF ILLINOIS
DEPARTMENT OF TRANSPORTATION
DIVISION OF HIGHWAYS
PLANS FOR PROPOSED
FEDERAL AID PROJECT
SALT CREEK GREENWAY TRAIL (NORTH DUPAGE)
PROJECT LIMITS: NORTH OF ELIZABETH DR. TO 2ND ST.
PROJECT NO. M-8003(222)
SECTION NO. 02-00090-00-BT
VILLAGE OF ADDISON
DUPAGE COUNTY
C-91-283-02

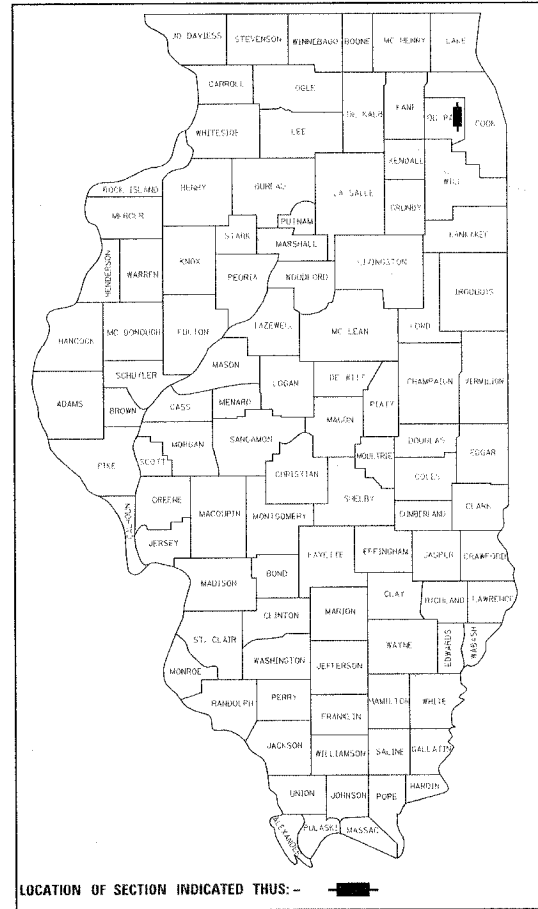

DESIGN DESIGNATION
BIKE PATH

POSTED SPEED LIMIT
20 M.P.H.

METRIC RATIOS

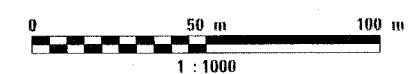
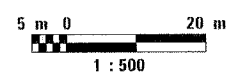
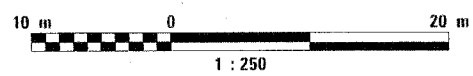
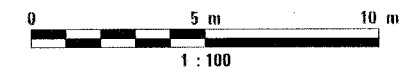
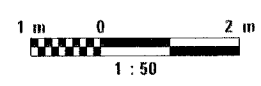

FULL SIZE PLANS HAVE BEEN PREPARED USING STANDARD ENGINEERING SCALES. REDUCED SIZED PLANS WILL NOT CONFORM TO STANDARD SCALES. IN MAKING MEASUREMENTS ON REDUCED PLANS, THE ABOVE SCALES MAY BE USED.

J.U.L.I.E.
JOINT UTILITY LOCATION INFORMATION FOR EXCAVATION
1-800-892-0123

CONTRACT NO. 83713

BEGIN PROJECT
NORTH DUPAGE
STA. 9 + 298.72

BRIDGE STRUCTURE
STA. 12 + 523 TO
STA. 12 + 548

BRIDGE STRUCTURE
STA. 15 + 802.00 TO
STA. 15 + 873.00

OMISSION
STA. 14 + 447.56
TO STA. 15 + 800.00

END PROJECT
NORTH DUPAGE
STA. 17 + 065.96

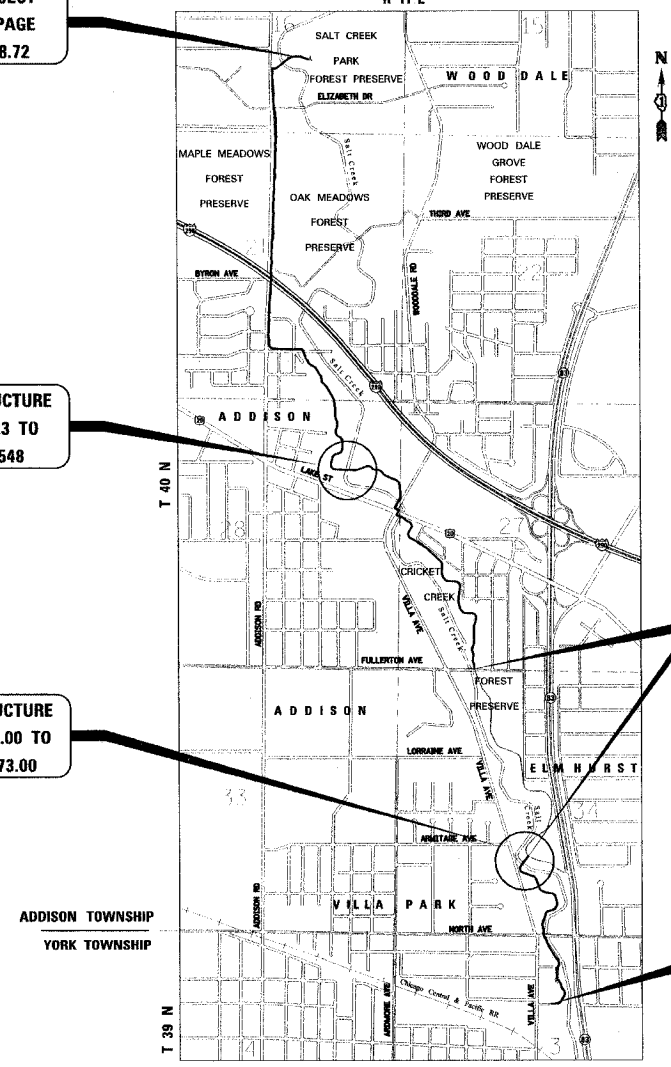

GROSS LENGTH = 7,767.24 METERS
NET LENGTH = 6,414.80 METERS

VILLAGE OF ADDISON
APPROVED November 5, 2004
Queen E. Weinstock
DIRECTOR OF PUBLIC WORKS

STATE OF ILLINOIS
DEPARTMENT OF TRANSPORTATION
DIVISION OF HIGHWAYS
APPROVED _____ 20_____
LOCAL ROADS AND STREETS ENGINEER
APPROVED November 19, 2004
Dina O'Keefe
DISTRICT ENGINEER

**PRINTED BY THE AUTHORITY
OF THE STATE OF ILLINOIS**

PLANS PREPARED BY:
URS 1701 GOLF ROAD, SUITE 1000
ROLLING MEADOWS, IL 60008
TEL. (847) 228-0707
FAX (847) 228-1115

David [Signature]
DATE: 11/3/04
Exp: 11/30/05

FEDERAL AID DESIGN ENGINEER: MAZHAR KHAN (847) 705-4179