

FAI R.T.E.	SECTION	COUNTY	TOTAL SHEETS	SHEET NO.
72	74-70HBR	PIATT	41	14
FED. ROAD DIST. NO.		ILLINOIS	FED. AID PROJECT	
			CONTRACT #90957	

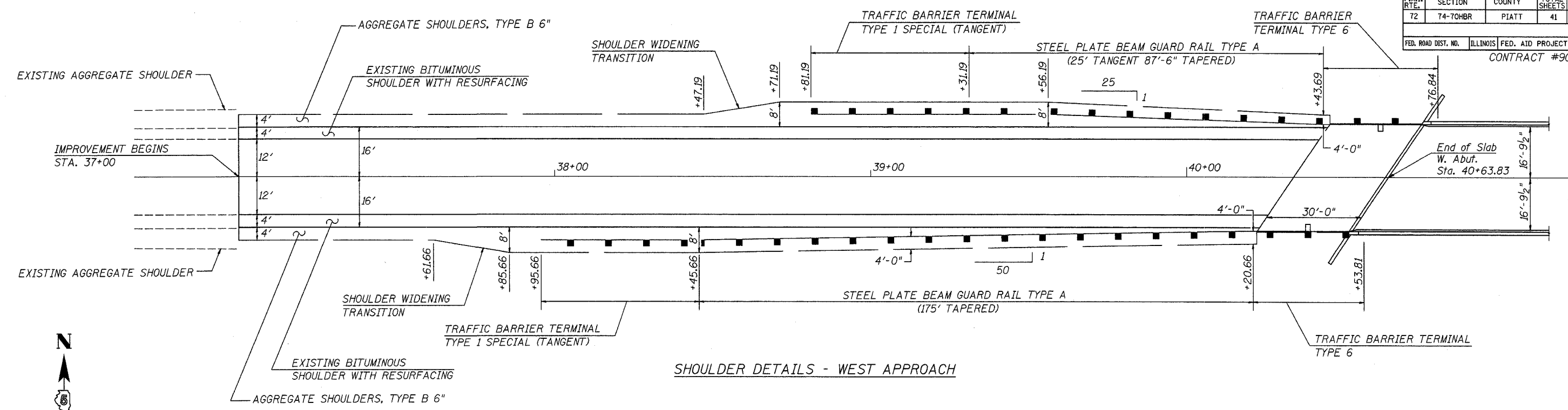

SHOULDER DETAILS - WEST APPROACH

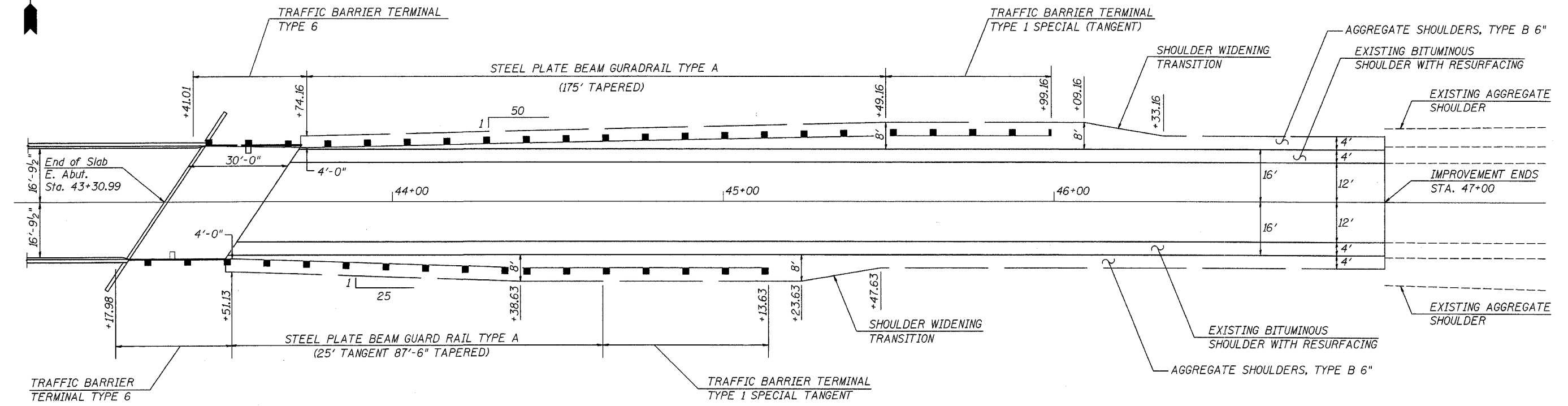

SHOULDER DETAILS - EAST APPROACH

STEEL PLATE BEAM GUARD RAIL TYPE A		TRAFFIC BARRIER TERMINAL TYPE 6		TRAFFIC BARRIER TERMINAL TYPE 1 SPECIAL (TANGENT)		GUARDRAIL REMOVAL	
LOCATION	FEET	LOCATION	EACH	LOCATION	EACH	LOCATION	FEET
RT STA 38+45.66 TO STA 40+20.66	175.0	RT STA 40+20.66 TO STA 40+53.81	1	RT STA 37+95.66 TO STA 38+45.66	1	RT STA 37+72.20 TO STA 40+43.50	271.3
RT STA 43+51.13 TO STA 44+63.63	112.5	RT STA 43+17.98 TO STA 43+51.13	1	RT STA 44+63.63 TO STA 45+13.63	1	RT STA 43+30.40 TO STA 46+01.30	270.9
LT STA 39+31.19 TO STA 40+43.69	112.5	LT STA 40+43.69 TO STA 40+76.84	1	LT STA 38+81.19 TO STA 39+31.19	1	LT STA 37+94.00 TO STA 40+65.30	271.3
LT STA 43+74.16 TO STA 45+49.16	175.0	LT STA 43+41.01 TO STA 43+74.16	1	LT STA 45+49.16 TO STA 45+99.16	1	LT STA 43+51.60 TO STA 46+23.10	271.5
<b>TOTAL</b>	<b>575.0</b>	<b>TOTAL</b>	<b>4</b>	<b>TOTAL</b>	<b>4</b>	<b>TOTAL</b>	<b>1,085.0</b>

**GUARD RAIL AND SHOULDER DETAILS**

FAI ROUTE 72  
SECTION 74-70HBR  
ILLINOIS DEPT. OF TRANSPORTATION  
DISTRICT 5  
PIATT COUNTY

CUMMINS ENGINEERING CORPORATION

JOB #: 088
FILE: 088GRAIL
DATE: 5/14/04