

CONSTRUCTION NOTES:

- ① INSTALL UNINTERRUPTIBLE POWER SUPPLY UNIT.
- ② INSTALL NEW SERVICE INSTALLATION, SERVICE CABLE, AND GROUND CABLE AND REMOVE EXISTING SERVICE INSTALLATION.
- ③ ALL EXISTING CONFIRMATION BEACONS SHALL BE RETROFITTED WITH LED INDICATORS. THIS WORK SHALL BE INCIDENTAL TO THE PAY ITEM: UNINTERRUPTIBLE POWER SUPPLY.
- ④ THE CONTRACTOR SHALL REMOVE ALL EXISTING PAVEMENT MARKINGS PRIOR TO INSTALLING NEW THERMOPLASTIC PAVEMENT MARKINGS.
- ⑤ THE TEMPORARY RADIO INTERCONNECT SHALL BE REMOVED AFTER THE FIBER OPTIC INTERCONNECT TO PARK AVENUE/PARK BOULEVARD IS INSTALLED AND OPERATIONAL.
- ⑥ THE CONTRACTOR SHALL PAINT ALL FOUR (4) EXISTING MAST ARM ASSEMBLIES AND POLES ACCORDING TO THE SPECIAL PROVISION.

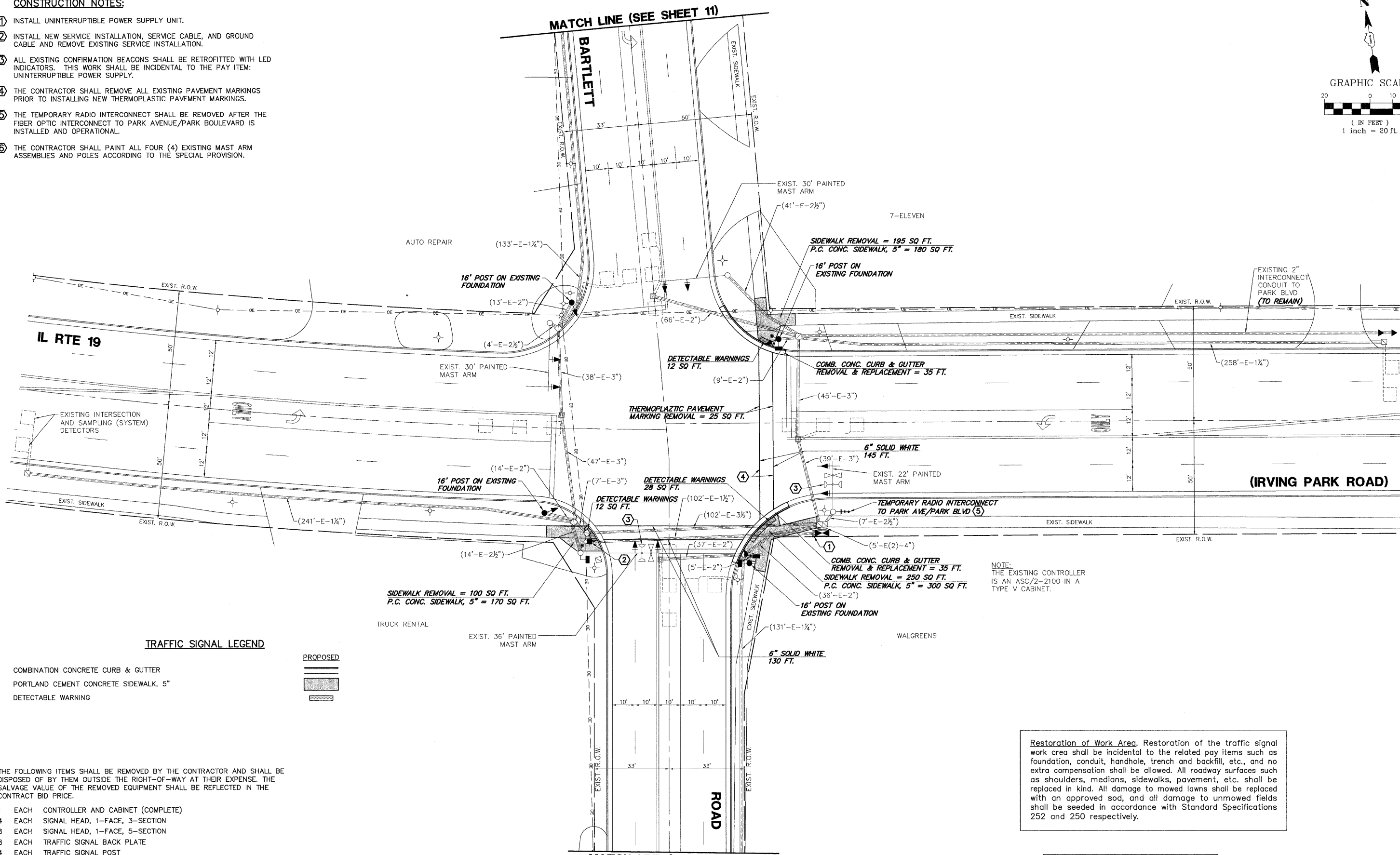
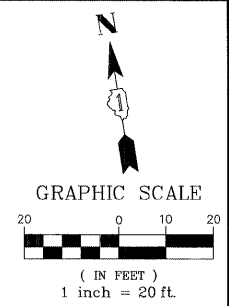

TRAFFIC SIGNAL LEGEND

- COMBINATION CONCRETE CURB & GUTTER
- PORTLAND CEMENT CONCRETE SIDEWALK, 5"
- DETECTABLE WARNING

THE FOLLOWING ITEMS SHALL BE REMOVED BY THE CONTRACTOR AND SHALL BE DISPOSED OF BY THEM OUTSIDE THE RIGHT-OF-WAY AT THEIR EXPENSE. THE SALVAGE VALUE OF THE REMOVED EQUIPMENT SHALL BE REFLECTED IN THE CONTRACT BID PRICE.

- 1 EACH CONTROLLER AND CABINET (COMPLETE)
- 4 EACH SIGNAL HEAD, 1-FACE, 3-SECTION
- 8 EACH SIGNAL HEAD, 1-FACE, 5-SECTION
- 8 EACH TRAFFIC SIGNAL BACK PLATE
- 4 EACH TRAFFIC SIGNAL POST
- 2 EACH PEDESTRIAN SIGNAL HEAD, 1-FACE
- 2 EACH PEDESTRIAN PUSH-BUTTON
- 1 EACH SERVICE INSTALLATION
- 4 EACH INCANDESCENT CONFIRMATION BEACON

NOTE:
THE EXISTING CONTROLLER IS AN ASC/2-2100 IN A TYPE V CABINET.

Restoration of Work Area. Restoration of the traffic signal work area shall be incidental to the related pay items such as foundation, conduit, handhole, trench and backfill, etc., and no extra compensation shall be allowed. All roadway surfaces such as shoulders, medians, sidewalks, pavement, etc. shall be replaced in kind. All damage to mowed lawns shall be replaced with an approved sod, and all damage to unmowed fields shall be seeded in accordance with Standard Specifications 252 and 250 respectively.

THE TRAFFIC SIGNAL CONTROL EQUIPMENT FOR THIS PROJECT SHALL BE "ECONOLITE" TO MATCH THE EXISTING ADJACENT SYSTEM.

FILE NAME = 4085.862-TR1.dwg	USER NAME = ZACH WALLSTEN	DESIGNED - JRD	REVISED -	STATE OF ILLINOIS DEPARTMENT OF TRANSPORTATION	TRAFFIC SIGNAL MODERNIZATION PLAN IL ROUTE 19 (IRVING PARK ROAD) AT BARTLETT ROAD				FAP RTE VARIES	SECTION 2010-005TS	COUNTY COOK	TOTAL SHEETS 32	SHEET NO. 10	CONTRACT # 60K23	GH #4085.862
	PLOT SCALE = 1" = .08'	DRAWN - ZCW	REVISED -		SCALE 1"=20'	SHEET NO.	OF SHEETS	STA.	TO STA.	ILLINOIS FED. AID PROJECT					
	PLOT DATE = 10/12/2010	CHECKED - KLB	REVISED -												
		DATE - 10/12/2010	REVISED -												