

CONSTRUCTION NOTES:

- ① THE CONTRACTOR SHALL DRILL INTO THE EXISTING DOUBLE HANDHOLE AND INSTALL A 2" INTERCONNECT CONDUIT TO THE NEW INTERSECTION HANDHOLE.
- ② THE CONTRACTOR SHALL BUILD THE NEW HANDHOLE OVER THE EXISTING INTERCONNECT CONDUIT TO REESTABLISH THE FIBER OPTIC INTERCONNECT BETWEEN LINCOLN AVENUE/SUNNYDALE BOULEVARD AND EAST AVENUE.

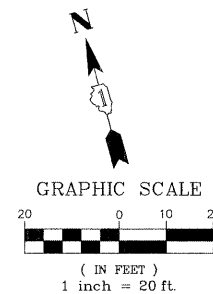

SUNNYDALE BLVD

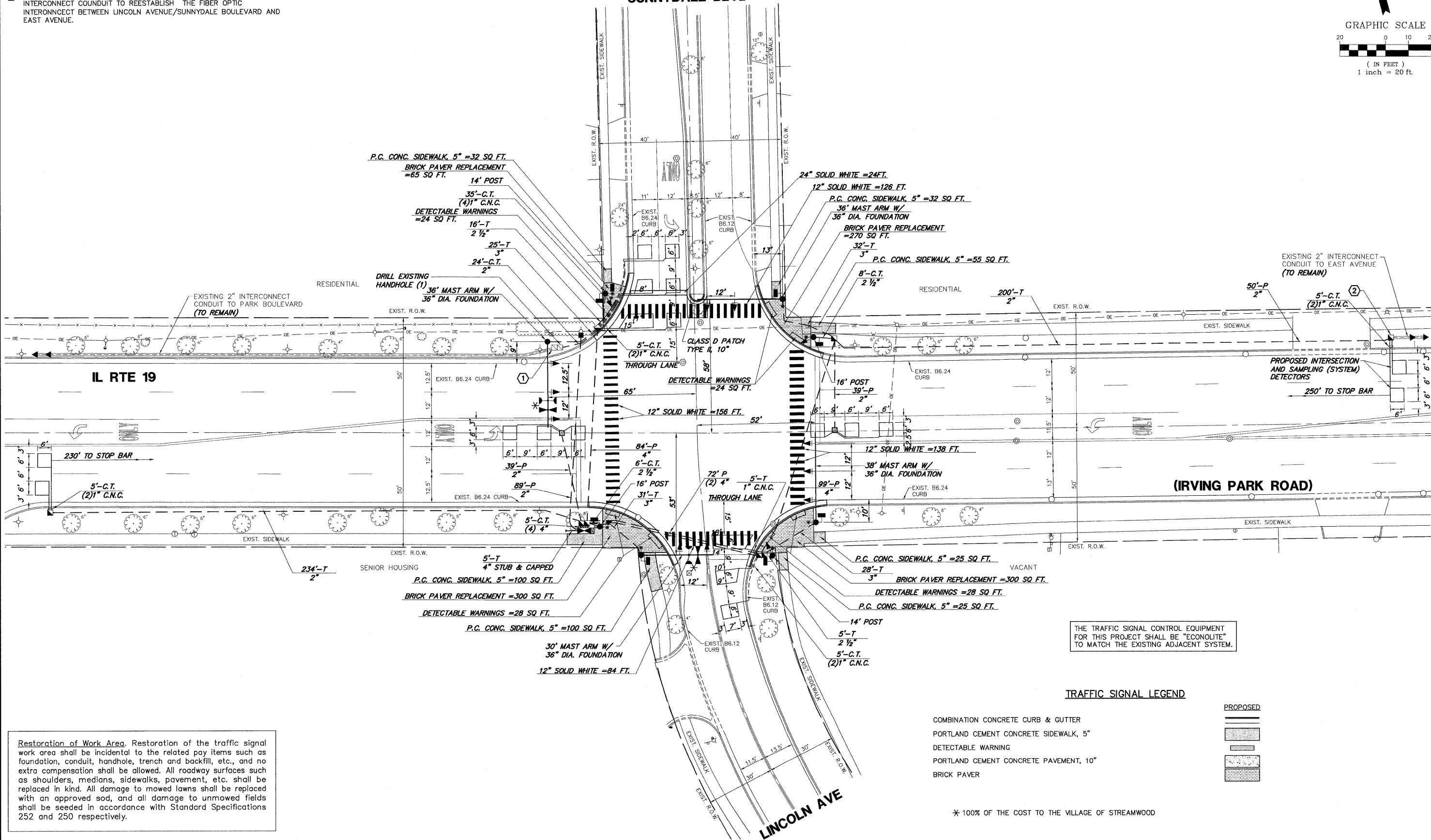

THE TRAFFIC SIGNAL CONTROL EQUIPMENT FOR THIS PROJECT SHALL BE "ECONOLITE" TO MATCH THE EXISTING ADJACENT SYSTEM.

TRAFFIC SIGNAL LEGEND

- COMBINATION CONCRETE CURB & GUTTER
- PORTLAND CEMENT CONCRETE SIDEWALK, 5"
- DETECTABLE WARNING
- PORTLAND CEMENT CONCRETE PAVEMENT, 10"
- BRICK PAVER

* 100% OF THE COST TO THE VILLAGE OF STREAMWOOD

Restoration of Work Area. Restoration of the traffic signal work area shall be incidental to the related pay items such as foundation, conduit, handhole, trench and backfill, etc., and no extra compensation shall be allowed. All roadway surfaces such as shoulders, medians, sidewalks, pavement, etc. shall be replaced in kind. All damage to mowed lawns shall be replaced with an approved sod, and all damage to unmowed fields shall be seeded in accordance with Standard Specifications 252 and 250 respectively.

FILE NAME = 4085.864-TR1.dwg	USER NAME = ZACH WALLSTEN	DESIGNED - JRD	REVISED -	STATE OF ILLINOIS DEPARTMENT OF TRANSPORTATION	TRAFFIC SIGNAL MODERNIZATION PLAN IL RTE 19 (IRVING PARK RD) AT LINCOLN AVE/SUNNYDALE BLVD			FAP RTE. VARIES	SECTION 2010-005TS	COUNTY COOK	TOTAL SHEETS 32	SHEET NO. 19
PLOT SCALE = 1" = .0833'	CHECKED - KLB	DATE - 10/12/2010	REVISED -		SCALE 1"=20'	SHEET NO.	OF SHEETS	STA.	TO STA.	CONTRACT #: 60K23		
										ILLINOIS FED. AID PROJECT		
										GHA #4085.864		