

F.A.P. RTE.	SECTION	COUNTY	TOTAL SHEETS	SHEET NO.
619	70 RS-5 & I	LASALLE	214	34
STA. 822+50.00 TO STA. 828+00.00				
FED. ROAD DIST. NO. 3 ILLINOIS FED. AID PROJECT				

DATE	BY

DATE	BY

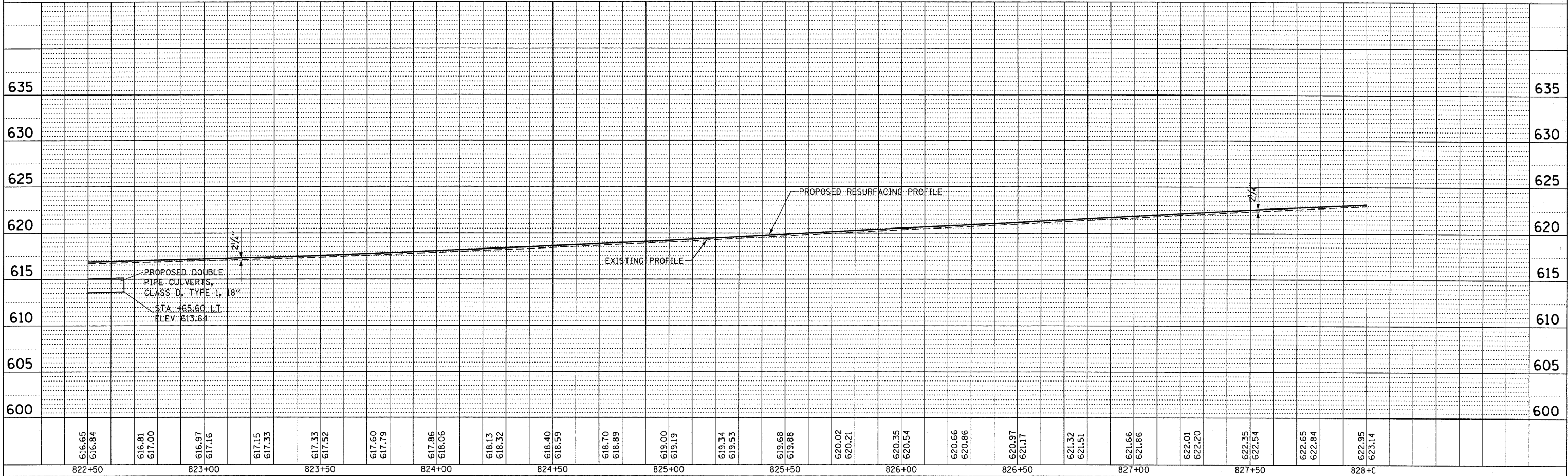
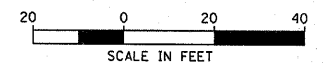
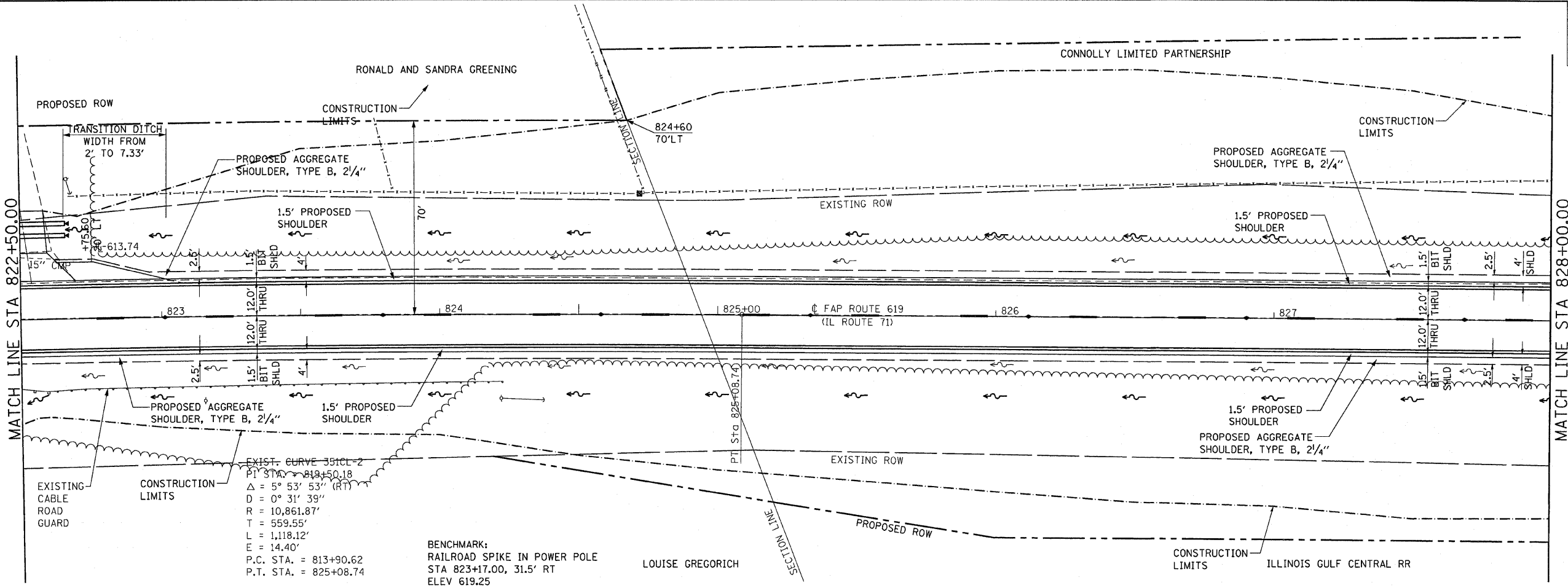

PLAN & PROFILE, FAP ROUTE 619 (IL 71) STA. 822+50.00 TO STA. 828+00.00