

F.A.P. RTE.	SECTION	COUNTY	TOTAL SHEETS	SHEET NO.
619	70 RS-5 & I	LASALLE	214	36
STA. 833+50.00		TO STA. 839+00.00		
FED. ROAD DIST. NO. 3 ILLINOIS FED. AID PROJECT				

PLAN	DATE
REVISION	BY
ALIGNED	
CHECKED	
DATE	

PROFILE	DATE
REVISION	BY
GRADES CHECKED	
STRUCTURE NOTATIONS CHECKED	
DATE	

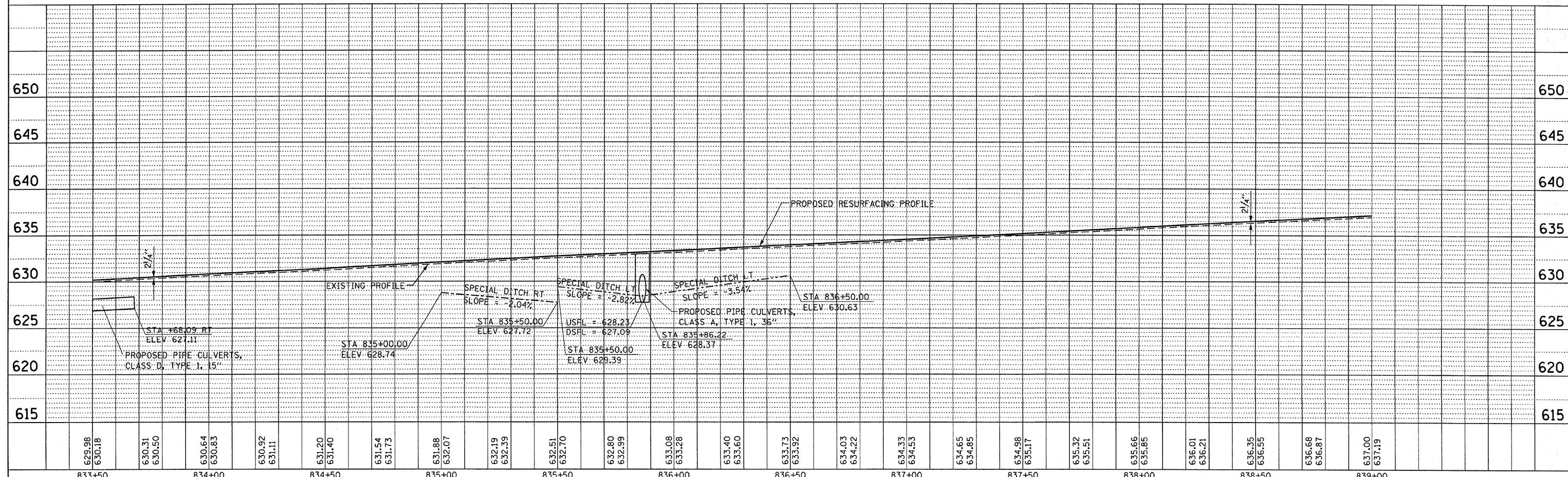
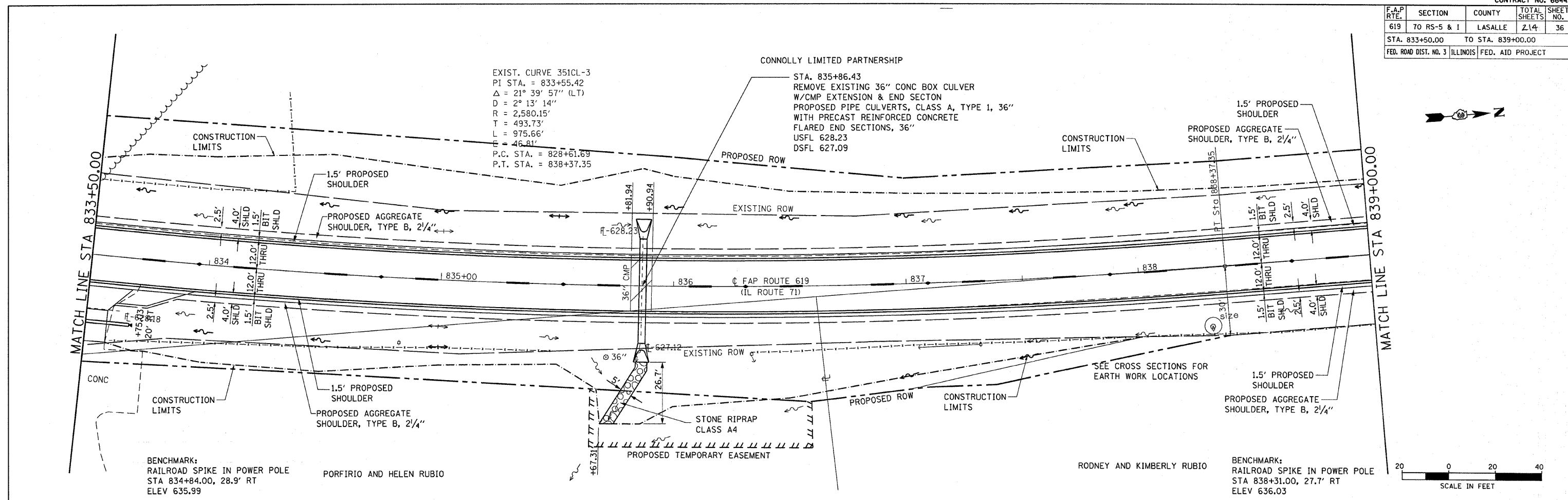

PLAN & PROFILE, FAP ROUTE 619 (IL 71) STA. 833+50.00 TO STA. 839+00.00