

F.A.P. RTE.	SECTION	COUNTY	TOTAL SHEETS	SHEET NO.
619	70 RS-5 & I	LASALLE	214	37
STA. 839+00.00		TO STA. 844+50.00		
FED. ROAD DIST. NO. 3 ILLINOIS FED. AID PROJECT				

PLAN	SURVEYED	DATE
	PLOTTED	BY
	ALIGNED	
	CHECKED	
	DATE	
	FILE NAME	

PROFILE	SURVEYED	DATE
	PLOTTED	BY
	GRADED	
	CHECKED	
	NOTATIONS	
	DATE	
	FILE NAME	

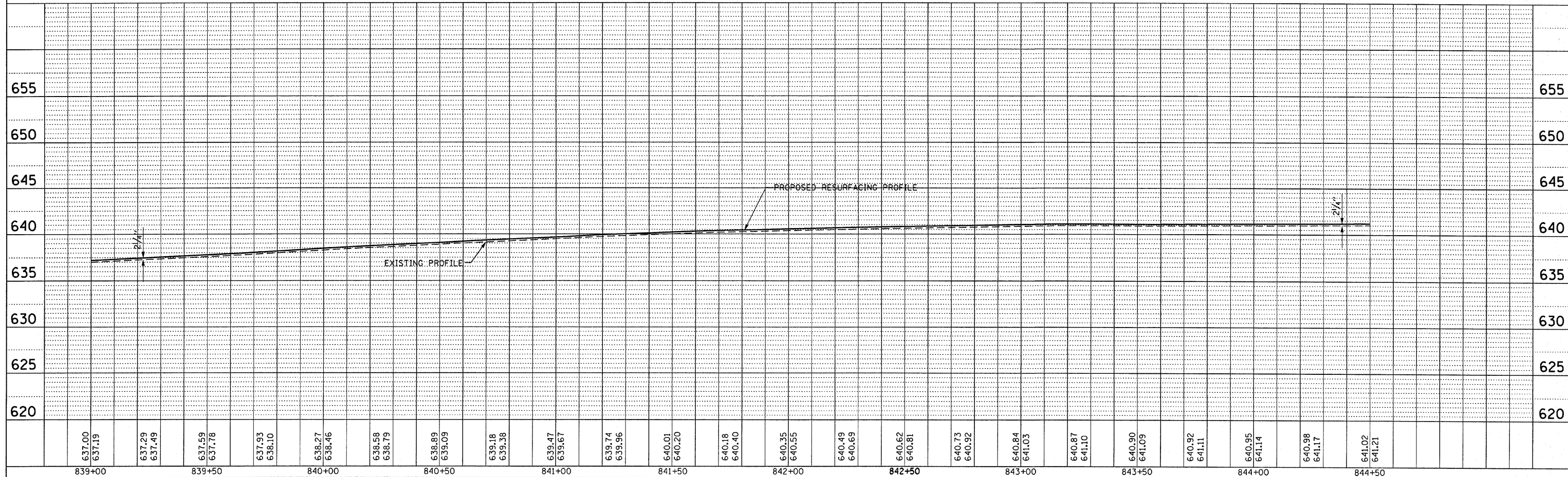
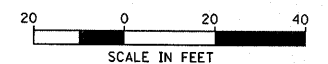
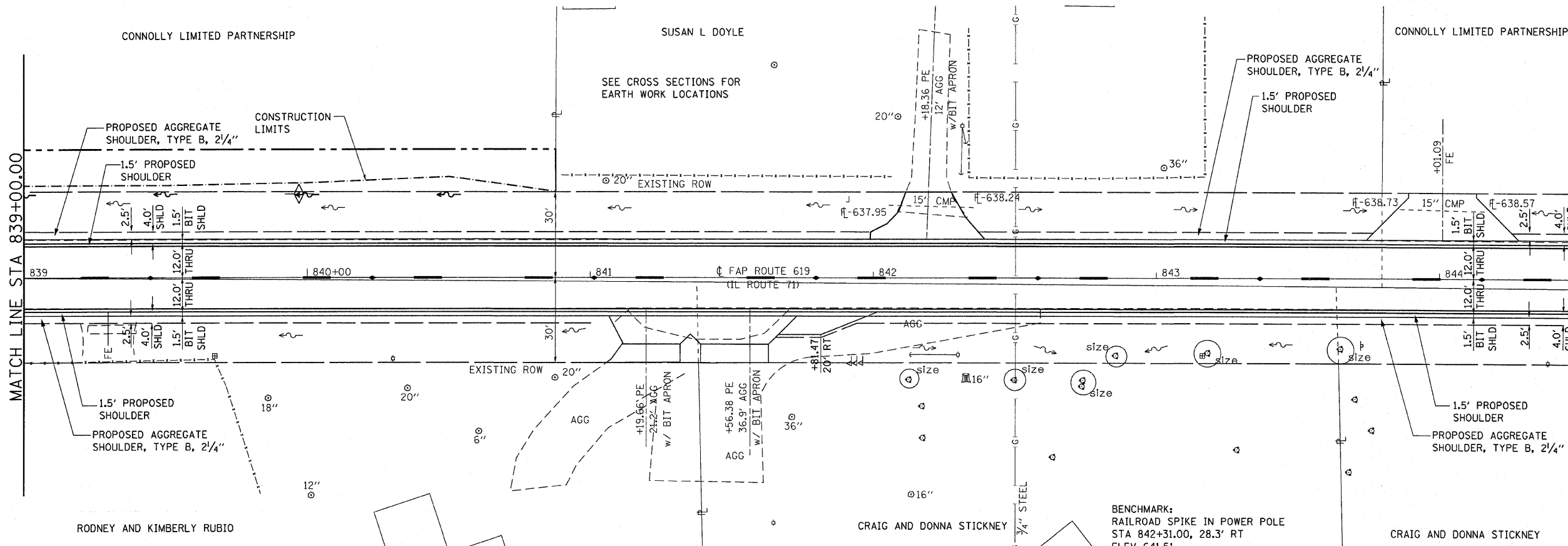

PLAN & PROFILE, FAP ROUTE 619 (IL 71) STA. 839+00.00 TO STA. 844+50.00