

F.A.P. RTE.	SECTION	COUNTY	TOTAL SHEETS	SHEET NO.
619	70 RS-5 & I	LASALLE	214	42
STA. 451+00.00		TO STA. 456+00.00		
FED. ROAD DIST. NO. 3		ILLINOIS FED. AID PROJECT		

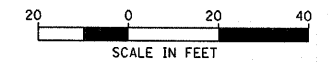
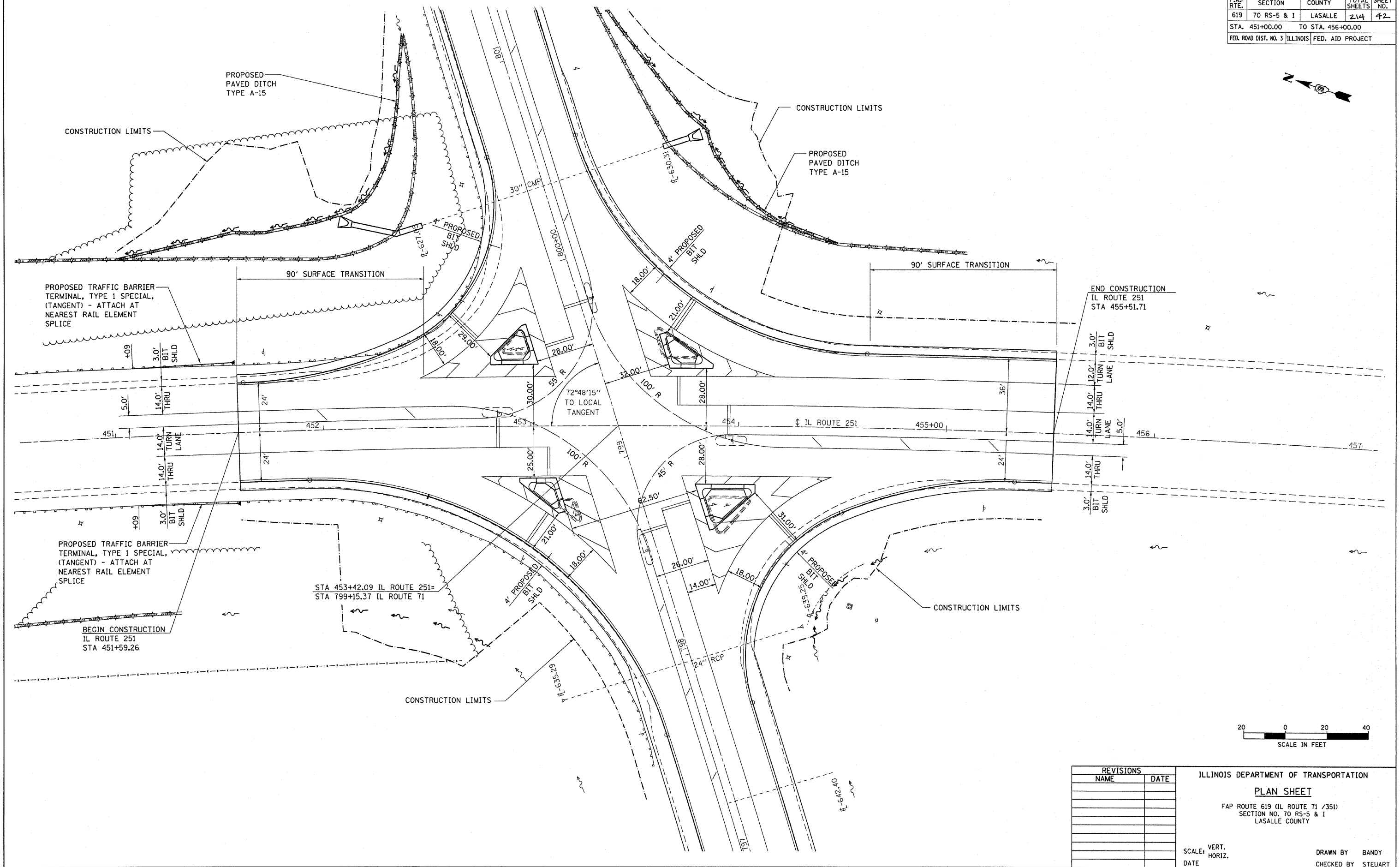

REVISIONS	
NAME	DATE

ILLINOIS DEPARTMENT OF TRANSPORTATION  
**PLAN SHEET**  
 FAP ROUTE 619 (IL ROUTE 71 /351)  
 SECTION NO. 70 RS-5 & I  
 LASALLE COUNTY

SCALE: VERT. \_\_\_\_\_  
 HORIZ. \_\_\_\_\_  
 DATE \_\_\_\_\_  
 DRAWN BY BANDY  
 CHECKED BY STEUART

PLAN, IL ROUTE 251, STA. 451+00.00 TO STA. 456+00.00, FAP ROUTE 619 (IL 71)