

F.A.P. RTE.	SECTION	COUNTY	TOTAL SHEETS	SHEET NO.
619	70 RS-5 & I	LASALLE	214	53
STA. 806+00		TO STA. 817+00.00		
FED. ROAD DIST. NO. 3		ILLINOIS	FED. AID PROJECT	

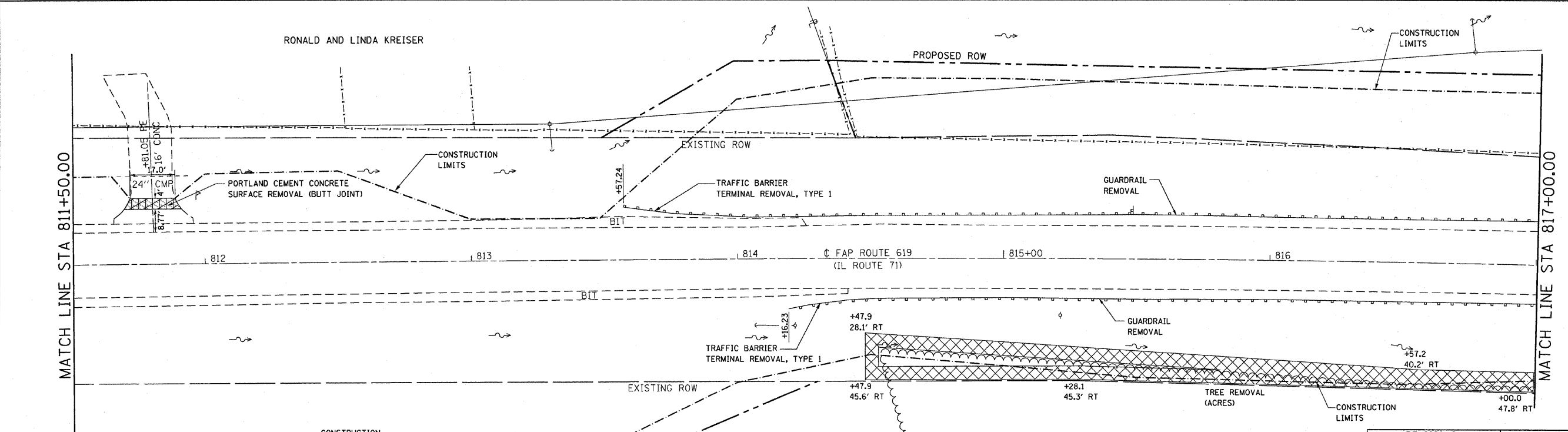
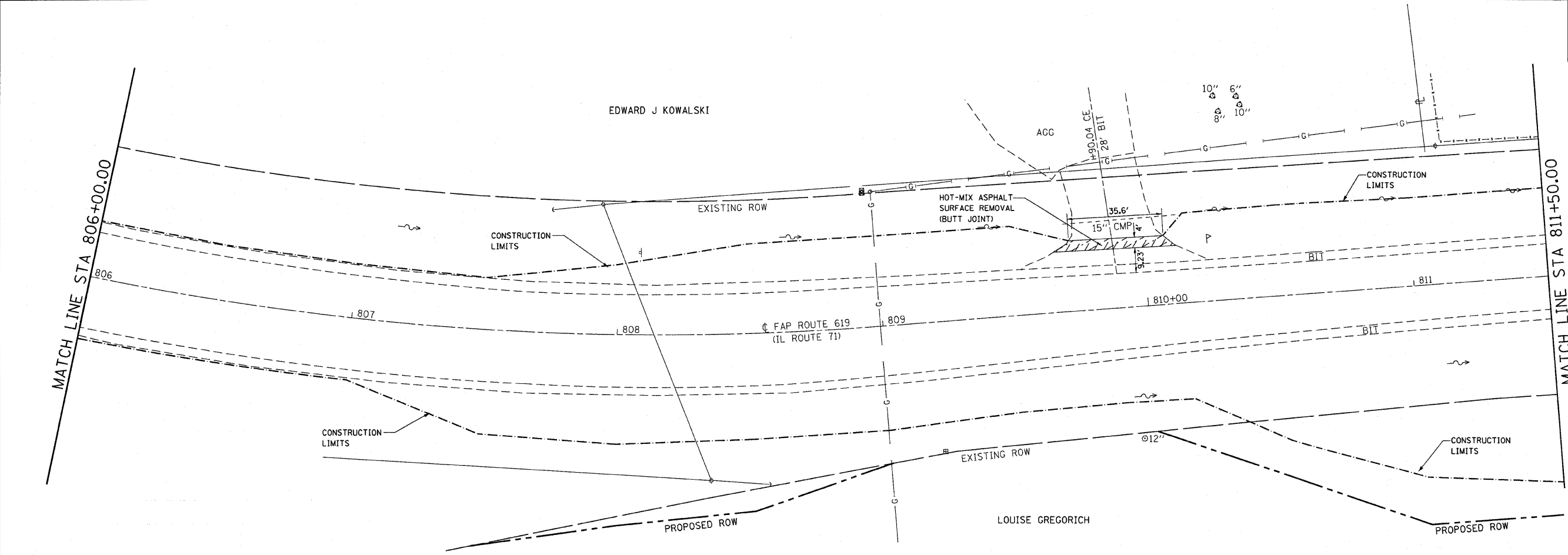

LEGEND

SIDEWALK REMOVAL	DRIVEWAY PAVEMENT REMOVAL	HOT-MIX ASPHALT SURFACE REMOVAL (BUTT JOINT)	TREE REMOVAL
PAVED SHOULDER REMOVAL	PAVEMENT REMOVAL	MEDIAN REMOVAL (PARTIAL DEPTH)	
COMB. CURB & GUTTER REMOVAL	ISLAND REMOVAL	PORTLAND CEMENT CONCRETE SURFACE REMOVAL (BUTT JOINT)	
PAVEMENT REMOVAL (SPECIAL)	CURB REMOVAL	CLASS D PATCHES	

REVISIONS	
NAME	DATE

ILLINOIS DEPARTMENT OF TRANSPORTATION
REMOVAL ITEMS
 FAP ROUTE 619 (IL ROUTE 71 /351)
 SECTION NO. 70 RS-5 & I
 LASALLE COUNTY

SCALE: VERT. _____
 HORIZ. _____
 DATE _____

DRAWN BY BANDY
 CHECKED BY STEUART