

F.A.P. RTE.	SECTION	COUNTY	TOTAL SHEETS	SHEET NO.
619	70 RS-5 & I	LASALLE	214	56
STA. 872+00.00		TO STA. 883+50.00		
FED. ROAD DIST. NO. 3 ILLINOIS FED. AID PROJECT				

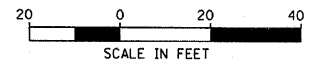
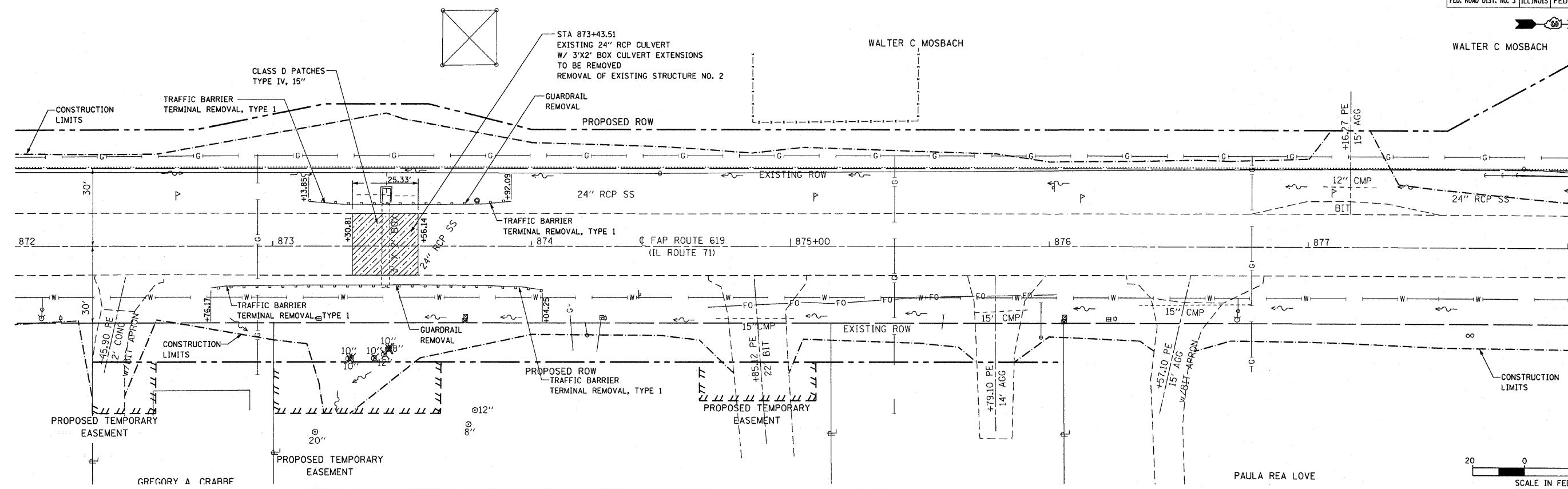

LEGEND

- | | | | |
|-----------------------------|---------------------------|---|--------------|
| SIDEWALK REMOVAL | DRIVEWAY PAVEMENT REMOVAL | HOT-MIX ASPHALT SURFACE REMOVAL (BUTT JOINT) | TREE REMOVAL |
| PAVED SHOULDER REMOVAL | PAVEMENT REMOVAL | MEDIAN REMOVAL (PARTIAL DEPTH) | |
| COMB. CURB & GUTTER REMOVAL | ISLAND REMOVAL | PORTLAND CEMENT CONCRETE SURFACE REMOVAL (BUTT JOINT) | |
| PAVEMENT REMOVAL (SPECIAL) | CURB REMOVAL | CLASS D PATCHES | |

REVISIONS	
NAME	DATE

ILLINOIS DEPARTMENT OF TRANSPORTATION
REMOVAL ITEMS
 FAP ROUTE 619 (IL ROUTE 71 /351)
 SECTION NO. 70 RS-5 & I
 LASALLE COUNTY

SCALE: VERT. _____
 HORIZ. _____
 DATE _____

DRAWN BY BANDY
 CHECKED BY STEUART