

F.A.P. RTE.	SECTION	COUNTY	TOTAL SHEETS	SHEET NO.
619	70 RS-5 & I	LASALLE	214	59
STA. 451+00.00 TO STA. 456+00.00				
FED. ROAD DIST. NO. 3 ILLINOIS FED. AID PROJECT				

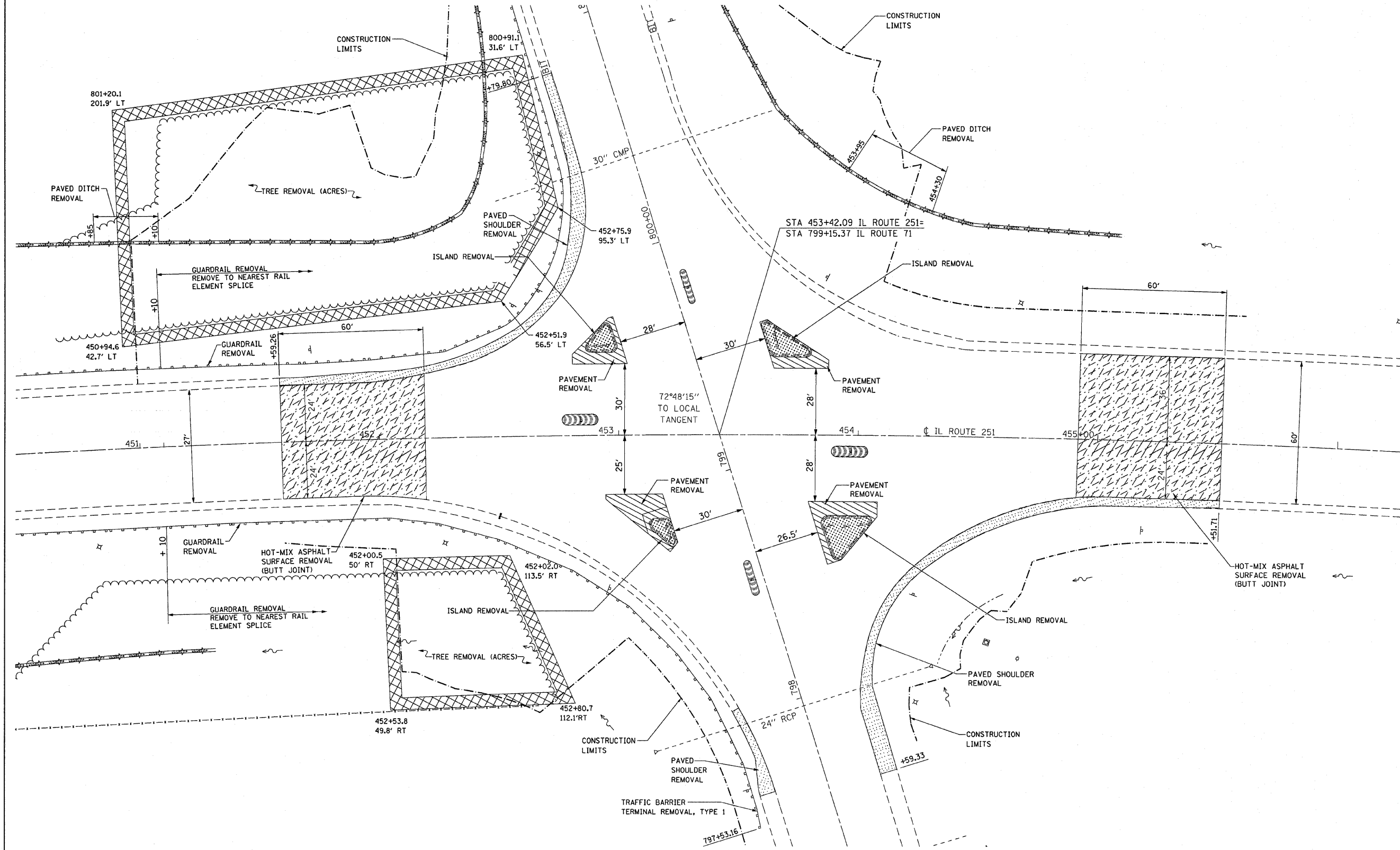

LEGEND

- | | | | | | | | |
|--|-----------------------------|--|---------------------------|--|---|--|--------------|
| | SIDEWALK REMOVAL | | DRIVEWAY PAVEMENT REMOVAL | | HOT-MIX ASPHALT SURFACE REMOVAL (BUTT JOINT) | | TREE REMOVAL |
| | PAVED SHOULDER REMOVAL | | PAVEMENT REMOVAL | | MEDIAN REMOVAL (PARTIAL DEPTH) | | |
| | COMB. CURB & GUTTER REMOVAL | | ISLAND REMOVAL | | PORTLAND CEMENT CONCRETE SURFACE REMOVAL (BUTT JOINT) | | |
| | PAVEMENT REMOVAL (SPECIAL) | | CURB REMOVAL | | CLASS D PATCHES | | |

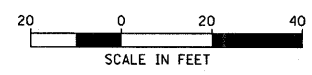

REVISIONS	
NAME	DATE

ILLINOIS DEPARTMENT OF TRANSPORTATION
REMOVAL ITEMS
 FAP ROUTE 619 (IL ROUTE 71 / 351)
 SECTION NO. 70 RS-5 & I
 LASALLE COUNTY

SCALE: VERT. _____
 HORIZ. _____
 DATE _____

DRAWN BY BANDY
 CHECKED BY STEUART

NOTE:
 EXISTING PAVED DITCH THAT WILL BE COVERED WITH EMBANKMENT SHALL BE BROKEN INTO PIECES IN ACCORDANCE WITH ARTICLE 205.03 OF THE STANDARD SPECIFICATIONS.