

F.A. RTE.	SECTION	COUNTY	TOTAL SHEETS	SHEET NO.
619	70 RS-5 & I	LASALLE	214	157
STA. 900+10.00		TO STA. 900+50.51		
FED. ROAD DIST. NO.		ILLINOIS FED. AID PROJECT		

FINAL SURVEY	SURVEYED	DATE
NOTE BOOK	PLOTTED	
NO.	TEMPLATE	
	AREAS CHECKED	

ORIGINAL SURVEY	SURVEYED	DATE
NOTE BOOK	PLOTTED	
NO.	TEMPLATE	
	AREAS CHECKED	

PLOT DATE = Aug 23, 2018 - 8:42:45 PM
 FILE NAME = c:\york\work\p1\cadd\lber\gntuno\p1\66442\900+10.00.dwg
 USER NAME = lber\gntuno

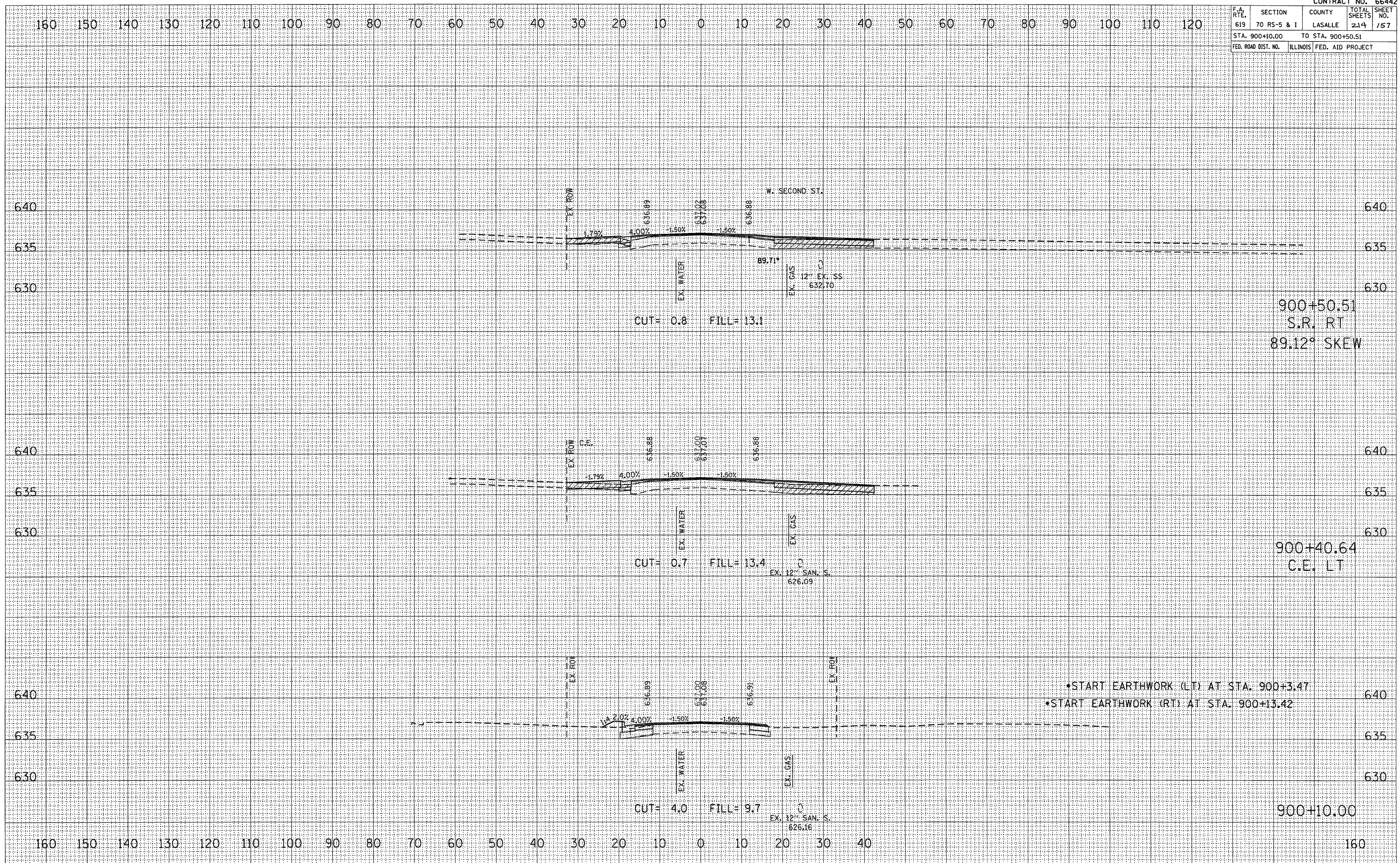

CROSS SECTION, STA 900+10.00 TO 900+50.51, FAP ROUTE 619 (IL 71)