

F.A. RTE.	SECTION	COUNTY	TOTAL SHEETS	SHEET NO.
619	70 RS-5 & I	LASALLE	214	158
STA. 900+55.00		TO STA. 900+65.16		
FED. ROAD DIST. NO.	ILLINOIS	FED. AID PROJECT		

FINAL SURVEY	SURVEYED	BY	DATE
NOTE BOOK	PLOTTED		
NO.	TEMPLATE		
	AREAS		
	CHECKED		

ORIGINAL SURVEY	SURVEYED	BY	DATE
NO.	PLOTTED		
	AREAS		
	CHECKED		

PLOT DATE = Aug 23, 2018 - 04:21:35 PM
 FILE NAME = c:\pwork\kudat\bergentino\66442\158.dwg
 USER NAME = bergentino

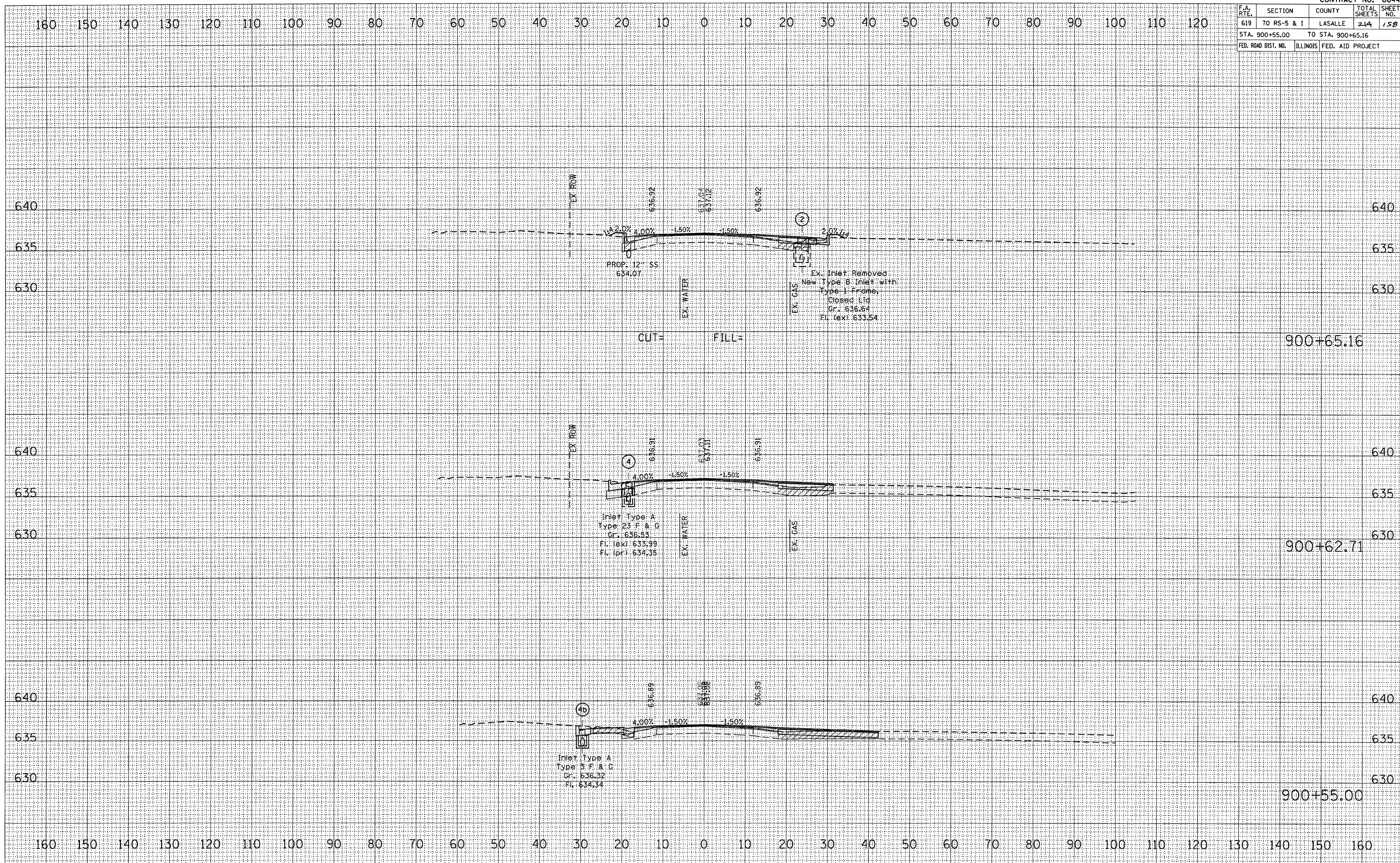

CROSS SECTION, STA 900+55.00 TO 900+65.16, FAP ROUTE 619 (IL 71)