

F.A. RTE.	SECTION	COUNTY	TOTAL SHEETS	SHEET NO.
619	70 RS-5 & I	LASALLE	214	162
STA. 902+23.86		TO STA. 902+60.96		
FED. ROAD DIST. NO.	ILLINOIS	FED. AID PROJECT		

FINAL SURVEY	SURVEYED	DATE
NOTE BOOK	PLOTTED	
NO.	TEMPLATE	
	AREAS	
	CHECKED	

ORIGINAL SURVEY	SURVEYED	DATE
NO.	PLOTTED	
	TEMPLATE	
	AREAS	
	CHECKED	

PLOT DATE = Aug 23, 2018 - 04:18:27 PM
 FILE NAME = c:\p-work\projects\bergenton\p\902+23.86.dwg
 USER NAME = bergenton

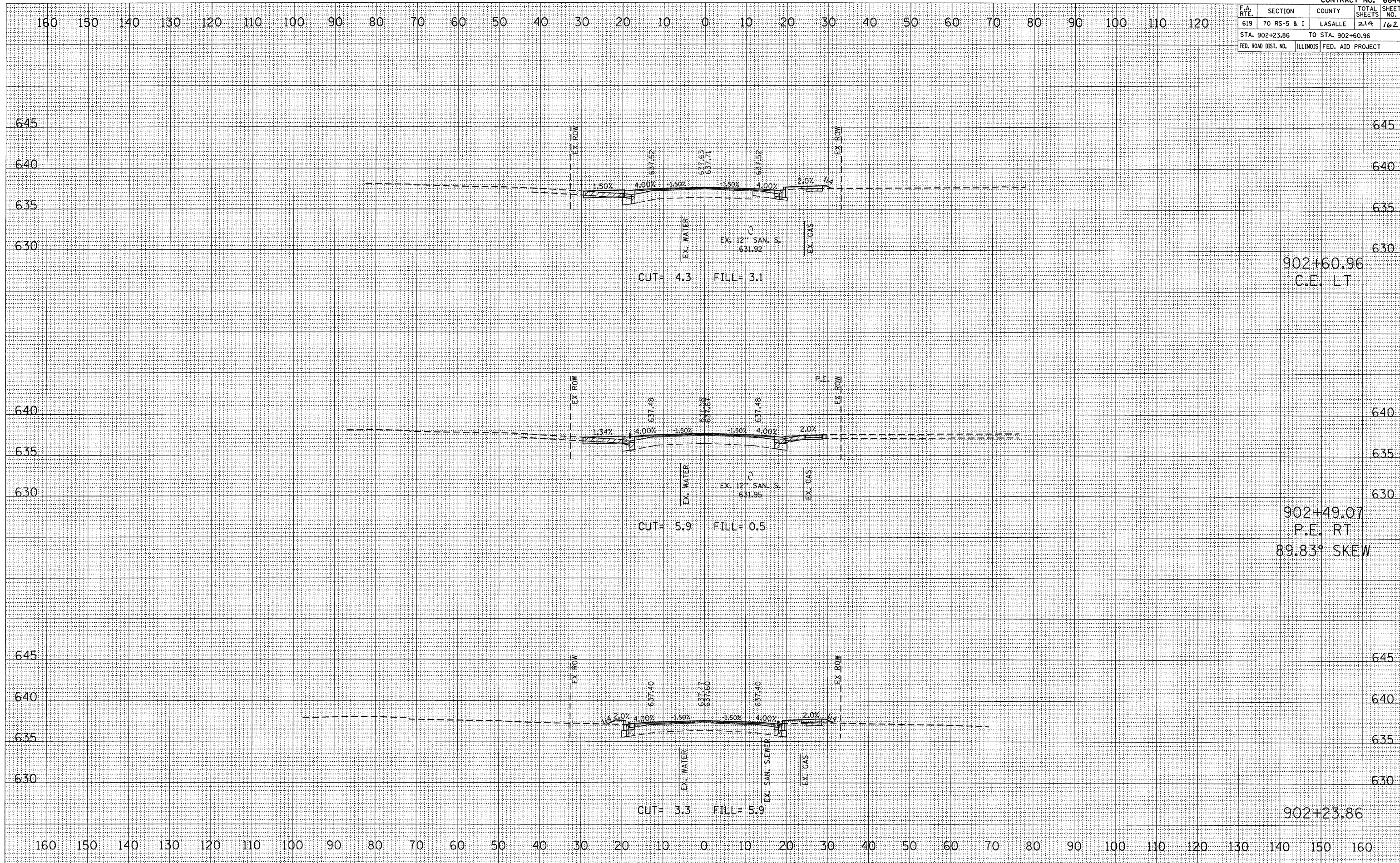

CROSS SECTION, STA 902+23.86 TO 902+60.96, FAP ROUTE 619 (IL 71)