

F.A. RTE.	SECTION	COUNTY	TOTAL SHEETS	SHEET NO.
619	70 RS-5 & I	LASALLE	214	163
STA. 902+73.80		TO STA. 903+03.53		
FED. ROAD DIST. NO.	ILLINOIS	FED. AID PROJECT		

FINAL SURVEY	SURVEYED	DATE
NOTE BOOK NO.	PLOTTED	
	TEMPLATE	
	AREAS CHECKED	

ORIGINAL SURVEY	SURVEYED	DATE
	PLOTTED	
	AREAS CHECKED	

PLOT DATE = Aug 23, 2010 - 04:18:16 PM  
 FILE NAME = c:\pwworkspace\bergentingje\project\902+73.80.dwg  
 USER NAME = bergentingje

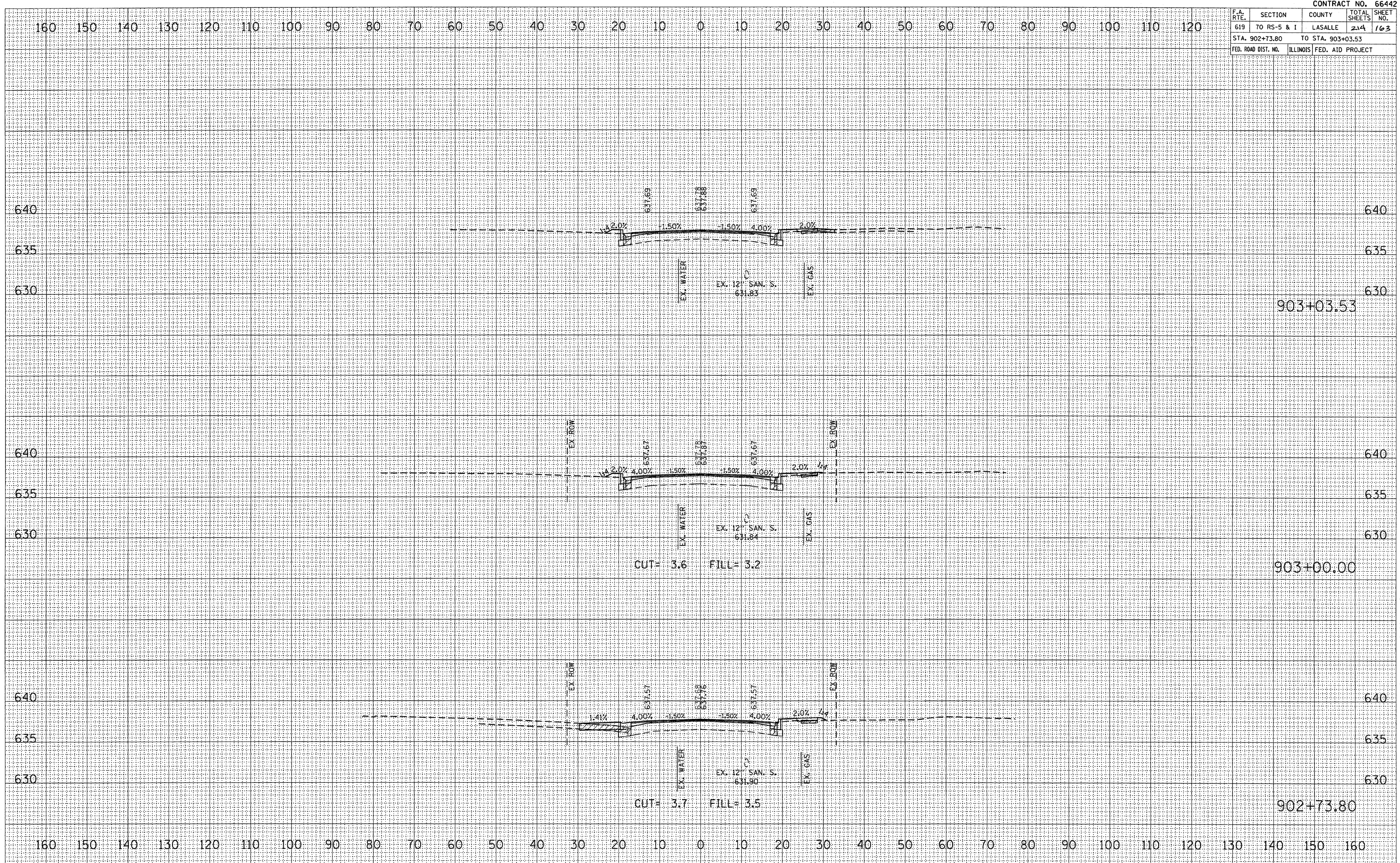

CROSS SECTION, STA 902+73.80 TO 903+03.53, FAP ROUTE 619 (IL 71)