

F.A. RTE.	SECTION	COUNTY	TOTAL SHEETS	SHEET NO.
619	70 RS-5 & I	LASALLE	214	166
STA. 904+56.55		TO STA. 904+65.00		
FED. ROAD DIST. NO.	ILLINOIS	FED. AID PROJECT		

DATE	
BY	
FINAL SURVEY	
SURVEY PLOTTED	
NOTE BOOK	
AREAS CHECKED	
NO.	

DATE	
BY	
ORIGINAL SURVEY	
SURVEY PLOTTED	
NOTE BOOK	
AREAS CHECKED	
NO.	

PLOT DATE = Aug 23, 2010 - 04:12:23 PM
 FILE NAME = c:\pwork\pudot\borger\map\img\904+56.55.dwg
 USER NAME = borger

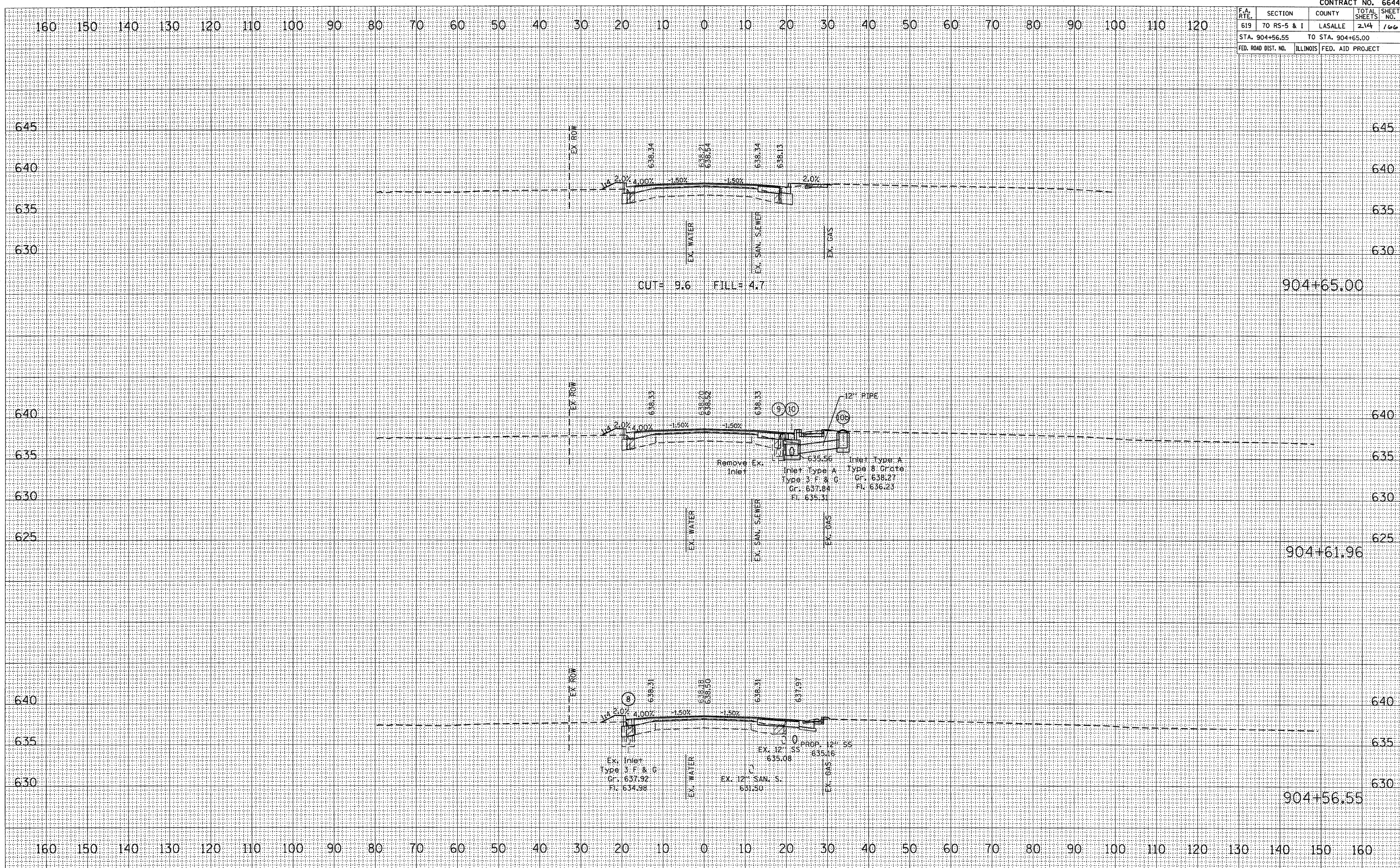

CROSS SECTION, STA 904+56.55 TO 904+65.00 FAP ROUTE 619 (IL 71)