

F.A. RTE.	SECTION	COUNTY	TOTAL SHEETS	SHEET NO.
619	70 RS-5 & I	LASALLE	214	167
STA. 905+00.00		TO STA. 905+42.16		
FED. ROAD DIST. NO.		ILLINOIS	FED. AID PROJECT	

BY	DATE

FINAL SURVEY	SURVEYED	PLOTTED	DATE

BY	DATE

ORIGINAL SURVEY	SURVEYED	PLOTTED	DATE

PLOT DATE = Aug 23, 2010 - 04:12:04 PM
 FILE NAME = c:\pwworkspace\pwworkspace\66442\66442.dwg
 USER NAME = bergmanjg

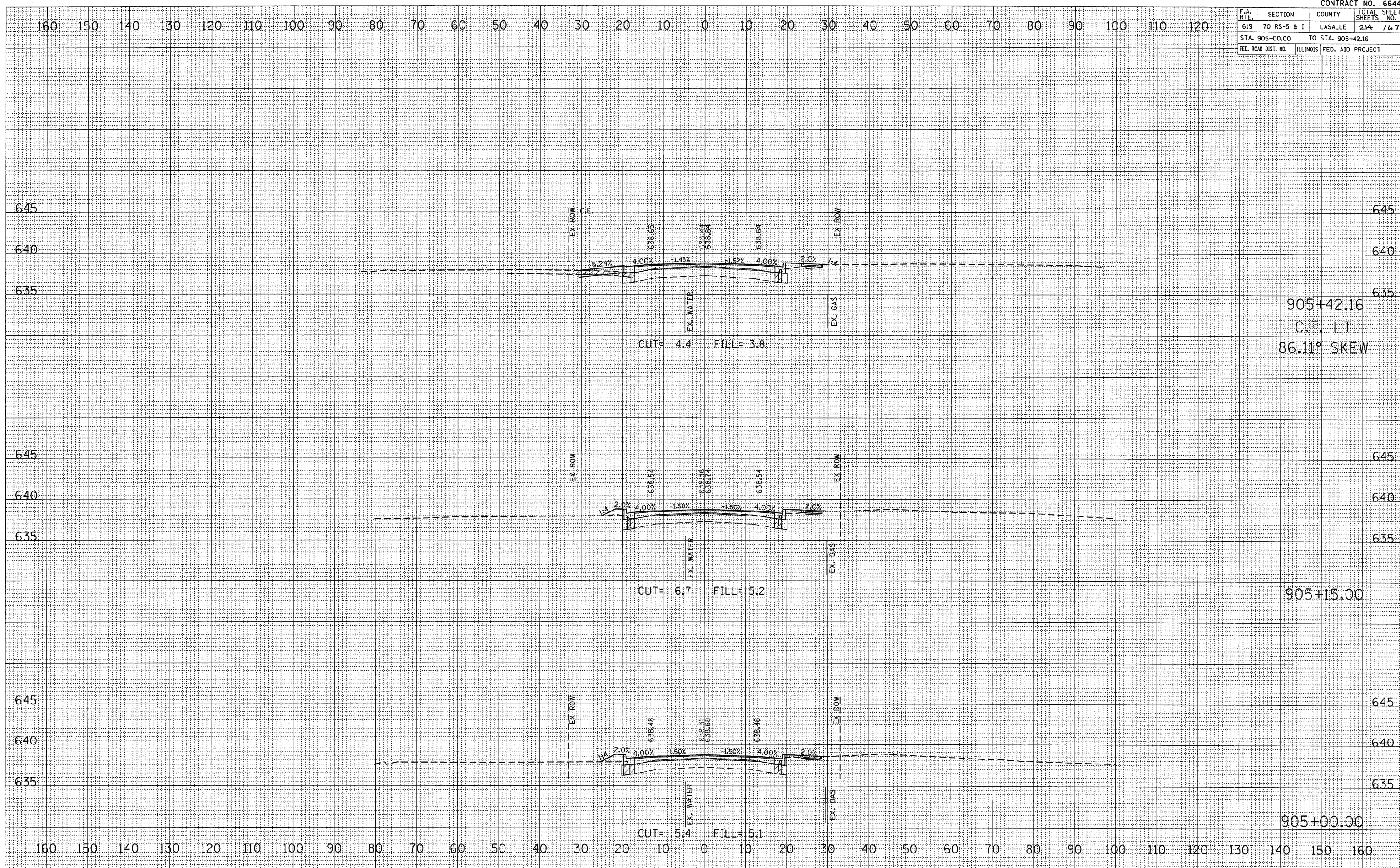

CROSS SECTION, STA 905+00.00 TO 905+42.16, FAP ROUTE 619 (IL 71)