

F.A. RTE.	SECTION	COUNTY	TOTAL SHEETS	SHEET NO.
619	70 RS-5 & I	LASALLE	214	177
STA. 911+46.00		TO STA. 911+75.00		
FED. ROAD DIST. NO.		ILLINOIS	FED. AID PROJECT	

DATE	
BY	
FINAL SURVEY	SURVEYED
NOTE BOOK	PLOTTED
NO.	AREAS CHECKED

DATE	
BY	
ORIGINAL SURVEY	SURVEYED
NO.	PLOTTED
	AREAS CHECKED

PLOT DATE = Aug 23, 2018 - 04:04:33 PM
 FILE NAME = c:\pwworkspace\bergtano\p...
 USER NAME = bergtanoj

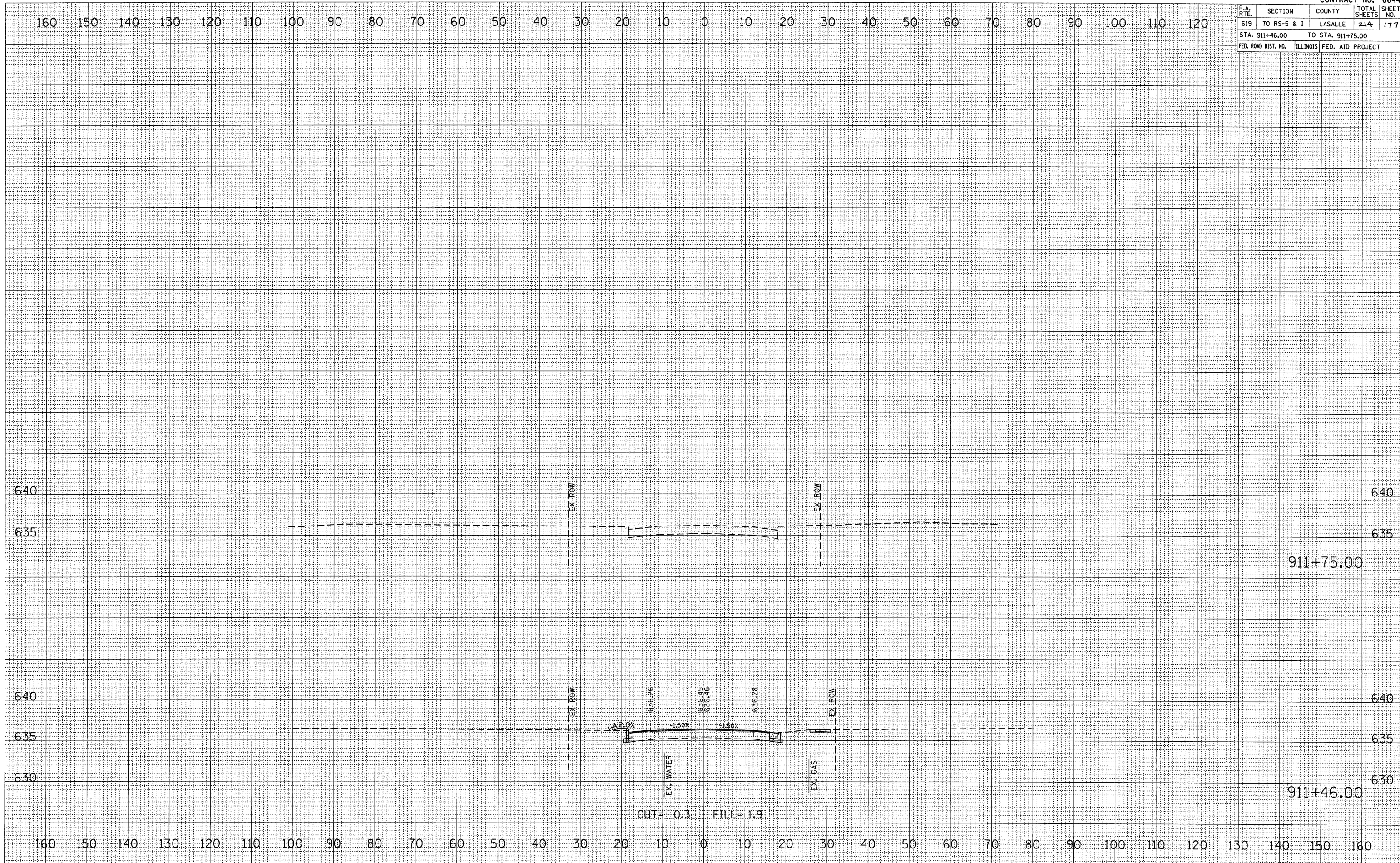

CROSS SECTION, STA 911+46.00 TO 911+75.00, FAP ROUTE 619 (IL 71)