

TA006

REVISIONS		
NUMBER	BY	DATE

0 1 2
 THIS BAR IS EQUAL TO 2"
 AT FULL SCALE (34X22).

**TAYLORVILLE MUNICIPAL AIRPORT
 TAYLORVILLE, ILLINOIS
 REHABILITATE NORTH PORTION OF AIRCRAFT PARKING APRON
 PROPOSED IMPROVEMENTS**

© Copyright CMT, Inc.

CMT
 CRAWFORD, MURPHY & TILLY, INC.
 CONSULTING ENGINEERS
 License No. 184-000613

DESIGN BY:	AJH
DRAWN BY:	CMT
CHECKED BY:	CET
APPROVED BY:	CET
DATE:	NOVEMBER 14, 2014
JOB No:	13050-01
IL PROJ. NO.	TAZ-4342
SBG NO.	3-17-SBGP-XX
SHEET	08 OF 14 SHEETS

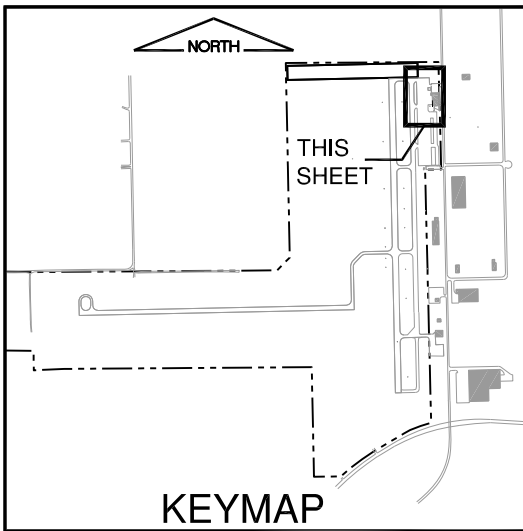

NOTE:
 A QUANTITY OF 500 SY OF AR152511
 SUBGRADE REPAIR HAS BEEN
 INCLUDED IN THE PROJECT TO BE USED
 AS NEEDED OR AS DESIGNATED BY THE
 RESIDENT ENGINEER.

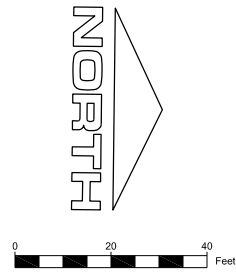

LEGEND

	PROPOSED LIMITS OF IMPROVEMENTS
	PROPOSED 6" P.C.C. PAVEMENT (501) PROPOSED 6" CRUSHED AGGREGATE BASE COURSE (209)
	PROPOSED 2" BITUMINOUS SURFACE COURSE OVERLAY (401) PROPOSED TACK COAT (603)
	PROPOSED BUTT JOINT CONSTRUCTION (401)
	PROPOSED 4" BITUMINOUS SURFACE COURSE (401) PROPOSED 6" CRUSHED AGGREGATE BASE COURSE (209) PROPOSED UNCLASSIFIED EXCAVATION (152)
XX	PROPOSED CLASS E FENCE 4' (162)
A	TYPE A ISOLATION JOINT (3/4")
B	TYPE B HINGED (TIED) CONTRACTION JOINT
C	TYPE C DOWELED CONTRACTION JOINT
D	TYPE D DUMMY CONTRACTION JOINT
E	TYPE E DOWELED CONSTRUCTION JOINT
T	THICKENED EDGE

North Apron - West Edge
 STA. = 501+15.98
 OFF. = -148.79
**CONTROL POINT #1
 SURVEY MONUMENT
 N: 1046546.540
 E: 2533418.600
 ELEV: 613.45'**

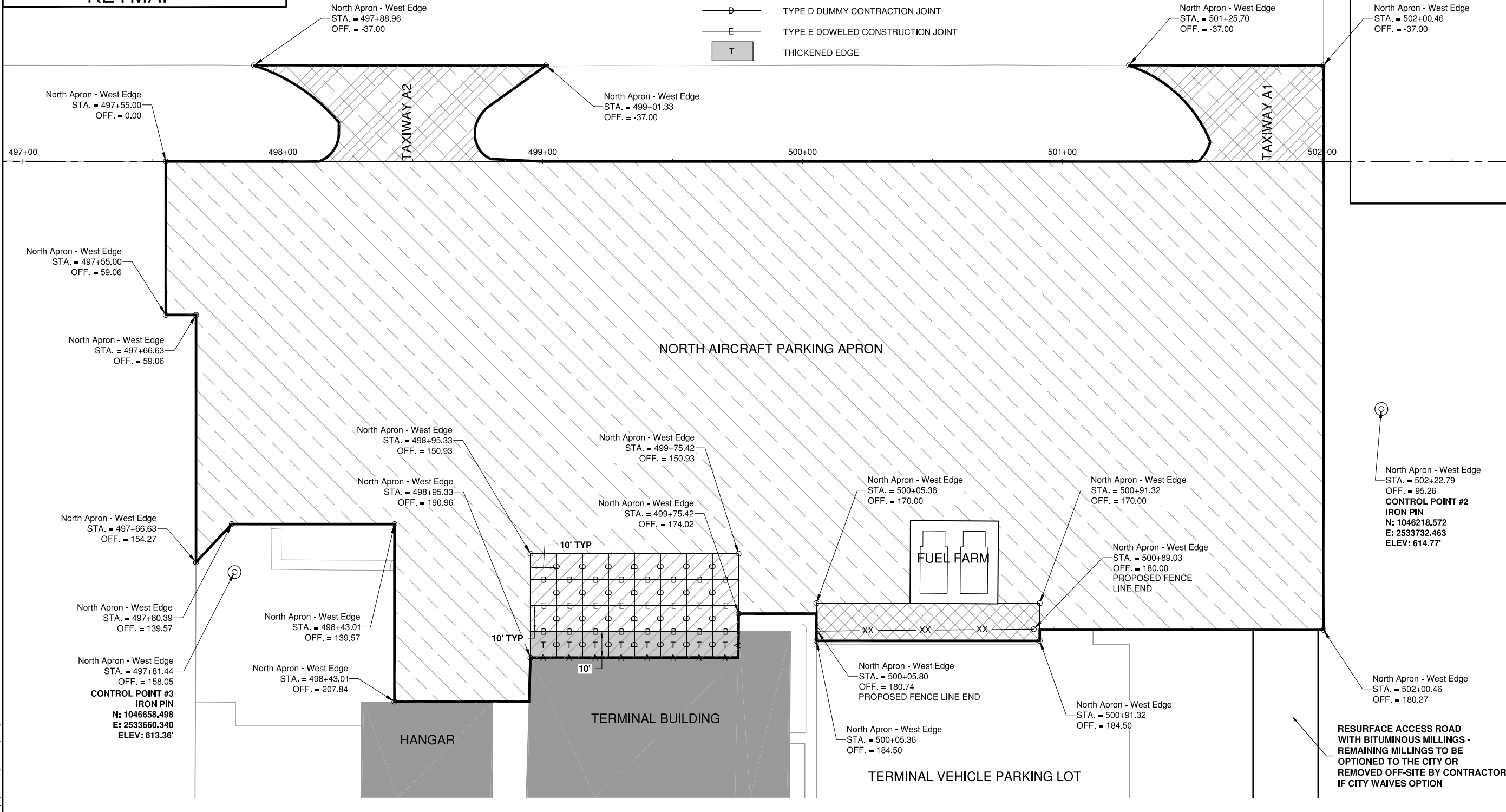

RESURFACE ACCESS ROAD
 WITH BITUMINOUS MILLINGS -
 REMAINING MILLINGS TO BE
 OPTIONED TO THE CITY OR
 REMOVED OFF-SITE BY CONTRACTOR
 IF CITY WAIVES OPTION