

STATE OF ILLINOIS
DEPARTMENT OF TRANSPORTATION

EXISTING STRUCTURE DATA

The existing structures are two similar bridges carrying Northbound and Southbound I-290 traffic over York Rd. Each structure is a four span continuous non-composite beam bridge and carries two mainline and two ramp lanes of traffic. Each structure is 180'-1/2" back to back of abutment.

The original structures were built in 1952 and 1963. In 1965, the substructures were rehabilitated and widened, and new steel beams were erected along the median to carry one additional lane of traffic. Its present condition has the exposed steel beams without the deck.

CONSTRUCTION CONTRACT

This construction contract is the second and last one required for the widening and rehabilitation for this bridge project.

In the first contract, the sub-structures were widened and repaired, and new steel beams were erected along the median.

In this contract, a new deck is added for the new traffic lane, part of the deck at the outside shoulder and the open joint in the deck are replaced, and the remainder of the original deck is patched and overlaid. The original structure will also have its bearings and expansion joints at the abutments replaced.

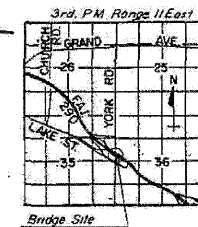
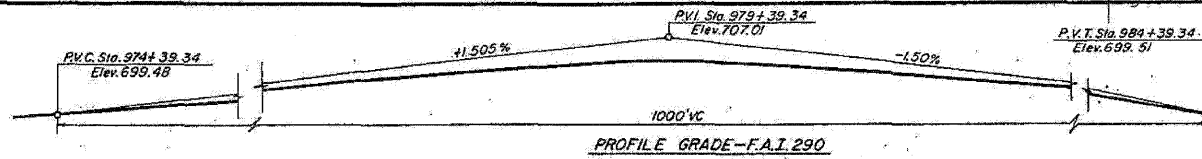

ROUTE NO.	SECTION	COUNTY	TOTAL SHEETS	SHEET NO.	SHEET NO. OF 14 SHEETS
FAI 290	1984-083R	DUPAGE	276	166	
FED. ROAD DIST. NO. 7	ILLINOIS	FEDERAL AID PROJECT NO.			

STATION 979+19.39
REBUILT 19... BY
STATE OF ILLINOIS
F.A.I. RT. 290 SEC. 1984-083R
F.A. PROJ. ACIX-290-3(3-4)
LOADING H5EO B ALT.
STR. NO.

Notes:
Structure Number is 022-0006 for the southbound bridge, and 022-0006 for the northbound bridge.
See Standard 2113.
NEW NAME PLATE

NOTES:
The information shown on this sheet concerning type and location of utilities is not guaranteed to be accurate or all inclusive. The contractor is responsible for making his own determinations as to the type and location of underground and other utilities as may be necessary to avoid damage there to.
Existing light poles shall be removed from the existing edge of deck and be disposed of as directed by the Engineer (cost incidental).

- Legend:**
- 3" G — Indicates existing 3" Gas Line
 - W — Indicates existing Water Line
 - ⊙ — Indicates location of new 6" floor drain
 - ➡ — Indicates direction of traffic lane
 - ⊙ — Indicates existing light pole
 - — — — — Indicates existing structure (in plan view)
 - — — — — Indicates new construction (in plan view)

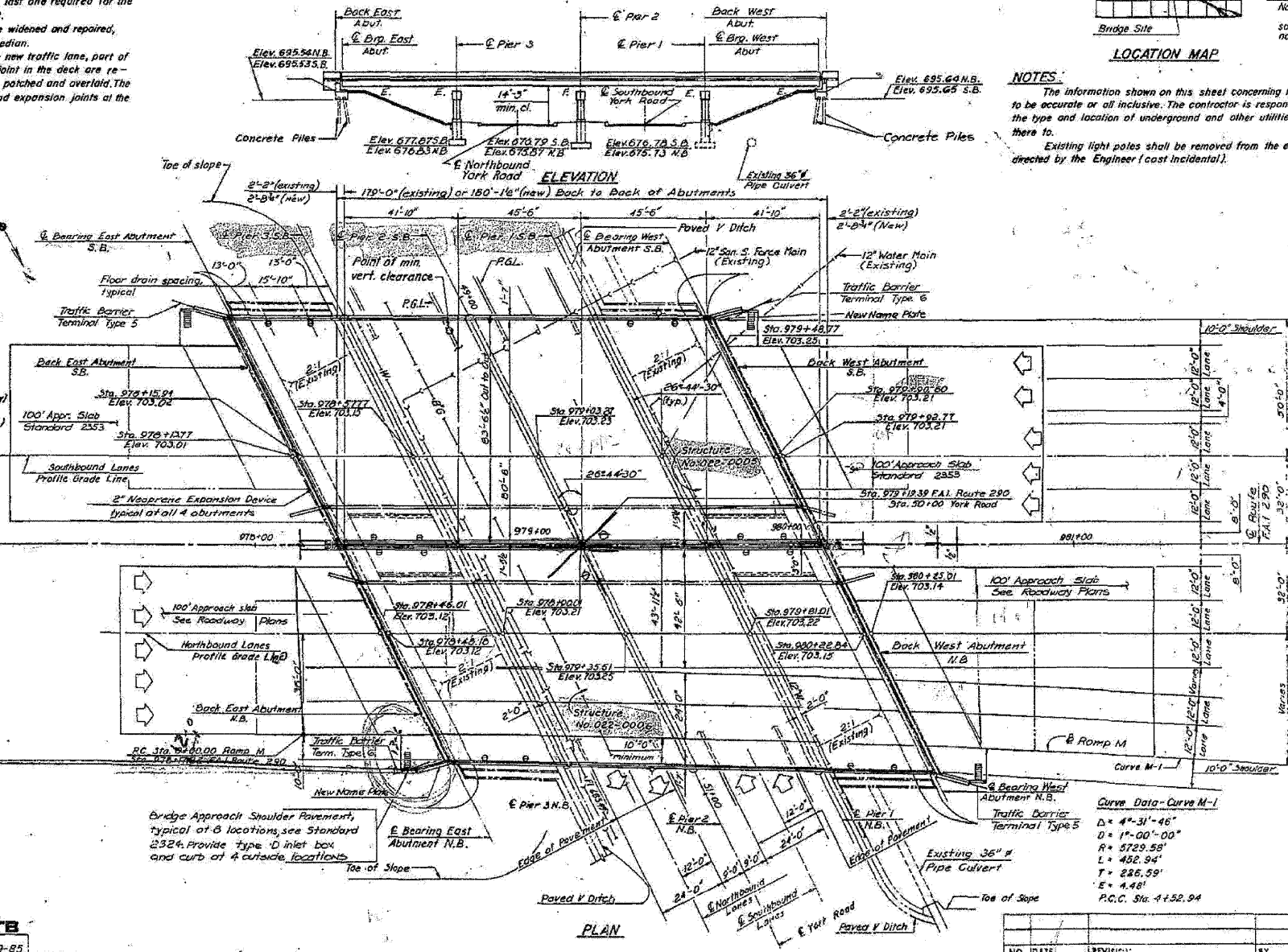

APPROVED
FOR STRUCTURAL AGENCY ONLY
James J. Fawcett
Engineer of Bridge Structures

I hereby certify that to the best of my knowledge, information and belief that these plans and specifications are correct and structurally adequate for the design loading shown on the plans and complies with all the current requirements.

Signed: *Raymond F. Pusczan* Date: 5-30-95
Raymond F. Pusczan
S.E. Ill. Reg. No. 2495



STATE OF ILLINOIS
DEPARTMENT OF TRANSPORTATION
GENERAL PLAN AND ELEVATION
F.A.I. ROUTE 290, DUPAGE COUNTY
SECTION 1984-083R
STA. 979+19.39
INTERSTATE ROUTE 290 OVER
YORK ROAD

HOWARD NERDLES TAMMEN & BERGENHOOP **HNTB**
MADE B.S.B. DATE 8-27-91 CHECKED R.F.P. DATE 5-29-95

FOR INFORMATION ONLY

benesch
alfred benesch & company
Engineers • Surveyors • Planners
205 North Michigan Avenue, Suite 2400
Chicago, Illinois 60601
312-565-0450 Job No. 10050

SHEET NO. 18	F.A.I. RTE. 290	SECTION 2009-099 BR	COUNTY COOK/DUPAGE	TOTAL SHEETS 309	SHEET NO. 237
25 SHEETS	CONTRACT NO. 60157		FED. ROAD DIST. NO. ILLINOIS FED. AID PROJECT		

EXISTING PLAN INFORMATION 1 OF 10
STRUCTURE NO. 022-0006

11/12/2009 18:41:18 x:\100005\10050\engineer\ing_documents_contract\1\SN_022-0006-0005-York_Rd\0006-60051-018-Existplan-01.dgn