

STATE OF ILLINOIS
DEPARTMENT OF TRANSPORTATION

F.A.U. RTE.	SECTION	COUNTY	TOTAL SHEETS	SHEET NO.
*	33PP-1, 10-PP-1, 10-1RS-2	ST CLAIR	15	1
		ILLINOIS	CONTRACT NO. 76U67	

* 9185 / 9183

PROPOSED HIGHWAY PLANS

**FAU ROUTE 9185 / 9183
(MLK DR, LOUISIANA BLVD AND LAKE DR.)
SECTIONS 33PP-1, 10-PP-1, 10-1RS-2
PATCHING & SLURRY SEAL - CM
ST CLAIR COUNTY**

C-98-131-25

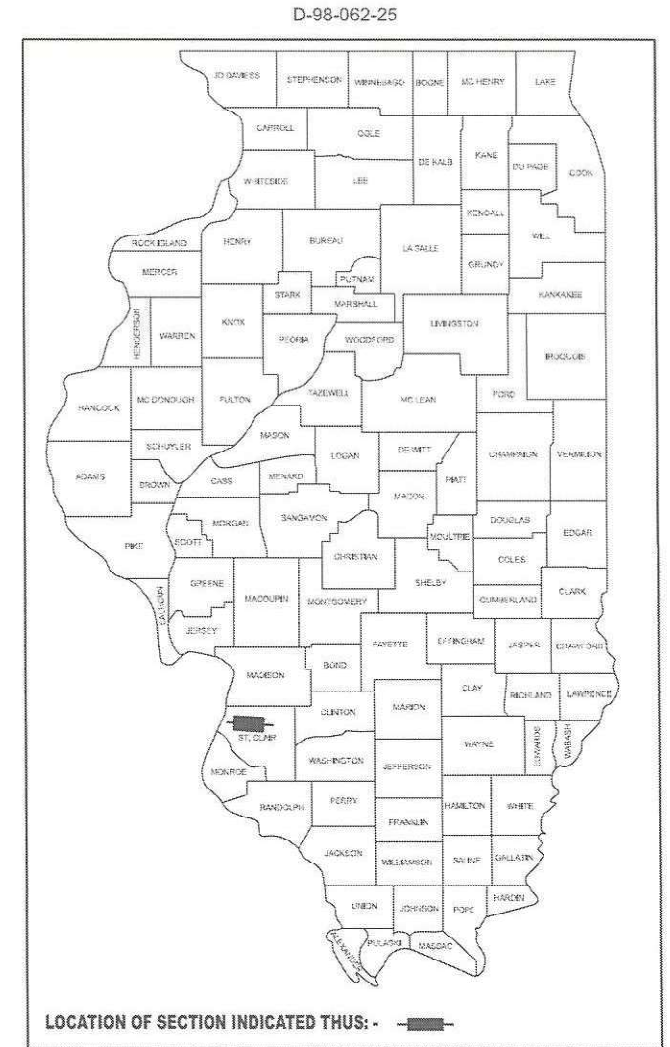

FOR INDEX OF SHEETS, SEE SHEET NO. 2

**TRAFFIC DATA
MLK DR**

2023 ADT = 2250 (ACTUAL)
2026 ADT = 2300 (ESTIMATED)
2046 ADT = 2650 (ESTIMATED)
SU = 3.6% MU = 2.7%

LOUISIANA BLVD FROM 23RD ST TO 28TH STREET

2023 ADT = 2600 (ACTUAL)
2026 ADT = 2650 (ESTIMATED)
2046 ADT = 3050 (ESTIMATED)
SU = 3.5% MU = 2.3%

LOUISIANA BLVD / LAKE DRIVE FROM 28TH ST TO IL 111 JUNCTION

2023 ADT = 2850 (ACTUAL)
2026 ADT = 2900 (ESTIMATED)
2046 ADT = 3350 (ESTIMATED)
SU = 2.5% MU = 1.4%

LAKE DRIVE FROM IL 111 JUNCTION TO IL 157 JUNCTION

2023 ADT = 3750 (ACTUAL)
2026 ADT = 3800 (ESTIMATED)
2046 ADT = 4400 (ESTIMATED)
SU = 2.1% MU = 1.1%

FUNCTIONAL CLASSIFICATION: MAJOR COLLECTOR

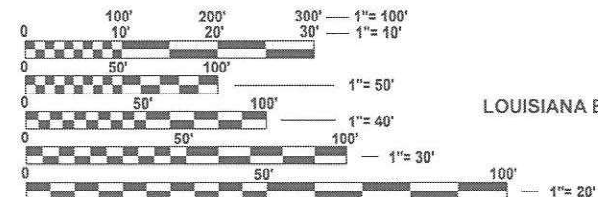

FULL SIZE PLANS HAVE BEEN PREPARED USING STANDARD ENGINEERING SCALES. REDUCED SIZED PLANS WILL NOT CONFORM TO STANDARD SCALES. IN MAKING MEASUREMENTS ON REDUCED PLANS, THE ABOVE SCALES MAY BE USED.

J.U.L.I.E.
JOINT UTILITY LOCATION INFORMATION FOR EXCAVATION
1-800-892-0123
OR 811

**PROJECT ENGINEER: BILLIE OWEN
PROJECT MANAGER: MIKE BERG**

CONTRACT NO. 76U67

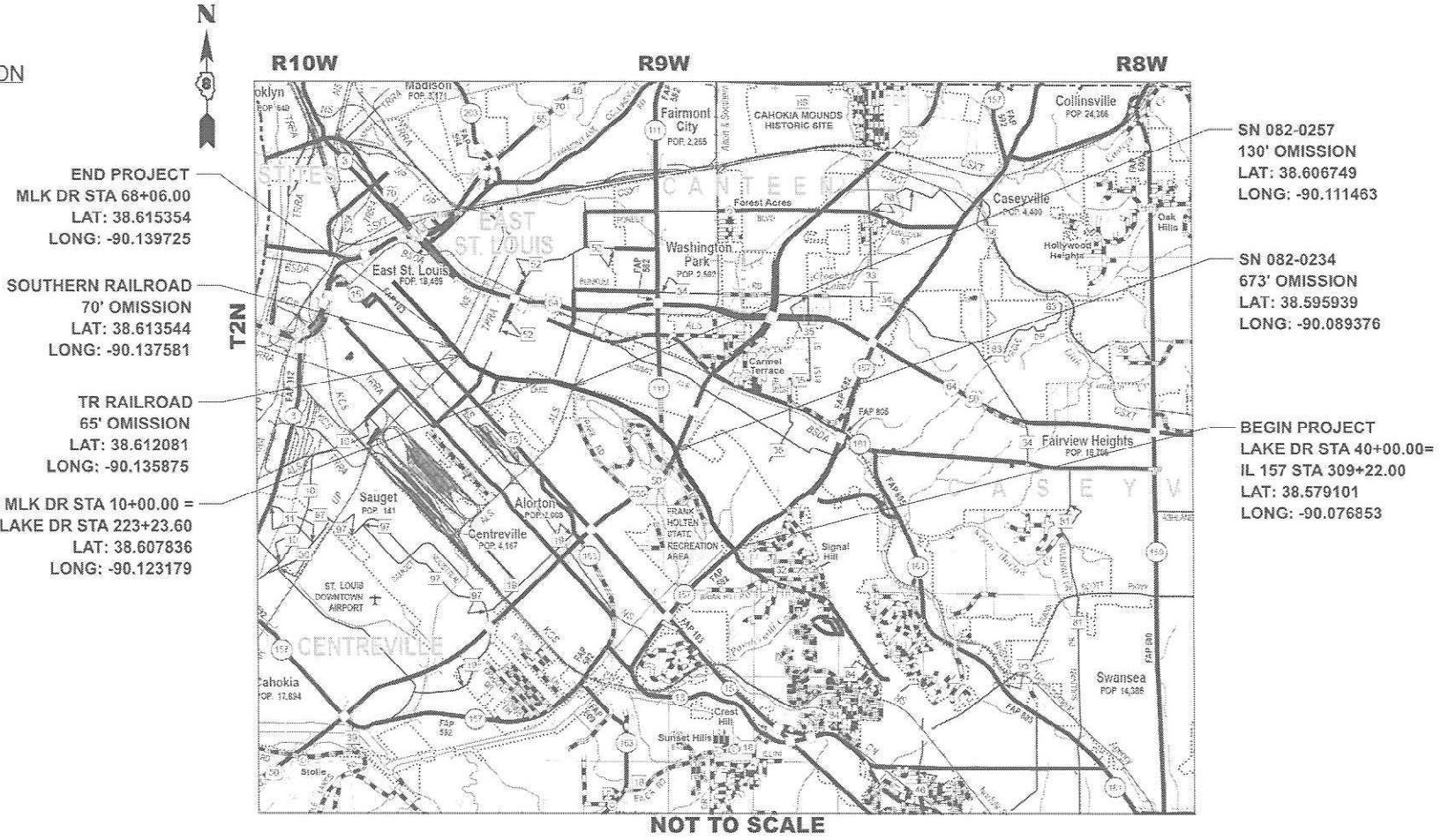

GROSS LENGTH = 24130 FT. = 4.57 MILES
NET LENGTH = 23192 FT. = 4.39 MILES

STATE OF ILLINOIS
DEPARTMENT OF TRANSPORTATION

SUBMITTED Dec 10 2025

[Signature]
REGIONAL ENGINEER

January 23 2026

[Signature]
ENGINEER OF DESIGN AND ENVIRONMENT

January 23 2026

[Signature]
DIRECTOR OF HIGHWAYS PROJECT IMPLEMENTATION

**PRINTED BY THE AUTHORITY
OF THE STATE OF ILLINOIS**

INDEX OF SHEETS

1. COVER SHEET
2. INDEX, HIGHWAY STANDARDS, GENERAL NOTES, MIXTURE REQUIREMENTS & COMMITMENTS
- 3-5. SUMMARY OF QUANTITIES
- 6-8. TYPICAL SECTIONS
- 9-11. SCHEDULE OF QUANTITIES
12. LOCATION MAP
13. MLK DRIVE MAP
- 14-15. LAKE DR PAVEMENT MARKING SHEETS

HIGHWAY STANDARDS

- 001006 DECIMAL OF AN INCH & OF A FOOT
- 000001-09 STANDARD SYMBOLS, ABBREVIATIONS & PATTERNS
- 442201-04 CLASS C PATCHES
- 701011-04 OFF-ROAD MOVING OPERATIONS, 2L, 2W, DAY ONLY
- 701101-05 OFF-ROAD OPERATIONS, MULTILANE 15' (4.5M) TO 24" (600MM) FROM PAVEMENT EDGE
- 701311-03 LANE CLOSURE, 2L, 2W, MOVING OPERATIONS - DAY ONLY
- 701427-05 LANE CLOSURE, MULTILANE INTERMITTENT OR MOVING OPERATIONS FOR SPEEDS ≤ 40 MPH
- 701501-06 URBAN LANE CLOSURE, 2L, 2W, UNDIVIDED
- 701601-09 URBAN LANE CLOSURE, MULTILANE, 1W OR 2W WITH NON TRAVERSABLE MEDIAN
- 701606-10 URBAN SINGLE LANE CLOSURE, MULTILANE, 2W WITH MOUNTABLE MEDIAN
- 701611-01 URBAN HALF ROAD CLOSURE, MULTILANE, 2W WITH MOUNTABLE MEDIAN
- 701701-10 URBAN LANE CLOSURE, MULTILANE INTERSECTION
- 701901-11 TRAFFIC CONTROL DEVICES

GENERAL NOTES

1. THE UTILITIES KNOWN TO HAVE FACILITIES WITHIN THE PROJECT AREA ARE AS FOLLOWS:
 - AMEREN ILLINOIS
 - AT&T ILLINOIS
 - CITY OF BELLEVILLE SEWER
 - BUCKEYE PARTNERS L.P. --WOOD RIVER PIPELINE
 - VILLAGE OF CAHOKIA WATER & SEWER
 - CHARTER COMMUNICATIONS, INC.
 - CITY OF EAST ST LOUIS SEWER
 - ILLINOIS AMERICAN WATER
 - VERIZON BUSINESS
 - METRO EAST SANITARY DISTRICT
2. NO SURVEY WAS PERFORMED FOR THIS PROJECT AND THE PLANS WERE CREATED USING MICROFILM AND FIELD MEASUREMENTS.
3. THE RESIDENT ENGINEER SHALL VERIFY THE EXISTENCE OF HIGHWAY LIGHTING, INTELLIGENT TRANSPORTATION SYSTEMS (I.T.S.) UTILITIES, AND/OR ELECTRICAL CABLES ASSOCIATED WITH TRAFFIC SIGNALS WITHIN THE PROJECT LIMITS. IF ANY OF THESE EXIST WITHIN THE PROJECT LIMITS, AND IF THESE ITEMS REQUIRE LOCATING, THE CONTRACTOR SHALL BE DIRECTED TO DO SO ACCORDING TO SECTION 803 OF THE STANDARD SPECIFICATIONS. THIS WORK SHALL BE PAID FOR ACCORDING TO ARTICLE 109.04 OF THE STANDARD SPECIFICATIONS.
4. FOUR CHANGEABLE MESSAGE SIGNS SHALL BE REQUIRED FOR THIS PROJECT, THEY SHALL BE PLACED AT THE BEGINNING OF THE PROJECT ALONG MARTIN LUTHER KING DRIVE, ALONG LOUISIANA BLVD AND LAKE DRIVE, AND AT THE END OF THE PROJECT BY THE IL 157 JUNCTION TWO WEEKS PRIOR TO ANY LANE CLOSURE. THEY SHALL REMAIN UP FOR THE DURATION OF THE PROJECT.

5. THE DEPARTMENT STRONGLY ENCOURAGES THE PRIME CONTRACTOR AND THEIR APPROVED SUB-CONTRACTORS TO HIRE MINORITY, WOMEN AND DISADVANTAGED INDIVIDUALS FROM ITS FEDERALLY FUNDED HIGHWAY CONSTRUCTION CAREERS TRAINING PROGRAM (HCCTP) TO HELP MEET WORKFORCE AND TRAINEE GOALS. THIS PROGRAM IS TRAINING MINORITIES, WOMEN AND DISADVANTAGED INDIVIDUALS IN HIGHWAY CONSTRUCTION RELATED SKILLS, E.G., MATH FOR THE TRADES, JOB READINESS, TECHNICAL SKILLS COURSEWORK (CARPENTRY, CONCRETE FLATWORK, BLUEPRINT READING, SITE PLANS, SITE WORK, TOOLS USE, ETC.) AND OSHA 10 HOUR CERTIFICATION, TO PREPARE THEM FOR A CAREER IN THE HIGHWAY CONSTRUCTION TRADES. GRADUATES ARE WELL-TRAINED AND READY TO BECOME PRODUCTIVE ENTRY-LEVEL CONSTRUCTION WORKERS. CONTACT THE DISTRICT 8 EEO OFFICE AT 618-346-3360 AND/OR THE HCCTP COORDINATOR AT 618-874-6528 TO LEARN MORE ABOUT THE PROGRAM AND FOR ASSISTANCE IN MEETING WORKFORCE AND TRAINEE GOALS.
6. THE CONTRACTOR SHALL BE ALLOWED TO USE HIGH EARLY STRENGTH CONCRETE FOR THE PATCHING AS DIRECTED BY THE ENGINEER.
7. THE VOID IN THE PAVEMENT WHICH RESULTS FROM THE RAISED REFLECTIVE PAVEMENT MARKER REMOVAL SHALL BE REPAIRED WITH MATERIAL AS DIRECTED BY THE ENGINEER, THE MATERIAL AND WORK SHALL BE PAID FOR IN ACCORDANCE WITH ARTICLE 783 OF THE STANDARD SPECIFICATIONS.
8. THE FOLLOWING MIXTURE REQUIREMENTS ARE APPLICABLE FOR THIS PROJECT:

MIXTURE USE		Partial Depth Patch
AC/PG		PG 64-22
DESIGN AIR VOIDS		4.0% @Ndes=70
MIX COMPOSITION (Gradation)		IL 9.5
FRICION AGG		MIXTURE "C"
QUALITY MGMT PROGRAM		QC/QA
MatTranDev Required?		NO

PLAN QUANTITIES FOR HOT-MIX ASPHALT ITEMS ARE CALCULATED USING A UNIT WEIGHT OF 112 LBS/SQ YD/IN

COMMITMENTS

NONE

MODEL: General Notes-1 [Sheet]
FILE NAME: c:\p\work\pav\illinois.gov\joshua.huffstutler\1377380876167-eh-gemnotes.dgn

USER NAME = joshua.huffstutler	DESIGNED -	REVISED -
	DRAWN -	REVISED -
	CHECKED -	REVISED -
PLOT DATE = 12/9/2025	DATE -	REVISED -

STATE OF ILLINOIS
DEPARTMENT OF TRANSPORTATION

INDEX OF SHEETS, HIGHWAY STANDARDS,
GENERAL NOTES, & COMMITMENTS

SCALE: SHEET 1 OF 1 SHEETS STA. TO STA.

F.A.U RTE.	SECTION	COUNTY	TOTAL SHEETS	SHEET NO.
*	33PP-1, 10-PP-1, 10-1RS-2	ST CLAIR	15	2
CONTRACT NO. 76U67				
ILLINOIS FED. AID PROJECT				

CODE NO.	ITEM	UNIT	TOTAL QUANTITY	CONSTRUCTION CODE	
				100% STATE	100% STATE
				ROADWAY 0005 URBAN	ROADWAY 0006 URBAN
40400001	FIBER-MODIFIED ASPHALT CRACK SEALING	FOOT	8030	8030	0
40400002	ASPHALTIC EMULSION SLURRY SEAL	SQ YD	25326	25326	0
40400020	BUMP REMOVAL	EACH	30	30	0
40600290	BITUMINOUS MATERIALS (TACK COAT)	POUND	9402	9402	0
40600295	POLYMERIZED BITUMINOUS MATERIALS (TACK COAT)	POUND	1994	1994	0
44201365	CLASS C PATCHES, TYPE II, 11 INCH	SQ YD	144	0	144
44201369	CLASS C PATCHES, TYPE III, 11 INCH	SQ YD	18	0	18
44201371	CLASS C PATCHES, TYPE IV, 11 INCH	SQ YD	612	0	612
67100100	MOBILIZATION	L SUM	1	0.2	0.8
70102620	TRAFFIC CONTROL AND PROTECTION, STANDARD 701501	L SUM	1	0.2	0.8
70102625	TRAFFIC CONTROL AND PROTECTION, STANDARD 701606	L SUM	1	0	1
70102630	TRAFFIC CONTROL AND PROTECTION, STANDARD 701601	L SUM	1	0.2	0.8
70102634	TRAFFIC CONTROL AND PROTECTION, STANDARD 701611	L SUM	1	0	1
70102635	TRAFFIC CONTROL AND PROTECTION, STANDARD 701701	L SUM	1	1	0

MODEL: SOQ (Sheet)
 FILE NAME: c:\p\work\pvt\illinois.gov_joshua.huffstutler@illinois.gov\1377380\876167-eh-SOQ.dgn

USER NAME = joshua.huffstutler	DESIGNED -	REVISED -
	DRAWN -	REVISED -
	CHECKED -	REVISED -
PLOT DATE = 12/9/2025	DATE -	REVISED -

**STATE OF ILLINOIS
DEPARTMENT OF TRANSPORTATION**

SUMMARY OF QUANTITIES

SCALE: SHEET 1 OF 3 SHEETS STA. TO STA.

F.A.U RTE.	SECTION	COUNTY	TOTAL SHEETS	SHEET NO.
*	33PP-1, 10-PP-1, 10-1RS-2	ST CLAIR	15	3
CONTRACT NO. 76U67				
ILLINOIS FED. AID PROJECT				

CODE NO.	ITEM	UNIT	TOTAL QUANTITY	CONSTRUCTION CODE	
				100% STATE	100% STATE
				ROADWAY 0005 URBAN	ROADWAY 0006 URBAN
70107025	CHANGEABLE MESSAGE SIGN	CAL DA	225	150	75
70300100	SHORT TERM PAVEMENT MARKING	FOOT	5443	5443	0
70300150	SHORT TERM PAVEMENT MARKING REMOVAL	SQ FT	910	910	0
70300211	TEMPORARY PAVEMENT MARKING LETTERS AND SYMBOLS - PAINT	SQ FT	65	65	0
70300241	TEMPORARY PAVEMENT MARKING - LINE 6"- PAINT	FOOT	36462	36462	0
70300281	TEMPORARY PAVEMENT MARKING - LINE 24"- PAINT	FOOT	65	65	0
78000100	THERMOPLASTIC PAVEMENT MARKING - LETTERS AND SYMBOLS	SQ FT	78	78	0
70000400	THERMOPLASTIC PAVEMENT MARKING - LINE 6"	FOOT	36462	36462	0
78000650	THERMOPLASTIC PAVEMENT MARKING - LINE 24"	FOOT	65	65	0
78001110	PAINT PAVEMENT MARKING - LINE 4"	FOOT	2838	2838	0
78100100	RAISED REFLECTIVE PAVEMENT MARKER	EACH	193	193	0
78300200	RAISED REFLECTIVE PAVEMENT MARKER REMOVAL	EACH	193	193	0
78300201	PAVEMENT MARKING REMOVAL - GRINDING	SQ FT	9156	9156	0
X4406250	PARTIAL DEPTH REMOVAL, TYPE II, 5"	SQ YD	49	0	49

MODEL: SOQ-1 [Sheet]
 FILE NAME: c:\p\work\pwr\illinois.gov_joshua.huffstutler@illinois.gov\137380\876167-eh-SOQ.dgn

USER NAME = joshua.huffstutler	DESIGNED -	REVISED -
	DRAWN -	REVISED -
	CHECKED -	REVISED -
PLOT DATE = 12/9/2025	DATE -	REVISED -

**STATE OF ILLINOIS
DEPARTMENT OF TRANSPORTATION**

SUMMARY OF QUANTITIES

SCALE: SHEET 2 OF 3 SHEETS STA. TO STA.

F.A.U RTE.	SECTION	COUNTY	TOTAL SHEETS	SHEET NO.
*	33PP-1, 10-PP-1, 10-1RS-2	ST CLAIR	15	4
CONTRACT NO. 76U67				
ILLINOIS FED. AID PROJECT				

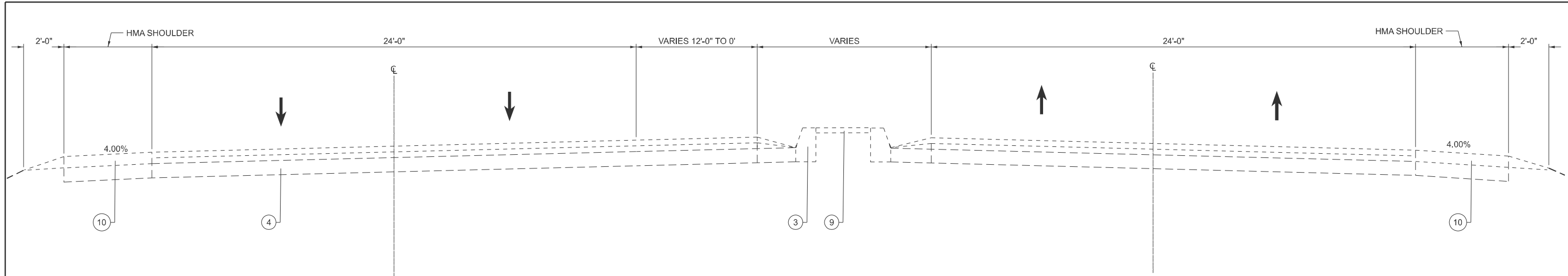

EXISTING TYPICAL SECTION
LAKE DR, STA 40+00.00 TO STA 49+78.20
LAKE DR & IL 157 INTERSECTION

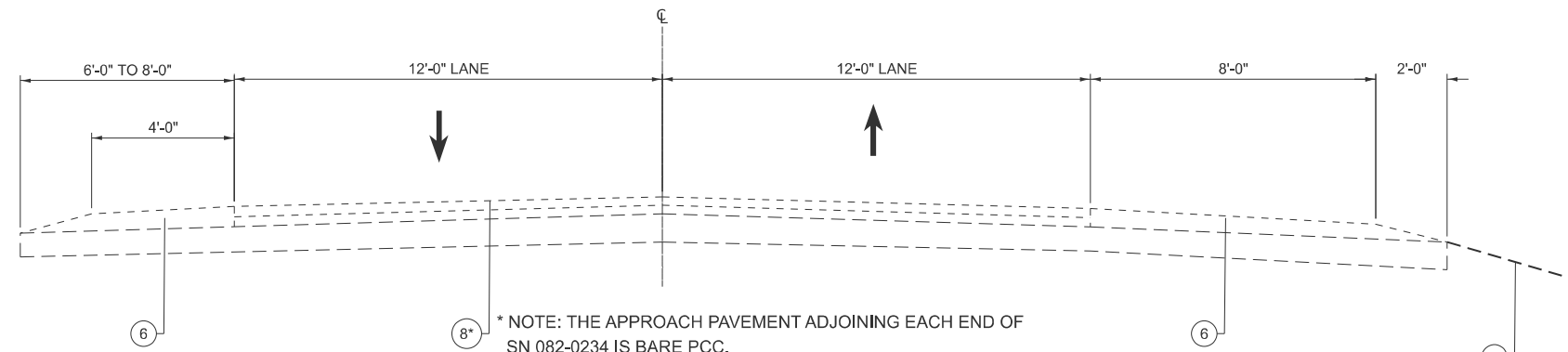

EXISTING TYPICAL SECTION
LAKE DR STA 49+78.20 TO STA 127+02.78
LAKE DR & IL 111 INTERSECTION

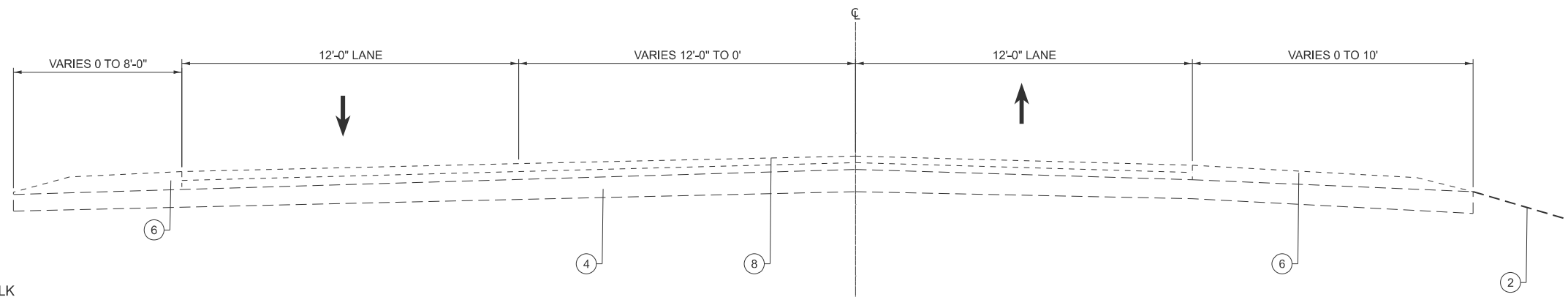

EXISTING TYPICAL SECTION
LAKE DR STA 127+02.78 TO STA 223+23.60

LEGEND

- ① EXISTING 4' SIDEWALK
- ② EXISTING GRADE
- ③ EXISTING COMBINATION CONCRETE CURB & GUTTER
- ④ EXISTING PCC PAVEMENT, 8"
- ⑤ EXISTING BIT CONCRETE SURFACE COURSE, SUPERPAVE, MIX D, N70, 1 1/2"
- ⑥ EXISTING AGGREGATE SHOULDER
- ⑦ EXISTING PARKING LANE OR CONCRETE SHOULDER
- ⑧ EXISTING HMA SURFACE COURSE, 1 1/2"
- ⑨ EXISTING CONCRETE MEDIAN SURFACE
- ⑩ EXISTING HMA SHOULDER

MODEL: Lake Dr Existing Typical Sections (Sheet)
FILE NAME: c:\p\work\pav\illinois.gov\joshua.huffstutter\1377380\0876167-eh-typicals.dgn

USER NAME = joshua.huffstutter	DESIGNED -	REVISED -
	DRAWN -	REVISED -
	CHECKED -	REVISED -
PLOT DATE = 12/9/2025	DATE -	REVISED -

**STATE OF ILLINOIS
DEPARTMENT OF TRANSPORTATION**

LAKE DR. EXISTING TYPICAL SECTIONS

SCALE: SHEET 1 OF 3 SHEETS STA. TO STA.

F.A.U. RTE.	SECTION	COUNTY	TOTAL SHEETS	SHEET NO.
*	33PP-1, 10-PP-1, 10-1RS-2	ST CLAIR	15	6
CONTRACT NO. 76U67				
ILLINOIS FED. AID PROJECT				

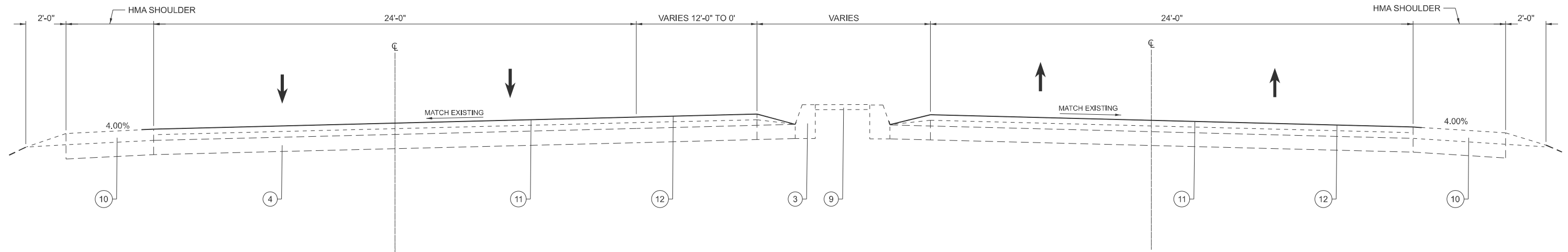

PROPOSED TYPICAL SECTION
LAKE DR. STA 40+00.00 TO STA 49+78.20
LAKE DR & IL 157 INTERSECTION

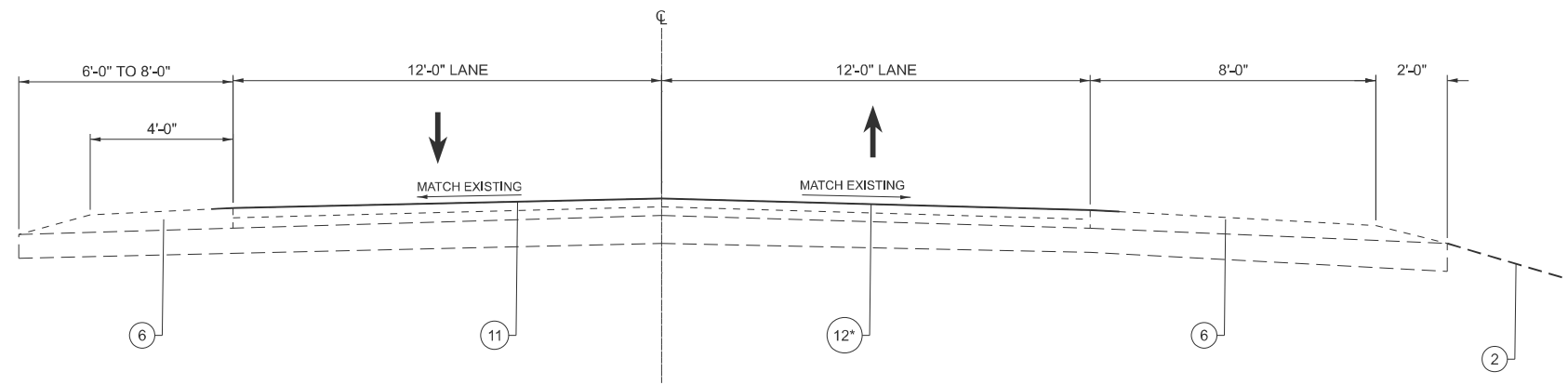

* NOTE: THE APPROACH PAVEMENT ADJOINING EACH END OF SN 082-0234 IS BARE PCC. APPLY A POLYMERIZED LAYER OF TACK COAT TO ENSURE PROPER ADHESION OF THE SLURRY SEAL.

PROPOSED TYPICAL SECTION
LAKE DR STA 49+78.20 TO STA 127+02.78
LAKE DR & IL 111 INTERSECTION

LEGEND

- ① EXISTING 4' SIDEWALK
- ② EXISTING GRADE
- ③ EXISTING COMBINATION CONCRETE CURB & GUTTER
- ④ EXISTING PCC PAVEMENT, 8"
- ⑤ EXISTING BIT CONCRETE SURFACE COURSE, SUPERPAVE, MIX D, N70, 1 1/2"
- ⑥ EXISTING AGGREGATE SHOULDER
- ⑦ EXISTING PARKING LANE OR CONCRETE SHOULDER
- ⑧ EXISTING HMA SURFACE COURSE, 1 1/2"
- ⑨ EXISTING CONCRETE MEDIAN SURFACE
- ⑩ EXISTING HMA SHOULDER
- ⑪ PROPOSED ASPHALTIC EMULSION SLURRY SEAL
- ⑫ PROPOSED BITUMINOUS MATERIAL (TACK COAT)

MODEL: Lake Dr. Proposed Sections (Sheet)
FILE NAME: c:\p\work\pav\illinois.gov\1377380\0876167-eh-typical.sdm

USER NAME = joshua.huffstutler	DESIGNED -	REVISED -
	DRAWN -	REVISED -
	CHECKED -	REVISED -
PLOT DATE = 12/9/2025	DATE -	REVISED -

STATE OF ILLINOIS
DEPARTMENT OF TRANSPORTATION

LAKE DR.			
PROPOSED TYPICAL SECTIONS			
SCALE:	SHEET 3	OF 3	SHEETS
	STA.		TO STA.

F.A.U. RTE.	SECTION	COUNTY	TOTAL SHEETS	SHEET NO.
*	33PP-1, 10-PP-1, 10-1RS-2	ST CLAIR	15	8
CONTRACT NO. 76U67				
ILLINOIS FED. AID PROJECT				

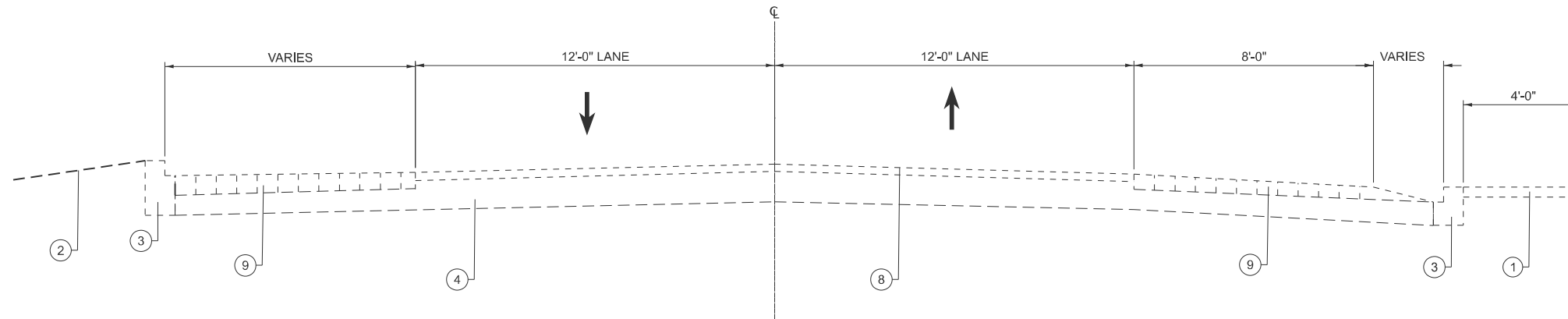

EXISTING TYPICAL SECTION
LAKE DR STA 223+23.00
LOUISIANA DR STA 10+00 TO 42+00.00

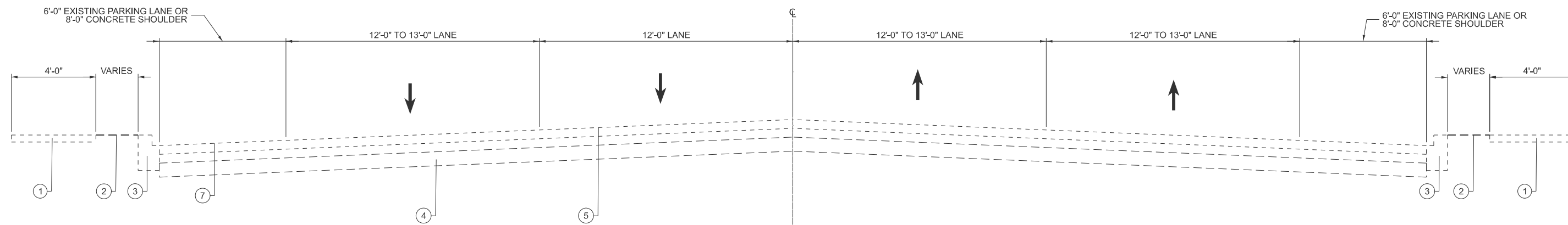

EXISTING TYPICAL SECTION
MARTIN LUTHER KING DR
STA 42+00 TO 68+06.00

LEGEND

- ① - EXISTING 4' SIDEWALK
- ② - EXISTING GRADE
- ③ - EXISTING COMBINATION CONCRETE CURB & GUTTER
- ④ - EXISTING PCC PAVEMENT, 8"
- ⑤ - EXISTING BIT CONCRETE SURFACE COURSE, SUPERPAVE, MIX D, N70, 1 1/2"
- ⑥ - EXISTING AGGREGATE SHOULDER
- ⑦ - EXISTING HMA SHOULDER
- ⑧ - EXISTING HMA SURFACE COURSE, 1 1/2"
- ⑨ - EXISTING BRICK SHOULDER, 8"

MODEL: Typical Sections (Sheet)
FILE NAME: c:\p\work\pav\illinois.gov\joshua.huffstutler@illinois.gov\1377380\0876167-eh-typical.dgn

USER NAME = joshua.huffstutler	DESIGNED -	REVISED -
	DRAWN -	REVISED -
	CHECKED -	REVISED -
PLOT DATE = 12/9/2025	DATE -	REVISED -

**STATE OF ILLINOIS
DEPARTMENT OF TRANSPORTATION**

**LOUISIANA DR. & MLK DR.
EXISTING TYPICAL SECTIONS**

SCALE: SHEET 2 OF 3 SHEETS STA. TO STA.

F.A.U. RTE.	SECTION	COUNTY	TOTAL SHEETS	SHEET NO.
*	33PP-1, 10-PP-1, 10-1RS-2	ST CLAIR	15	7
CONTRACT NO. 76U67				
ILLINOIS FED. AID PROJECT				

PARTIAL DEPTH PATCHING, 5-INCH SCHEDULE

OFFSET FROM CL	SIDE STREET(S)/ LANDMARK	FIELD NOTES	LENGTH	WIDTH	Area (SY)	TYPE II	TYPE III	TYPE IV	PARTIAL DEPTH PATCHING	PAIN T PAVEMENT MARKING LINE 4"
			FOOT	FOOT	SQ YDS	SQ YDS	SQ YDS	SQ YDS	TONS	FOOT
RT	Calhoun & 82nd St	WHEEL LANE	120	6	80.0	0.0	0.0	80.0	22.4	60
RT	Calhoun & 82nd St	EDGE LINE	150	6	100.0	0.0	0.0	100.0	28.0	75
LT	Calhoun & 82nd St	EDGE LINE	150	6	100.0	0.0	0.0	100.0	28.0	75
LT	Calhoun & 82nd St	CENTER LINE	300	6	200.0	0.0	0.0	200.0	56.0	150
RT	Calhoun & 82nd St	EDGE LINE	200	6	133.3	0.0	0.0	133.3	37.3	100
LT	Calhoun & 82nd St	EDGE LINE	200	6	133.3	0.0	0.0	133.3	37.3	100
RT	SALOON ON LAKE	EDGE LINE	1200	6	800.0	0.0	0.0	800.0	224.0	600
RT	SALOON ON LAKE	EDGE LINE	20	6	13.3	13.3	0.0	0.0	3.7	10
RT	Calhoun Ln	CENTER / EDGE LINE	200	12	266.7	0.0	0.0	266.7	74.7	100
RT	Calhoun Ln	CENTER / EDGE LINE	80	12	106.7	0.0	0.0	106.7	29.9	40
RT	Pershing St & 73rd	CENTER / EDGE LINE	620	12	826.7	0.0	0.0	826.7	231.5	310
LT	Pershing St & 73rd	CENTER / EDGE LINE	250	12	333.3	0.0	0.0	333.3	93.3	125
RT	73rd & 72nd	EDGE LINE	20	6	13.3	13.3	0.0	0.0	3.7	10
LT	72nd		60	12	80.0	0.0	0.0	80.0	22.4	30
RT	72nd		60	12	80.0	0.0	0.0	80.0	22.4	30
LT	Island Dr		40	12	53.3	0.0	0.0	53.3	14.9	20
LT	69th & 71st	8' WIDE WHEEL LANE	40	8	35.6	0.0	0.0	35.6	10.0	20
RT	69th & 71st	EDGE LINE	150	6	100.0	0.0	0.0	100.0	28.0	75
RT	69th & 71st	EDGE LINE	80	6	53.3	0.0	0.0	53.3	14.9	40
RT	N 63rd St Radius	JOINT FAILURE 1/2 LANE	60	6	40.0	0.0	0.0	40.0	11.2	30
LT	N 63rd St Radius	1/2 LANE	60	6	40.0	0.0	0.0	40.0	11.2	30
RT	62nd	CENTER LINE / EDGE	12	12	16.0	0.0	16.0	0.0	4.5	6
LT	62nd	CENTER LINE / EDGE	6	12	8.0	8.0	0.0	0.0	2.2	3
RT	47th		200	12	266.7	0.0	0.0	266.7	74.7	100
RT	27th	3' WIDE	30	3	10.0	10.0	0.0	0.0	2.8	15
RT	26th & 25th		60	12	80.0	0.0	0.0	80.0	22.4	30
SUB TOTAL:						44.7	16.0	3908.9	1111.5	2184.0
10 % FOR ANTICIPATED FAILURES / CONTINGENCY						49.0	18.0	4300.0	1223.0	2402.0

MODEL: Schedules (Sheet)
FILE NAME: c:\p\work\pvt\illinois.gov\joshua.huffstutler\137380876167-eh-schedule.dgn

USER NAME = joshua.huffstutler	DESIGNED -	REVISED -
	DRAWN -	REVISED -
	CHECKED -	REVISED -
PLOT DATE = 12/9/2025	DATE -	REVISED -

STATE OF ILLINOIS
DEPARTMENT OF TRANSPORTATION

SCHEDULE OF QUANTITIES

SCALE: SHEET 1 OF 3 SHEETS STA. TO STA.

F.A.U RTE.	SECTION	COUNTY	TOTAL SHEETS	SHEET NO.
*	33PP-1, 10-PP-1, 10-IRS-2	ST CLAIR	15	9
CONTRACT NO. 76U67				
ILLINOIS FED. AID PROJECT				

CLASS C, 11-INCH PATCHING SCHEDULE

OFFSET FROM CL	SIDE STREET(S) / LANDMARK	FIELD NOTES	LENGTH	WIDTH	Area (SY)	TYPE II	TYPE III	TYPE IV	PAINT PAVEMENT MARKING LINE 4" FOOT
			FOOT	FOOT	SQ YDS	SQ YDS	SQ YDS	SQ YDS	
LT	SALOON ON LAKE		8	12	10.7	10.7	0.0	0.0	0
LT	7121 LAKE DR	EDGE LINE	8	12	10.7	10.7	0.0	0.0	0
LT	Island Dr		6	12	8.0	8.0	0.0	0.0	0
RT	Island Dr		6	12	8.0	8.0	0.0	0.0	0
LT	Ash St & 71st		80	12	106.7	0.0	0.0	106.7	80
RT	Ash St & 71st		80	12	106.7	0.0	0.0	106.7	80
RT	N 63rd St		6	12	8.0	8.0	0.0	0.0	0
LT	47th	1/2 LANE	80	12	106.7	0.0	0.0	106.7	80
LT	Park St & 36th		6	12	8.0	8.0	0.0	0.0	0
RT	41st & 36th		6	12	8.0	8.0	0.0	0.0	0
LT	41st & 36th		6	12	8.0	8.0	0.0	0.0	0
RT	36th		6	12	8.0	8.0	0.0	0.0	0
RT	35th St		20	12	26.7	0.0	0.0	26.7	20
LT	35th St	SHOULDER	80	8	71.1	0.0	0.0	71.1	0
LT	35th St		80	12	106.7	0.0	0.0	106.7	80
RT	35th & 34th		24	12	32.0	0.0	0.0	32.0	24
RT	35th & 34th		6	12	8.0	8.0	0.0	0.0	0
LT	29th St INTERSECTION		8	12	10.7	10.7	0.0	0.0	0
LT	29th St INTERSECTION		8	12	10.7	10.7	0.0	0.0	0
LT	20th	SHOULDER	12	8	10.7	10.7	0.0	0.0	0
LT	20th	FAR RIGHT LANE	12	12	16.0	0.0	16.0	0.0	12
RT	18th	FAR RIGHT LANE	20	6	13.3	13.3	0.0	0.0	20
SUB TOTAL:						130.7	16.0	556.4	396.0
10 % FOR ANTICIPATED FAILURES / CONTINGENCY						144.0	18.0	612.0	436.0

MODEL: S:\mry\Seal Schedules (Sheet)
FILE NAME: c:\p\work\pvt\illinois.gov\joshua.huffstutler\137380876167-eh-schedule.dgn

USER NAME = joshua.huffstutler	DESIGNED -	REVISED -
	DRAWN -	REVISED -
	CHECKED -	REVISED -
PLOT DATE = 12/9/2025	DATE -	REVISED -

STATE OF ILLINOIS
DEPARTMENT OF TRANSPORTATION

SCHEDULE OF QUANTITIES

SCALE: SHEET 2 OF 3 SHEETS STA. TO STA.

F.A.U RTE.	SECTION	COUNTY	TOTAL SHEETS	SHEET NO.
*	33PP-1, 10-PP-1, 10-1RS-2	ST CLAIR	15	10
CONTRACT NO. 76U67				
ILLINOIS FED. AID PROJECT				

SLURRY SEAL SCHEDULE								
STATION		DIMENSION		BITUMINOUS MATERIALS (TACK COAT)	POLYMERIZED BITUMINOUS MATERIALS (TACK COAT)	ASPHALTIC EMULSION SLURRY SEAL	FIBER-MODIFIED ASPHALTIC CRACK SEALING	BUMP REMOVAL
		LENGTH	WIDTH					
FROM	TO	FEET	FEET	POUND	POUND	SQ YD	FOOT	EACH
40+00.00	49+78.20	978.2	60	2934.6	0.0	6521.3	978.2	5
49+78.20	97+80.00	4801.8	24	5762.2	0.0	12804.8	4801.8	10
* 97+80.00	107+20.00	940.00	24	0.0	1128.0	2506.7	940	5
* 113+93.00	121+15.00	722.00	24	0.0	866.4	1925.3	722	5
121+15.00	127+02.78	587.78	24	705.3	0.0	1567.4	587.78	5
TOTAL				9402	1994	25326	8030	30

*PAVEMENT IS BARE PCC AND WILL REQUIRE POLYMERIZED TACK COAT PRIOR TO SLURRY SEAL

PAVEMENT MARKING SCHEDULE												
LOCATION		THERMOPLASTIC PAVEMENT MARKING						SHORT TERM PAVEMENT MARKING (1 APPLICATION)	SHORT TERM PAVEMENT MARKING REMOVAL	RAISED REFLECTIVE PAVEMENT MARKER		RAISED REFLECTIVE PAVEMENT MARKER REMOVAL
STATION		LINE - 6" THERMOPLASTIC					LINE - 24"			ONE WAY CRYSTAL	TWO WAY AMBER	
FROM	TO	YELLOW SOLID	SKIP-DASH YELLOW	SKIP-DASH WHITE	WHITE SOLID EDGE LINE	TURN LANE SYMBOLS	WHITE SOLID	FEET	SQ FT	EACH	EACH	EACH
		FEET	FEET	FEET	FEET	SQ FT	FEET	FEET	FEET	FEET	FEET	FEET
40+00.0	49+78.2	1956.4	0	1000	2156.4	31.2	65.0	1956.4	327.0	25	0	25
49+78.2	55+57.0	578.75	300	0	1157.5	0.0	0.0	217.0	37.0	0	22	22
55+57.0	104+62.4	0	2460	0	9810.84	0.0	0.0	1839.5	307.0	0	62	62
104+62.4	116+16.7	1154.25	580	0	2308.5	0.0	0.0	432.8	73.0	0	43	43
116+16.7	120+39.9	0	220	0	846.36	0.0	0.0	158.7	27.0	0	6	6
120+39.9	126+48.7	1217.68	0	0	1217.68	0.0	0.0	761.1	127.0	0	30	30
126+48.7	142+01.7	6211.88	0	0	3285.94	46.8	0.0	1941.2	324.0	0	155	155
TOTAL		11119	3560	1000	20783	78.0	65.0	7307	1222.0	25	318	343
ABSOLUTE TOTAL		36462										

MODEL: Slurry Seal Schedule-1 [Sheet]
FILE NAME: c:\p\work\pav\illinois.gov\joshua.huffstutler\137380\0876167-eh-schedule.dgn

USER NAME = joshua.huffstutler	DESIGNED -	REVISED -
	DRAWN -	REVISED -
	CHECKED -	REVISED -
PLOT DATE = 12/9/2025	DATE -	REVISED -

**STATE OF ILLINOIS
DEPARTMENT OF TRANSPORTATION**

SCHEDULE OF QUANTITIES

SCALE: SHEET 3 OF 3 SHEETS STA. TO STA.

F.A.U. RTE.	SECTION	COUNTY	TOTAL SHEETS	SHEET NO.
*	33PP-1, 10-PP-1, 10-IRS-2	ST CLAIR	15	11
CONTRACT NO. 76U67				
ILLINOIS FED. AID PROJECT				

MODEL: Station Correlation Plan (Sheet)
 FILE NAME: c:\p\work\pwr\illinois.gov\joshua.huffstutter@illinois.gov\137380876167-eh-StatPlan.dgn

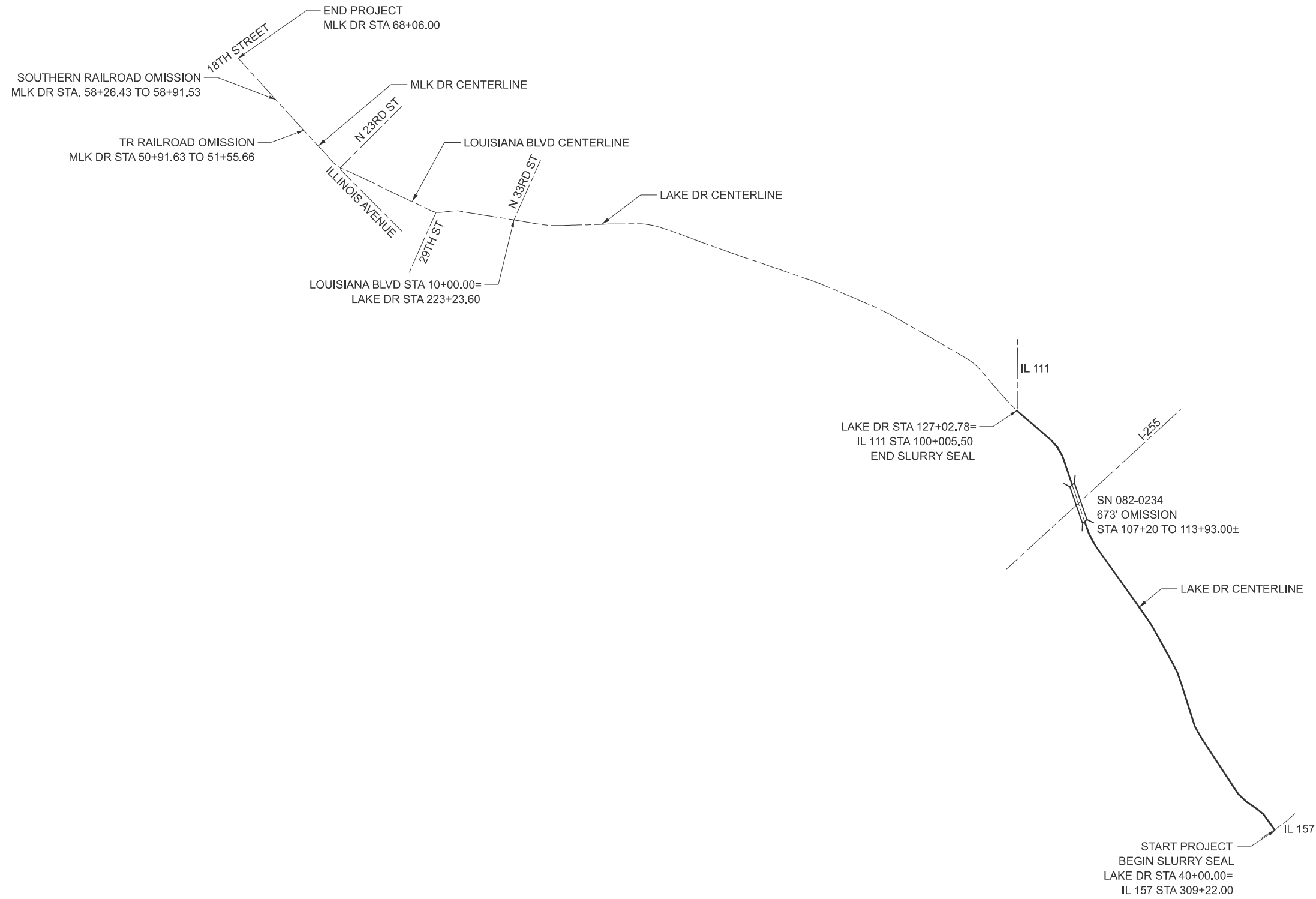

USER NAME = joshua.huffstutter	DESIGNED -	REVISED -
	DRAWN -	REVISED -
	CHECKED -	REVISED -
PLOT DATE = 12/4/2025	DATE -	REVISED -

**STATE OF ILLINOIS
 DEPARTMENT OF TRANSPORTATION**

LOCATION MAP

SCALE: SHEET 1 OF 4 SHEETS STA. TO STA.

F.A.U. RTE.	SECTION	COUNTY	TOTAL SHEETS	SHEET NO.
*	33PP-1, 10-PP-1, 10-1RS-2	ST CLAIR	15	12
CONTRACT NO. 76U67				
ILLINOIS FED. AID PROJECT				

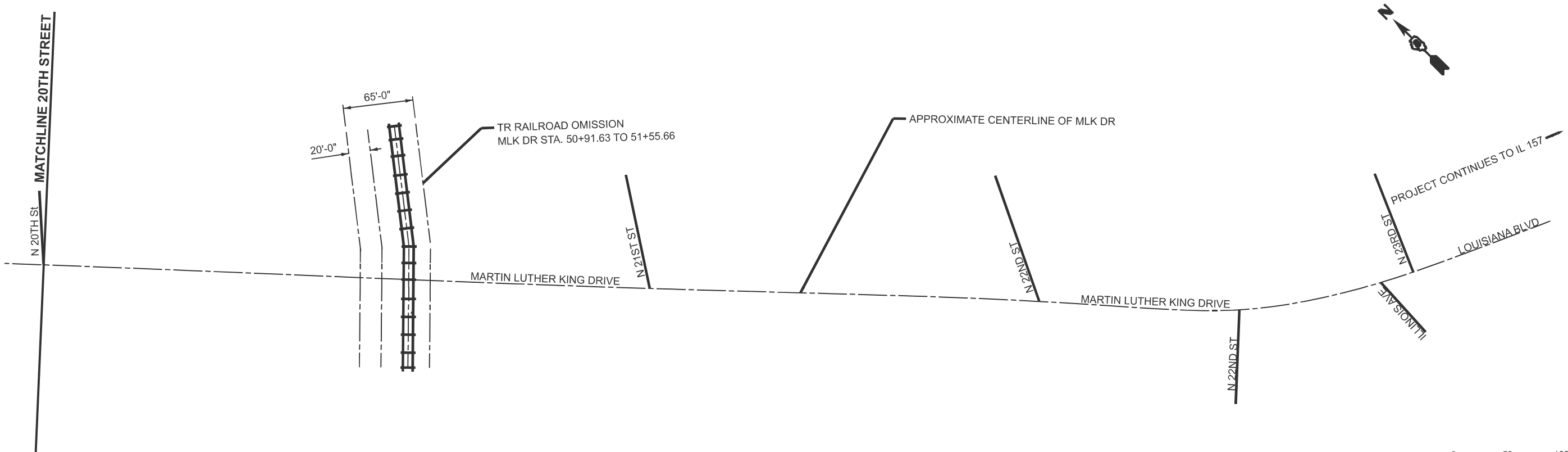
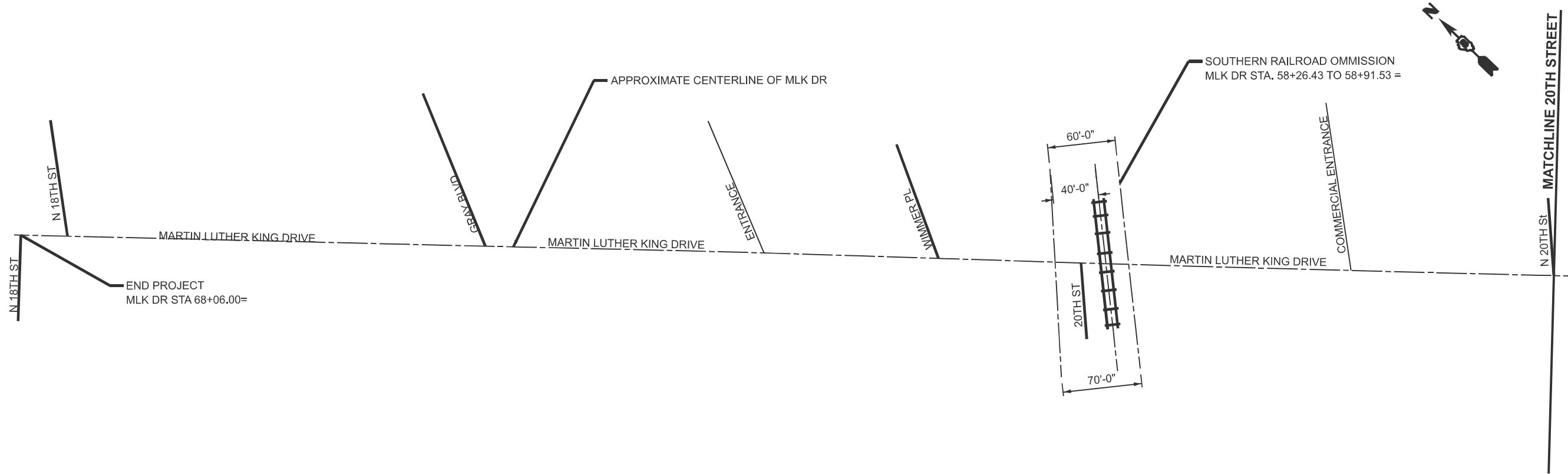

MODEL: Unnamed Plan - MLK Plan [Sheet]
 FILE NAME: c:\p\work\visio\illinois.gov\joshua.huffstutter\illinois.gov\1377380\0876167-shit-dan.dgn



USER NAME = joshua.huffstutter	DESIGNED -	REVISED -
	DRAWN -	REVISED -
	CHECKED -	REVISED -
PLOT DATE = 12/9/2025	DATE -	REVISED -

STATE OF ILLINOIS
DEPARTMENT OF TRANSPORTATION

MLK DRIVE PLAN VIEW

SCALE: 1"=50' SHEET 2 OF 4 SHEETS STA. -1+00.00 TO STA. 28+00.00

F.A.U. RTE.	SECTION	COUNTY	TOTAL SHEETS	SHEET NO.
-	33PP-1, 10-PP-1, 10-1RS-2	ST CLAIR	15	13
CONTRACT NO. 76U67				
ILLINOIS FED. AID PROJECT				

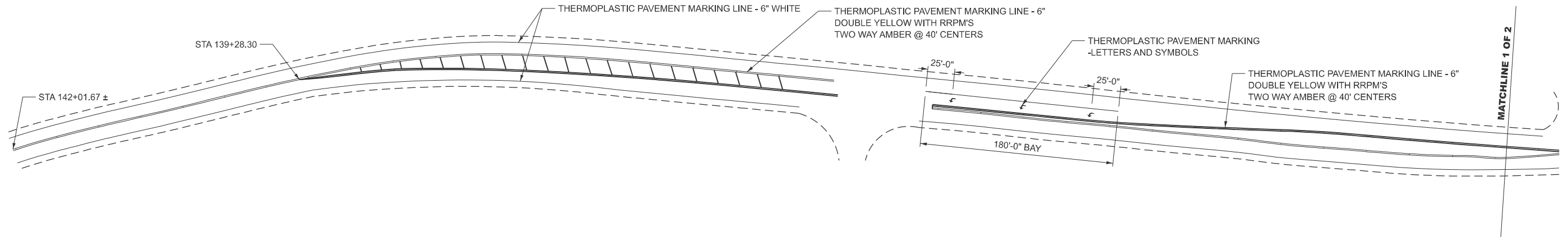

NOTE: ENTRANCES NOT SHOWN. STOP AND START WHITE EDGE LINES AT ENTRANCES (TYP)

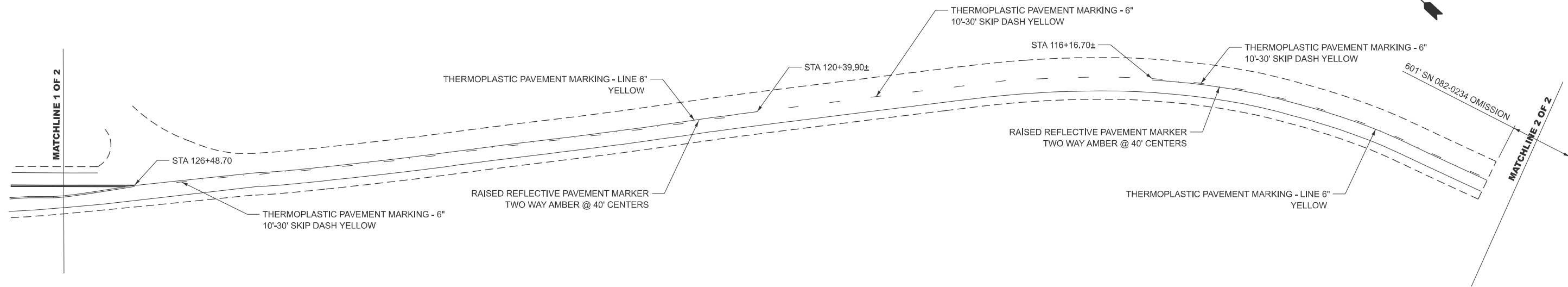

NOTE: ENTRANCES NOT SHOWN. STOP AND START WHITE EDGE LINES AT ENTRANCES (TYP)



MODEL: Unnamed Plan - Pavement Marking Plan 1 (Sheet)
FILE NAME: c:\p\work\wisdo\illinois.gov\joshua.huffstutler@illinois.gov\1377380\0876167-eh-hpmk.dgn

USER NAME = joshua.huffstutler	DESIGNED -	REVISED -
	DRAWN -	REVISED -
	CHECKED -	REVISED -
PLOT DATE = 12/9/2025	DATE -	REVISED -

**STATE OF ILLINOIS
DEPARTMENT OF TRANSPORTATION**

**LAKE DR PAVEMENT MARKING SHEET
IL 111 TO IL 157**

SCALE: 1"=50' SHEET 3 OF 4 SHEETS STA. 139+26.26 TO STA. 167+26.26

F.A.U RTE.	SECTION	COUNTY	TOTAL SHEETS	SHEET NO.
*	33PP-1, 10-PP-1, 10-1RS-2	ST CLAIR	15	14
CONTRACT NO. 76U67				
ILLINOIS FED. AID PROJECT				

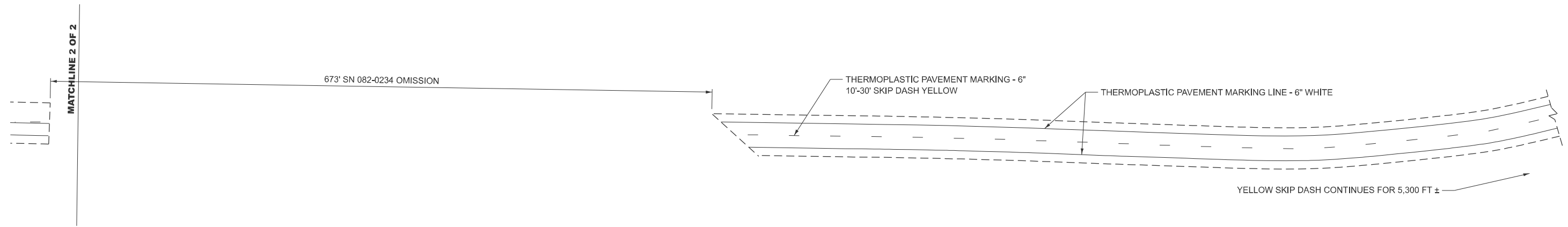

NOTE: ENTRANCES NOT SHOWN. STOP AND START WHITE EDGE LINES AT ENTRANCES (TYP)

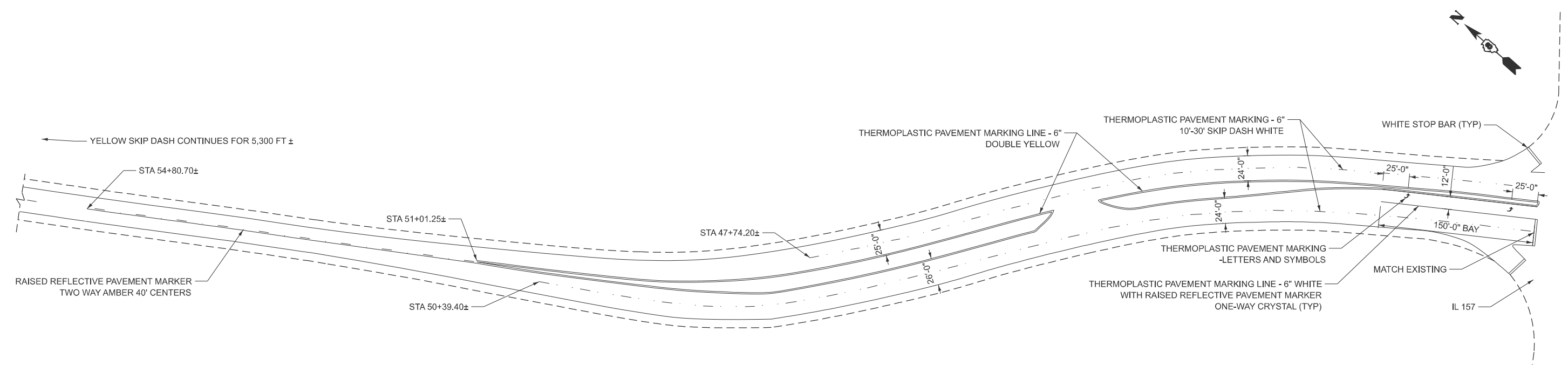

NOTE: ENTRANCES NOT SHOWN. STOP AND START WHITE EDGE LINES AT ENTRANCES (TYP)



MODEL: Unnamed Plan - Pavement Marking Plan 3 (Sheet)
 FILE NAME: c:\p\work\pav\illinois.gov\joshua.huffstutter@illinois.gov\joshua.huffstutter@illinois.gov\jsh-hpmk.dgn

USER NAME = joshua.huffstutter	DESIGNED -	REVISED -
	DRAWN -	REVISED -
	CHECKED -	REVISED -
PLOT DATE = 12/9/2025	DATE -	REVISED -

STATE OF ILLINOIS
DEPARTMENT OF TRANSPORTATION

LAKE DR PAVEMENT MARKING SHEET
IL 111 TO IL 157

SCALE: 1"=50' SHEET 4 OF 4 SHEETS STA. 167+26.26 TO STA. 181+26.26

F.A.U. RTE.	SECTION	COUNTY	TOTAL SHEETS	SHEET NO.
*	33PP-1, 10-PP-1, 10-1RS-2	ST CLAIR	15	15
CONTRACT NO. 76U67				
ILLINOIS FED. AID PROJECT				