

STATE OF ILLINOIS  
DEPARTMENT OF TRANSPORTATION

F.A.P. RTE.	SECTION	COUNTY	TOTAL SHEETS	SHEET NO.
693	(119BR-3)BRR	TAZEWELL	17	1
		ILLINOIS	CONTRACT NO. 68K56	

**INDEX OF SHEETS**  
SEE SHEET 2 FOR "INDEX OF SHEETS"

**HIGHWAY STANDARDS**  
SEE SHEET 2 FOR "HIGHWAY STANDARDS"

**PROPOSED  
HIGHWAY PLANS**

FAP ROUTE 693 (IL ROUTE 9)  
SECTION (119BR-3)BRR  
PROJECT NO.  
**BRIDGE RESURFACING AND JOINT REPAIR**  
**TAZEWELL COUNTY**

C-94-105-25

BRIDGE OVER PRAIRIE CREEK SN 090-0061  
BEGIN IMPROVMENT STA 504+89.69  
END IMPROVMENT STA 506+31.50

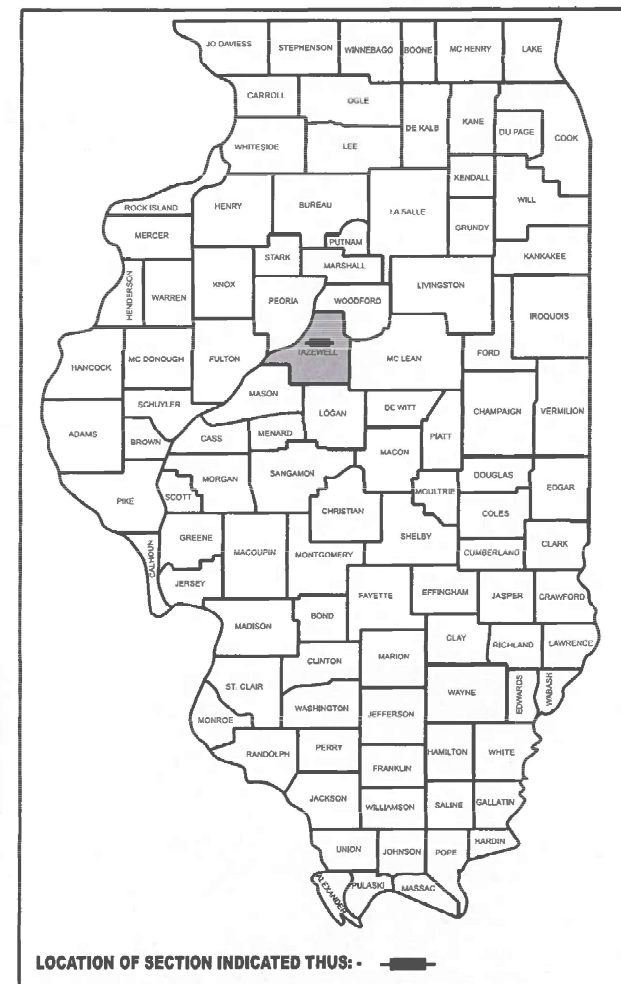

**FUNCTIONAL CLASSIFICATION**  
**RURAL MINOR ARTERIAL**  
2023 ADT = 2700  
S.U. = 120 M.U. = 170

**QEI**  
2351 S. DIRKSEN PKWY  
SPRINGFIELD, ILLINOIS 62703  
217-570-0563 (P)  
www.quiggengineering.com  
DESIGN FIRM REG. NO. 184.004721-0014

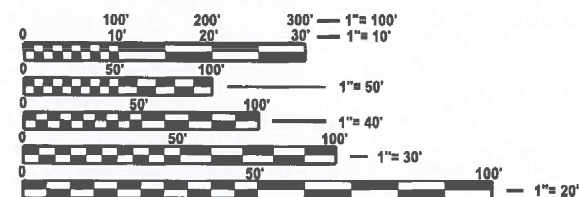

FULL SIZE PLANS HAVE BEEN PREPARED USING STANDARD ENGINEERING SCALES. REDUCED SIZED PLANS WILL NOT CONFORM TO STANDARD SCALES. IN MAKING MEASUREMENTS ON REDUCED PLANS, THE ABOVE SCALES MAY BE USED.

J.U.L.I.E.  
JOINT UTILITY LOCATION INFORMATION FOR EXCAVATION  
1-800-892-0123  
OR 811

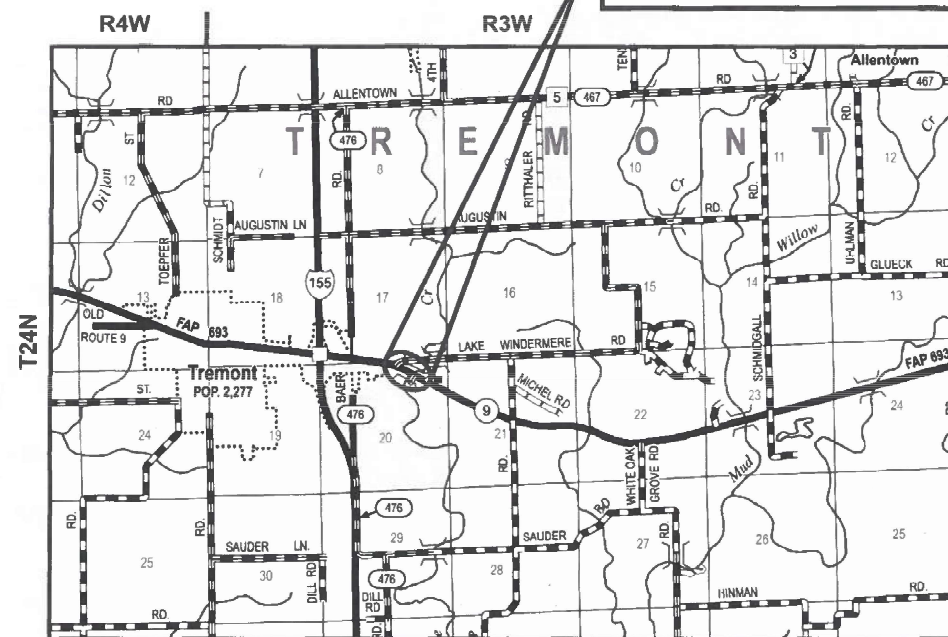

LOCATION MAP



GROSS LENGTH = 141.81 FT. = 0.027 MILE  
NET LENGTH = 141.81 FT. = 0.027 MILE



*Stephen M. Kehoe* 11/25/2025  
STEPHEN M. KEHOE ILLINOIS P.E. 062-048103 DATE  
EXPIRES 11/30/2025

PROJECT ENGINEER: BEN TELLEFSON  
PROJECT MANAGER: MARK ECKHOFF

CONTRACT NO. 68K56

STATE OF ILLINOIS  
DEPARTMENT OF TRANSPORTATION

SUBMITTED December 5 2025  
*Kensil L. Darneth*  
REGIONAL ENGINEER  
January 23 2026  
*Scott A. Etkin*  
ENGINEER OF DESIGN AND ENVIRONMENT  
January 23 2026  
*Gregory J. ...*  
DIRECTOR OF HIGHWAYS PROJECT IMPLEMENTATION

**PRINTED BY THE AUTHORITY  
OF THE STATE OF ILLINOIS**

## INDEX OF SHEETS

SHEET NO.	DESCRIPTION
1	COVER SHEET
2	INDEX OF SHEETS, HIGHWAY STANDARDS, & GENERAL NOTES
3 - 4	SUMMARY OF QUANTITIES
5	SCHEDULE OF QUANTITIES
6	TYPICAL SECTIONS
7	ALIGNMENT DIAGRAM
8	REMOVAL PLAN
9	ROADWAY PLAN
10	CONSTRUCTION SEQUENCE AND MAINTENANCE OF TRAFFIC
11 - 13	DISTRICT STANDARDS
14 - 17	STRUCTURE PLANS

### GENERAL NOTES

1. THE ENGINEER AND OWNER FURTHER DO NOT WARRANT THAT ALL UTILITIES HAVE BEEN ILLUSTRATED ON THESE DOCUMENTS. THE CONTRACTOR IS SOLELY RESPONSIBLE FOR CONTACTING J.U.L.I.E. FOR FIELD VERIFICATION OF ALL UTILITIES ON THE SITE PRIOR WHERE SECTION OR SUBSECTION MONUMENTS ARE ENCOUNTERED. THE ENGINEER SHALL BE NOTIFIED BEFORE SUCH ARE REMOVED. THE CONTRACTOR SHALL PROTECT AND CAREFULLY PRESERVE ALL PROPERTY MARKERS AND MONUMENTS UNTIL THE OWNER AND AN AUTHORIZED SURVEYOR OR AGENT, HAVE WITNESSED OR OTHERWISE REFERENCED THEIR LOCATION.
2. THE CONTRACTOR SHALL CONFINE HIS OPERATIONS TO THE AREA LOCATED WITHIN THE CONSTRUCTION LIMIT LINES, AS SHOWN PER PLANS. ANY AREA DISTURBED BEYOND THESE LIMITS SHALL BE RESTORED TO ITS ORIGINAL CONDITION AT THE CONTRACTOR'S EXPENSE.
3. IT IS INTENDED THAT ANY CULVERTS DAMAGED BY OR REMOVED BY THE CONTRACTOR OTHER THAN THOSE NOTED ON THE PLANS TO BE REMOVED WILL HAVE TO BE REMOVED AND/OR REPLACED AT THE CONTRACTOR'S SOLE EXPENSE.
4. AFTER PLACEMENT OF THE BRIDGE DECK OVERLAY, THE RESIDENT ENGINEER SHALL NOTIFY THE DISTRICT BRIDGE MAINTENANCE ENGINEER OF THE "AS CONSTRUCTED" MILLING DEPTH AND OVERLAY THICKNESS FOR UPDATING THE ILLINOIS HIGHWAY INFORMATION SYSTEM.
5. CONTINUOUS PAVING OPERATIONS ON THE MAIN ROADWAY SHALL BE MAINTAINED AT ALL TIMES DURING THE CONSTRUCTION OF THE HOT-MIX ASPHALT SURFACE. NO INTERRUPTIONS FOR SIDE ROADS, ENTRANCES, TURN LANES, ETC, WILL BE ALLOWED.
6. ILLINOIS STATE LAW REQUIRES A 48-HOUR NOTICE TO BE GIVEN TO ALL UTILITIES BEFORE DIGGING, FIELD MARKING OF FACILITIES MAY ALSO BE OBTAINED BY CALLING J.U.L.I.E. AND FOR NON-J.U.L.I.E. MEMBERS, THE UTILITY COMPANY DIRECTLY. (MEMBERS OF J.U.L.I.E.) (800) 892-0123. NON-MEMBERS OF J.U.L.I.E MUST BE NOTIFIED INDIVIDUALLY).
7. CROSSING EXISTING STRUCTURES WITH EQUIPMENT THE FOLLOWING STRUCTURES: SN ~~090-0061~~ MAY BE CROSSED WITH THE EMPTY MTD. ANY STRUCTURES NOT LISTED ABOVE SHALL BE VERIFIED BY THE RESIDENT PRIOR TO BEGINNING WORK.
8. BUTT JOINTS SHALL NOT BE MILLED MORE THAN THREE (3) DAYS PRIOR TO PLACEMENT OF THE HMA SURFACE COURSE.
9. THE RESIDENT SHALL CONTACT OPERATIONS TO VERIFY THE LOCATION OF NO PASSING ZONES PRIOR TO PLACEMENT OF CENTERLINE STRIPING.
10. THE CONTRACT SPECIAL PROVISION FOR "HOT-MIX ASPHALT JOINT TRIMMING" IS TO APPLY TO ALL MAINLINE LONGITUDINAL PAVING JOINTS.
11. POLYMERIZED BITUMINOUS MATERIALS (TACK COAT) RATES:

SURFACE TYPE	RESIDUAL RATE
MILLED (HMA OR PCC)	0.08 LB/SF (TWO APPLICATIONS)
EXISTING PAVEMENT	0.08 LB/SF
FOG COAT (BETWEEN LIFTS)	0.08 LB/SF

### COMMITMENTS

COMMITMENTS ARE NOT TO BE ALTERED WITHOUT THE WRITTEN APPROVAL OF ALL PARTIES TO WHICH THE COMMITMENT WAS MADE.

NO COMMITMENTS HAVE BEEN MADE FOR THIS PROJECT

### HOT-MIX ASPHALT MIXTURE REQUIREMENTS

MIXTURES USE(S):	BRIDGE DECK AND APPROACH PAVEMENT	SHOULDER PAVEMENT	WIDENING (9")	
	HMA PAVEMENT OVERLAY (SURFACE 1½")	HMA SHOULDERS OVERLAY (SURFACE 1½")	LIFTS (TOP - 2")	BOTTOM (2 LIFTS 3.5")
AC/PG:	SBS OR SBR 70-28	SBS OR SBR 70-28	PG 58-28	PG 58-28
DESIGN AIR VOIDS:	4.0% @ 50 GYRATION	4.0% @ 50 GYRATION	4.0% @ 50 GYRATION	4.0% @ 50 GYRATION
MIXTURE COMPOSITION: (GRADATION MIXTURE)	IL 9.5	IL 9.5	IL 9.5	IL 19.0
FRICITION AGGREGATE:	MIXTURE "D"	MIXTURE "D"	NA	NA
QUALITY MANAGAMENT PROGRAM:	QCP	QCP	QCQA	QCQA
MATERIAL TRANSFER DEVICE	NO	NO	NO	NO

### NOTES:

1. INDIVIDUAL LIFT THICKNESSES OF EACH MIX WILL BE NO LESS THAN THREE (3) TIMES NOMINAL MAXIMUM AGGREGATE SIZE AND NO MORE THAN FIVE (5) TIMES NOMINAL AGGREGATE MAXIMUM SIZE, UNLESS OTHERWISE APPROVED BY THE ENGINEER.
2. FOR DESIGN PURPOSES, MIXTURE WEIGHT FOR ALL MIXES IS DETERMINED TO BE 112.0 LB./SQ. YARD/IN., UNLESS OTHERWISE NOTED.
3. SUBLOT SIZES FOR PFP AND QCP MIXES WILL BE 1,000 TONS, UNLESS OTHERWISE AGREED TO BY THE ENGINEER AND THE PAVING CONTRACTOR.

## IDOT HIGHWAY STANDARDS

STD NO.	DESCRIPTION
000001-09	STANDARD SYMBOLS, ABBREVIATIONS AND PATTERNS
001006	DECIMAL OF AN INCH AND OF A FOOT
635001-02	DELINEATORS
701006-05	OFF-ROAD OPERATIONS, 2L, 2W, 15' (4.5 M) TO 24" (600 MM) FROM PAVEMENT EDGE
701011-04	OFF-ROAD MOVING OPERATIONS, 2L, 2W, DAY ONLY
701201-05	LANE CLOSURE, 2L, 2W, DAY ONLY, FOR SPEEDS > 45 MPH
701311-03	LANE CLOSURE, 2L, 2W, MOVING OPERATIONS - DAY ONLY
701901-11	TRAFFIC CONTROL DEVICES
781001-04	TYPICAL APPLICATIONS RAISED REFLECTIVE PAVEMENT MARKERS
782006-01	GUARDRAIL AND BARRIER WALL REFLECTOR MOUNTING DETAILS

MODEL: Unnamed Plan - General Notes (Sheet)  
FILE NAME: S:\2023\231068 - PTB 2023-23 D4 - TMM - Various PH II IIIWO 25 IL-9 BR Repairs\CADD\CADD Sheets\468K56-shit-GenNotes.dgn

 QUIGG ENGINEERING INC	USER NAME = RGoertz	DESIGNED - TO	REVISED -	STATE OF ILLINOIS DEPARTMENT OF TRANSPORTATION	INDEX OF SHEETS, HIGHWAY STANDARDS, & GENERAL NOTES IL 9	F.A.P. RTE.	SECTION	COUNTY	TOTAL SHEETS	SHEET NO.
	PLOT DATE = 11/25/2025	CHECKED - SMK	REVISIED -			693	(119BR-3)BRR	TAZEWELL	17	2
						ILLINOIS		FED. AID PROJECT		

SCALE: NONE    SHEET 1 OF 1 SHEETS    STA.    TO STA.

100% STATE

CODE NO.	ITEM	UNIT	TOTAL QUANTITY	CONSTRUCTION TYPE CODE	
				ROADWAY	BRIDGE
				0047	0047
				RURAL	S.N. 090-0061
35600712	HOT-MIX ASPHALT BASE COURSE WIDENING, 9"	SQ YD	55	55	
40600295	POLYMERIZED BITUMINOUS MATERIALS (TACK COAT)	POUND	765	294	471
40600982	HOT-MIX ASPHALT SURFACE REMOVAL - BUTT JOINT	SQ YD	38	38	
40604160	POLYMERIZED HOT-MIX ASPHALT SURFACE COURSE, IL-9.5, MIX "D", N50	TON	46	18	28
44000155	HOT-MIX ASPHALT SURFACE REMOVAL, 1 1/2"	SQ YD	163	163	
67100100	MOBILIZATION	L SUM	1	1	
70100450	TRAFFIC CONTROL AND PROTECTION, STANDARD 701201	L SUM	1	1	
70103815	TRAFFIC CONTROL SURVEILLANCE	CAL DA	3	3	
70106700	TEMPORARY RUMBLE STRIPS	EACH	4	4	
70107025	CHANGEABLE MESSAGE SIGN	CAL DA	30	30	
70300100	SHORT TERM PAVEMENT MARKING	FOOT	284	284	
70300150	SHORT TERM PAVEMENT MARKING REMOVAL	SQ FT	95	95	
* 78009004	MODIFIED URETHANE PAVEMENT MARKING - LINE 4"	FOOT	284	284	
* 78009006	MODIFIED URETHANE PAVEMENT MARKING - LINE 6"	FOOT	496	496	

\*= SPECIALTY ITEM

MODEL: Unnamed Plan-2 - Plan 1 (Sheet)  
FILE NAME: S:\2023\231068 - PTB 203-23-04 - TWM - Various Ph II ILLINO 25 IL-9 BR Repairs\CADD\CADD Sheets\468K56-shit-SQO.dgn



USER NAME = MGlim  
PLOT DATE = 11/25/2025

DESIGNED - TO  
DRAWN - TO  
CHECKED - SMK  
DATE - 11/25/2025

REVISED -  
REVISED -  
REVISED -  
REVISED -

STATE OF ILLINOIS  
DEPARTMENT OF TRANSPORTATION

SUMMARY OF QUANTITIES  
IL 9

SCALE: NONE SHEET 1 OF 2 SHEETS STA. TO STA.

F.A.P. RTE.	SECTION	COUNTY	TOTAL SHEETS	SHEET NO.
693	(119BR-3)BRR	TAZEWELL	17	3
CONTRACT NO. 68K56				
ILLINOIS FED. AID PROJECT				

100% STATE

CODE NO.	ITEM	UNIT	TOTAL QUANTITY	CONSTRUCTION TYPE CODE	
				ROADWAY	BRIDGE
				0047	0047
				RURAL	S.N. 090-0061
78300200	RAISED REFLECTIVE PAVEMENT MARKER REMOVAL	EACH	1	1	
53004556	HOT-MIX ASPHALT SURFACAE REMOVAL (DECK)	SQ YD	327		327
Z0021900	EXPANSION JOINT REPAIR	FOOT	33		33
X6350204	LINEAR DELINEATOR PANELS, 4 INCH	EACH	9	9	

MODEL: Unnamed Plan-2 - Plan 2 (Sheet)  
 FILE NAME: S:\2023\2311068 - PTB 202-23-04 - TWM - Various Phi II ILLINO 25 IL-9 BR Repairs\CADD\CADD Sheets\468K56-sh1-SQO.dgn



QUIGG ENGINEERING INC

USER NAME = MGIme	DESIGNED - TO	REVISED -
	DRAWN - TO	REVISED -
	CHECKED - SMK	REVISED -
PLOT DATE = 11/25/2025	DATE - 11/25/2025	REVISED -

**STATE OF ILLINOIS  
 DEPARTMENT OF TRANSPORTATION**

**SUMMARY OF QUANTITIES  
 IL 9**

SCALE: NONE SHEET 2 OF 2 SHEETS STA. TO STA.

F.A.P. RTE.	SECTION	COUNTY	TOTAL SHEETS	SHEET NO.
693	(119BR-3)BRR	TAZEWELL	17	4
ILLINOIS FED. AID PROJECT			CONTRACT NO. 68K56	

MODEL: Unnamed Plan - Plan 1 [Sheet]  
 FILE NAME: S:\2023\2311068 - PTB 203-23 D4 - TWM - Various PH II IIIWO 25 IL-9 BR Repairs\CADD\CADD Sheets\468K56-sht-Schedule.dgn

PAVING SCHEDULE						
LOCATION		HOT-MIX ASPHALT BASE COURSE WIDENING, 9"	POLYMERIZED BITUMINOUS MATERIALS (TACK COAT)	HOT-MIX ASPHALT SURFACE REMOVAL - BUTT JOINT	POLYMERIZED HOT-MIX ASPHALT SURFACE COURSE, IL-9.5, MIX "D", N50	HOT-MIX ASPHALT SURFACE REMOVAL, 1 1/2"
STATION	LT / RT	SQ YD	POUND	SQ YD	TON	SQ YD
<b>IL 9</b>						
505+81.50 TO 506+21.50	LT / RT					106.67
505+81.50 TO 506+31.50	LT / RT		197.04		11.43	
506+21.50 TO 506+31.50	LT / RT			37.78		
<b>SHOULDERS</b>						
505+71.42 TO 506+21.50	LT / RT					55.64
505+71.42 TO 506+31.50	LT / RT		96.12		5.67	
506+70.60 TO 507+15.15	RT	16.84				
506+79.72 TO 507+15.00	LT	37.90				
ROADWAY SUBTOTAL		54.74	293.16	37.78	17.10	162.31
USE		55	294	38	18	163
<b>SN: 090-0061</b>						
504+88.50 TO 505+51.50	LT / RT		471.00		28.00	
STRUCTURE SUBTOTAL			471.00		28.00	
USE			471		28	
GRAND TOTAL		55	765	38	46	163

PAVEMENT MARKING SCHEDULE						
LOCATION		SHORT TERM PAVEMENT MARKING	SHORT TERM PAVEMENT MARKING REMOVAL	MODIFIED URETHANE PAVEMENT MARKING - LINE 4"	MODIFIED URETHANE PAVEMENT MARKING - LINE 6"	RAISED REFLECTIVE PAVEMENT MARKER REMOVAL
STATION	LT / RT	FOOT	SQ FT	FOOT	FOOT	EACH
<b>IL 9 (IN LIEW OF FINAL)</b>						
501+74.49 TO 509+39.74	LT / RT	283.62	94.54			1
<b>IL 9 (FINAL)</b>						
501+74.49 TO 509+39.74	LT / RT			283.62	495.99	
TOTALS		283.62	94.54	283.62	495.99	1
USE		284	95	284	496	1

DELINEATOR PANELS SCHEDULE		
LOCATION		LINEAR DELINEATOR PANELS, 4 INCH
STATION	LT / RT	EACH
<b>IL 9</b>		
501+74.49 TO 506+68.38	RT	4
503+64.88 TO 507+18.63	LT	5
TOTAL		9



USER NAME = RGoertz	DESIGNED - TO	REVISED -
	DRAWN - TO	REVISED -
	CHECKED - SMK	REVISED -
PLOT DATE = 11/25/2025	DATE - 11/25/2025	REVISED -

STATE OF ILLINOIS  
 DEPARTMENT OF TRANSPORTATION

SCHEDULE OF QUANTITIES  
 IL 9

SCALE: NONE SHEET 1 OF 1 SHEETS STA. TO STA.

F.A.P. RTE.	SECTION	COUNTY	TOTAL SHEETS	SHEET NO.
693	(119BR-3)BRR	TAZEWELL	17	5
CONTRACT NO. 68K56				
ILLINOIS FED. AID PROJECT				

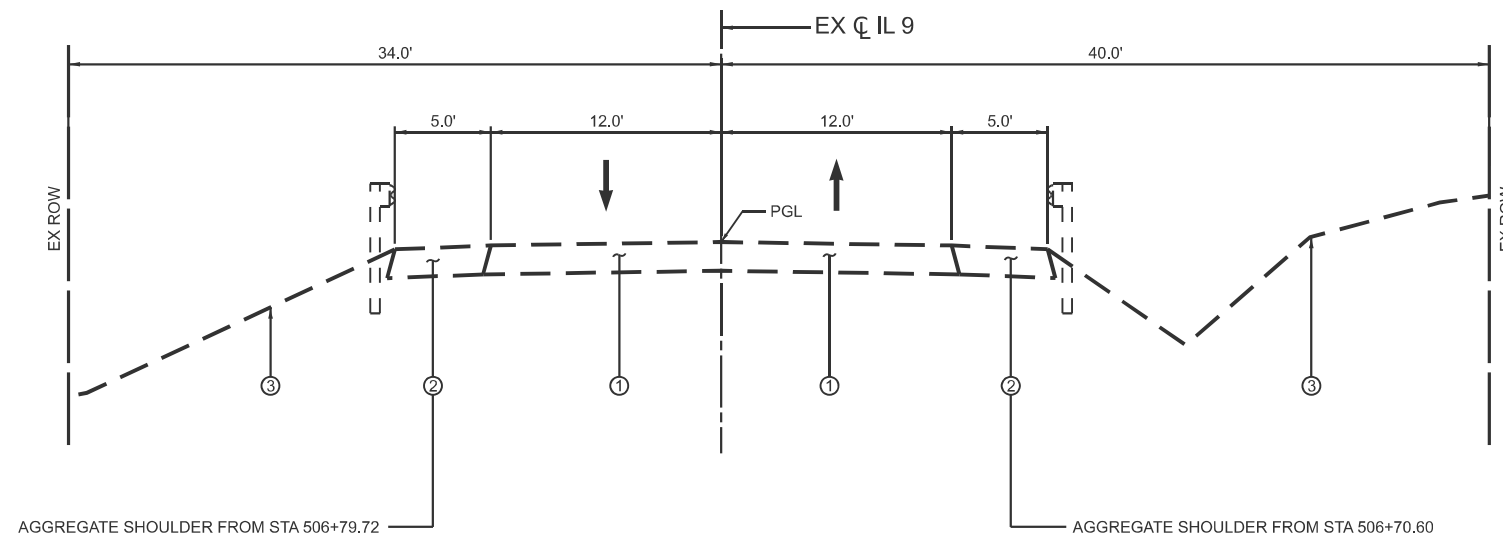

**EXISTING TYPICAL SECTION**

STA 503+60.00 TO STA 504+88.50  
 BRIDGE OMISSION: STA 504+88.50 TO STA 505+51.50  
 STA 505+51.50 TO STA 507+65.00

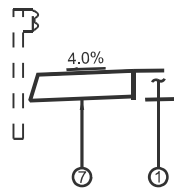

**PROPOSED TYPICAL (WIDENING)**

STA 506+79.72 TO STA 507+15.00

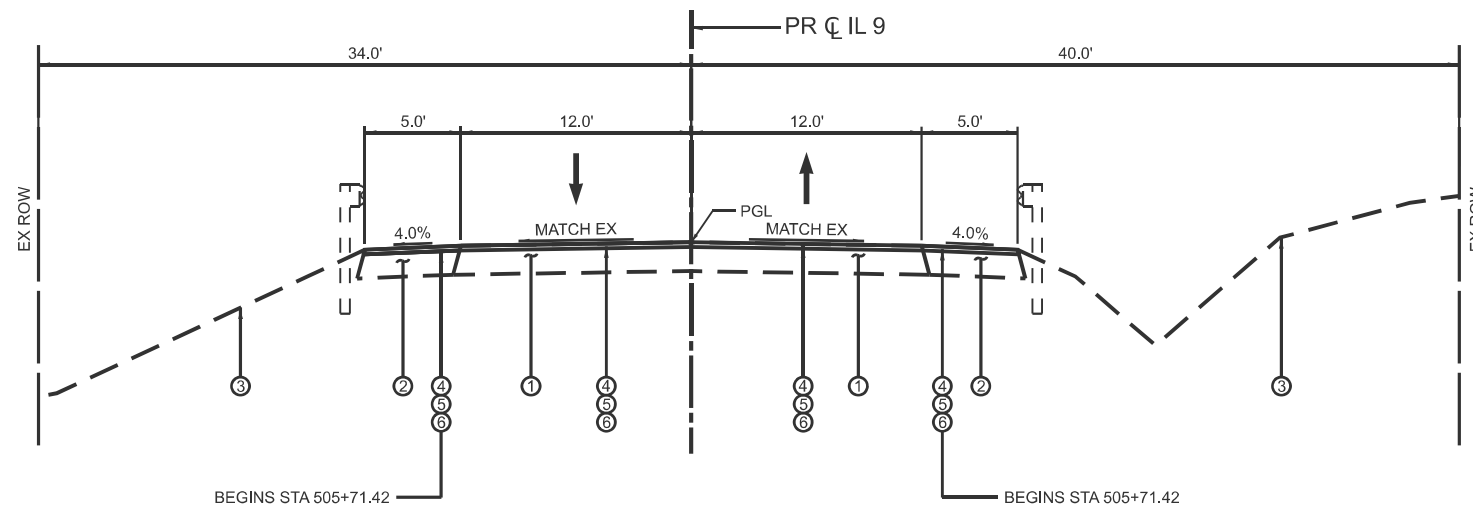

**PROPOSED TYPICAL SECTION**

STA 505+81.50 TO STA 506+31.50

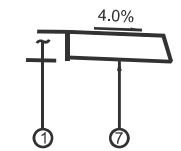

**PROPOSED TYPICAL (WIDENING)**

STA 506+70.60 TO STA 507+15.15

**LEGEND**

- ① EXISTING HMA ROADWAY
- ② EXISTING HMA SHOULDER 9"
- ③ EXISTING GROUND
- ④ POLYMERIZED HMA SURFACE COURSE, IL-9.5, MIX "D", N50 (1 1/2")
- ⑤ HOT-MIX ASPHALT SURFACE REMOVAL, 1 1/2"
- ⑥ BITUMINOUS MATERIALS (TACK COAT)
- ⑦ HOT-MIX ASPHALT BASE COURSE WIDENING, 9" (EARTHWORK INCIDENTAL)

MODEL: Typical Sections (Sheet)  
 FILE NAME: S:\2023\2311\068 - PTB 205-23 D4 - TWM - Various PH II IIIWO 25 IL-9 BR Repairs\CADD\CADD Sheets\468K56-shtrTypical.dgn



USER NAME = MGllme	DESIGNED - TO	REVISED -
	DRAWN - TO	REVISED -
	CHECKED - SMK	REVISED -
PLOT DATE = 11/25/2025	DATE - 11/25/2025	REVISED -

**STATE OF ILLINOIS  
 DEPARTMENT OF TRANSPORTATION**

**TYPICAL SECTIONS  
 IL 9**

SCALE: NONE SHEET 1 OF 1 SHEETS STA. TO STA.

F.A.P. RTE.	SECTION	COUNTY	TOTAL SHEETS	SHEET NO.
693	(119BR-3)BRR	TAZEWELL	17	6
CONTRACT NO. 68K56				
ILLINOIS FED. AID PROJECT				

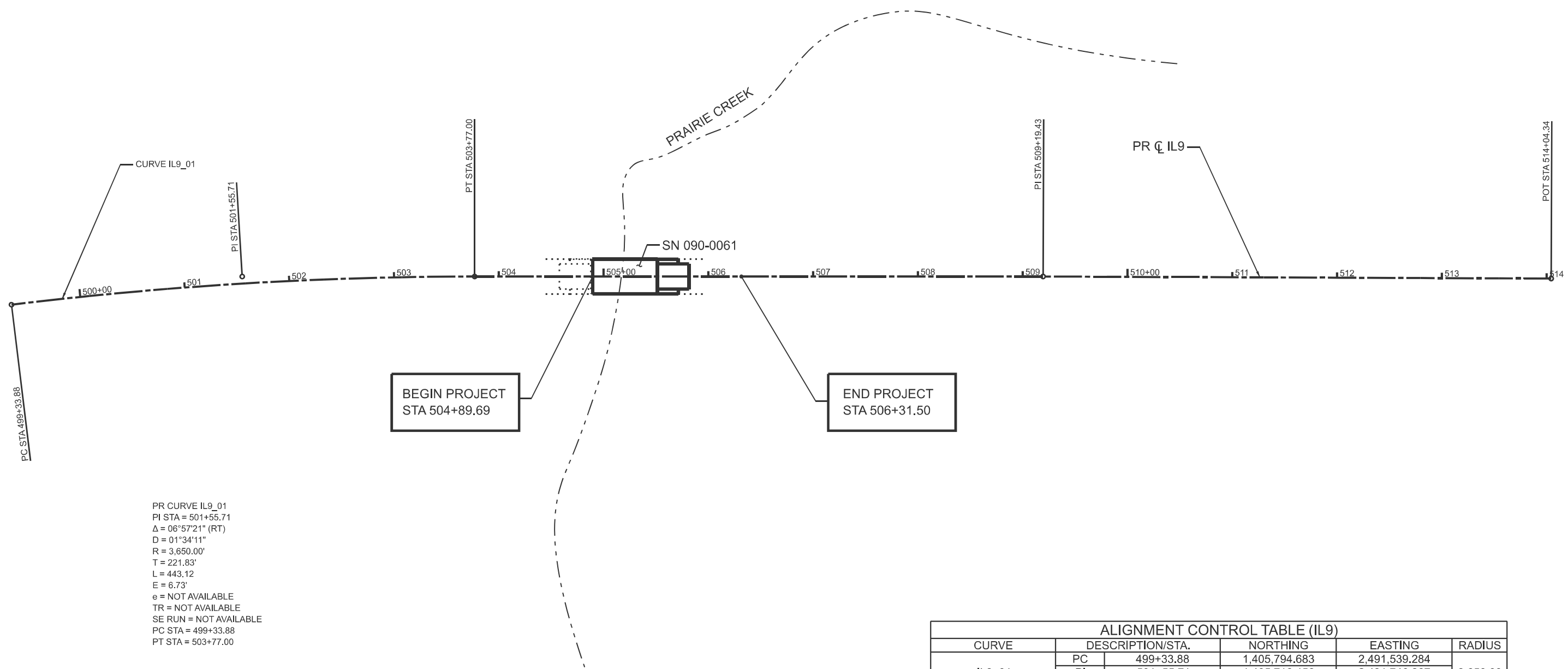
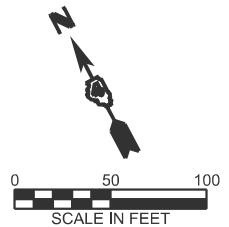

PR CURVE IL9\_01  
 PI STA = 501+55.71  
 $\Delta = 06^{\circ}57'21''$  (RT)  
 $D = 01^{\circ}34'11''$   
 $R = 3,650.00'$   
 $T = 221.83'$   
 $L = 443.12$   
 $E = 6.73'$   
 $e =$  NOT AVAILABLE  
 $TR =$  NOT AVAILABLE  
 $SE RUN =$  NOT AVAILABLE  
 PC STA = 499+33.88  
 PT STA = 503+77.00

ALIGNMENT CONTROL TABLE (IL9)				
CURVE	DESCRIPTION/STA.	NORTHING	EASTING	RADIUS
IL9_01	PC	499+33.88	1,405,794.683	2,491,539.284
	PI	501+55.71	1,405,716.456	2,491,746.867
	PT	503+77.00	1,405,613.666	2,491,943.449
	PI	509+19.43	1,405,362.324	2,492,424.128
	POT	514+04.34	1,405,135.909	2,492,852.940

MODEL: PCL\_IL9\_ATB [Sheet]  
 FILE NAME: S:\2023\231068 - PTB 205-23 D4 - TWM - Various Ph II ILLINOIS - Various Ph II ILLINOIS CADD\CADD Sheets\468K56-sht-ATB.dgn



USER NAME = RGoertz	DESIGNED - MG	REVISED -
	DRAWN - MG	REVISED -
	CHECKED - SMK	REVISED -
PLOT DATE = 11/25/2025	DATE - 11/25/2025	REVISED -

**STATE OF ILLINOIS**  
**DEPARTMENT OF TRANSPORTATION**

**ALIGNMENT DIAGRAM**  
**IL 9**

SCALE: 1"=50'    SHEET 1 OF 1 SHEETS    STA. 499+33.88 TO STA. 514+04.34

F.A.P. RTE. 693	SECTION (119BR-3)BRR	COUNTY TAZEWELL	TOTAL SHEETS 17	SHEET NO. 7
ILLINOIS FED. AID PROJECT			CONTRACT NO. 68K56	

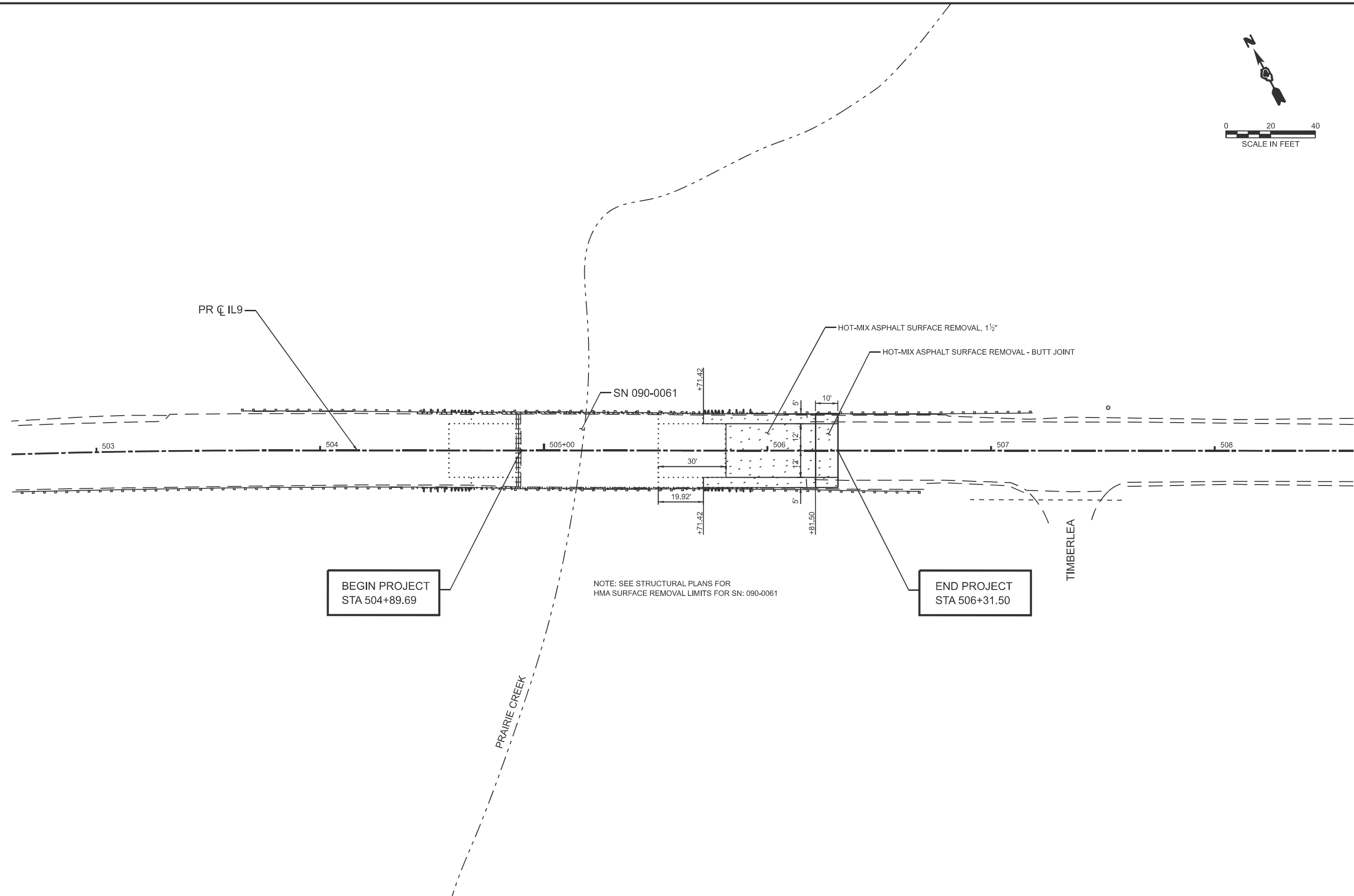
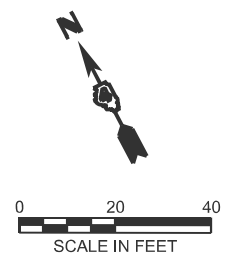

BEGIN PROJECT  
STA 504+89.69

NOTE: SEE STRUCTURAL PLANS FOR  
HMA SURFACE REMOVAL LIMITS FOR SN: 090-0061

END PROJECT  
STA 506+31.50

MODEL: PCL IL9 - REM-1 [Sheet]  
FILE NAME: S:\2023\231068 - PTB 205-23 D4 - TWM - Various PH II IIIWO 25 IL-9 BR Repairs\CADD\CADD Sheets\468K56-sht-Rem.dgn



USER NAME = TOverton	DESIGNED - MG	REVISED -
	DRAWN - MG	REVISED -
	CHECKED - SMK	REVISED -
PLOT DATE = 11/24/2025	DATE - 11/25/2025	REVISED -

**STATE OF ILLINOIS  
DEPARTMENT OF TRANSPORTATION**

**REMOVAL PLAN  
IL 9**

SCALE: 1"=20'    SHEET 1 OF 1 SHEETS    STA. 502+20.00 TO STA. 508+20.00

F.A.P. RTE. 693	SECTION (119BR-3)BRR	COUNTY TAZEWELL	TOTAL SHEETS 17	SHEET NO. 8
ILLINOIS FED. AID PROJECT			CONTRACT NO. 68K56	

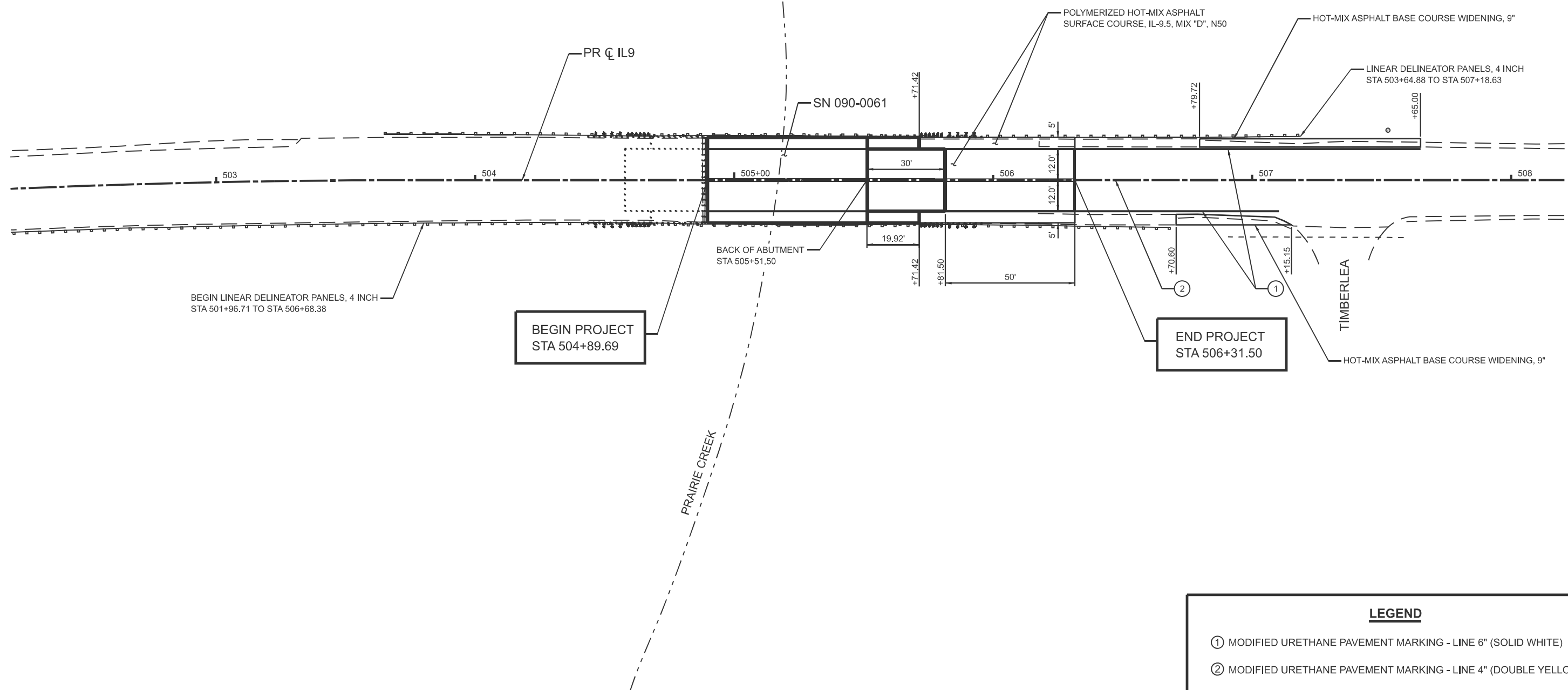
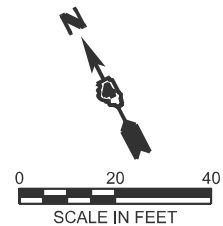

LEGEND				
①	MODIFIED URETHANE PAVEMENT MARKING - LINE 6" (SOLID WHITE)			
②	MODIFIED URETHANE PAVEMENT MARKING - LINE 4" (DOUBLE YELLOW)			

MODEL: PCL\_IL9\_Plan 1 [Sheet]  
 FILE NAME: S:\2023\231068 - PTB 205-23.D4 - TWM - Various Ph II IIIWO 25 IL-9 BR Repairs\CADD\CADD Sheets\468K56-sh1-RDWY.dgn



USER NAME = RGoertz	DESIGNED - TO	REVISED -
	DRAWN - MG	REVISED -
	CHECKED - SMK	REVISED -
PLOT DATE = 11/25/2025	DATE - 11/25/2025	REVISED -

**STATE OF ILLINOIS**  
**DEPARTMENT OF TRANSPORTATION**

**ROADWAY PLAN**  
**IL 9**

SCALE: 1"=20'    SHEET 1 OF 1 SHEETS    STA. 502+20.00 TO STA. 508+20.00

F.A.P. RTE.	SECTION	COUNTY	TOTAL SHEETS	SHEET NO.
693	(119BR-3)BRR	TAZEWELL	17	9
CONTRACT NO. 68K56				
ILLINOIS FED. AID PROJECT				

MODEL: Unnamed Plan-1 - Plan 1 (Sheet)  
 FILE NAME: S:\2023\231068 - PTB 202-23 D4 - TWM - Various PH II IIIWO 25 IL-9 BR Repairs\CADD\CADD Sheets\468K56-shh-Starting.dgn

**CONSTRUCTION SEQUENCE**

CONSTRUCT HOT-MIX ASPHALT BASE COURSE WIDENING 9".

MILL AND PAVE WESTBOUND PAVEMENT, BRIDGE DECK, APPROACH SLAB, AND SHOULDERS.  
 THE MILLING, CLEANING, TACK COATING, AND PAVING SHALL BE DONE IN A SINGLE DAY.  
 TRAFFIC SHALL NOT BE ALLOWED TO DRIVE ON MILLED SURFACE.

MILL AND PAVE EASTBOUND PAVEMENT, BRIDGE DECK, APPROACH SLAB, AND SHOULDERS.  
 THE MILLING, CLEANING, TACK COATING, AND PAVING SHALL BE DONE IN A SINGLE DAY.  
 TRAFFIC SHALL NOT BE ALLOWED TO DRIVE ON MILLED SURFACE.

PERFORM EXPANSION JOINT REPAIRS.

PAVEMENT MARKINGS AND CLEAN UP.

**MAINTENANCE OF TRAFFIC NOTES**

ALL HMA AND BRIDGE EXPANSION JOINT WORK WILL BE PERFORMED UNDER HIGHWAY STANDARD 701201 USING FLAGGERS.

A MINIMUM OF THREE FLAGGERS SHALL BE USED TO CONTROL EASTBOUND AND WESTBOUND IL 9 TRAFFIC AND TIMBERLEA TRAFFIC. THE ADDITIONAL FLAGGER WILL BE INCLUDED IN THE COST FOR HIGHWAY STANDARD 701201.

AN ADDITIONAL FLAGGER WITH SLOW PADDLE IS REQUIRED ANYTIME WORK IS BEING PERFORMED ON THE EXPANSION JOINTS TO SERVE AS A SPOTTER. THE ADDITIONAL FLAGGER WILL BE INCLUDED IN THE COST FOR HIGHWAY STANDARD 701201.

TEMPORARY RUMBLE STRIPS ARE TO BE INSTALLED PRIOR TO STARTING CONSTRUCTION IN LINE WITH WITH THE ROAD COSTRUCTION AHEAD SIGNS AND 500' IN ADVANCE OF THE BRIDGE IN EACH DIRECTION OF IL 9.



USER NAME = RGoertz	DESIGNED - TO	REVISED -
	DRAWN - TO	REVISED -
	CHECKED - SMK	REVISED -
PLOT DATE = 11/25/2025	DATE - 11/25/2025	REVISED -

**STATE OF ILLINOIS  
 DEPARTMENT OF TRANSPORTATION**

**CONSTRUCTION SEQUENCE AND MAINTENANCE OF TRAFFIC  
 IL 9**

SCALE: NONE SHEET 1 OF 1 SHEETS STA. TO STA.

F.A.P. RTE.	SECTION	COUNTY	TOTAL SHEETS	SHEET NO.
693	(119BR-3)BRR	TAZEWELL	17	10
ILLINOIS FED. AID PROJECT			CONTRACT NO. 68K56	

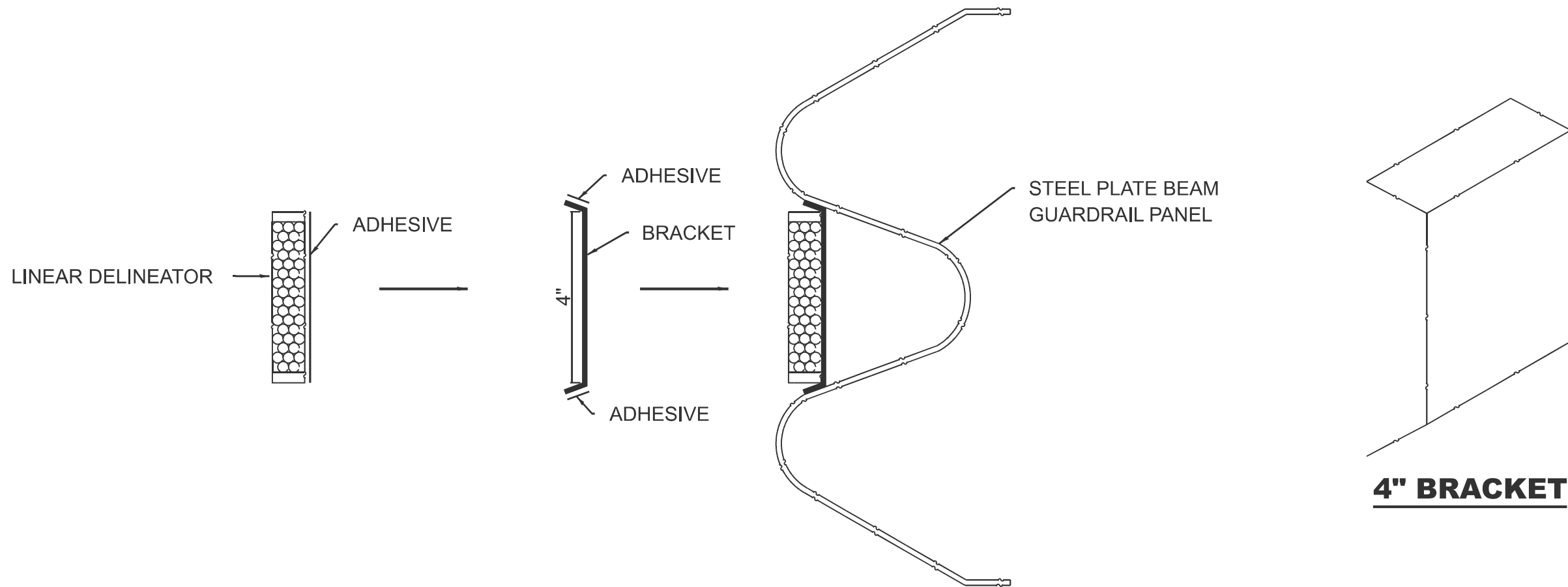

**4" BRACKET**

# **LINEAR DELINEATOR APPLICATION TO STANDARD GALVANIZED GUARDRAIL**

LINEAR DELINEATOR SHALL BE APPLIED ACCORDING TO THE MANUFACTURER'S RECOMMENDATIONS

MODEL: D4 STD (Sheet) FILE NAME: S:\2023\231068 - PTB 205-23 D4 - TWM - Various Ph II IIIWO 25 IL-9 BR Repairs\CADD\CADD Sheets\D468K56-shh-District Strls.dgn

USER NAME = RGoertz	DESIGNED -	REVISED -
	DRAWN -	REVISED -
	CHECKED -	REVISED -
PLOT DATE = 11/25/2025	DATE -	REVISED -

**STATE OF ILLINOIS  
DEPARTMENT OF TRANSPORTATION**

**DISTRICT 4 STANDARD DETAILS  
LINEAR DELINEATOR APPLICATION (NO. 635003)**

SCALE: NONE    SHEET 1 OF 3 SHEETS    STA.    TO STA.

F.A.P. RTE.	SECTION	COUNTY	TOTAL SHEETS	SHEET NO.
693	(119BR-3)BRR	TAZEWELL	17	11
CONTRACT NO. 68K56				
ILLINOIS FED. AID PROJECT				

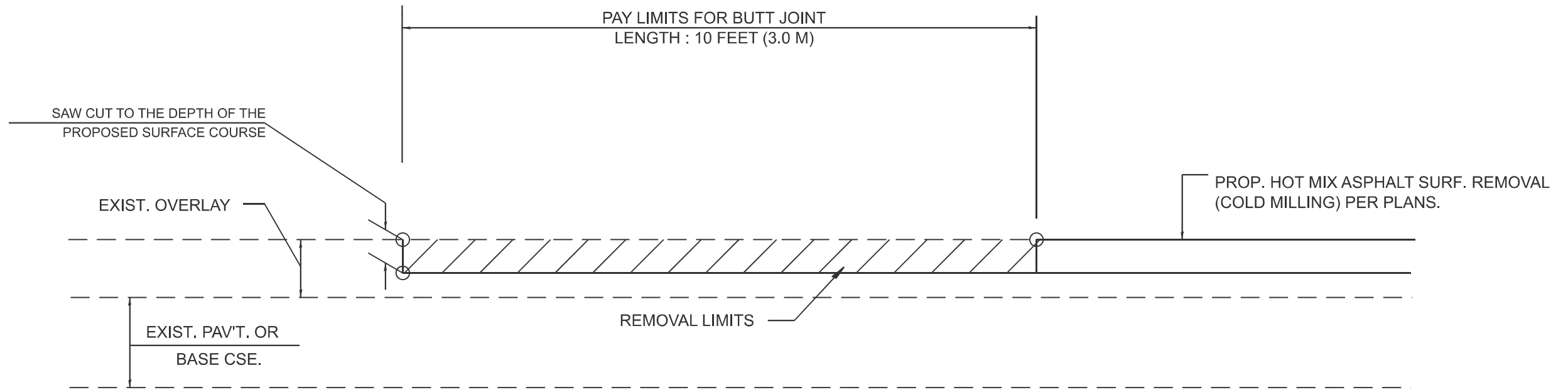

**CASE 4 : SINGLE LIFT OVERLAY WITH EQUIVALENT DEPTH  
HOT MIX ASPHALT SURFACE REMOVAL (COLD MILLING)  
TIE-IN TO EXISTING BITUMINOUS TAPER**

ALL DIMENSIONS ARE IN INCHES (MILLIMETERS)  
UNLESS OTHERWISE NOTED.

MODEL: D4 STD-1 [Sheet]  
FILE NAME: S:\2023\231068 - PTB 205-23 D4 - TWM - Various Ph II IIWVO 25 IL-9 BR Repairs\CADD\CADD Sheets\468K56-shh-District Strs.dgn

USER NAME = RGoertz	DESIGNED -	REVISED -
	DRAWN -	REVISED -
	CHECKED -	REVISED -
PLOT DATE = 11/25/2025	DATE -	REVISED -

**STATE OF ILLINOIS  
DEPARTMENT OF TRANSPORTATION**

**DISTRICT 4 STANDARD DETAILS  
BUTT JOINT (NO. 406101)**

SCALE: NONE SHEET 2 OF 3 SHEETS STA. TO STA.

F.A.P. RTE.	SECTION	COUNTY	TOTAL SHEETS	SHEET NO.
693	(119BR-3)BRR	TAZEWELL	17	12
ILLINOIS FED. AID PROJECT			CONTRACT NO. 68K56	



Existing Structure: S.N. 090-0061, originally built in 1928 as a single span structure on closed cantilever abutments. The superstructure was replaced in 2007 using PPC deck beams. The back to back length = 63'-0" and the out to out width = 33'-0". Structure is to be repaired as detailed in these plans. Traffic is to be maintained using stage construction.

No salvage.

**TOTAL BILL OF MATERIAL**

ITEM	UNIT	SUPER	SUB	TOTAL
Polymerized Bituminous Materials (Tack Coat)	Pound	471		471
Polymerized Hot-Mix Asphalt Surface Course, IL-9.5, Mix "D", N50	Ton	28		28
Hot-Mix Asphalt Surface Removal (Deck)	Sq. Yd.	327		327
Expansion Joint Repair	Foot	33		33

**GENERAL NOTES**

Plan dimensions and details relative to the existing structure have been taken from existing plans are subject to nominal construction variations. The Contractor shall field verify existing dimensions and details affecting new construction and make necessary approved adjustments prior to construction or ordering of materials. Such variations shall not be cause for additional compensation for a change in scope of the work, however, the Contractor will be paid for the quantity actually furnished at the unit price bid for the work.

The Contractor shall exercise care not to damage the existing Waterproofing Membrane System on the beams during the HMA removal process.

No field welding is permitted except as specified in the contract documents.

**SCOPE OF WORK**

1. Remove 1½" of existing overlay on bridge deck and east approach pavement.
2. Place 1½" HMA overlay on bridge deck and east approach pavement.
3. Remove and replace west expansion joint material.

**INDEX OF SHEETS**

1. General Plan and Elevation
2. Stage Construction Details
3. Deck Overlay Plan
4. Deck Overlay Details

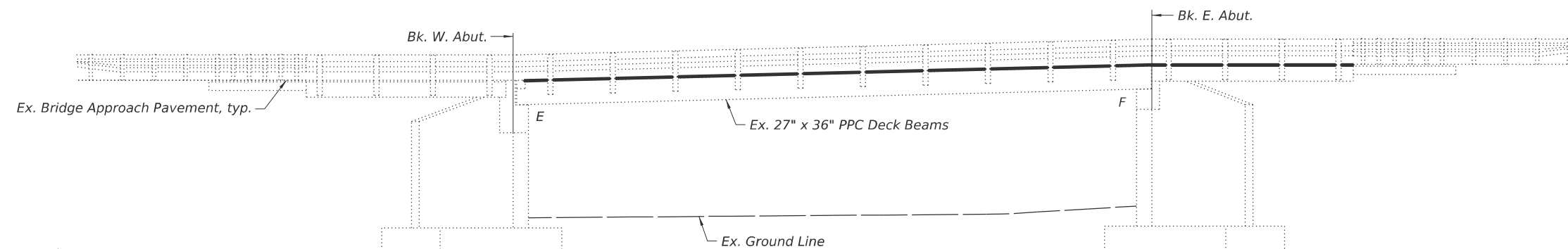

**ELEVATION**

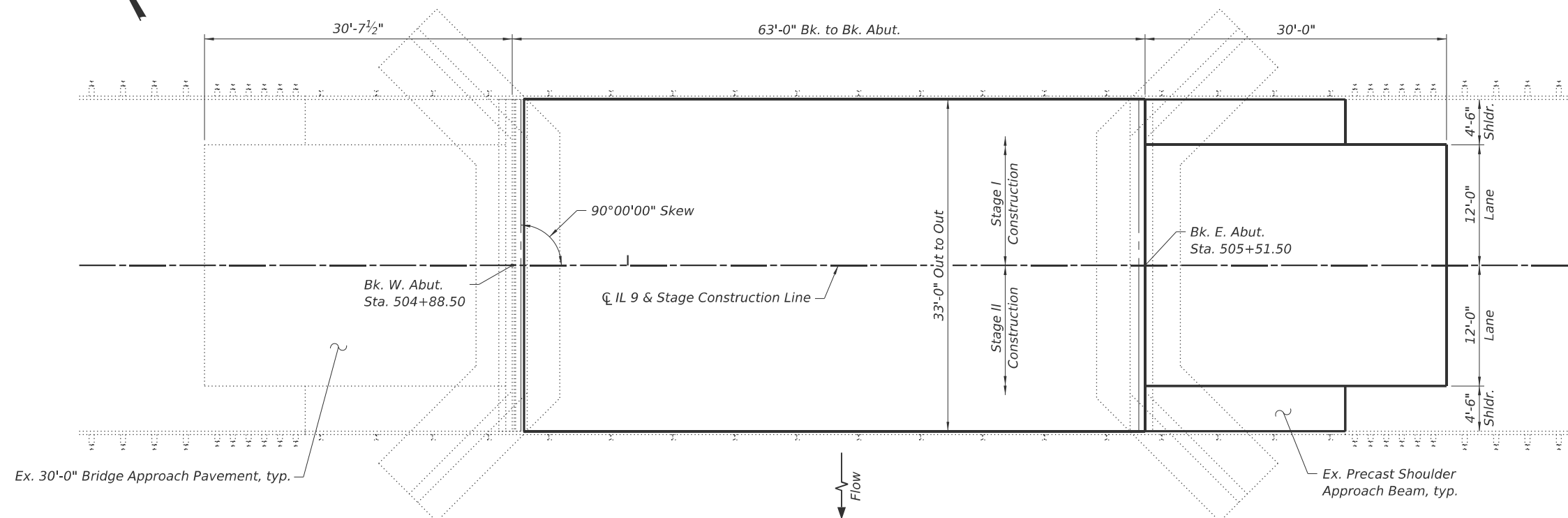

**PLAN**

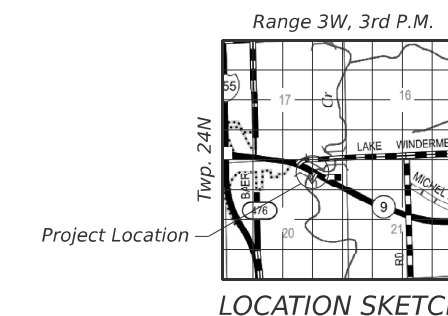

**GENERAL PLAN AND ELEVATION  
IL 9 OVER PRAIRIE CREEK  
FAP ROUTE 693  
SECTION (119BR-3)BRR  
TAZEWELL COUNTY  
STRUCTURE NO. 090-0061**

**DESIGN SPECIFICATIONS**  
2002 AASHTO Standard Specifications  
for Highway Bridges - LFD

**LOADING HS20-44**  
No Allowance for Future Wearing Surface

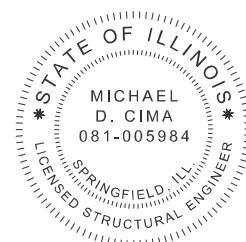

*Michael D. Cima*  
Michael D. Cima, Illinois S.E. 081-005984  
Date 11/18/2025  
Expires 11/30/2026

**STATE OF ILLINOIS  
DEPARTMENT OF TRANSPORTATION**

**GENERAL PLAN AND ELEVATION  
STRUCTURE NO. 090-0061**

SHEET 1 OF 4 SHEETS

F.A.P. RTE.	SECTION	COUNTY	TOTAL SHEETS	SHEET NO.
693	(119BR-3)BRR	TAZEWELL	17	14
CONTRACT NO. 68K56				

ILLINOIS FED. AID PROJECT



USER NAME = CStokes	DESIGNED - CFS	REVISD -
0900061-D468K56-001-GPE.dgn	CHECKED - ZLD	REVISD -
PLOT SCALE = \$SCALE\$	DRAWN - CFS	REVISD -
PLOT DATE = 11/18/2025	CHECKED - MDC	REVISD -

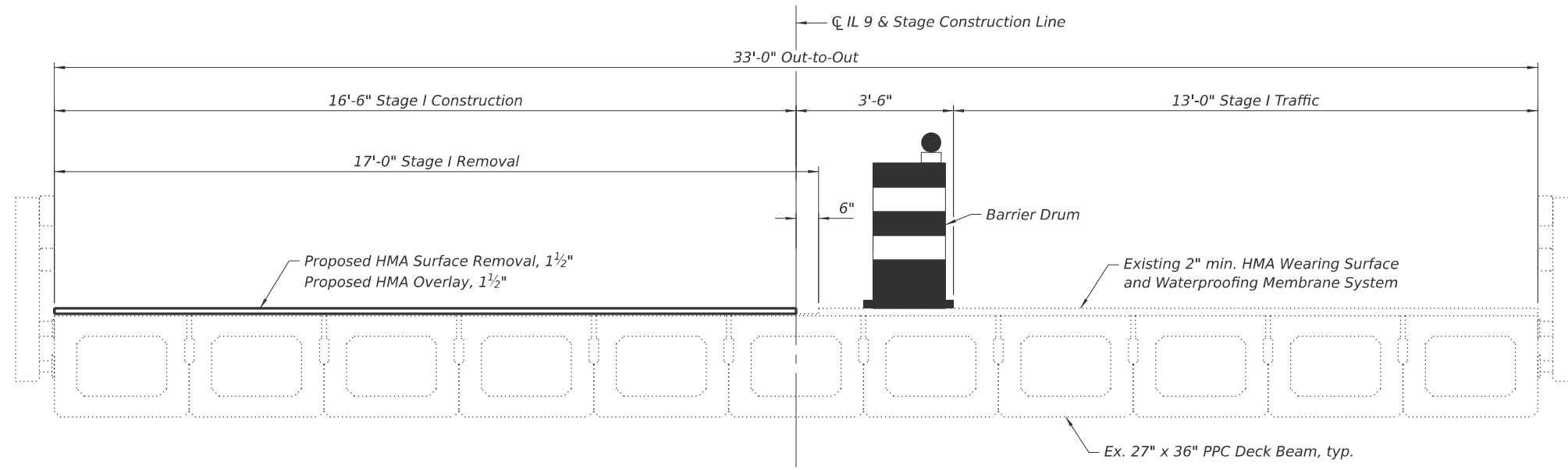

**STAGE I CONSTRUCTION**  
(Looking East)

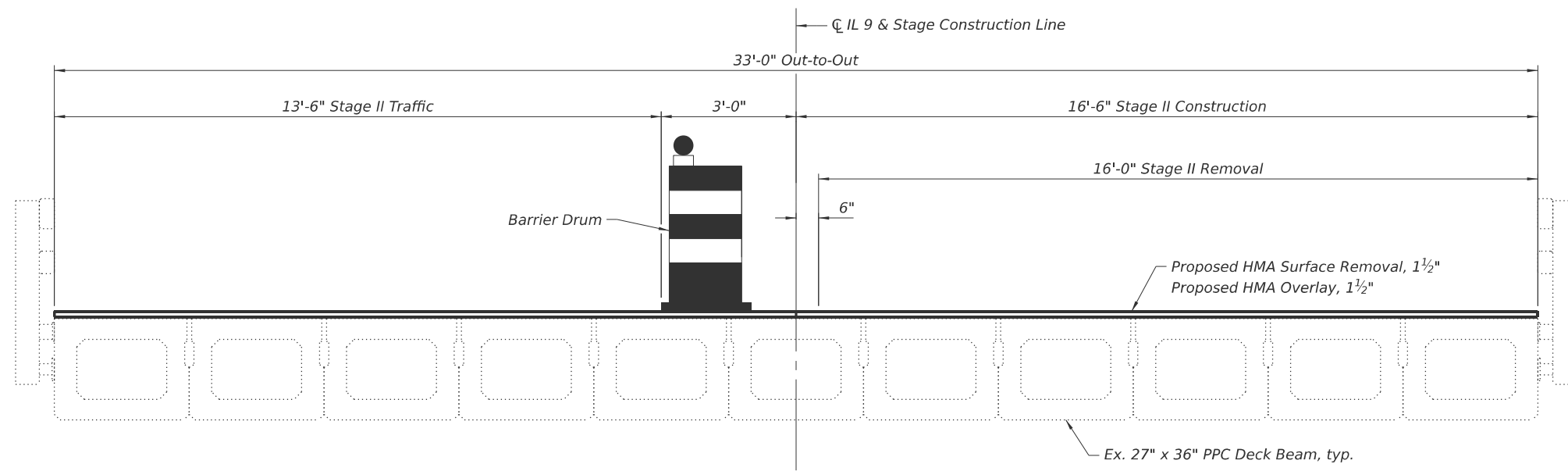

**STAGE II CONSTRUCTION**  
(Looking East)

MODEL: Default  
 FILE NAME: S:\2023\231068 - PTB 209-23 D4 - TWM - Various Ph I II IIIWO 25 IL-9 BR Repairs\CADD\CADD Sheets\0900061-D468K56-002-StageConstr.dgn  
 11/24/2025 5:15:31 PM



USER NAME = CStokes	DESIGNED - CFS	REVISED -
0900061-D468K56-002-StageConstr.dgn	CHECKED - ZLD	REVISED -
PLOT SCALE = \$SCALE\$	DRAWN - CFS	REVISED -
PLOT DATE = 11/18/2025	CHECKED - MDC	REVISED -

**STATE OF ILLINOIS  
DEPARTMENT OF TRANSPORTATION**

**STAGE CONSTRUCTION DETAILS  
STRUCTURE NO. 090-0061**

SHEET 2 OF 4 SHEETS

F.A.P. RTE.	SECTION	COUNTY	TOTAL SHEETS	SHEET NO.
693	(119BR-3)BRR	TAZEWELL	17	15
CONTRACT NO. 68K56				
ILLINOIS FED. AID PROJECT				

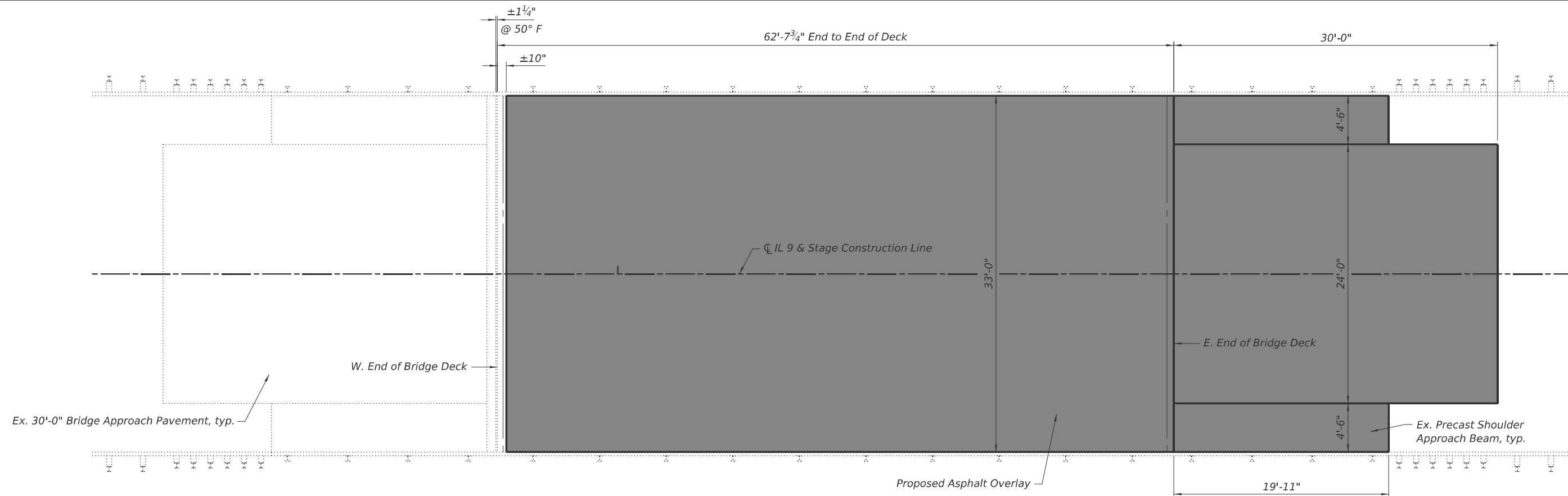

**PLAN**

**LEGEND**

HMA Surface Removal and HMA Overlay Limits

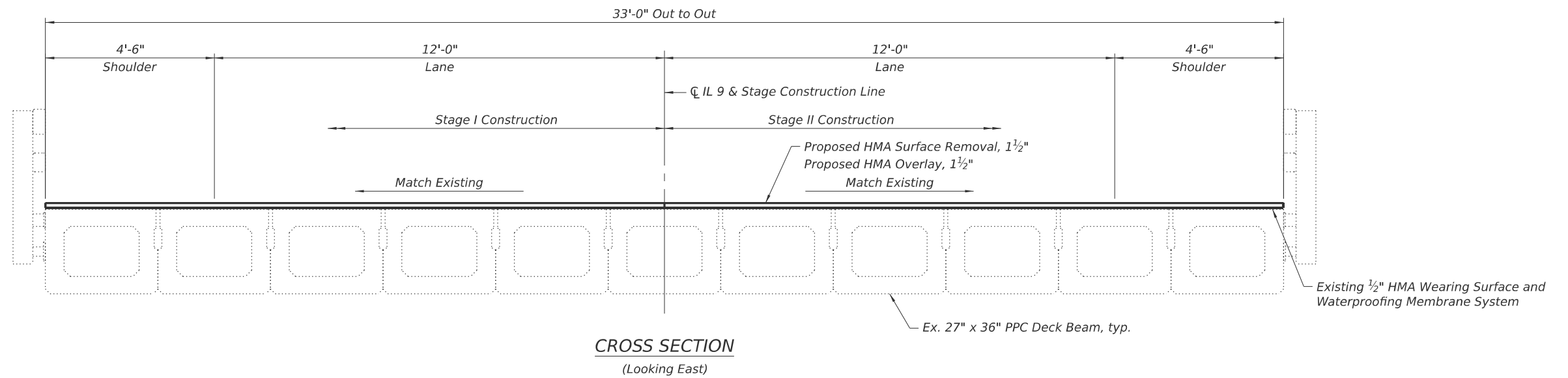

**CROSS SECTION**  
(Looking East)

**BILL OF MATERIAL**

Item	Unit	Total
Polymerized Hot-Mix Asphalt Surface Course, IL-9.5, Mix "D", N50	Ton	28
Hot-Mix Asphalt Surface Removal (Deck)	Sq. Yd.	327

MODEL: Default  
 FILE NAME: S:\2023\31068 - PTB 209-23 D4 - TWM - Various Pth I\111WO 25 IL-9 BR Repairs\CADD\CADD Sheets\0900061-D468K56-004-Plan.dgn  
 11/24/2025 5:15:31 PM



USER NAME = CStokes	DESIGNED - CFS	REVISED -
0900061-D468K56-004-Plan.dgn	CHECKED - ZLD	REVISED -
PLOT SCALE = \$SCALE\$	DRAWN - CFS	REVISED -
PLOT DATE = 11/18/2025	CHECKED - MDC	REVISED -

**STATE OF ILLINOIS  
DEPARTMENT OF TRANSPORTATION**

**DECK OVERLAY PLAN  
STRUCTURE NO. 090-0061**

SHEET 3 OF 4 SHEETS

F.A.P. RTE. 693	SECTION (119BR-3)BRR	COUNTY TAZEWELL	TOTAL SHEETS 17	SHEET NO. 16
CONTRACT NO. 68K56				
ILLINOIS FED. AID PROJECT				

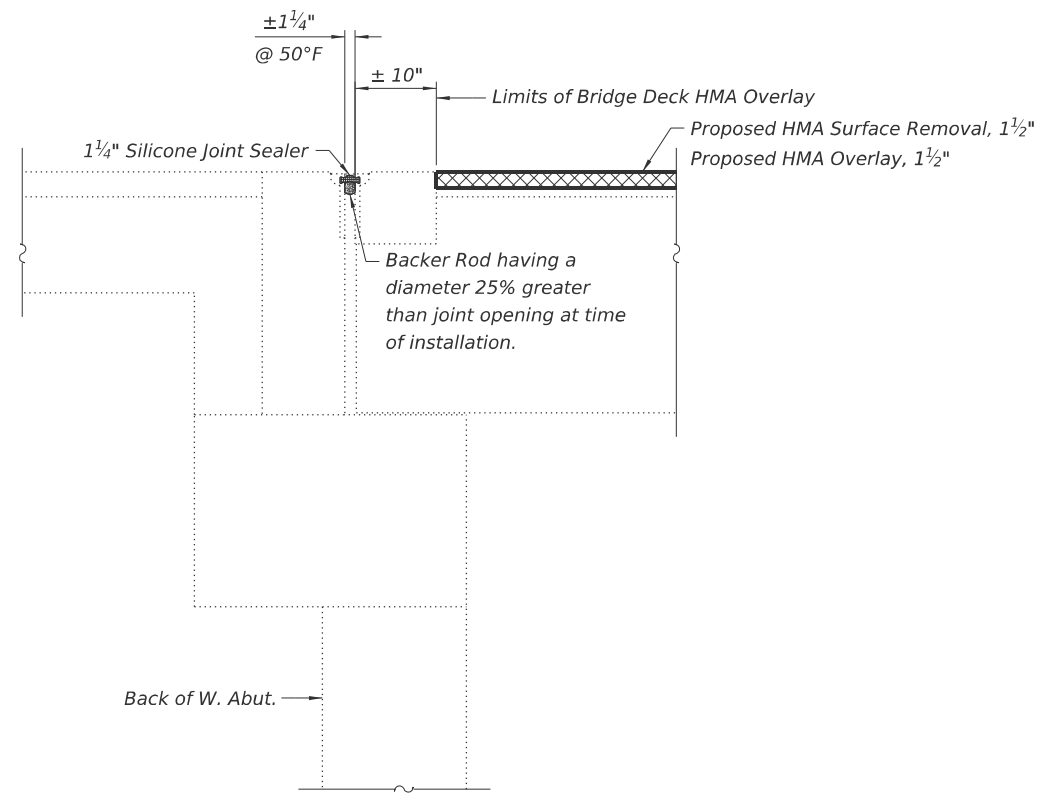

**SECTION THRU WEST ABUTMENT**

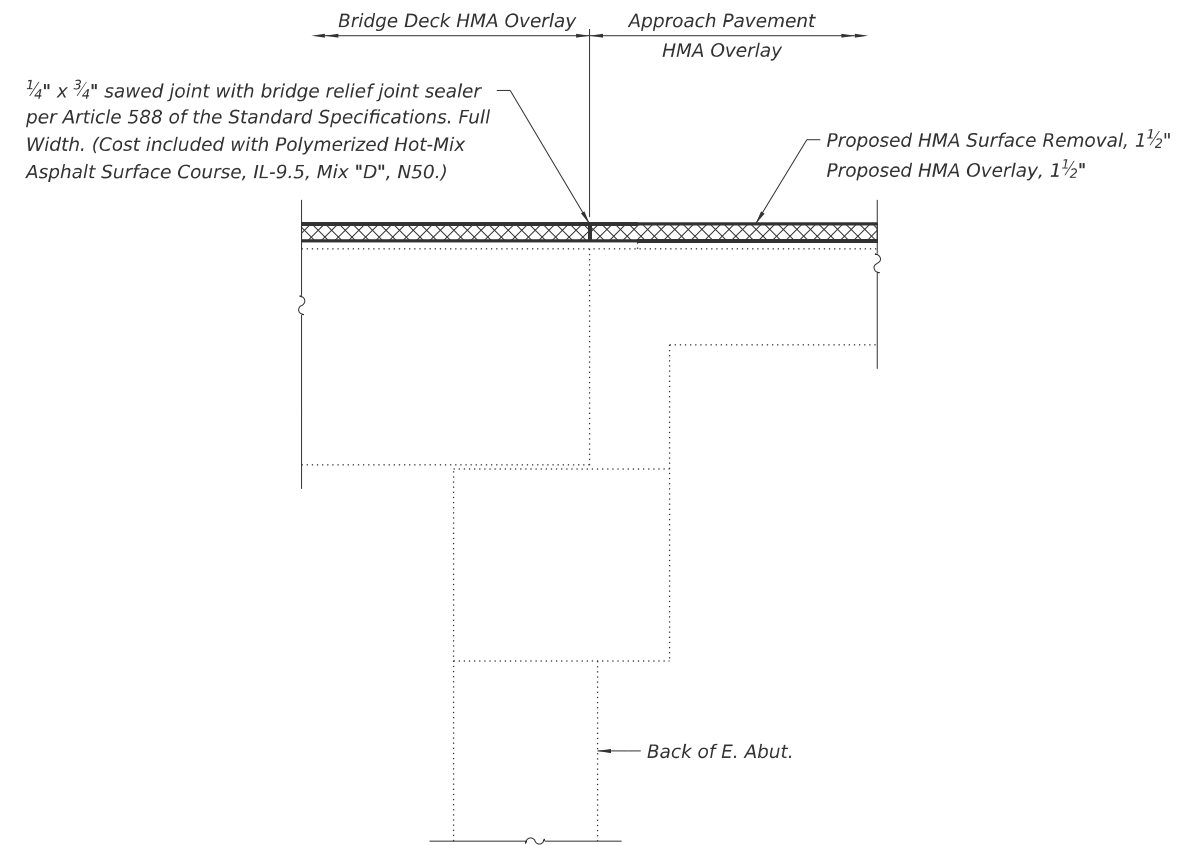

**SECTION THRU EAST ABUTMENT**

*Note:*  
See special provision for Expansion Joint Repair details.

**BILL OF MATERIAL**

Item	Unit	Total
Expansion Joint Repair	Foot	33

MODEL: Default  
FILE NAME: S:\2023\231068 - PTB 2023 D4 - TWM - Various Pth I\IWO 25 IL-9 BR Repairs\CADD\CADD Sheets\0900061-D468K56-005-Details.dgn



USER NAME = CStokes	DESIGNED - CFS	REVISED -
0900061-D468K56-005-Details.dgn	CHECKED - ZLD	REVISED -
PLOT SCALE = \$SCALE\$	DRAWN - CFS	REVISED -
PLOT DATE = 11/18/2025	CHECKED - MDC	REVISED -

**STATE OF ILLINOIS  
DEPARTMENT OF TRANSPORTATION**

**DECK OVERLAY DETAILS  
STRUCTURE NO. 090-0061**

SHEET 4 OF 4 SHEETS

F.A.P. RTE. 693	SECTION (119BR-3)BRR	COUNTY TAZEWELL	TOTAL SHEETS 17	SHEET NO. 17
CONTRACT NO. 68K56			ILLINOIS FED. AID PROJECT	