

INDEX OF SHEETS

- 1 COVER SHEET
- 2 GENERAL NOTES AND COMMITMENTS
- 3 SUMMARY OF QUANTITIES
- 4 LOCATION MAP
- 5 RIPRAP DETAILS
- 6-7 STRUCTURE INFORMATION

HIGHWAY STANDARDS

- 000001-09 STANDARD SYMBOLS, ABBREVIATIONS AND PATTERNS
- 701001-02 OFF-RD OPERATIONS, 2L, 2W, MORE THAN 15' (4.5m) AWAY
- 701006-05 OFF-RD OPERATIONS, 2L, 2W, 15' (4.5m) TO 24" (600mm) FROM PAVEMENT EDGE
- 701011-04 OFF-RD MOVING OPERATIONS 2L, 2W, DAY ONLY
- 701201-05 LANE CLOSURE, 2L, 2W, DAY ONLY, FOR SPEEDS ≥ 45 MPH
- 701301-04 LANE CLOSURE, 2L, 2W, SHORT TIME OPERATIONS
- 701901-11 TRAFFIC CONTROL DEVICES

TRAFFIC DATA - ADT

LOCATION 1 - 2050 (2023)
MINOR ARTERIAL

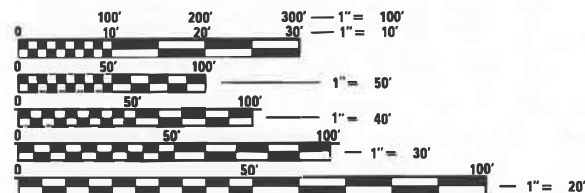

FULL SIZE PLANS HAVE BEEN PREPARED USING STANDARD ENGINEERING SCALES. REDUCED SIZED PLANS WILL NOT CONFORM TO STANDARD SCALES. IN MAKING MEASUREMENTS ON REDUCED PLANS, THE ABOVE SCALES MAY BE USED.

J.U.L.I.E.
JOINT UTILITY LOCATION INFORMATION FOR EXCAVATORS
1-800-892-0123
OR 811

PROJECT ENGINEER: BEN TELLEFSON
PROJECT MANAGER: MARK ECKHOFF
CONTRACT NO. 68K57
CATALOG NO. 036695-00D

STATE OF ILLINOIS
DEPARTMENT OF TRANSPORTATION
DIVISION OF HIGHWAYS

PROPOSED
HIGHWAY PLANS

FAP 646 (IL 40)
SECTION (124BR)SCR
INSTALL RIPRAP AT BOTH
ENDS OF SN 062-2001
MARSHALL COUNTY

C-94-106-25

SN 062-2001
STA 417+24
39° SKEW RT AHEAD
DOUBLE 10'x8' BOX CULVERT

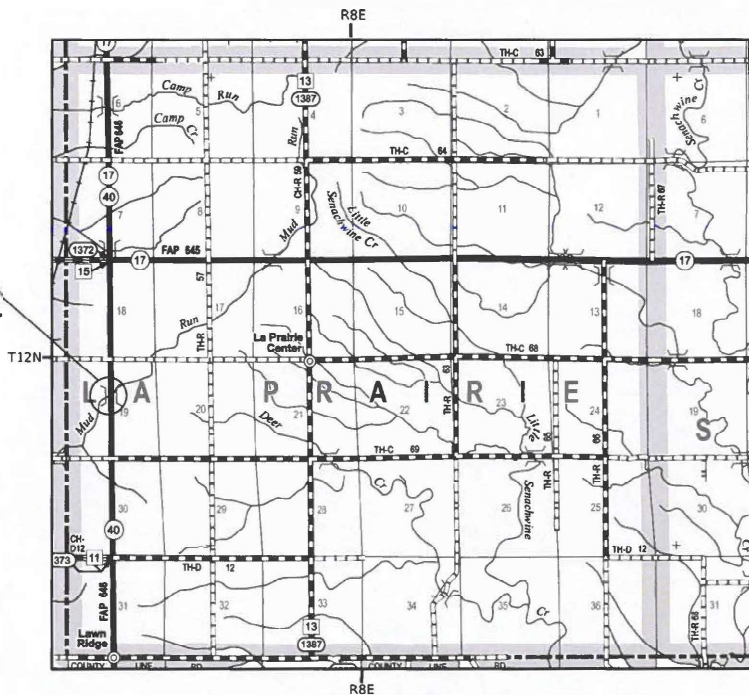

LOCATION MAP
0.5" = 1000'

GROSS LENGTH = 117.08 FT. = 0.022 MILE
NET LENGTH = 117.08 FT. = 0.022 MILE

LICENSED PROFESSIONAL ENGINEER
TIMOTHY B. PADGETT, P.E.
LICENSE NO. 062-049162
EXPIRATION DATE 11-30-2027
SIGNED DATE 12-05-2025

F.A.P. RTE.	SECTION	COUNTY	TOTAL SHEETS	SHEET NO.
646	(124BR)SCR	MARSHALL	7	1
		ILLINOIS	CONTRACT NO. 68K57	

D-94-092-25

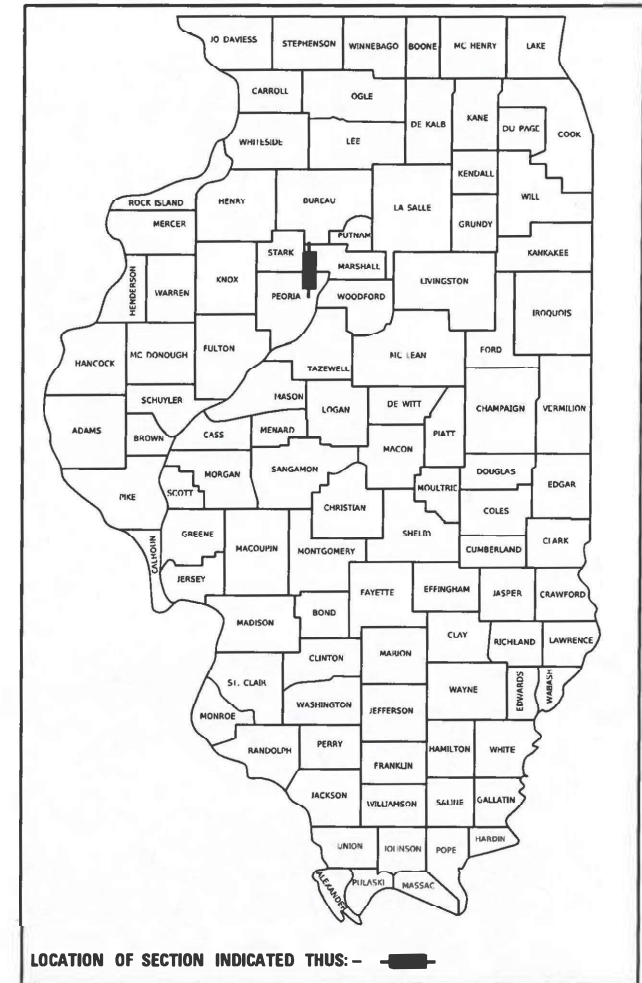

PLANS PREPARED BY:

TWM ENGINEERING GEOSPATIAL SERVICES
4940 Old Collinsville Road
Swansea, Illinois 62226
Tel: 618.624.4488
www.twm-inc.com
Illinois Professional Design Firm
No. 184-001220
License Expires: 4/30/2025
ILLINOIS - MISSOURI - TENNESSEE

STATE OF ILLINOIS
DEPARTMENT OF TRANSPORTATION
SUBMITTED December 9 20 25
Kenneth A. Barnette
REGIONAL ENGINEER
January 23 20 26
[Signature]
ENGINEER OF DESIGN AND ENVIRONMENT
January 23 20 26
[Signature]
DIRECTOR OF HIGHWAYS PROJECT IMPLEMENTATION

PRINTED BY THE AUTHORITY
OF THE STATE OF ILLINOIS

COMMITMENTS

NO COMMITMENTS HAVE BEEN MADE FOR THIS PROJECT.

GENERAL NOTES

AVAILABILITY OF ELECTRONIC FILES

MICROSTATION AND GEOPAK FILES OF THIS PROJECT WILL BE MADE AVAILABLE TO THE CONTRACTOR AFTER CONTRACT AWARD. IF THERE IS A CONFLICT BETWEEN THE ELECTRONIC FILES AND THE PRINTED CONTRACT PLANS AND DOCUMENTS, THE PRINTED CONTRACT PLANS AND DOCUMENTS SHALL TAKE PRECEDENCE OVER THE ELECTRONIC FILES. THE CONTRACTOR SHALL ACCEPT ALL RISK ASSOCIATED WITH USING THE ELECTRONIC FILES AND SHALL HOLD THE DEPARTMENT HARMLESS FOR ANY ERRORS OR OMISSIONS IN THE ELECTRONIC FILES AND THE DATA CONTAINED THEREIN. ERRORS OR DELAYS RESULTING FROM THE USE OF THE ELECTRONIC FILES BY THE CONTRACTOR SHALL NOT RESULT IN AN EXTENSION OF TIME FOR ANY INTERIM OR FINAL COMPLETION DATE OR SHALL NOT BE CONSIDERED CAUSE FOR ADDITIONAL COMPENSATION. THE CONTRACTOR SHALL NOT USE, SHARE, OR DISTRIBUTE THESE ELECTRONIC FILES EXCEPT FOR THE PURPOSE OF CONSTRUCTING THIS CONTRACT. ANY CLAIMS BY THIRD PARTIES DUE TO USE OR ERRORS SHALL BE THE RESPONSIBILITY OF THE CONTRACTOR. THE CONTRACTOR SHALL INCLUDE THIS DISCLAIMER WITH THE TRANSFER OF THESE ELECTRONIC FILES TO ANY OTHER PARTIES AND SHALL INCLUDE APPROPRIATE LANGUAGE BINDING THEM TO SIMILAR RESPONSIBILITIES.

TRAFFIC CONTROL

ADDITIONAL SUPPLEMENTAL TRAFFIC CONTROL

THE DEPARTMENT RESERVES THE RIGHT AT ANY TIME TO ADD ADDITIONAL TRAFFIC CONTROL SYSTEMS OR DEVICES WITHIN THE ACTIVE CONTRACT LIMITS, BY MEANS OF AN ADDITIONAL CONTRACT. ALL TERMS OF ARTICLE 105.08 OF THE STANDARD SPECIFICATIONS SHALL BE FOLLOWED BY EACH CONTRACTOR.

CONVERSION RATES

STONE RIPRAP, A5 (22 INCHES) 0.9167 TONS / SQ YD

MODEL Path: \\...
FILE NAME: P:\2023\23098A\228 - IL 40 Box Culvert Riprap.dwg - DWG\4.7 Tran\CADD Sheets\68K57-40c-janmoose.dgn



USER NAME = dllee	DESIGNED - JRH	REVISED -
	DRAWN - JRH	REVISED -
PLOT SCALE = 40,0000 * / in.	CHECKED - TBP	REVISED -
PLOT DATE = 12/8/2025	DATE - JULY 2025	REVISED -

**STATE OF ILLINOIS
DEPARTMENT OF TRANSPORTATION**

GENERAL NOTES AND COMMITMENTS

SCALE: N/A SHEET 1 OF 1 SHEETS STA. TO STA.

F.A.P RTE.	SECTION	COUNTY	TOTAL SHEETS	SHEET NO.
646	(124BR)SCR	MARSHALL	7	2
CONTRACT NO. 68K57			ILLINOIS CONTRACT MAINTENANCE	

CODE NO.	PAY ITEM	UNIT	TOTAL QUANTITY	CONSTRUCTION CODE	
				MARSHALL COUNTY	
				100% STATE	
				0047	
				RURAL	
28100809	STONE DUMPED RIPRAP, CLASS A5	TON	61	61	
67100100	MOBILIZATION	L SUM	1	1	
70100450	TRAFFIC CONTROL AND PROTECTION, STANDARD 701201	L SUM	1	1	
70107025	CHANGEABLE MESSAGE SIGN	CAL DA	14	14	

MODEL: D:\a\h\l
 FILE NAME: P:\2023\23098A\228 - IL 40 Box Culvert Riprap\4_CADD - DWG\4.7 Tran\CADD Sheets\68K57-shc-SOC.dgn



USER NAME = dllee	DESIGNED - JRH	REVISED -
DRAWN - JRH	REVISED -	
PLOT SCALE = 10,0000 * / in.	CHECKED - TBP	REVISED -
PLOT DATE = 12/8/2025	DATE - JULY 2025	REVISED -

DESIGNED - JRH	REVISED -
DRAWN - JRH	REVISED -
CHECKED - TBP	REVISED -
DATE - JULY 2025	REVISED -

STATE OF ILLINOIS
DEPARTMENT OF TRANSPORTATION

SUMMARY OF QUANTITIES

SCALE: N/A SHEET 1 OF 1 SHEETS STA. TO STA.

F.A.P. RTE.	SECTION	COUNTY	TOTAL SHEETS	SHEET NO.
646	(124BR)SCR	MARSHALL	7	3
CONTRACT NO. 68K57			ILLINOIS CONTRACT MAINTENANCE	

SN 062-2001
 IL 40 OVER MUD RUN
 MARSHALL COUNTY

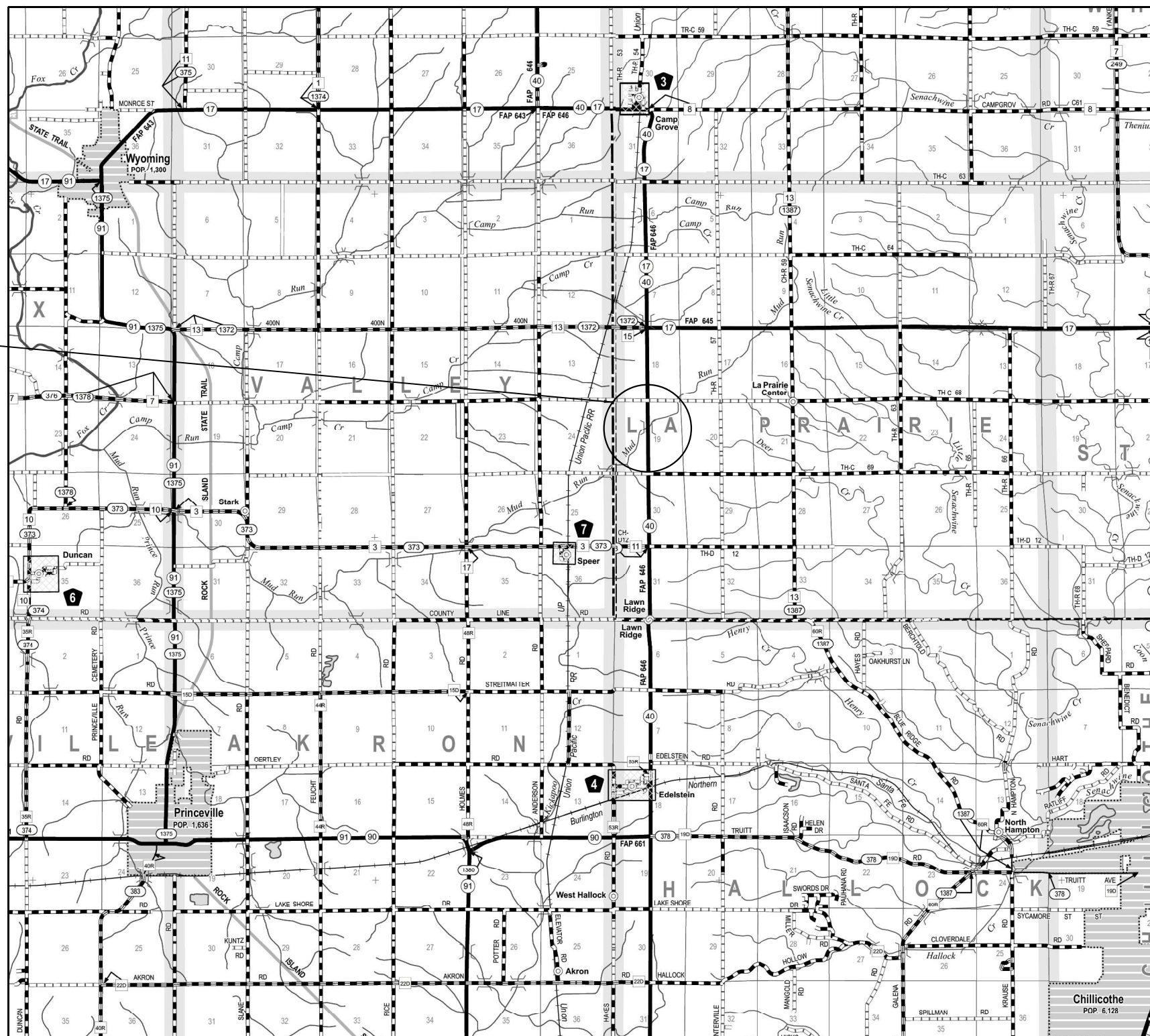

NOT TO
 SCALE

MODEL: Dwg.dwg
 FILE NAME: P:\2023\230984\278 - IL 40 Box Culvert Riprap CADD - DWG\4.7 Top\CADD Streets\68K57-shc-location_map.dwg



USER NAME = jhale
 PLOT SCALE = 40,0000 * / in.
 PLOT DATE = 8/12/2025

DESIGNED - JRH
 DRAWN - JRH
 CHECKED - TBP
 DATE - JULY 2025

REVISED -
 REVISED -
 REVISED -
 REVISED -

STATE OF ILLINOIS
 DEPARTMENT OF TRANSPORTATION

LOCATION MAP
 SN 062-2001

SCALE: N/A SHEET 1 OF 1 SHEETS STA. TO STA.

F.A.P. RTE.	SECTION	COUNTY	TOTAL SHEETS	SHEET NO.
646	(124BR)SCR	MARSHALL	7	4
CONTRACT NO. 68K57				
ILLINOIS CONTRACT MAINTENANCE				

PLAN VIEW

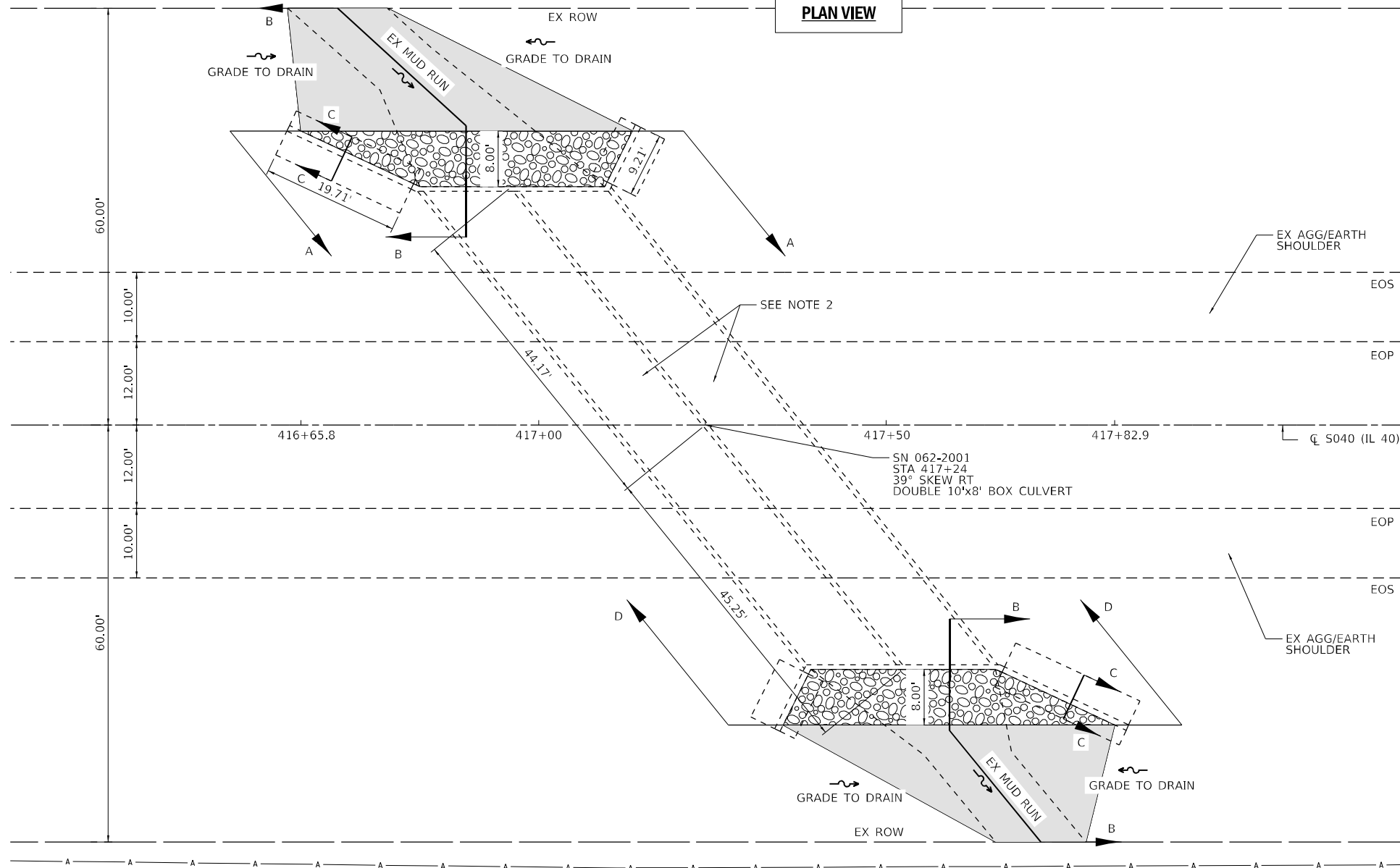

NOTES:

1. ALL SURPLUS MATERIALS TO BE DISPOSED OF OFF SITE ACCORDING TO ARTICLE 202.03.
2. CLEANING OF THE EXISTING BOX CULVERT TO BE DONE ACCORDING TO ARTICLE 109.04.
3. FILTER FABRIC AND BEDDING WILL NOT BE REQUIRED.
4. THE COST OF EXCAVATION FOR THE RIPRAP, CHANNEL GRADING, GRADING, AND DISPOSAL OF SURPLUS MATERIALS SHALL BE INCLUDED IN THE COST PER TON FOR STONE DUMPED RIPRAP, CLASS A5

LEGEND:

- CHANNEL GRADING
- PR STONE DUMPED RIPRAP, CLASS A5

RIPRAP SCHEDULE

LOCATION		STONE DUMPED RIPRAP, CLASS A5
UPSTREAM/DOWNSTREAM	LT/RT	TON
UPSTREAM	LT	30.3
DOWNSTREAM	RT	30.3
SUB TOTAL:		60.6
PAY TOTAL:		61

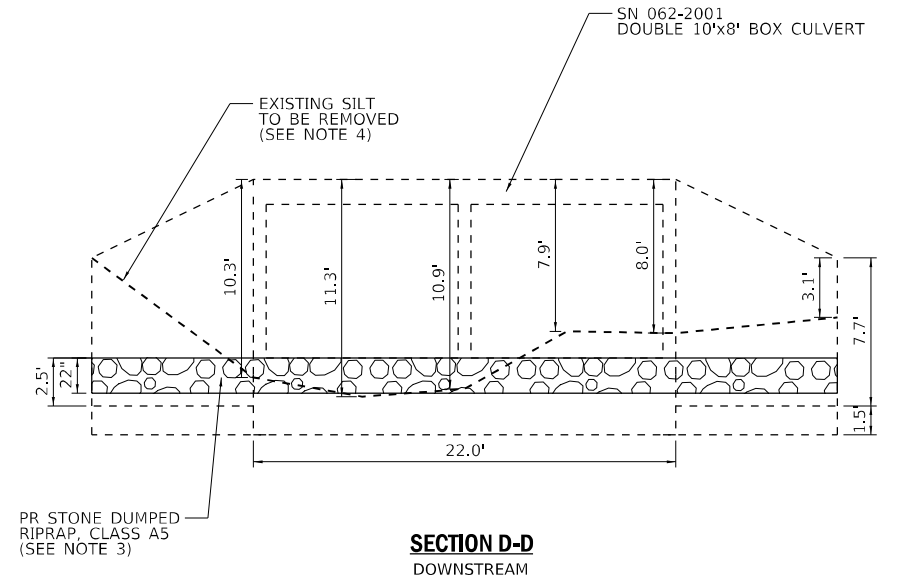
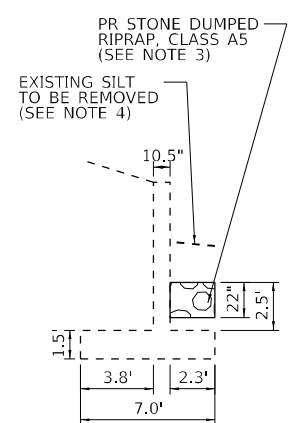
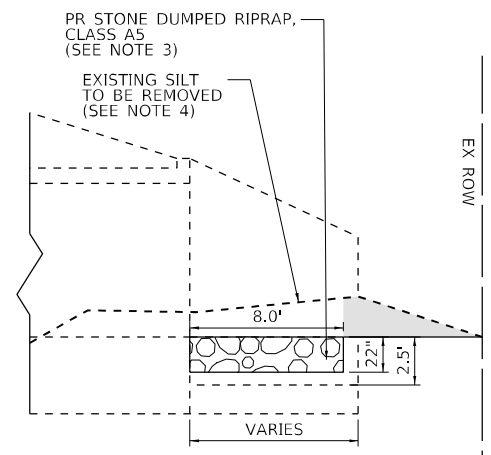
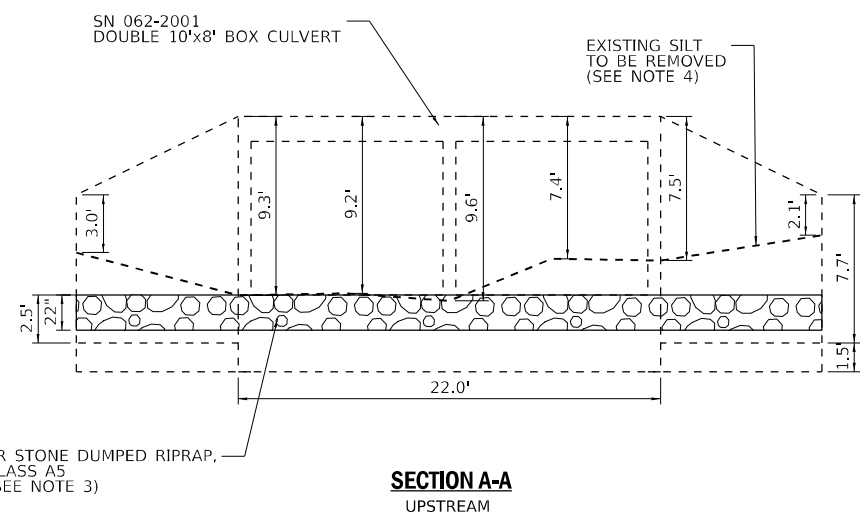
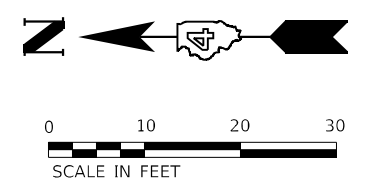

MODEL: D:\p4\11... FILE NAME: P:\2023\20230804\278 - IL 40 Box Culvert Riprap\4_CADD - DWG\4.7_Trim\CADD_Sheets\68K57-2b.dwg



USER NAME = dllee	DESIGNED - JRH	REVISED -
PLOT SCALE = 20,0000 * / in.	DRAWN - JRH	REVISED -
PLOT DATE = 12/8/2025	CHECKED - TBP	REVISED -
	DATE - JULY 2025	REVISED -

**STATE OF ILLINOIS
DEPARTMENT OF TRANSPORTATION**

**RIPRAP DETAILS
SN 062-2001**

SCALE: SHEET 1 OF 1 SHEETS STA. TO STA.

F.A.P. RTE.	SECTION	COUNTY	TOTAL SHEETS	SHEET NO.
646	(124BR)SCR	MARSHALL	7	5
ILLINOIS CONTRACT MAINTENANCE			CONTRACT NO. 68K57	

FOR INFORMATION ONLY

SN 062-2001 OVER MUD RUN

3/4" : 7/8" chiseled & East hd. A.R.C.
 Lt. Sta. 420+97 Elev. 462.90
 Existing Structure: R.C. Girder, 13span 54'-1 1/2" Rdwy. 21'-10"
 R.C. Closed Abutts. P.C.C. Floor with 3' 5" 1-11 overlay (Abutments to Remain)
 Superstructure to be removed by Sec. 124W, 125W-1 Contractor
 No Salvage
 No Temporary Bridge required.

STATE OF ILLINOIS
 DEPARTMENT OF PUBLIC WORKS & BUILDINGS
 DIVISION OF HIGHWAYS

ROUTE NO.	SECTION	COUNTY	TOTAL SHEETS	SHEET NO.
S.B.I. 58	124W	MARSHALL	111	25
P.A. 125W-1		PEORIA		
PER ROAD DIST. NO. 1		ILLINOIS	PER AID PROJECT: F-150(16)	

SHEET NO. 1
 2 SHEETS

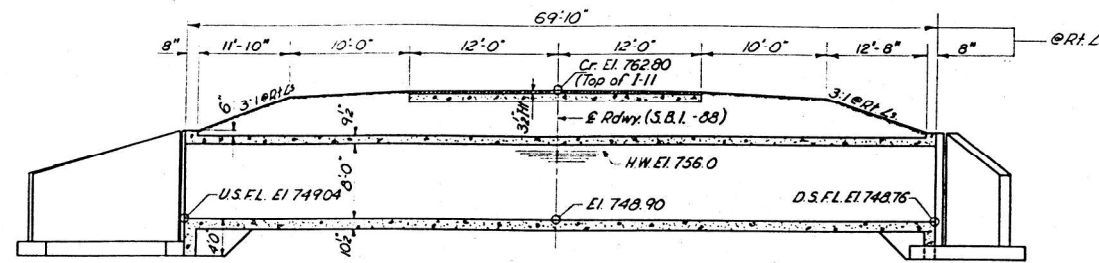

ELEVATION

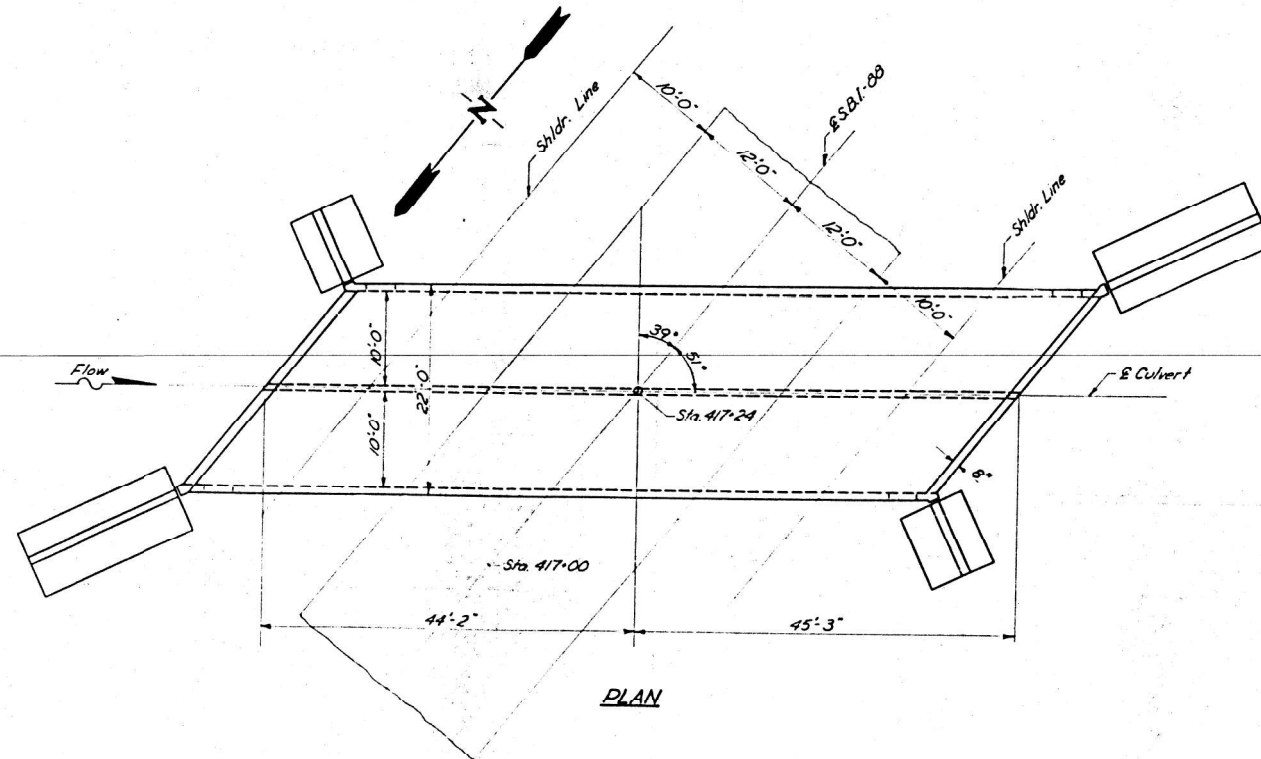

PLAN

GENERAL NOTES
 Class X Concrete shall be used throughout.
 Exposed edges shall be beveled 3/4".
 For backfilling and embankment see Std. Spec's.
 All bars shall be lapped 20 diameters unless otherwise specified.
 The top of the culvert, the backs of the sidewalls above the lower construction joint and backs of the wings above the tops of the footings shall be waterproofed in accordance with Art. 51.21 of the Std. Spec's.
 Nonmetallic water seal used in the wingwall joints shall extend from the top of the footing to within 6" of the top of the headwall.

TOTAL BILL OF MATERIALS

Item	Unit	Total
Class X Concrete	Cu. Yds.	224.1
Reinforcement Bars	Lbs.	34,700
Name Plate	Each	1
Removal of Exist. Struct.	Each	1

WATERWAY INFORMATION
 Drainage Area: 2080 Acres
 Character: level, rolling, cultivated
 Required Opening (35 yr. flood): 142 Sq. Ft.
 Present Opening: 238 Sq. Ft.
 Proposed Opening: 142 Sq. Ft.
 Ordinary Water Elev.: 749.2
 Low Water Elev.: 749.1

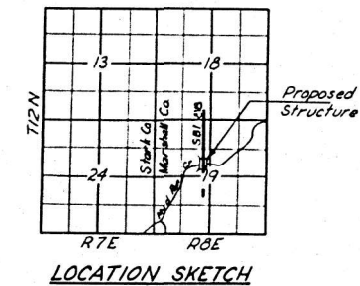

LOCATION SKETCH

DESIGN STRESSES
 f_c = 4000 psi Sidewalls, Top & Batt. Slab
 f_c = 1000 psi Wingwalls
 f_s = 20,000 psi Reinf.
 v_c = 75 psi Flgs.
 n = 10
 v_c = 90 psi Barrel
 Max. Rating pressure = 2.51 Kios per sq. ft.

STATION 417+24
 BUILT 196 BY
 STATE OF ILLINOIS
 SBI RT. 88 SEC. 124 BR
 F.A. PROJ. F-150(16)
 LOADING H20-S16

NAME PLATE
 See Standard 2113-1
 Locate at N.W. Corner

LOADING H20-S16-44

PROJECT F-150(16)
 MUD RUN CREEK
 SBI RT. 88 SEC. 124 BR
 MARSHALL COUNTY
 STATION 417+24

DESIGNED	J. Engers	EXAMINED	JAN 8 1964
CHECKED	Tom Stone	PASSED	[Signature]
DRAWN	Thomas A. Lewis	APPROVED	[Signature]
CHECKED	[Signature]		

MODEL: Dwgfile; FILE NAME: P:\2023\230808A\228 - IL 40 Box Culvert Riprap CADD - DWG\4.7 Tran\CADD Sheets\68K57-shc-structural details.dwg

TWM
 ENGINEERING
 GEOSPATIAL SERVICES
 TWM, INC.
 www.twm-inc.com
 IL DESIGN FIRM
 LICENSE NO:
 184-001220

USER NAME = jhale	DESIGNED - JRH	REVISED -
PLOT SCALE = 0.0833' / in.	DRAWN - JRH	REVISED -
PLOT DATE = 8/12/2025	CHECKED - TBP	REVISED -
	DATE - JULY 2025	REVISED -

STATE OF ILLINOIS
 DEPARTMENT OF TRANSPORTATION

STRUCTURE INFORMATION	
SCALE: N/A	SHEET 1 OF 2 SHEETS STA. TO STA.

F.A.P. RTE.	SECTION	COUNTY	TOTAL SHEETS	SHEET NO.
646	(124BR)SCR	MARSHALL	7	6
CONTRACT NO. 68K57				
ILLINOIS CONTRACT MAINTENANCE				

FOR INFORMATION ONLY

SN 062-2001 OVER MUD RUN

