

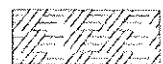

LANDSCAPING LEGEND:

-  SEEDING, CLASS 2A NITROGEN, PHOSPHORUS, AND POTASSIUM FERTILIZER NUTRIENTS TOPSOIL EXCAVATION AND PLACEMENT, 12"
-  SEEDING, CLASS 4 (MOD) AND CLASS 5 (MOD) TOPSOIL EXCAVATION AND PLACEMENT, 12"
-  SEEDING, CLASS 4B (MOD.) TOPSOIL EXCAVATION AND PLACEMENT, 1.
-  PERENNIAL PLANTS WETLAND EMERGENT TYPE, 2 X 4 PLUG TOPSOIL EXCAVATION AND PLACEMENT.

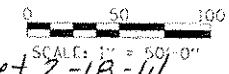
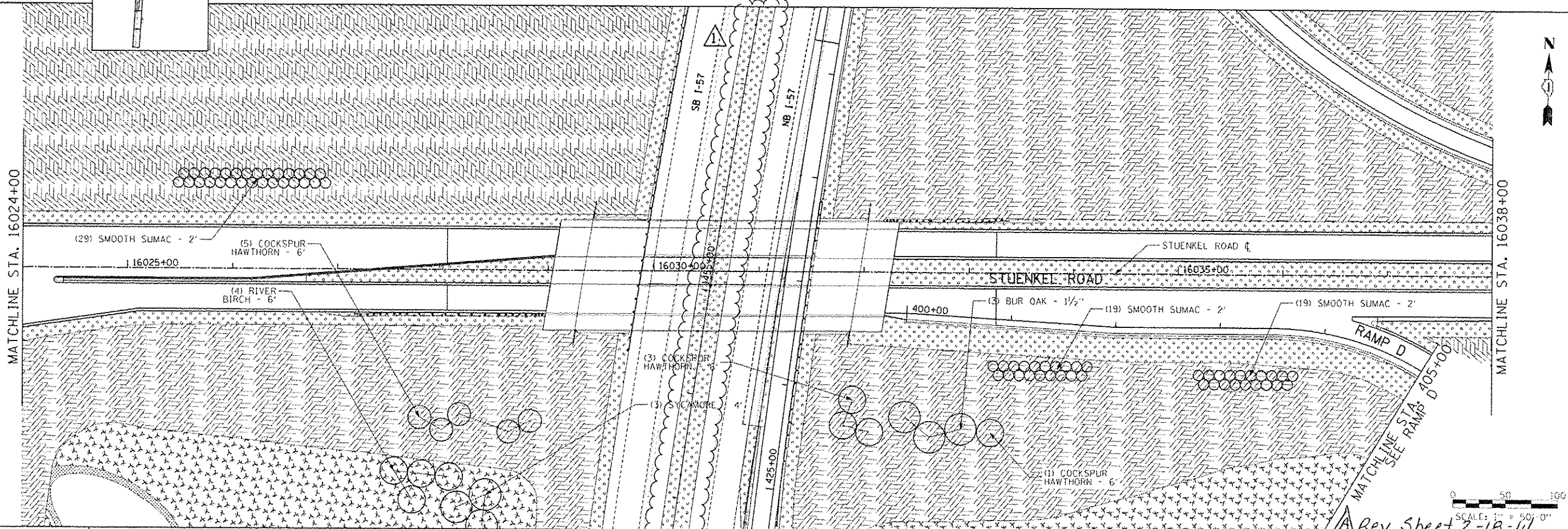
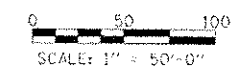

Rev. Sheet 2-18-14

TYLIN INTERNATIONAL	USER NAME	DESIGNED - PP	REVISED - ADDENDUM 02/07/14
	PLAT SCALE	DRAWN - DPS	REVISED -
	PLAT DATE	CHECKED - JPM	REVISED -
		DATE - 05/10/2013	REVISED -

**STATE OF ILLINOIS
DEPARTMENT OF TRANSPORTATION**

**STUENKEL ROAD AT I-57 RIDGELAND AVENUE TO CENTRAL AVENUE
STUENKEL ROAD LANDSCAPING PLAN**

SCALE: 1" = 50' SHEET 2 OF 10 SHEETS STA. 16010+00 TO STA. 16038+00

P.A. RTE.	SECTION	COUNTY	TOTAL SHEETS	SHEET NO.
57	99-116-RJ	WILL	679	161
			CONTRACT NO. 60L69	
ILLINOIS FED. AID PROJECT				

P:\AG26120-57_@_Stuenkel\Road\NC_3\In\exchange\NC_3_Stuenkel\I.LNDW2.dgn