

02-28-14 LETTING ITEM 128

FOR INDEX OF SHEETS, SEE SHEET NO. 2
FOR LOCATION MAPS, SEE SHEETS NO. 3-7
FOR SUMMARY OF QUANTITIES, SEE SHEETS NO. 8-9

STATE OF ILLINOIS
DEPARTMENT OF TRANSPORTATION
DIVISION OF HIGHWAYS

PROPOSED HIGHWAY PLANS

F.A.I. ROUTE 74 (I-74) & F.A.I. ROUTE 57 (I-57)
SECTION D5 PATCHING 2014-4

PATCHING
VARIOUS COUNTIES

C-95-029-13

MCLEAN CO. LINE TO DANVILLE & TOLONO TO OLYMPIAN DRIVE IN CHAMPAIGN

CURRENT ADT
SEE LOCATION MAPS

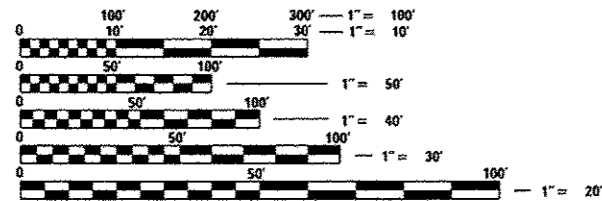
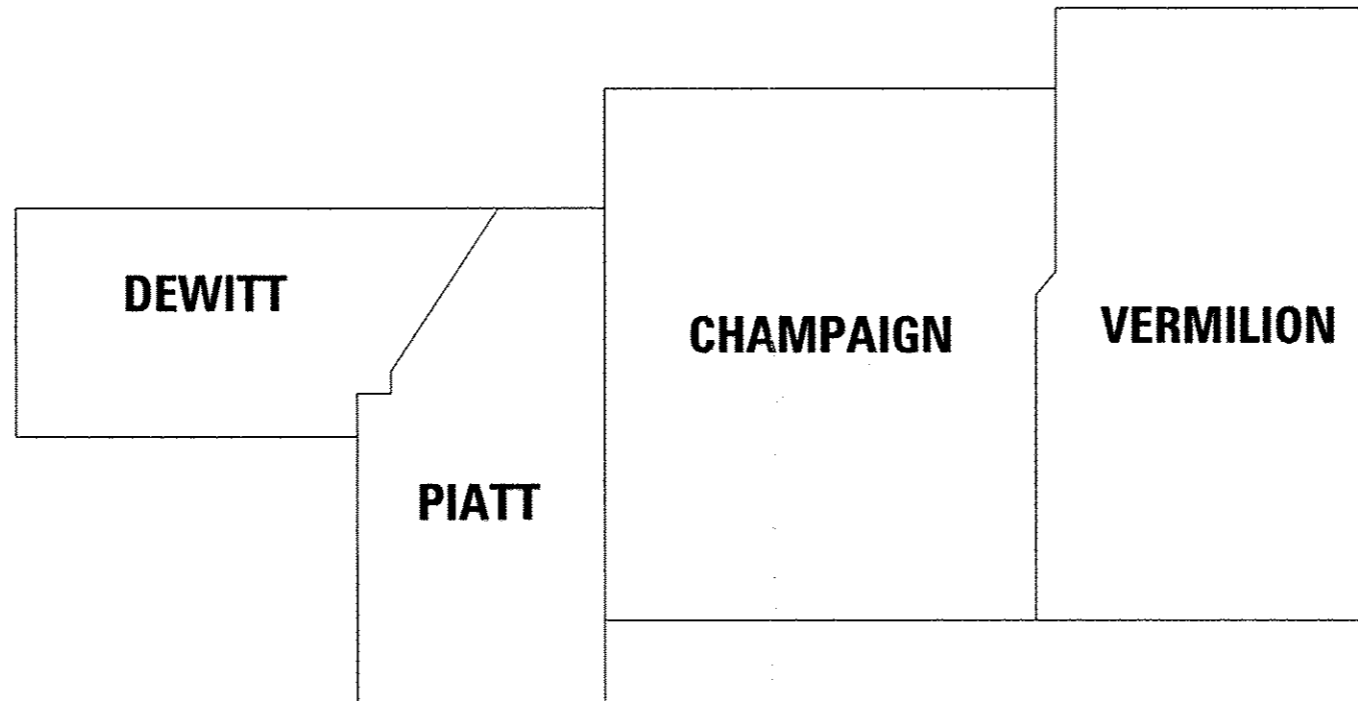

FULL SIZE PLANS HAVE BEEN PREPARED USING STANDARD ENGINEERING SCALES. REDUCED SIZED PLANS WILL NOT CONFORM TO STANDARD SCALES. IN MAKING MEASUREMENTS ON REDUCED PLANS, THE ABOVE SCALES MAY BE USED.

J.U.L.I.E.
JOINT UTILITY LOCATION INFORMATION FOR EXCAVATION
1-800-892-0123
OR 811

PROJECT ENGINEER: JASON STULTS
SQUAD LEADER: MICHAEL LEROY
PHONE: 217-465-4181
CONTRACT NO. 70A38

GROSS LENGTH = 341,574.63 FT. = 64.692 MILE
NET LENGTH = 341,574.63 FT. = 64.692 MILE

F.A.I. RTE.	SECTION	COUNTY	TOTAL SHEETS	SHEET NO.
74&57	D5 PATCHING 2014-4	VARIOUS	29	1
		ILLINOIS	CONTRACT NO. 70A38	

D-95-029-13



LOCATION OF SECTION INDICATED THUS: - [shaded box] -

STATE OF ILLINOIS
DEPARTMENT OF TRANSPORTATION
DIVISION OF HIGHWAYS

SUBMITTED December 4, 2013
Joseph S. Crowe
DEPUTY DIRECTOR OF HIGHWAYS, REGION 3 ENGINEER C.A.E.

Jan 24, 2014
John D. Baranzelli, P.E.
ENGINEER OF DESIGN AND ENVIRONMENT

Jan 24, 2014
Omer Osman, P.E.
DIRECTOR OF HIGHWAYS, CHIEF ENGINEER

PRINTED BY THE AUTHORITY
OF THE STATE OF ILLINOIS

INDEX OF SHEETS

SHEET NO.	DESCRIPTION
1	COVER SHEET
2	INDEX OF SHEETS AND LIST OF STANDARDS
2	GENERAL NOTES
3 - 7	LOCATION MAPS
8 - 9	SUMMARY OF QUANTITIES
10 - 21	EXISTING TYPICAL CROSS SECTIONS
22 - 28	SCHEDULE OF QUANTITIES
29	DETAIL - PCC PARTIAL DEPTH & VARIABLE DEPTH HMA PATCHING

LIST OF STANDARDS

STANDARD NO.	DESCRIPTION
000001-06	STANDARD SYMBOLS, ABBREVIATIONS AND PATTERNS
001001-02	AREAS OF REINFORCEMENT BARS
001006	DECIMAL OF AN INCH AND OF A FOOT
420001-07	PAVEMENT JOINTS
420701-02	PAVEMENT FABRIC
421001-02	BAR REINFORCEMENT FOR CRC PAVEMENT
442001-04	CLASS A PATCHES
442101-07	CLASS B PATCHES
701101-04	OFF-ROAD OPERATIONS, MULTILANE, 15' (4.5M) TO 24" (600 MM) FROM PAVEMENT EDGE
701400-07	APPROACH TO LANE CLOSURE, FREEWAY / EXPRESSWAY
701401-08	LANE CLOSURE, FREEWAY OR EXPRESSWAY
701411-08	LANE CLOSURE, MULTILANE, AT ENTRANCE OR EXIT RAMP, FOR SPEEDS > OR = 45 MPH
701426-06	LANE CLOSURE, MULTILANE, INTERMITTENT OR MOVING OPERATION, FOR SPEEDS > OR = 45 MPH
701901-03	TRAFFIC CONTROL DEVICES

GENERAL NOTES

G.N.-100

ENGLISH UNITS OF MEASUREMENT SHALL GOVERN OVER AND SUPERSEDE ANY METRIC UNITS SHOWN IN THIS CONTRACT. WHERE INCLUDED, METRIC UNITS ARE FOR INFORMATION ONLY.

G.N.-100A

ELECTRONIC FILES AND/OR ELECTRONIC SURVEY INFORMATION INCLUDING CADD FILES WILL NOT BE AVAILABLE TO THE CONTRACTOR.

G.N. -406H

The following mixture requirements are applicable for this project:

Location	I-57/I-74 P.D.	I-57/I-74 P.D.
Mixture Use	PATCHING	PATCHING
	bottom lifts	top 2"
AC/PG	SBS PG 70-22	SBS PG 70-22
RAP % (Max)	10	10
Design Air Voids	4.0%@Ndes=90	4.0%@Ndes=90
Mix Comp(Gradation)	IL 19.0FG	IL 9.5
Friction Aggregate	N.A.	Mix D

G.N.-442B -- PATCHING SCHEDULES

THE PATCHING SCHEDULES INCLUDED IN THE PLANS REPRESENT THE BEST INFORMATION AVAILABLE AT THE TIME OF COMPLETION OF THE PLANS FOR LETTING. VARIATIONS IN LOCATION AND SIZES OF BOTH FULL-DEPTH AND PARTIAL-DEPTH PATCHES MAY OCCUR.

G.N.-1004.01

COARSE AGGREGATE GRADATION CA-10 MAY BE USED WHENEVER COARSE AGGREGATE CA-6 IS SPECIFIED IN THE STANDARD SPECIFICATIONS.

COMMITMENTS:

THERE ARE NO COMMITMENTS FOR THIS CONTRACT.

FILE NAME #	USER NAME = leroyme	DESIGNED -	REVISED -	STATE OF ILLINOIS DEPARTMENT OF TRANSPORTATION	INDEX OF SHEETS, LIST OF STANDARDS, & GENERAL NOTES	F.A.I. RTE.	SECTION	COUNTY	TOTAL SHEETS	SHEET NO.	
c:\work\pdsat\leryme\0365293\0577	036-shr-cover.dgn	DRAWN -	REVISED -			74&57	D5 PATCHING 2014-4	VARIOUS	29	2	
	PLOT SCALE = 40.0000 1/ in.	CHECKED -	REVISED -			CONTRACT NO. 70A38					
#MODELNAME#	PLOT DATE = 12/4/2013	DATE -	REVISED -			ILLINOIS/FED. AID PROJECT					
					SCALE:	SHEET OF SHEETS		STA. TO STA.			

LOCATION MAP #1

DEWITT CO.
F.A.I. 74

CURRENT ADT

FUNCTIONAL CLASSIFICATION: INTERSTATE
FAI 74 (I-74)

LEG "A" ADT(2013) = 18,300 SU=7.5% MU=35.3%
LEG "B" ADT(2013) = 20,600 SU=4.1% MU=36.1%

BEGIN SECTION
STA. 635+97.34
MCLEAN CO. LINE

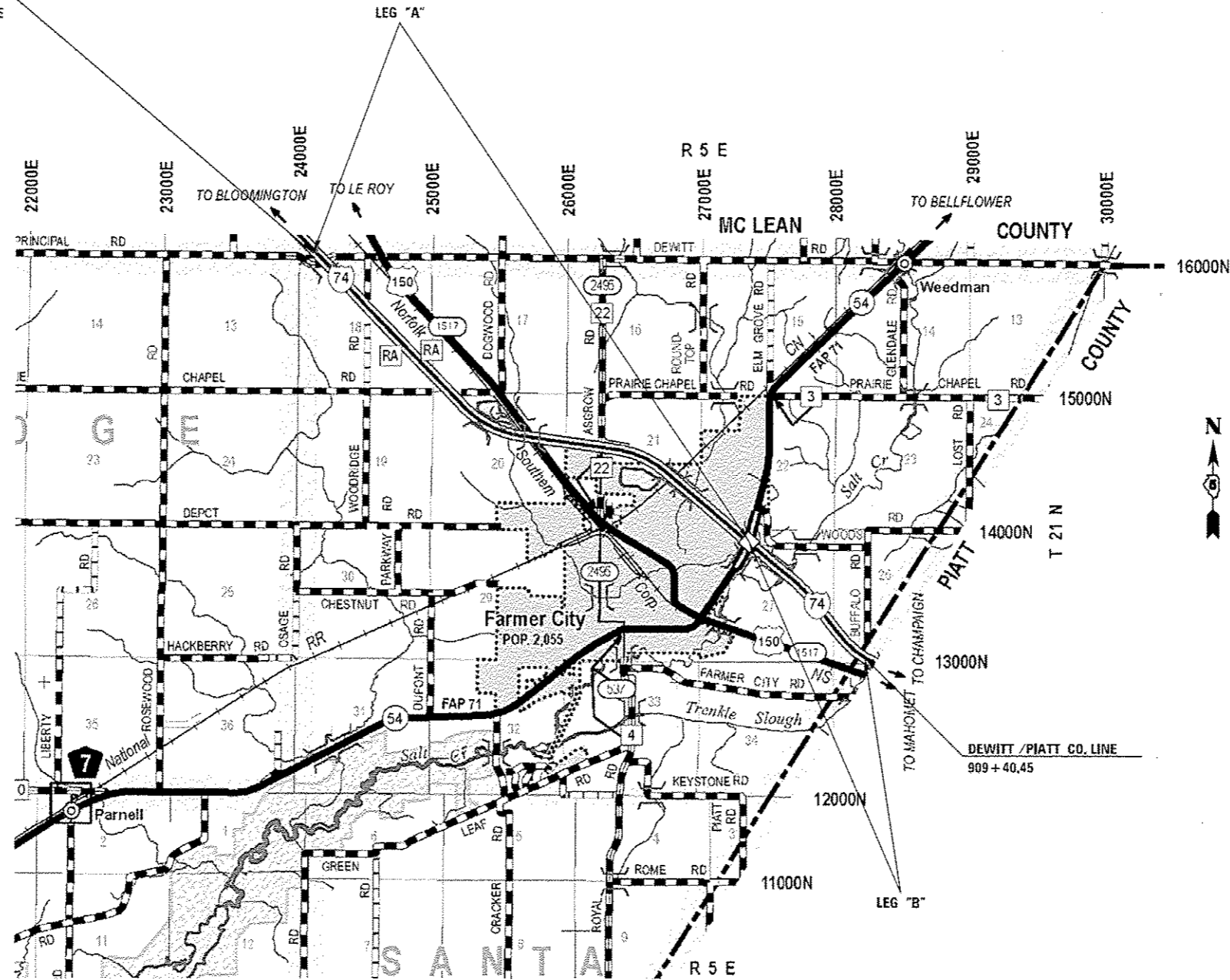

RURAL
STA. 635 + 97.34 TO STA. 909 + 40.45

SCALE

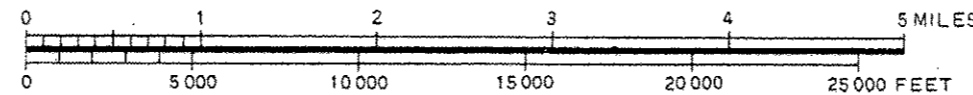

GROSS LENGTH = 27,343.11 FT. = 5.179 MILE
NET LENGTH = 27,343.11 FT. = 5.179 MILE

TOWNSHIPS
FARMER CITY

FILE NAME	USER NAME = leroyne	DESIGNED -	REVISED -	STATE OF ILLINOIS DEPARTMENT OF TRANSPORTATION	LOCATION MAP #1	F.A.I. RTE.	SECTION	COUNTY	TOTAL SHEETS	SHEET NO.	
		DRAWN -	REVISED -			74&57	DS PATCHING 2014-4	VARIOUS	29	3	
		CHECKED -	REVISED -			SCALE: SHEET 1 OF 5 SHEETS STA. TO STA.					
		DATE -	REVISED -			ILLINOIS FED. AID PROJECT					

LOCATION MAP #2

PIATT CO.
F.A.I. 74

CURRENT ADT

FUNCTIONAL CLASSIFICATION: INTERSTATE
FAI 74 (I-74)

LEG "A" ADT(2013)=19,000 SU=3.9% MU=30.6%
LEG "B" ADT(2013)=21,800 SU=4.3% MU=27.8%

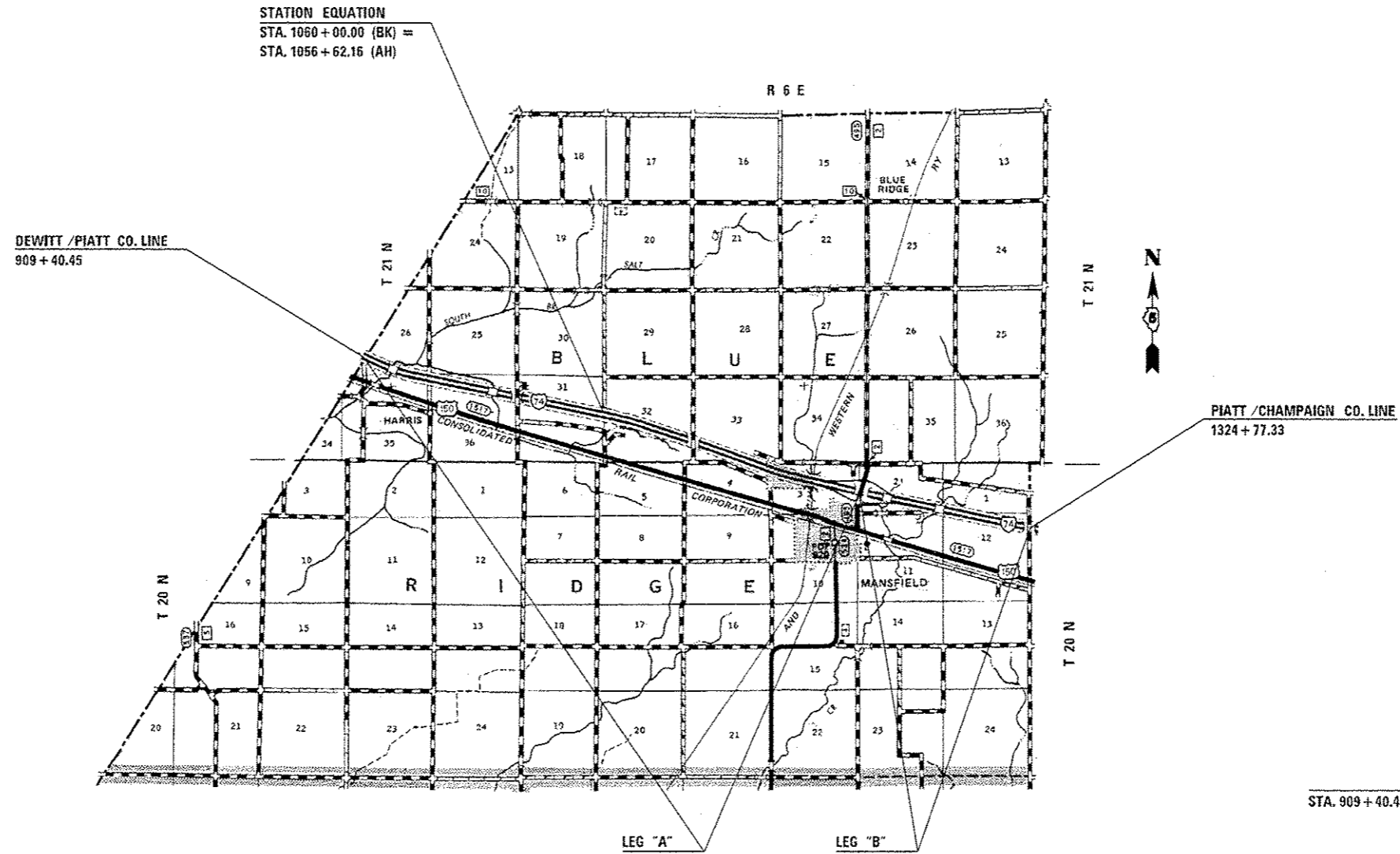

TOWNSHIPS
BLUE RIDGE

FILE NAME *	USER NAME # jarayma	DESIGNED -	REVISED -	STATE OF ILLINOIS DEPARTMENT OF TRANSPORTATION	LOCATION MAP #2	F.A.I. RTE.	SECTION	COUNTY	TOTAL SHEETS	SHEET NO.
en:\pvc\work\p\sidot\jarayma\0365293\057038-sht-covar.dgn	DRAWN -	REVISED -	74&S7			D5 PATCHING 2014-4	VARIOUS	29	4	
PLOT SCALE * 48.0000' / in.	CHECKED -	REVISED -	CONTRACT NO. 70A38							
PLOT DATE * 12/4/2013	DATE -	REVISED -	ILLINOIS FED. AID PROJECT							
MODELNAME#				SCALE: SHEET 2 OF 5 SHEETS STA. TO STA.						

LOCATION MAP #3

CHAMPAIGN CO.
F.A.I. 74

CURRENT ADT

FUNCTIONAL CLASSIFICATION: INTERSTATE

F.A.I. 74 (I-74)

LEG "A"	ADT(2013)=21,800	SU=4.3%	MU=27.8%
LEG "B"	ADT(2013)=27,800	SU=3.5%	MU=23.0%
LEG "C"	ADT(2013)=27,500	SU=3.6%	MU=21.1%
LEG "D"	ADT(2013)=30,000	SU=3.5%	MU=23.2%
LEG "E"	ADT(2013)=26,400	SU=4.2%	MU=24.8%
LEG "F"	ADT(2013)=24,700	SU=3.8%	MU=26.5%

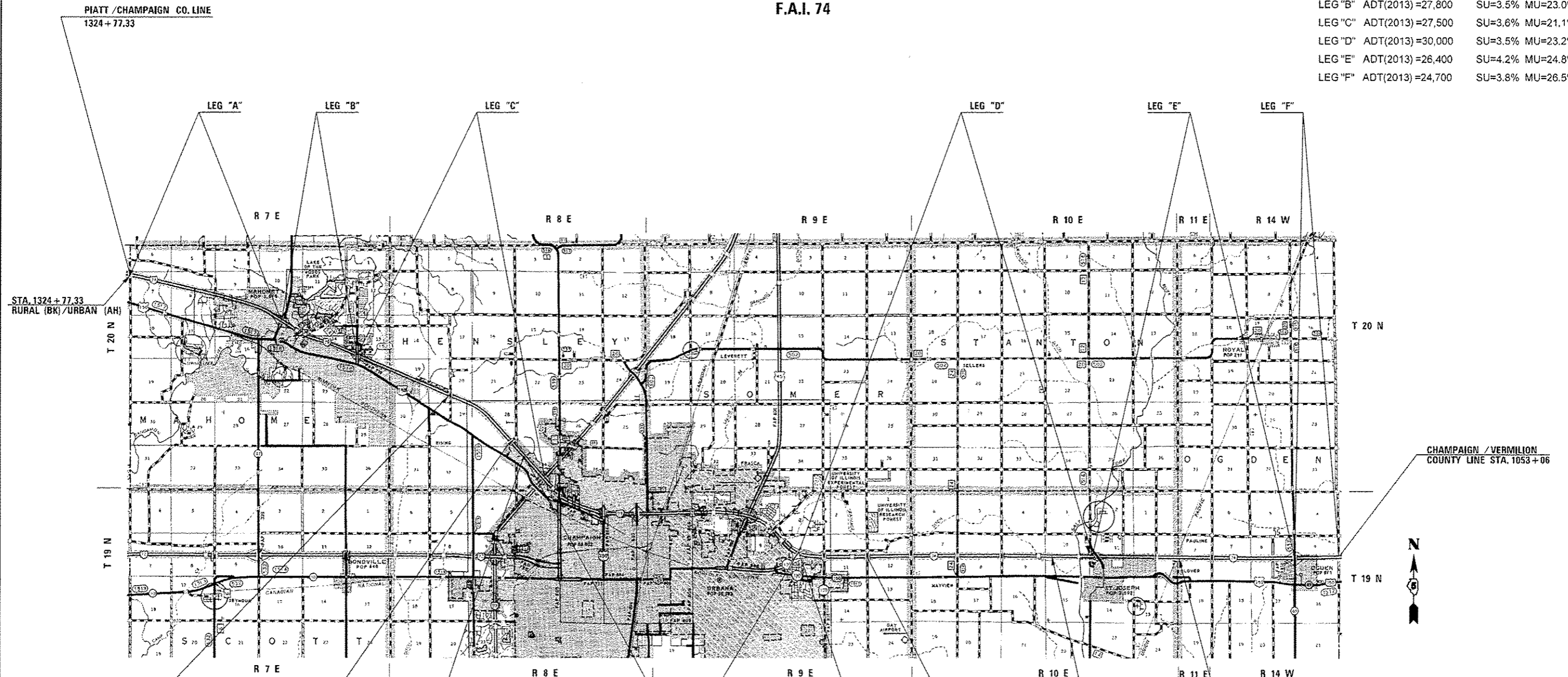

STA. 1324 + 77.33
RURAL (BK)/URBAN (AH)

STA. 1742 + 74.09
URBAN (BK)/RURAL (AH)

STA. 1807 + 74.09
RURAL (BK)/URBAN (AH)

OMISSION: STA. 1035 + 75.00
TO STA. 1429 + 00.00

STA. 483 + 83.09
URBAN (BK)/RURAL (AH)

STA. 700 + 14
RURAL (BK)/URBAN (AH)

STA. 857 + 94.85
URBAN (BK)/RURAL (AH)

STATION EQUATION
STA. 1870 + 95.89 (BK) =
STA. 1035 + 75.00 (AH)

STATION EQUATION
STA. 1429 + 00.00 (BK) =
STA. 429 + 00.00 (AH)

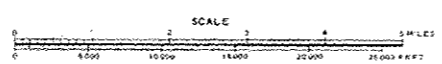

GROSS LENGTH = 156,349.56 FT. = 29.612 MILE
NET LENGTH = 117024.56 FT. = 22.164 MILE

URBAN
STA. 1324 + 77.33 TO STA. 1742 + 74.26 (MAHOMET)
STA. 1807 + 74.09 TO STA. 483 + 83.09 (CHAMPAIGN)
STA. 700 + 14 TO STA. 857 + 94.85 (ST. JOSEPH)

RURAL
STA. 1742 + 74.26 (PIATT CO. LINE) TO STA. 1807 + 74.09
STA. 483 + 83.09 TO STA. 700 + 14
STA. 857 + 94.85 TO STA. 1053 + 06 (VERMILION CO. LINE)

TOWNSHIPS
MAHOMET
HENSLEY
CHAMPAIGN
URBANA
ST. JOSEPH
OGDEN

FILE NAME =	USER NAME = lerogms	DESIGNED -	REVISED -	STATE OF ILLINOIS DEPARTMENT OF TRANSPORTATION	LOCATION MAP #3	F.A.I. RTE.	SECTION	COUNTY	TOTAL SHEETS	SHEET NO.	
en:\p\work\newdot\lerogms\10365293\1057033-ahc-cover.dgn	1036-ahc-cover.dgn	DRAWN -	REVISED -			74&57	D5 PATCHING 2014-4	VARIOUS	29	5	
PLOT SCALE = 40,0000 1/4 in.	PLOT DATE = 12/4/2013	CHECKED -	REVISED -			SCALE: SHEET 3 OF 5 SHEETS STA. TO STA.					
#MODELNAME#		DATE -	REVISED -			ILLINOIS FED. AID PROJECT CONTRACT NO. 70A38					

LOCATION MAP #4

VERMILION CO.
F.A.I. 74

CURRENT ADT

FUNCTIONAL CLASSIFICATION: INTERSTATE
FAI 74 (I-74)

LEG "A"	ADT(2013)=24,700	SU=3.8%	MU=26.5%
LEG "B"	ADT(2013)=24,100	SU=3.1%	MU=24.2%
LEG "C"	ADT(2013)=17,800	SU=3.6%	MU=35.1%
LEG "D"	ADT(2013)=23,100	SU=3.4%	MU=29.1%
LEG "E"	ADT(2013)=26,900	SU=3.9%	MU=25.7%
LEG "F"	ADT(2013)=18,000	SU=4.1%	MU=32.4%

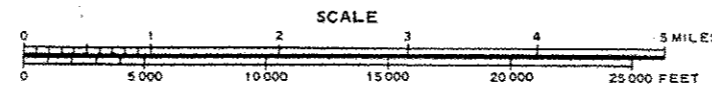
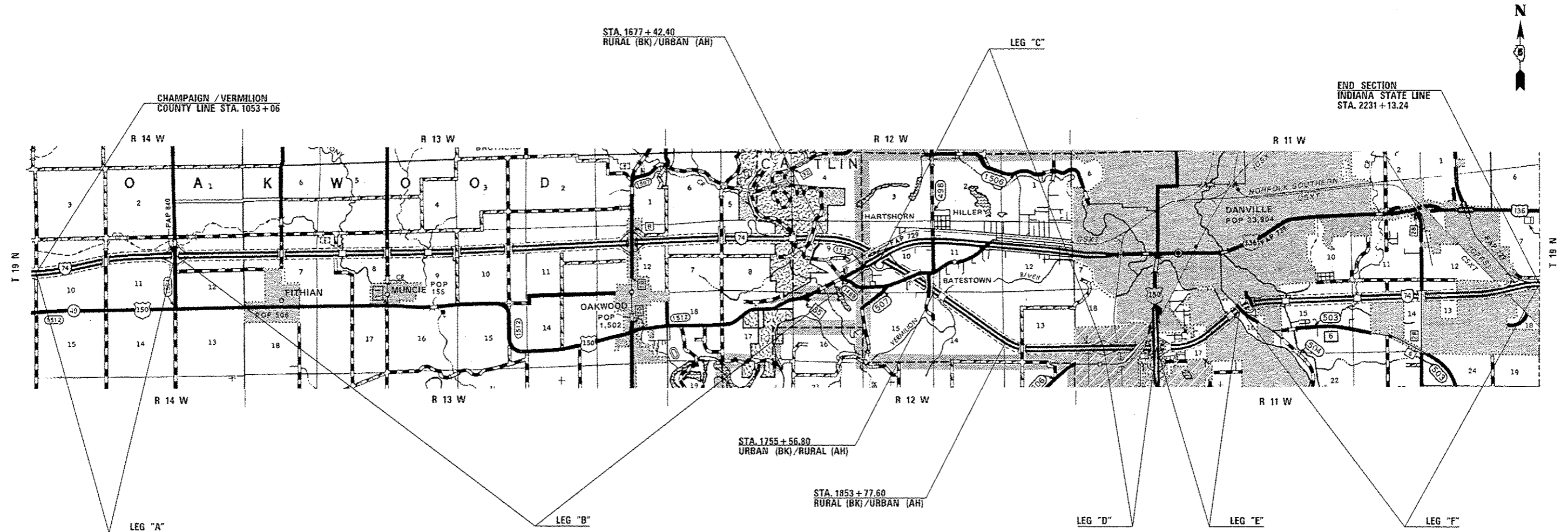

GROSS LENGTH = 117,807.24 FT. = 22.312 MILE
NET LENGTH = 117,807.24 FT. = 22.312 MILE

URBAN
STA. 1676+03 (MLK DRIVE) TO STA. 1853+77.60 (BATESTOWN RD.)
STA. 1853+77.60 (BOYDE RD.) TO STA. 2231+13.24 (INDIANA STATE LINE)

RURAL
STA. 1053+06 (CHAMPAIGN CO. LINE) TO STA. 1676+03
STA. 1755+56.80 TO STA. 1853+77.60

TOWNSHIPS
OAKWOOD
DANVILLE

FILE NAME =	USER NAME = leroyna	DESIGNED -	REVISED -
c:\p\work\pvidot\leryona\050524\0570330-kht-cover.dgn		DRAWN -	REVISED -
	PLOT SCALE = 48,2000' / in.	CHECKED -	REVISED -
MODELNAME =	PLOT DATE = 12/4/2013	DATE -	REVISED -

STATE OF ILLINOIS
DEPARTMENT OF TRANSPORTATION

LOCATION MAP #4

SCALE: SHEET 4 OF 5 SHEETS STA. TO STA.

F.A.I. RTE.	SECTION	COUNTY	TOTAL SHEETS	SHEET NO.
74&57	D5 PATCHING 2014-4	VARIOUS	29	6
				CONTRACT NO. 70A38
ILLINOIS FED. AID PROJECT				

LOCATION MAP #5

CHAMPAIGN CO.
F.A.I. 57

CURRENT ADT
FUNCTIONAL CLASSIFICATION: INTERSTATE
FAI 57 (I-57)

LEG "A"	ADT(2013)=21,800	SU=4.3%	MU=25.9%
LEG "B"	ADT(2013)=23,700	SU=3.3%	MU=24.3%
LEG "C"	ADT(2013)=33,600	SU=3.9%	MU=24.5%
LEG "D"	ADT(2013)=23,000	SU=4.4%	MU=23.8%

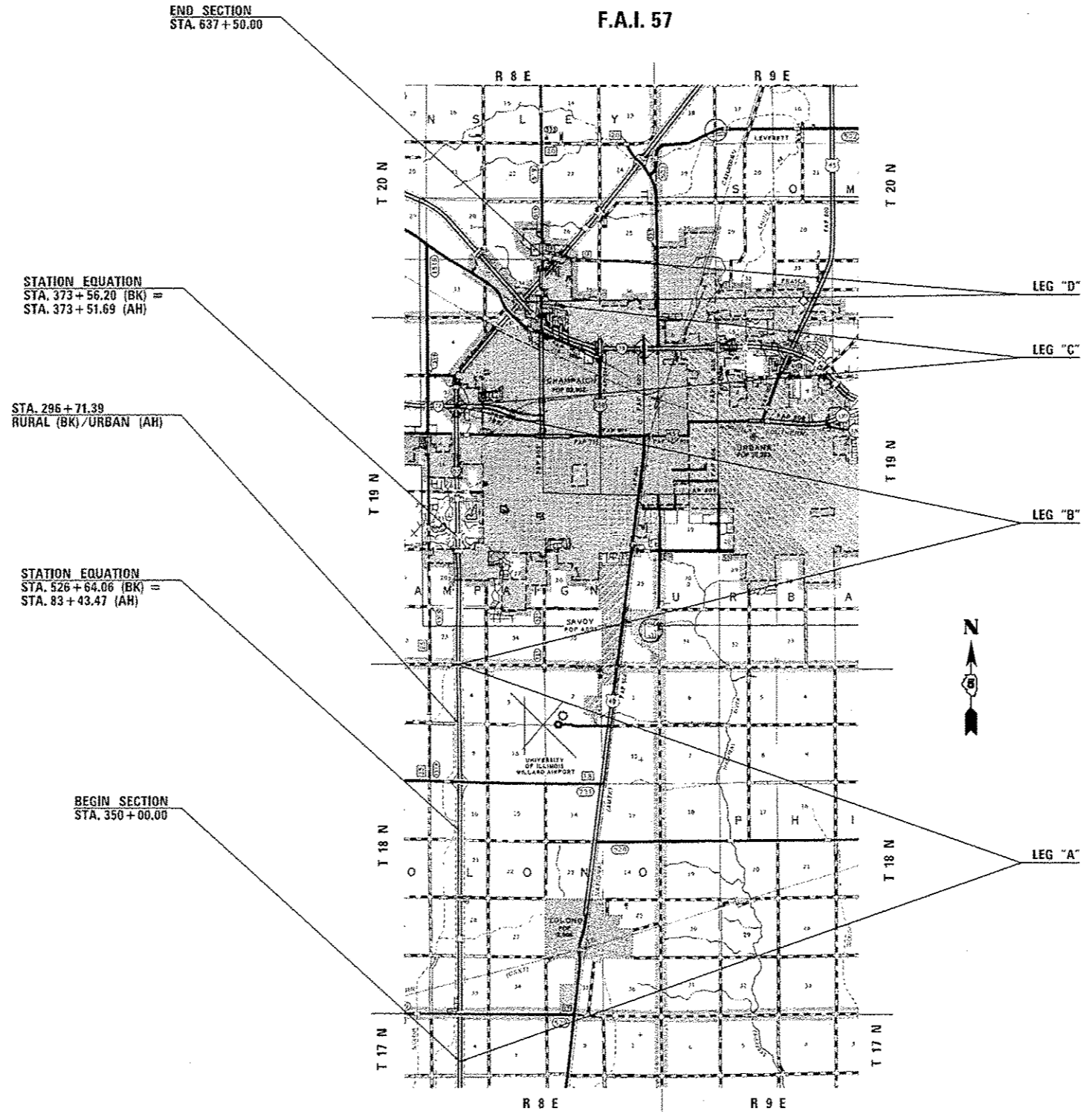

GROSS LENGTH = 73,075.10 FT. = 13.840 MILE
NET LENGTH = 73,075.10 FT. = 13.840 MILE

TOWNSHIPS	
PEQUOTUM	
TOLONO	
CHAMPAIGN	
HENSLEY	

FILE NAME #	USER NAME #	DESIGNED -	REVISED -	STATE OF ILLINOIS DEPARTMENT OF TRANSPORTATION	LOCATION MAP #1	F.A.I. RTE.	SECTION	COUNTY	TOTAL SHEETS	SHEET NO.
cr:\p\work\p10dot\lanoma\p2365243\0572	50-shr-cover.dgn	DRAWN -	REVISED -			74&57	05 PATCHING 2014-4	VARIOUS	29	7
		CHECKED -	REVISED -			SCALE:	SHEET 5 OF 5 SHEETS	STA.	TO STA.	CONTRACT NO. 70A38
MODELNAME#	PLOT DATE # 12/4/2013	DATE -	REVISED -			ILLINOIS FED. AID PROJECT				

SUMMARY OF QUANTITIES

LOCATION:

FAI 74 (I-74) DEWITT CTY RURAL INTERSTATE 100% STATE	FAI 74 (I-74) PIATT CTY RURAL INTERSTATE 100% STATE	FAI 74 (I-74) CHAMPAIGN CTY RURAL INTERSTATE 100% STATE	FAI 74 (I-74) CHAMPAIGN CTY URBAN INTERSTATE 100% STATE	FAI 57 (I-57) CHAMPAIGN CTY RURAL INTERSTATE 100% STATE	FAI 57 (I-57) CHAMPAIGN CTY URBAN INTERSTATE 100% STATE	FAI 74 (I-74) VERMILION CTY RURAL INTERSTATE 100% STATE	FAI 74 (I-74) VERMILION CTY URBAN INTERSTATE 100% STATE
0005	0005	0005	0005	0005	0005	0005	0005

CONSTRUCTION CODE:

PAY ITEM CODE	PAY ITEM	UNIT	TOTAL	07E05							
				QTY	QTY	QTY	QTY	QTY	QTY	QTY	QTY
44201299	DOWEL BARS 1 1/2"	EACH	1,090.0			150.0	140.0	260.0	190.0	80.0	270.0
44213000	PATCHING REINFORCEMENT	SO YD	380			38.0	342.0				
44213100	PAVEMENT FABRIC	SO YD	367			70.0	20.0	0.0	80.0	16.0	181.0
44213200	SAW CUTS	FOOT	4,186.0			640.0	1184.0	576.0	748.0	204.0	834.0
44213204	TIE BARS 3/4"	EACH	178.0			20.0	80.0	0.0	33.0	0.0	45.0
67100100	MOBILIZATION	L SUM	1.0	0.1	0.1	0.1	0.2	0.2	0.1	0.1	0.1
70100420	TRAFFIC CONTROL AND PROTECTION, STANDARD 701411	EACH	12.0	1.0	1.0	3.0	1.0	2.0	2.0	1.0	1.0
70100800	TRAFFIC CONTROL AND PROTECTION, STANDARD 701401	L SUM	1.0	0.1	0.1	0.1	0.2	0.2	0.1	0.1	0.1
70103815	TRAFFIC CONTROL SURVEILLANCE	CAL DA	25.0	3.0	3.0	3.0	3.0	3.0	3.0	3.0	4.0
X0323583	SPEED INDICATOR SIGN	CAL DA	25.0	3.0	3.0	3.0	3.0	3.0	3.0	3.0	4.0
X4421000	PARTIAL DEPTH PATCHING	TON	307.0	165.0	142.0						
X4422000	PARTIAL DEPTH REMOVAL, VARIABLE DEPTH	SO YD	1,403.0	711.0	692.0						
X7015005	CHANGEABLE MESSAGE SIGN	CAL DA	30.0	3.0	3.0	4.0	4.0	4.0	4.0	4.0	4.0

• SPECIALTY ITEMS

LOCATION MAP #1
DEWITT CO.

EXISTING TYPICAL CROSS SECTION ①

STATION	TO	STATION
EB 635+97.34 (AH)		EB 655+70.00②
WB 635+97.34 (AH)		WB 666+29.87②
③EB 662+33.70		EB 694+54.78③
③WB 679+10.15		WB 711+31.23③
②EB 707+35.06		EB 909+40.45④
②WB 717+94.93		WB 909+40.45④

STRUCTURE OMISSIONS

STATION	TO	STATION
(SN 020-0026)	745+73.01	749+39.68
(SN 020-0027)	774+75.17	748+41.84
(SN 020-0028)	775+06.98	776+13.99
(SN 020-0029)	774+92.42	776+01.37
(SN 020-0030)	807+27.60	808+76.60
(SN 020-0031)	807+37.98	808+86.98
(SN 020-0032)	816+05.17	817+66.75
(SN 020-0033)	816+05.17	817+66.75
(SN 020-0036)	865+37.71	867+22.29
(SN 020-0037)	865+37.71	867+22.29

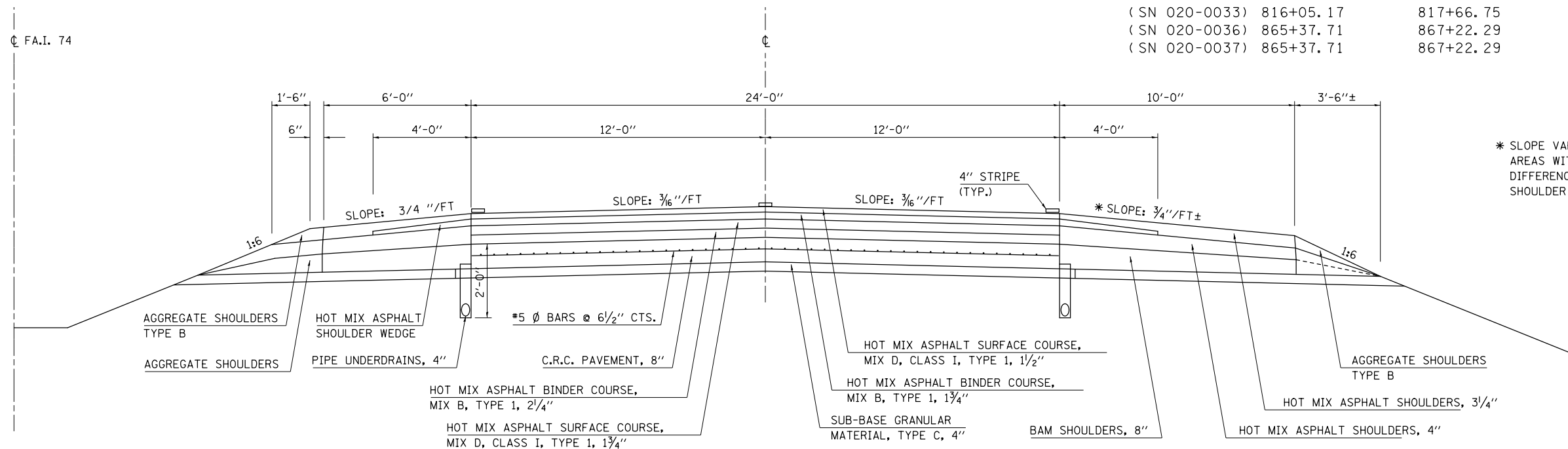

LOCATION MAP #1
DEWITT CO.

EXISTING TYPICAL CROSS SECTION ②

STATION	TO	STATION
①EB 655+70.00③		EB 659+74.37
③WB 713+90.56①		WB 717+94.93
③EB 697+85.06①		EB 707+35.06
①WB 666+29.87③		WB 675+79.87

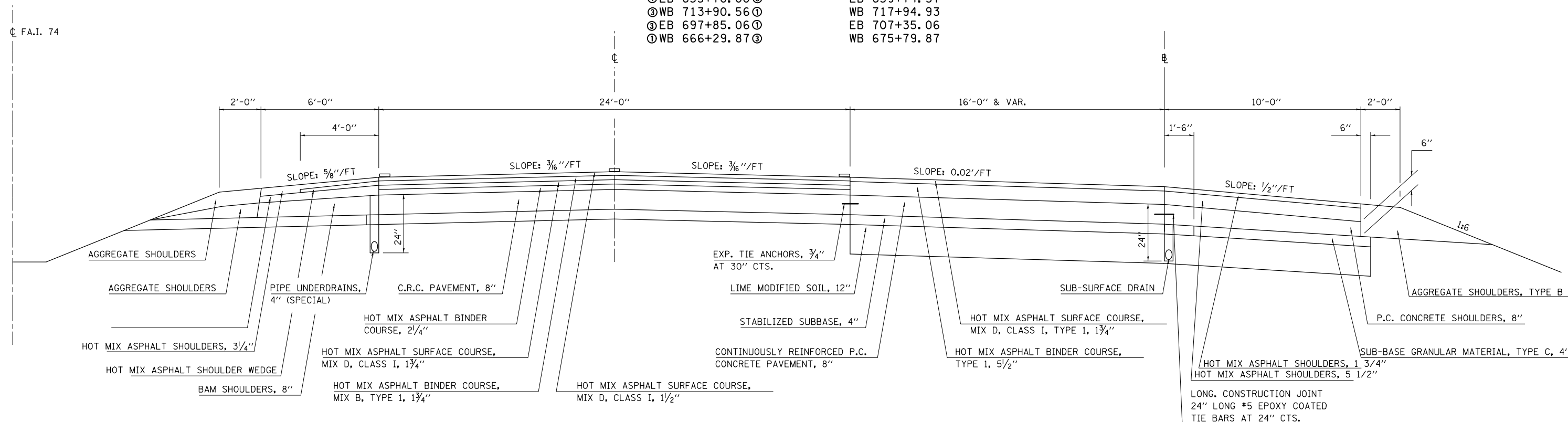

LOCATION MAP #1
DEWITT CO.

EXISTING TYPICAL CROSS SECTION ③

STATION	TO	STATION
② EB 659+74.37		EB 662+33.70 ①
① WB 711+31.23		WB 713+90.56 ②
① EB 694+54.78		EB 697+85.06 ②
② WB 675+79.87		WB 679+10.15 ①

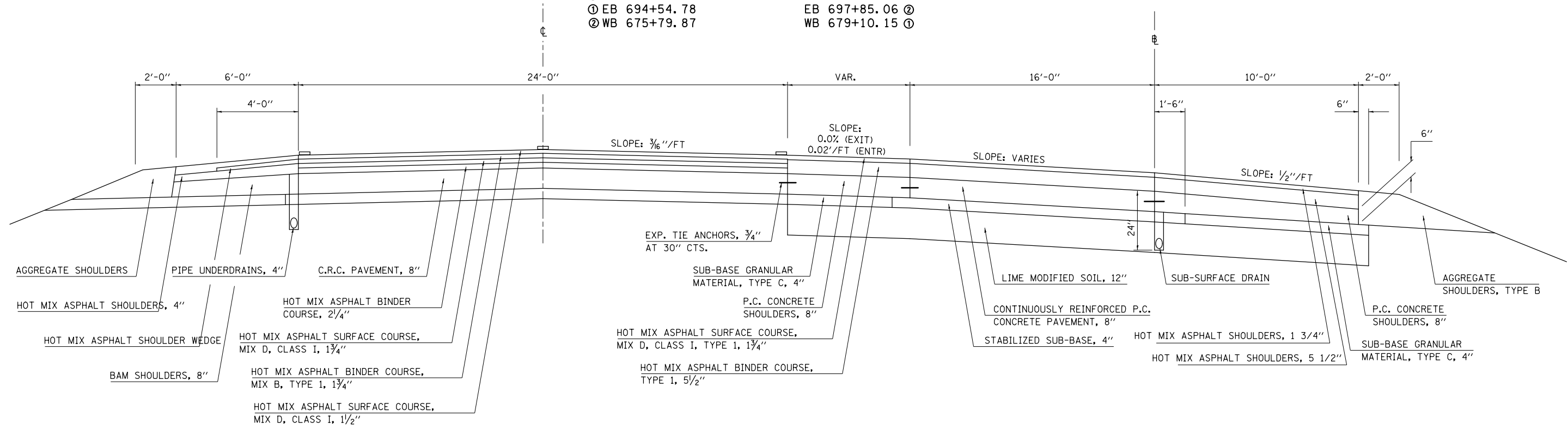

FILE NAME =	USER NAME = leroyma	DESIGNED -	REVISED -
ci:\pw\work\p1dot\leroyma\d0365293\0570438-sht-typicals.dgn		DRAWN -	REVISED -
	PLOT SCALE = 40.0000' / in.	CHECKED -	REVISED -
#MODELNAME#	PLOT DATE = 12/4/2013	DATE -	REVISED -

STATE OF ILLINOIS
DEPARTMENT OF TRANSPORTATION

TYPICAL CROSS SECTIONS

SCALE: SHEET 6 OF 12 SHEETS STA. TO STA.

F.A.I. RTE.	SECTION	COUNTY	TOTAL SHEETS	SHEET NO.
74&57	D5 PATCHING 2014-2	VARIOUS	29	11
CONTRACT NO. 70A38			ILLINOIS FED. AID PROJECT	

LOCATION MAP #2
PIATT CO.

EXISTING TYPICAL CROSS SECTION

4

F.A.I. 74

WESTBOUND LANES

STATION TO STATION
③ 909+40.45 TO 1056+78.00 ⑤

EASTBOUND LANES

STATION TO STATION
③ 909+40.45 TO 1056+30.00 ⑤

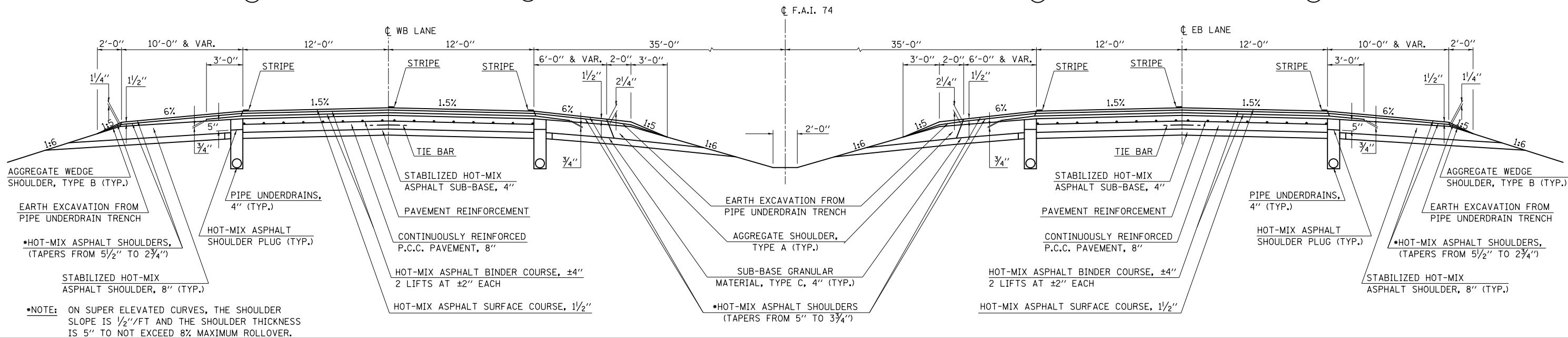

LOCATION MAP #2

EXISTING TYPICAL CROSS SECTION

5

F.A.I. 74

STATION EQUATION:

STA. 1060+00.00 (BK) =
STA. 1056+62.16 (AH)

WESTBOUND LANES

STATION TO STATION
④ 1056+78.00 TO 1256+35.00 ⑥

EASTBOUND LANES

STATION TO STATION
④ 1056+30.00 TO 1258+12.00 ⑥

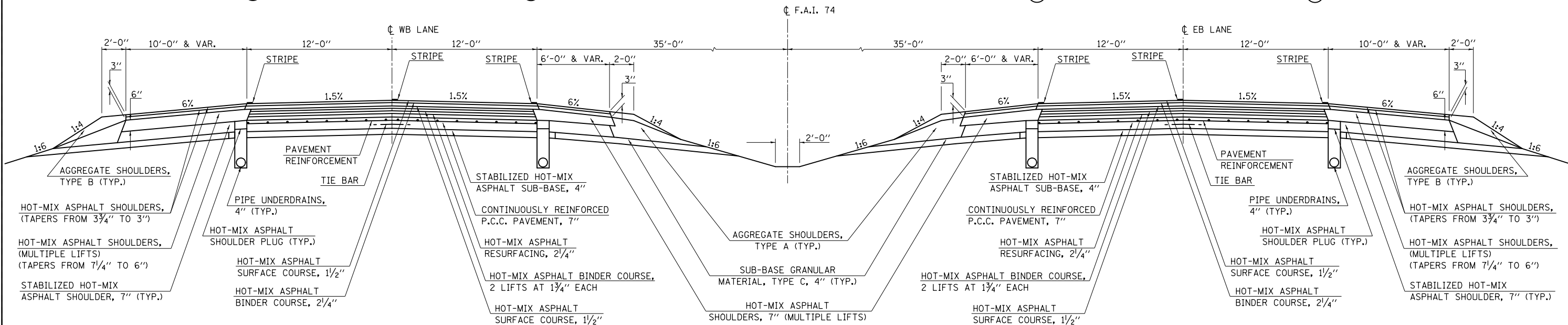

FILE NAME =	USER NAME = leroyma	DESIGNED -	REVISED -
ei:\pwwork\pwwid\l\eroyma\d0365293\0570838-sht-typicals.dgn		DRAWN -	REVISED -
		CHECKED -	REVISED -
		DATE -	REVISED -

STATE OF ILLINOIS
DEPARTMENT OF TRANSPORTATION

TYPICAL CROSS SECTIONS

SCALE: SHEET 7 OF 12 SHEETS STA. TO STA.

F.A.I. RTE.	SECTION	COUNTY	TOTAL SHEETS	SHEET NO.
74&57	D5 PATCHING 2014-2	VARIOUS	29	12
ILLINOIS FED. AID PROJECT			CONTRACT NO. 70A38	

LOCATION MAPS #2 & #3
PIATT & CHAMPAIGN CO.

EXISTING TYPICAL SECTION ⑥

F.A.I. 74

	STATION	TO	STATION
⑤ EB	1258+09		1501+00 ⑦
⑤ WB	1256+31		1496+51 ⑦

PIATT & CHAMPAIGN CO. LINE
AT STA. 1324+77.33

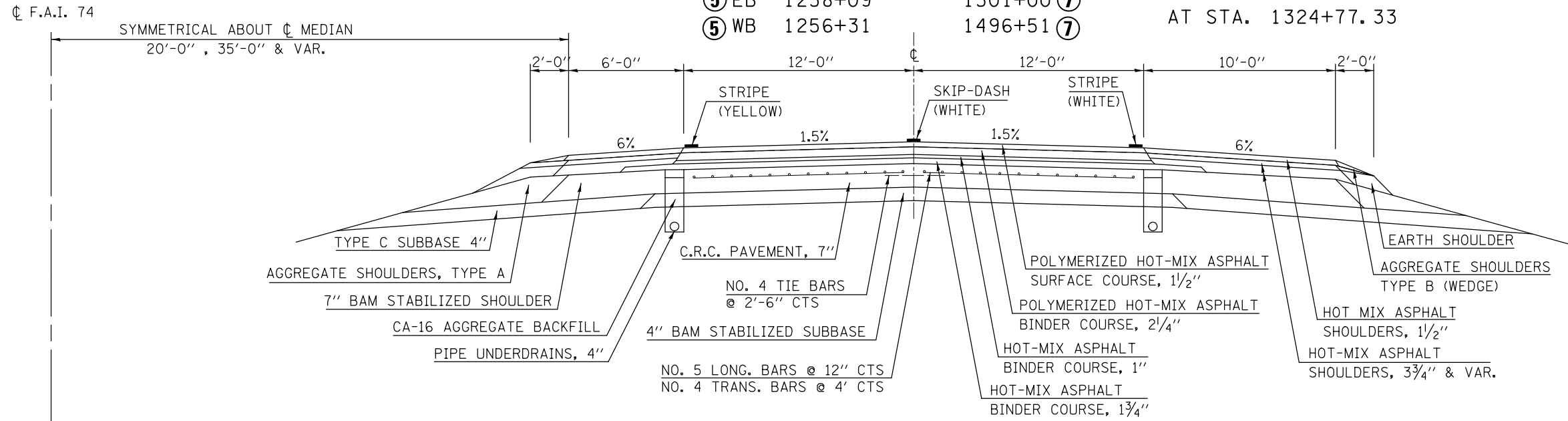

LOCATION MAP #3
PIATT & CHAMPAIGN CO.

EXISTING TYPICAL SECTION ⑦

F.A.I. 74

* BEGIN FULL DEPTH ASPHALT PAVEMENT,
NO PATCHES DESIGNATED IN THIS AREA

	STATION	TO	STATION
⑥ EB	1501+00.00		1870+95.89 *
⑥ WB	1496+51.00		1870+95.89 *

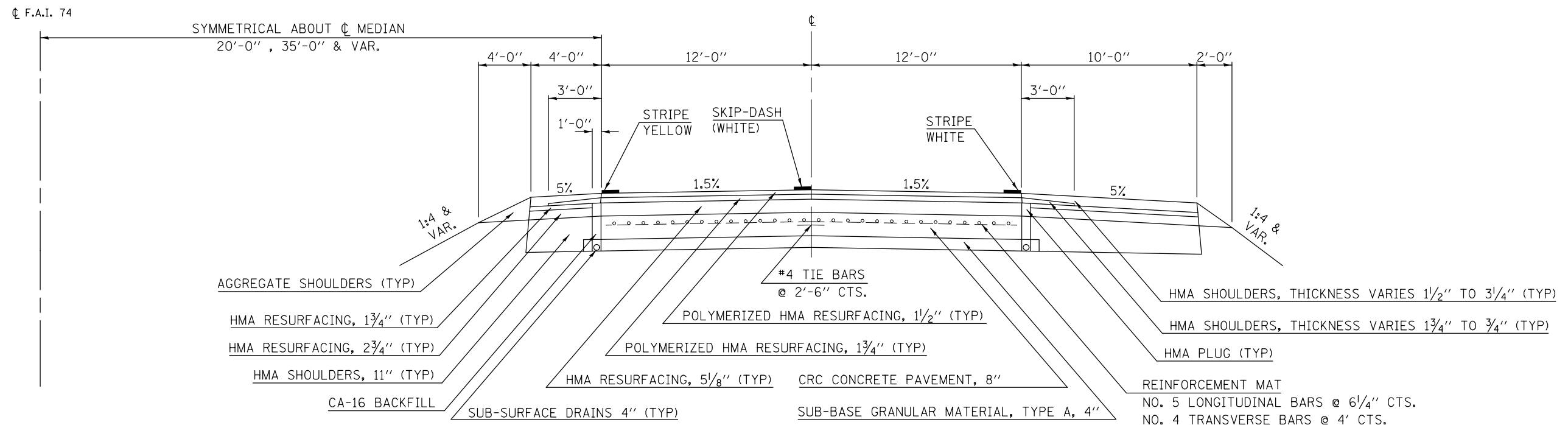

FILE NAME =	USER NAME = leroyma	DESIGNED -	REVISED -	STATE OF ILLINOIS DEPARTMENT OF TRANSPORTATION	TYPICAL CROSS SECTIONS			F.A.I. RTE.	SECTION	COUNTY	TOTAL SHEETS	SHEET NO.	
ei:\pwork\pwork\leroyma\d0365293\0570438-sht-typicals.dgn		DRAWN -	REVISED -		SCALE:	SHEET 8	OF 12 SHEETS	STA.	TO STA.	74&57	D5 PATCHING 2014-2	VARIOUS	29 13
		CHECKED -	REVISED -		CONTRACT NO. 70A38								
MODELNAME		DATE -	REVISED -		ILLINOIS FED. AID PROJECT								

LOCATION MAP #3

EXISTING TYPICAL SECTION 8

* END FULL DEPTH ASPHALT PAVEMENT

F.A.I. 74

STATION TO STATION
 * 429+00.00 880+00.00 9

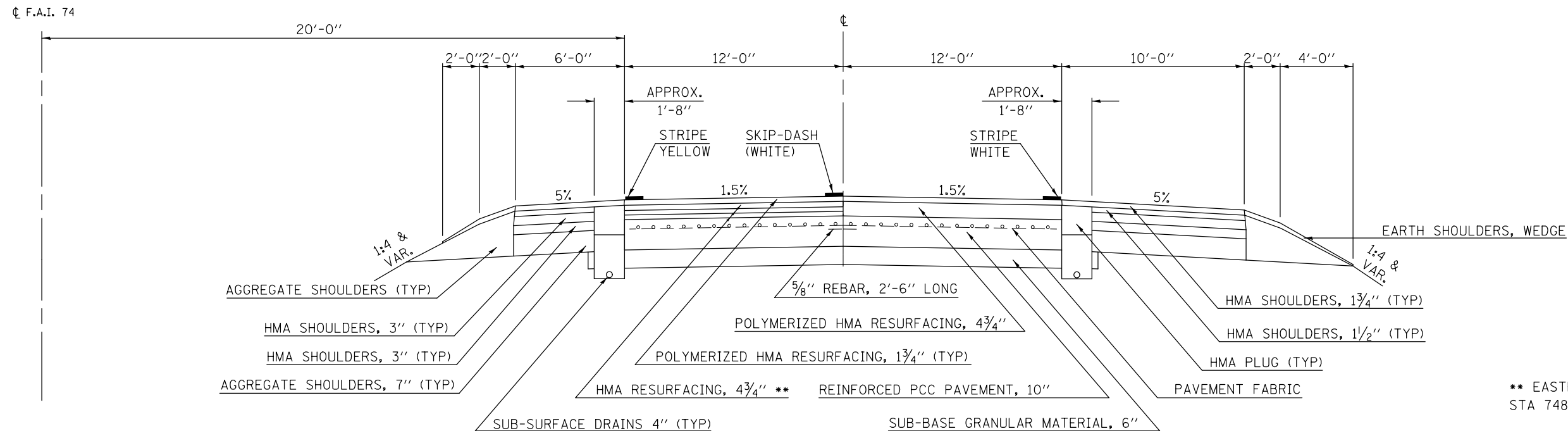

** EASTBOUND LANES - STA 730+0 TO STA 748+00 HMA RESURFACING = 6"±

LOCATION MAPS #3 & #4

EXISTING TYPICAL SECTION 9

CHAMPAIGN AND VERMILION COUNTY
 LINE AT STA 1053+06.00

F.A.I. 74

STATION TO STATION
 8 880+00.00 1616+00.00 10

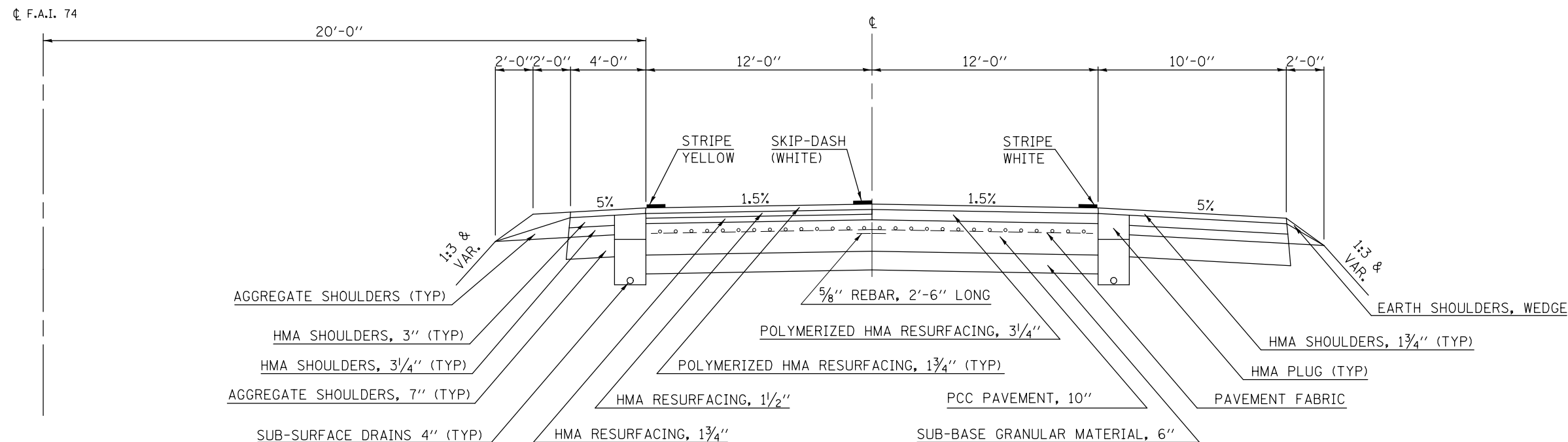

FILE NAME =	USER NAME = leroyma	DESIGNED -	REVISED -
ei:\pw\work\p\dot\l\eroyma\d0365293\0570438-sht-typicals.dgn		DRAWN -	REVISED -
		CHECKED -	REVISED -
		DATE -	REVISED -
*MODELNAME#	PLOT DATE = 12/4/2013		

STATE OF ILLINOIS
 DEPARTMENT OF TRANSPORTATION

TYPICAL CROSS SECTIONS

SCALE: SHEET 9 OF 12 SHEETS STA. TO STA.

F.A.I. RTE.	SECTION	COUNTY	TOTAL SHEETS	SHEET NO.
74&57	D5 PATCHING 2014-2	VARIOUS	29	14
CONTRACT NO. 70A38				
ILLINOIS FED. AID PROJECT				

LOCATION MAP #4

EXISTING TYPICAL SECTION 10

F.A.I. 74

STATION TO STATION
 ⑨ 1616+00.00 1720+00.00 ⑩

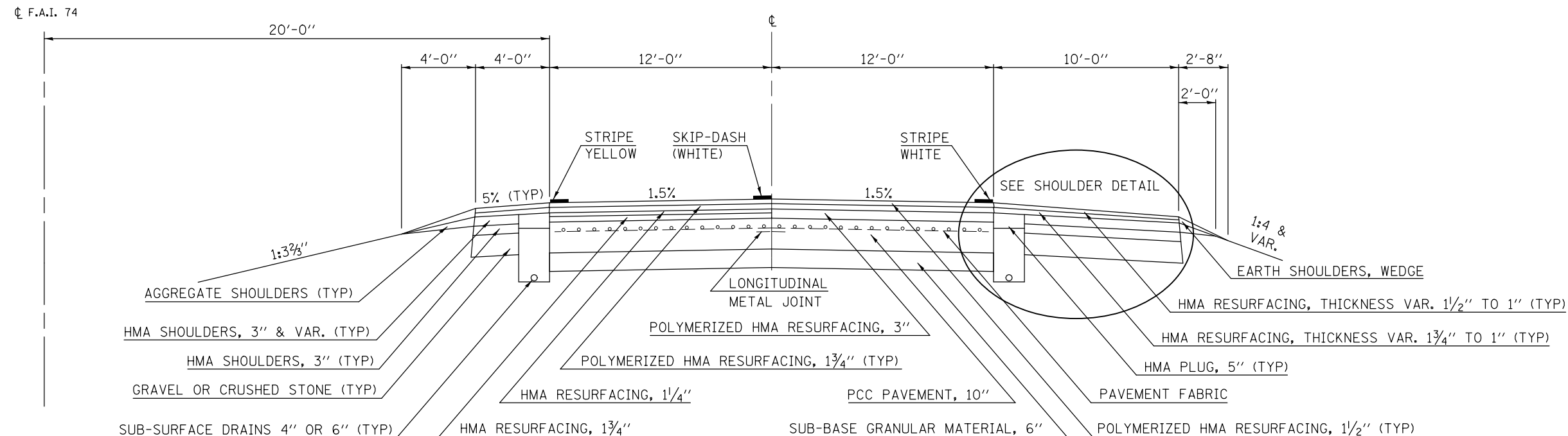

SHOULDER DETAIL

LT. 1618+87.00 TO LT. 1627+88.22
 RT. 1624+65.29 TO RT. 1627+88.22

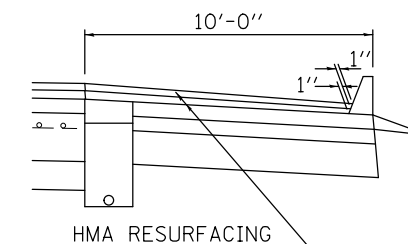

SHOULDER DETAIL

LT. 1631.89.30 TO LT. 1647+92.36 (WB)
 RT. 1631+89.63 TO RT. 1647+36.45 (EB)

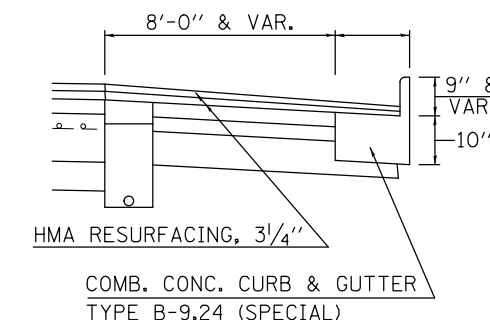

LOCATION MAP #4

EXISTING TYPICAL SECTION 11

F.A.I. 74

STATION TO STATION
 ⑩ 1720+00.00 1908+00.00 ⑫

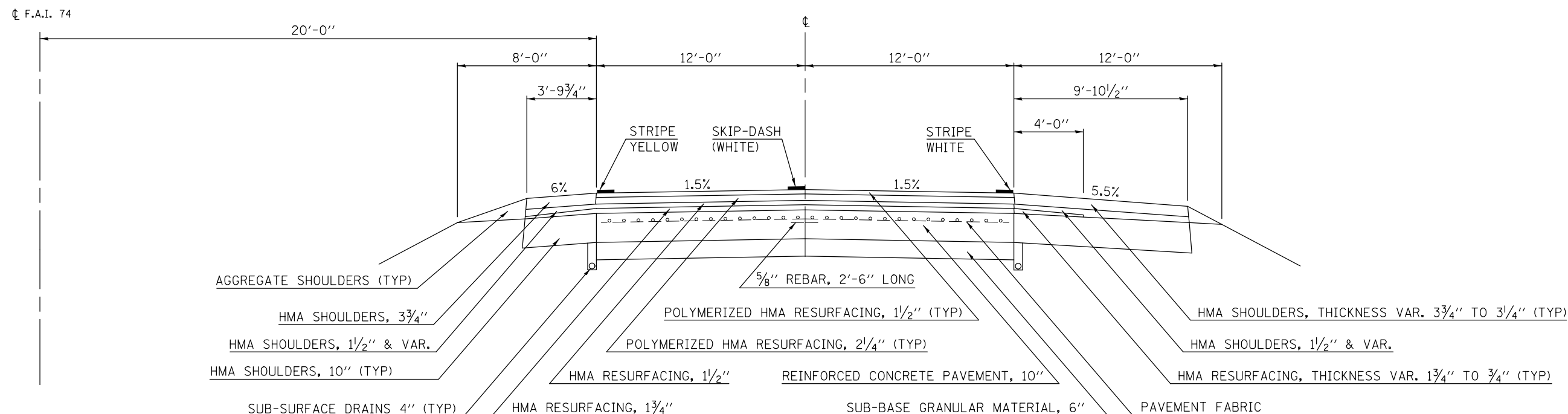

FILE NAME =	USER NAME = leroyma	DESIGNED -	REVISED -	STATE OF ILLINOIS DEPARTMENT OF TRANSPORTATION	TYPICAL CROSS SECTIONS			F.A.I. RTE.	SECTION	COUNTY	TOTAL SHEETS	SHEET NO.
ci:\pw\work\p\dot\l\eroyma\d0365293\0570438-sht-typcals.dgn	PLOT SCALE = 40.0000' / in.	DRAWN -	REVISED -					74&57	D5 PATCHING 2014-2	VARIOUS	29	15
*MODELNAME#	PLOT DATE = 12/4/2013	CHECKED -	REVISED -		SCALE: SHEET 10 OF 12 SHEETS STA. TO STA.			CONTRACT NO. 70A38				
		DATE -	REVISED -		ILLINOIS FED. AID PROJECT							

LOCATION #4

EXISTING TYPICAL SECTION 12

F.A.I. 74

STATION 10 STATION
11 1908+00.00 1951+50.00 13

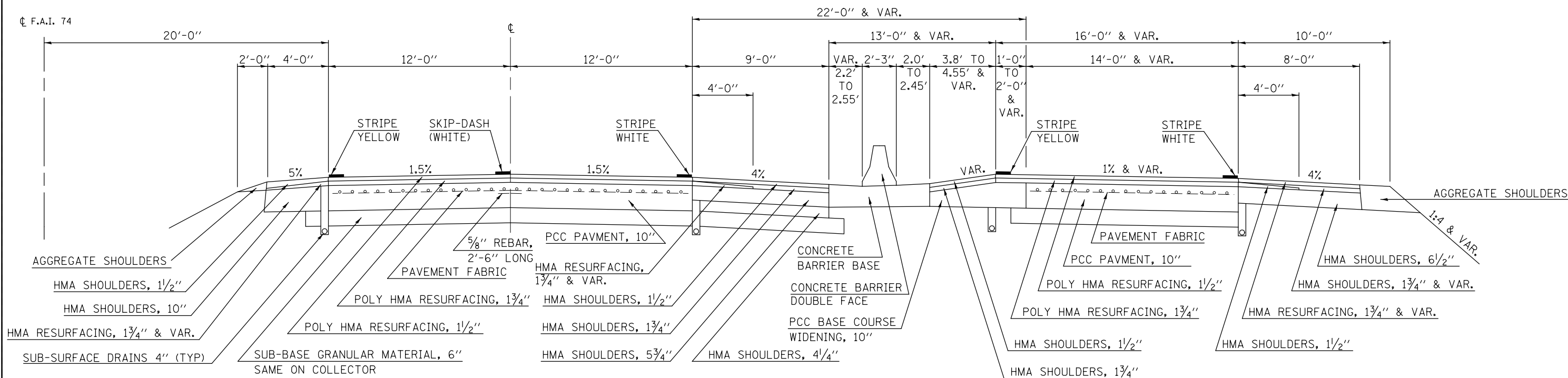

LOCATION #4

EXISTING TYPICAL SECTION 13

F.A.I. 74

STATION 10 STATION
12 1951+50.00 2020+00.00 14

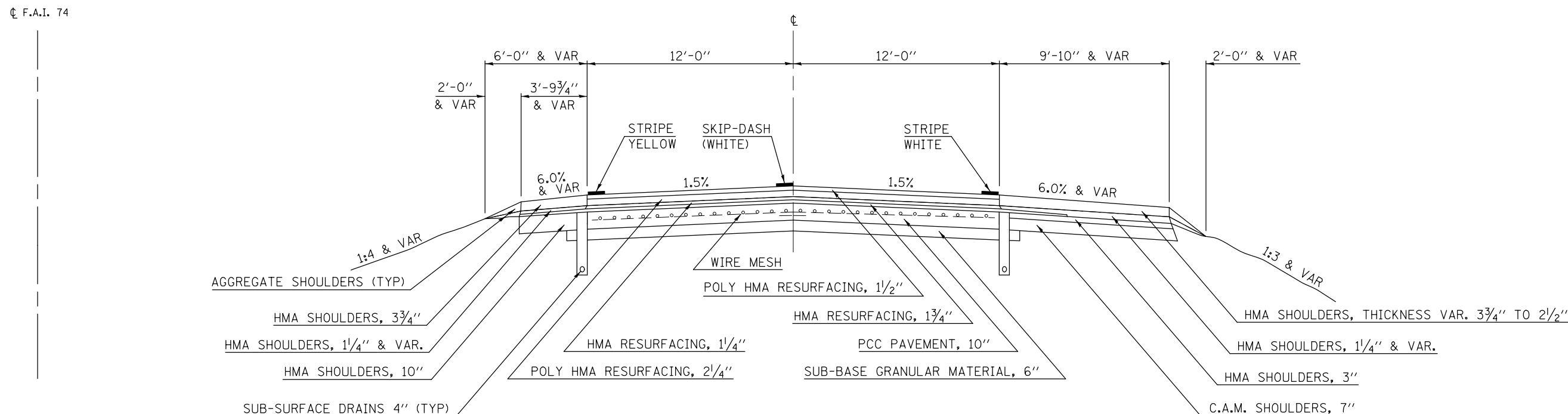

FILE NAME =	USER NAME = leroyma	DESIGNED -	REVISED -	STATE OF ILLINOIS DEPARTMENT OF TRANSPORTATION	TYPICAL CROSS SECTIONS			F.A.I. RT. =	SECTION	COUNTY	TOTAL SHEETS	SHEET NO.
ei:\pw\work\p1dot\leryoma\d0365293\0570138-sht-typicals.dgn	PLOT SCALE = 40.0000' / in.	DRAWN -	REVISED -					74&57	D5 PATCHING 2014-2	VARIOUS	29	16
*MODELNAME#	PLOT DATE = 12/4/2013	CHECKED -	REVISED -		SCALE:	SHEET 11	OF 12 SHEETS	STA.	TO STA.	CONTRACT NO. 70A38		
		DATE -	REVISED -							ILLINOIS FED. AID PROJECT		

EXISTING TYPICAL SECTION 14

F.A.I. 74

STATION IO STATION
 13 2020+00.00 2231+13.24

☉ F.A.I. 74

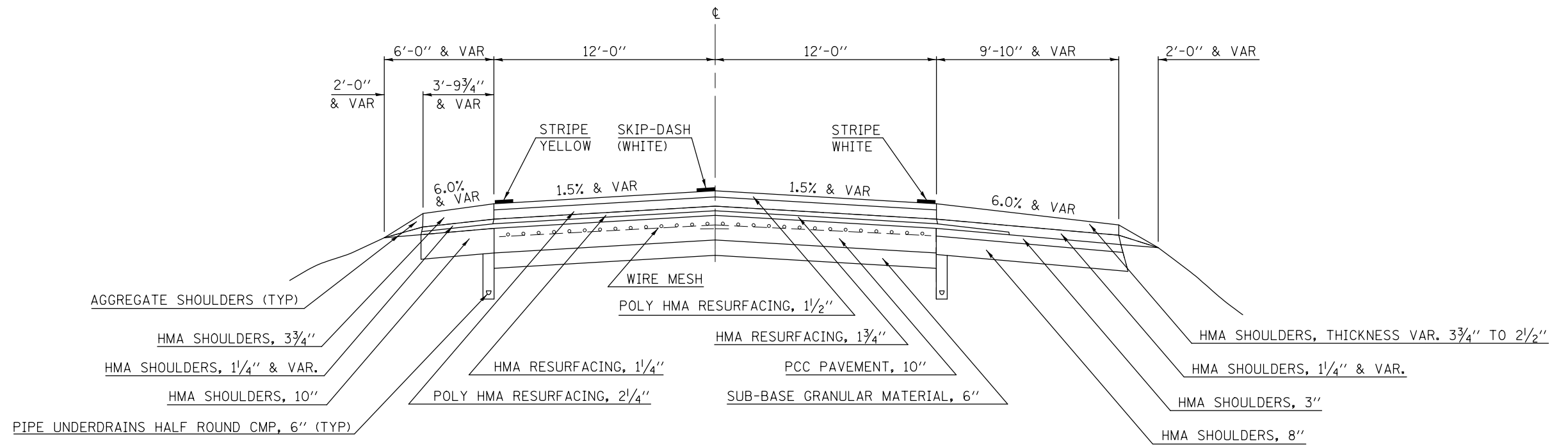

FILE NAME =	USER NAME = leroyma	DESIGNED -	REVISED -
ci:\pwork\pwork\leryma\d0365293\0570438-sht-typicals.dgn		DRAWN -	REVISED -
	PLOT SCALE = 40.0000' / in.	CHECKED -	REVISED -
#MODELNAME#	PLOT DATE = 12/4/2013	DATE -	REVISED -

STATE OF ILLINOIS
 DEPARTMENT OF TRANSPORTATION

TYPICAL CROSS SECTIONS			
SCALE:	SHEET 12	OF 12 SHEETS	STA. TO STA.

F.A.I. RTE.	SECTION	COUNTY	TOTAL SHEETS	SHEET NO.
74&57	D5 PATCHING 2014-2	VARIOUS	29	17
CONTRACT NO. 70A38				
ILLINOIS FED. AID PROJECT				

LOCATION MAP #5

EXISTING TYPICAL SECTION

F.A.I. 57

STATION	TO	STATION
350+00.00		526+64.06 (NB & SB)
83+43.47		401+15.77 (NB) ③
83+43.47		135+00.00 (SB) ②
346+13.00		401+15.77 (SB) ③

STATION EQUATIONS:

STA 526+64.06 (BK) = STA 83+43.47 (AH)
 STA 373+56.20 (BK) = STA 373+51.69 (AH)

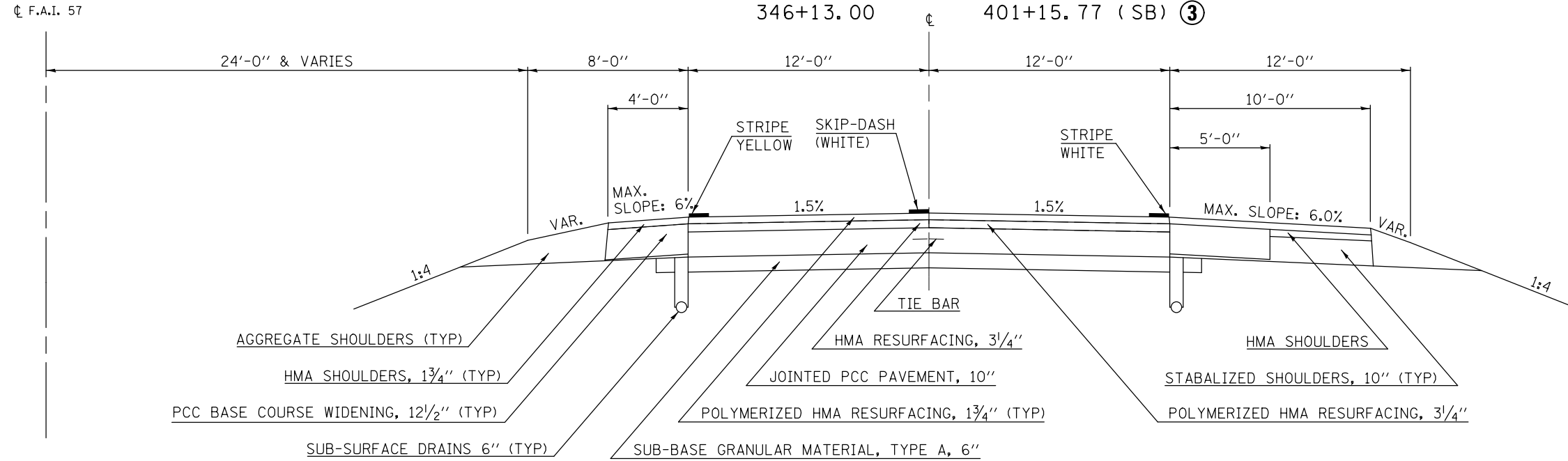

LOCATION MAP #5

EXISTING TYPICAL SECTION

F.A.I. 57

STATION	TO	STATION
① 135+00.00		346+13.00 (SB) ①

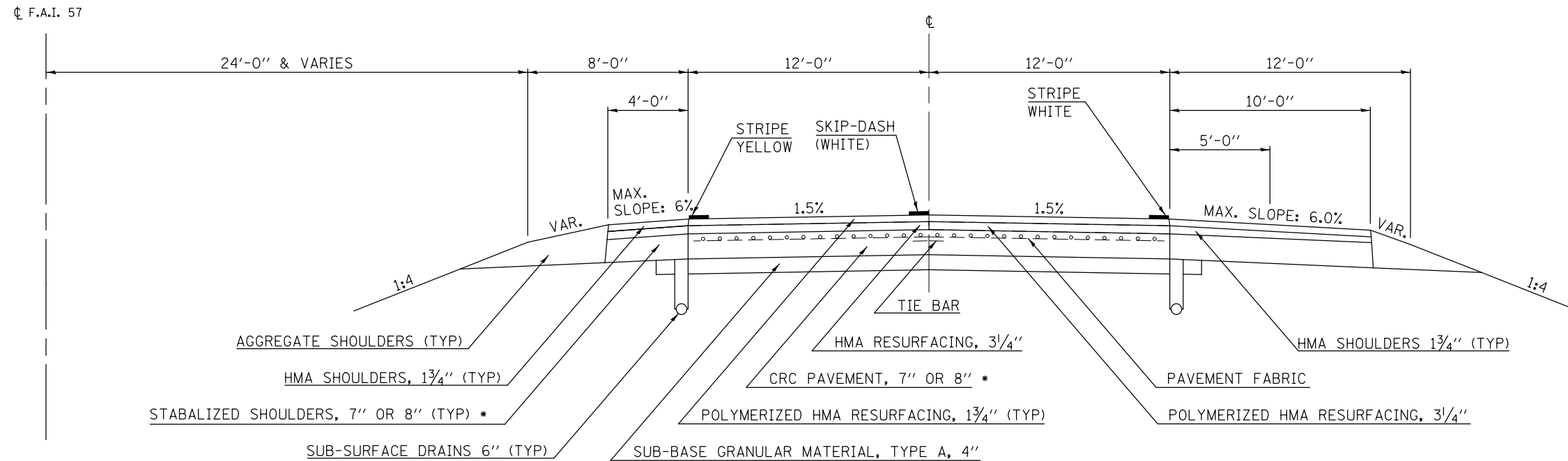

* STA. 135+00.00 TO STA. 241+00.00 - 7"
 STA. 241+00.00 TO STA. 346+13.00 - 8"

FILE NAME =	USER NAME = leroyma	DESIGNED -	REVISED -
ei:\pwork\pwork\leryoma\d0365293\0570038-sht-typicals.dgn		DRAWN -	REVISED -
		CHECKED -	REVISED -
		DATE -	REVISED -
MODELNAME	PLOT DATE = 12/4/2013		

STATE OF ILLINOIS
 DEPARTMENT OF TRANSPORTATION

TYPICAL CROSS SECTIONS

SCALE: SHEET 1 OF 12 SHEETS STA. TO STA.

F.A.I. RTE.	SECTION	COUNTY	TOTAL SHEETS	SHEET NO.
74&57	D5 PATCHING 2014-2	VARIOUS	29	18
CONTRACT NO. 70A38				
ILLINOIS FED. AID PROJECT				

LOCATION MAP #5

EXISTING TYPICAL SECTION ③ F.A.I. 57

STATION I0 STATION
 ① 401+15.77 492+69.23 ④
 ④ 522+00.92 545+00.00 ⑤

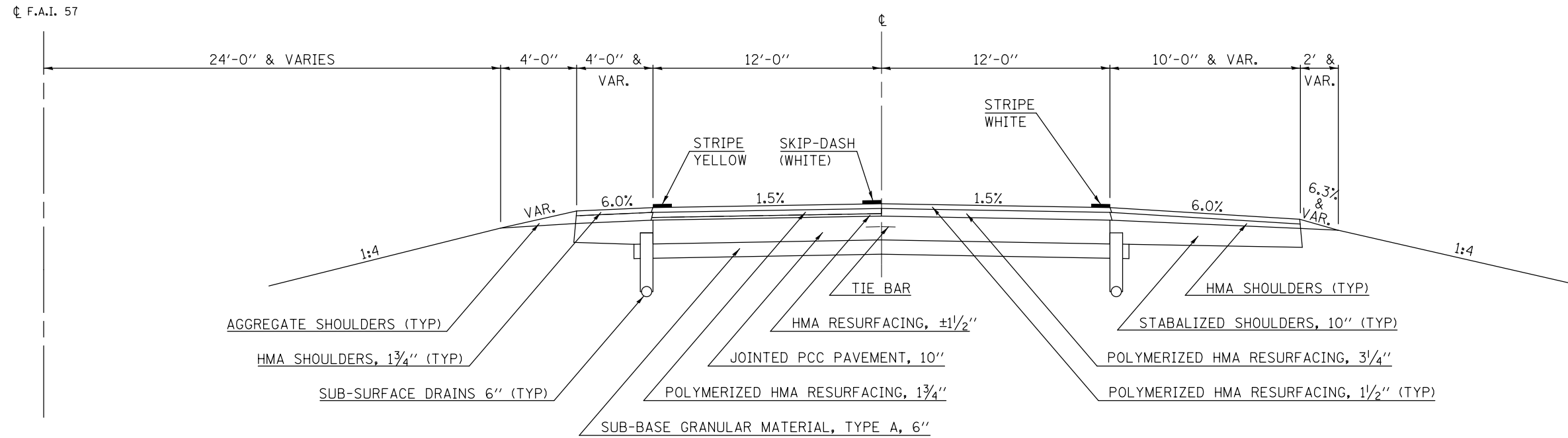

LOCATION MAP #5

EXISTING TYPICAL SECTION ④ F.A.I. 57

STATION I0 STATION
 ③ 492+69.23 522+00.92 ③

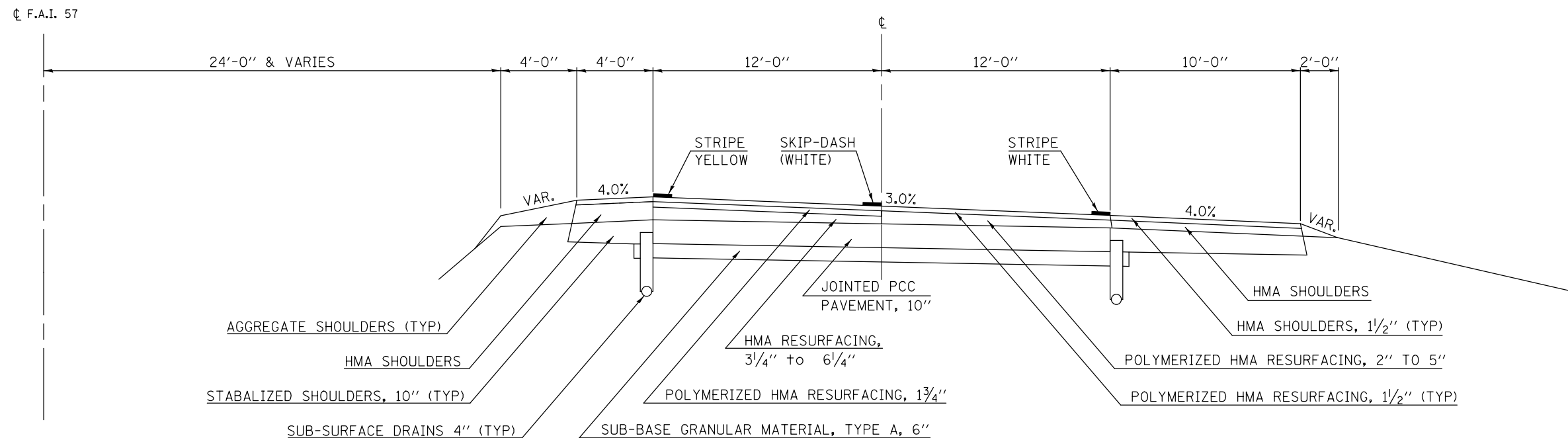

FILE NAME =	USER NAME = leroyma	DESIGNED -	REVISED -
ct:\pw\work\p1dot\leroyma\d0365293\0570438-sht-typcals.dgn		DRAWN -	REVISED -
	PLOT SCALE = 40.0000' / in.	CHECKED -	REVISED -
#MODELNAME#	PLOT DATE = 12/4/2013	DATE -	REVISED -

STATE OF ILLINOIS
DEPARTMENT OF TRANSPORTATION

TYPICAL CROSS SECTIONS

SCALE: SHEET 2 OF 12 SHEETS STA. TO STA.

F.A.I. RTE.	SECTION	COUNTY	TOTAL SHEETS	SHEET NO.
74&57	D5 PATCHING 2014-2	VARIOUS	29	19
CONTRACT NO. 70A38				
ILLINOIS FED. AID PROJECT				

LOCATION MAP #5

EXISTING TYPICAL SECTION ⑤

F.A.I. 57

STATION IO STATION
 ③ 545+00.00 575+00.00 ⑥

☉ F.A.I. 57

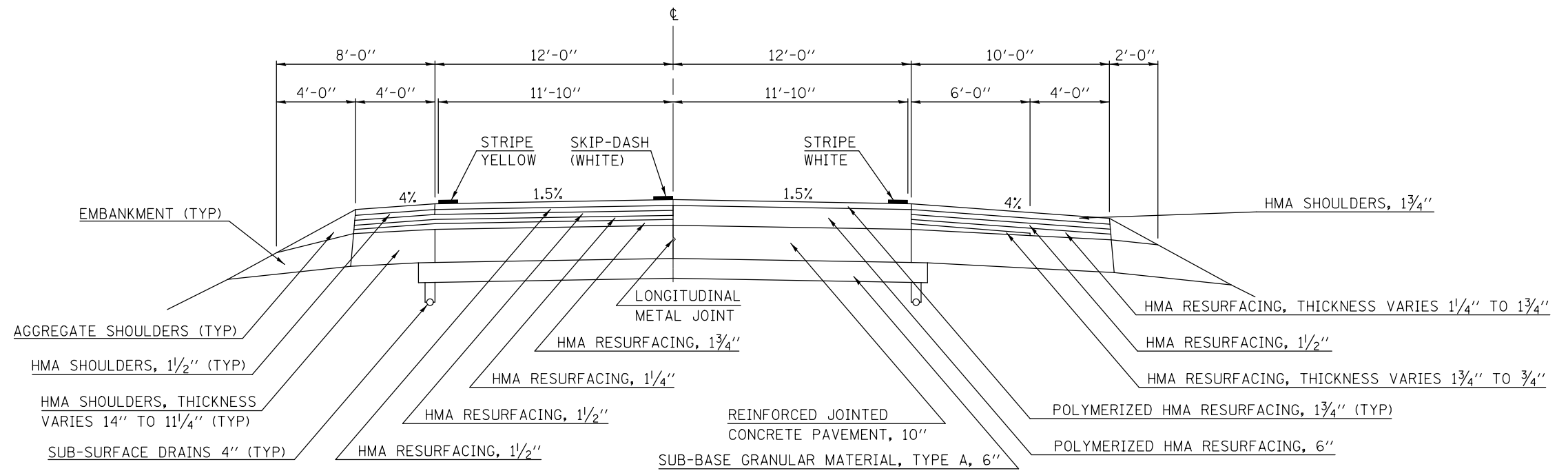

LOCATION MAP #5

EXISTING TYPICAL SECTION ⑥

F.A.I. 57

STATION IO STATION
 ⑤ 575+00.00 623+36.00 ⑦ ⑧

☉ F.A.I. 57

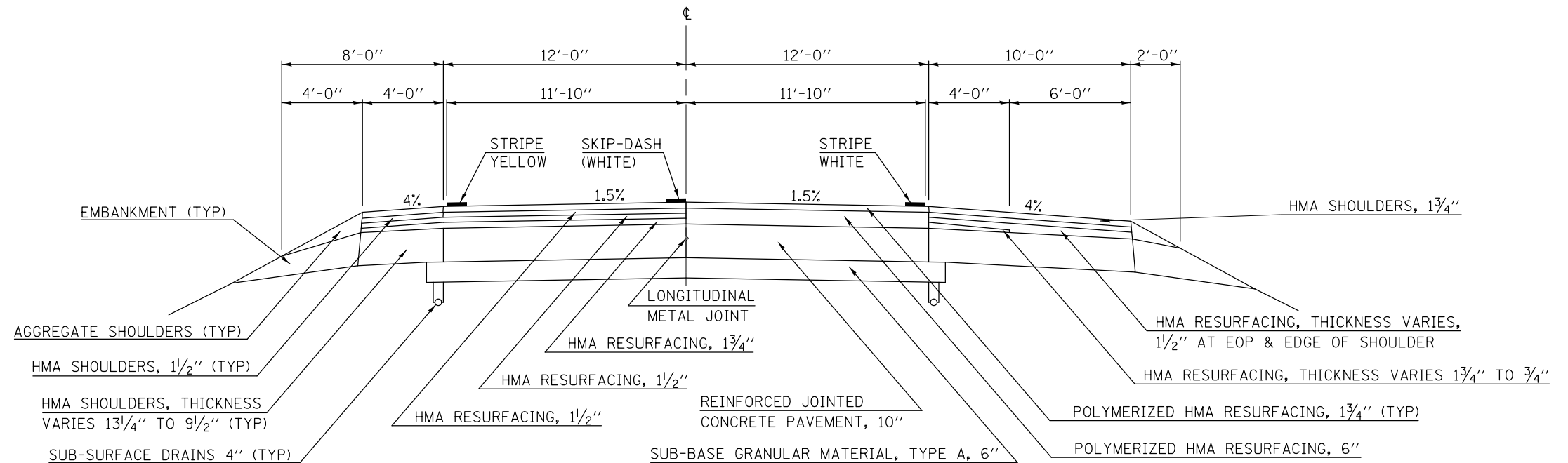

FILE NAME =	USER NAME = leroyma	DESIGNED -	REVISED -
ct:\pwork\pwork\leryoma\0365293\057038-sht-typicals.dgn		DRAWN -	REVISED -
	PLOT SCALE = 40.0000' / in.	CHECKED -	REVISED -
*MODELNAME#	PLOT DATE = 12/4/2013	DATE -	REVISED -

STATE OF ILLINOIS
 DEPARTMENT OF TRANSPORTATION

TYPICAL CROSS SECTIONS

SCALE: SHEET 3 OF 12 SHEETS STA. TO STA.

F.A.I. RTE.	SECTION	COUNTY	TOTAL SHEETS	SHEET NO.
74&57	D5 PATCHING 2014-2	VARIOUS	29	20
CONTRACT NO. 70A38				
ILLINOIS FED. AID PROJECT				

LOCATION MAP #5

EXISTING TYPICAL SECTION ⑦

F.A.I. 57

NORTHBOUND LANES

STATION I/O STATION
 ⑥ 623+36.00 637+50.00

☉ F.A.I. 57

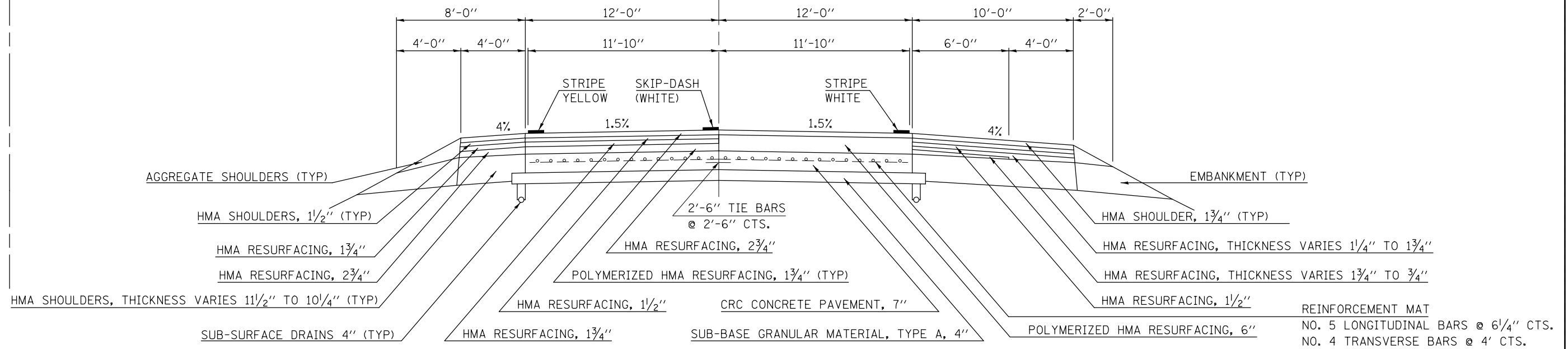

LOCATION MAP #5

EXISTING TYPICAL SECTION ⑧

F.A.I. 57

SOUTHBOUND LANES

STATION I/O STATION
 ⑥ 623+36.00 637+50.00

☉ F.A.I. 57

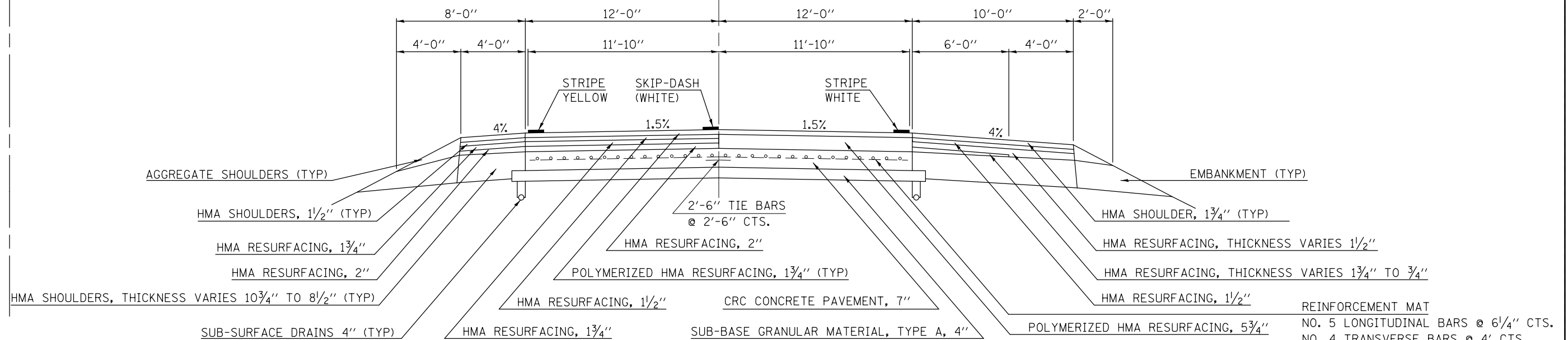

FILE NAME =	USER NAME = leroyma	DESIGNED -	REVISED -	STATE OF ILLINOIS DEPARTMENT OF TRANSPORTATION	TYPICAL CROSS SECTIONS			F.A.I. RTE.	SECTION	COUNTY	TOTAL SHEETS	SHEET NO.
et:\pwork\pwork\leryoma\0365293\0570438-sht-typicals.dgn	PLOT SCALE = 40.0000' / in.	DRAWN -	REVISED -					74&57	D5 PATCHING 2014-2	VARIOUS	29	21
*MODELNAME#	PLOT DATE = 12/4/2013	CHECKED -	REVISED -		SCALE: SHEET 4 OF 12 SHEETS STA. TO STA.			CONTRACT NO. 70A38				
		DATE -	REVISED -		ILLINOIS FED. AID PROJECT							

SCHEDULE OF QUANTITIES

F.A.I. 74

PARTIAL DEPTH PATCHING

STATION	REMARKS OR STRUCTURE NUMBER	DIRECTION	LANE	PRIORITY (1 = HIGHEST 3 = LOWEST)	LENGTH (ft)	WIDTH (ft)	APPROX. PARTIAL DEPTH REMOVAL THICKNESS (INCH)	EXISTING OVERLAY THICKNESS (4 3/4" or less) (Inch)	PARTIAL DEPTH REMOVAL, VARIABLE DEPTH X4422000 (sq. yd)	PARTIAL DEPTH REMOVAL, 5" 44022037 (sq. yd)	PARTIAL DEPTH PATCHING X4421000 (tons)
DEWITT											
715+00	NO	EASTBOUND	DRIVING	3	8.00	12.00	5.00	8 3/4"		10.7	3.0
733+71	NO	EASTBOUND	DRIVING	3	6.00	12.00	5.00	8 3/4"		8.0	2.2
745+73	0026	EASTBOUND	DRIVING	1	70.00	12.00	5 TO 1.5	8 3/4"	93.3		17.0
749+39	0026	EASTBOUND	DRIVING	1	30.00	12.00	5 TO 1.5	8 3/4"	40.0		7.3
769+58	NO	EASTBOUND	DRIVING	3	15.00	12.00	5.00	8 3/4"		20.0	2.5
775+07	0028	EASTBOUND	DRIVING	1	51.00	12.00	5 TO 1.5	8 3/4"	68.0		12.4
776+14	0028	EASTBOUND	DRIVING	1	22.00	12.00	5 TO 1.5	8 3/4"	29.3		5.3
783+38	NO	EASTBOUND	DRIVING	3	20.00	12.00	5.00	8 3/4"		26.7	7.5
793+00	NO	EASTBOUND	DRIVING	1	25.00	12.00	5.00	8 3/4"		33.3	9.3
806+00	NO	EASTBOUND	DRIVING	1	8.00	12.00	5.00	8 3/4"		10.7	3.0
807+28	0030	EASTBOUND	DRIVING	2	22.00	12.00	5 TO 1.5	8 3/4"	29.3		5.3
808+76	0030	EASTBOUND	DRIVING	3	10.00	12.00	5 TO 1.5	8 3/4"	13.3		2.4
815+90	0032	EASTBOUND	DRIVING	1	8.00	12.00	5 TO 1.5	8 3/4"	10.7		1.9
816+05	0032	EASTBOUND	DRIVING	1	8.00	12.00	5 TO 1.5	8 3/4"	10.7		1.9
817+67	0032	EASTBOUND	DRIVING	1	6.00	12.00	5 TO 1.5	8 3/4"	8.0		1.5
818+00	0032	EASTBOUND	DRIVING	1	25.00	12.00	5 TO 1.5	8 3/4"	33.3		6.1
865+38	0036	EASTBOUND	DRIVING	1	6.00	12.00	5 TO 1.5	8 3/4"	8.0		1.5
867+23	0036	EASTBOUND	DRIVING	1	45.00	12.00	5 TO 1.5	8 3/4"	60.0		10.9
876+74	NO	EASTBOUND	DRIVING	3	10.00	12.00	5.00	8 3/4"		13.3	3.7
876+74	NO	EASTBOUND	PASSING	3	10.00	12.00	5.00	8 3/4"		13.3	3.7
867+22	0037	WESTBOUND	DRIVING	1	6.00	12.00	5 TO 1.5	8 3/4"	8.0		1.5
865+00	0037	WESTBOUND	DRIVING	1	6.00	12.00	5 TO 1.5	8 3/4"	8.0		1.5
817+67	0033	WESTBOUND	DRIVING	1	15.00	12.00	5 TO 1.5	8 3/4"	20.0		3.6
816+05	0033	WESTBOUND	DRIVING	1	6.00	12.00	5 TO 1.5	8 3/4"	8.0		1.5
808+87	0031	WESTBOUND	DRIVING	1	70.00	12.00	5 TO 1.5	8 3/4"	93.3		17.0
807+38	0031	WESTBOUND	DRIVING	1	30.00	12.00	5 TO 1.5	8 3/4"	40.0		7.3
776+01	0029	WESTBOUND	DRIVING	1	6.00	12.00	5 TO 1.5	8 3/4"	8.0		1.5
774+92	0029	WESTBOUND	DRIVING	1	70.00	12.00	5 TO 1.5	8 3/4"	93.3		17.0
748+41	0027	WESTBOUND	DRIVING	1	6.00	12.00	5 TO 1.5	8 3/4"	8.0		1.5
744+75	0027	WESTBOUND	DRIVING	1	15.00	12.00	5 TO 1.5	8 3/4"	20.0		3.6
DEWITT TOTAL									710.7	136.0	164.3
USE									711.0	136.0	165.0

SCHEDULE OF QUANTITIES

F.A.I. 74

PARTIAL DEPTH PATCHING (cont.)

STATION	REMARKS OR STRUCTURE NUMBER	DIRECTION	LANE	PRIORITY (1 = HIGHEST 3 = LOWEST)	LENGTH (ft)	WIDTH (ft)	APPROX. PARTIAL DEPTH REMOVAL THICKNESS (INCH)	EXISTING OVERLAY THICKNESS (4 3/4" or less) (inch)	PARTIAL DEPTH REMOVAL, VARIABLE DEPTH X4422000 (sq. yd)	PARTIAL DEPTH REMOVAL, 5" 44022037 (sq. yd)	PARTIAL DEPTH PATCHING X4421000 (tons)
PIATT CO:											
1191+50	0043	WESTBOUND	DRIVING	1	8.00	12.00	5 TO 1.5	11"	10.7		1.9
1190+77	0043	WESTBOUND	DRIVING	1	25.00	12.00	5 TO 1.5	11"	33.3		6.1
1188+42	0043	WESTBOUND	DRIVING	1	25.00	12.00	5 TO 1.5	11"	33.3		6.1
1188+27	0043	WESTBOUND	DRIVING	1	8.00	12.00	5 TO 1.5	11"	10.7		1.9
1188+00	0043	WESTBOUND	DRIVING	1	8.00	12.00	5 TO 1.5	11"	10.7		1.9
1080+50	NO	WESTBOUND	DRIVING	3	8.00	12.00	5.00	11"		10.7	3.0
1053+11	NO	WESTBOUND	DRIVING	3	10.00	12.00	5.00	5 1/2"		13.3	3.7
961+90	NO	WESTBOUND	DRIVING	3	6.00	12.00	5.00	5 1/2"		8.0	2.2
924+90	0038	WESTBOUND	DRIVING	1	15.00	12.00	5 TO 1.5	5 1/2"	20.0		3.6
924+56	0038	WESTBOUND	DRIVING	1	40.00	12.00	5 TO 1.5	5 1/2"	53.3		9.7
921+44	0038	WESTBOUND	DRIVING	1	70.00	12.00	5 TO 1.5	5 1/2"	93.3		17.0
921+03	0037	EASTBOUND	DRIVING	1	75.00	12.00	5 TO 1.5	5 1/2"	100.0		18.2
924+07	0037	EASTBOUND	DRIVING	1	48.00	12.00	5 TO 1.5	5 1/2"	64.0		11.6
933+00	NO	EASTBOUND	DRIVING	3	6.00	12.00	5.00	5 1/2"		8.0	2.2
1187+90	0042	EASTBOUND	DRIVING	1	6.00	12.00	5 TO 1.5	11"	8.0		1.5
1188+42	0042	EASTBOUND	DRIVING	1	150.00	12.00	5 TO 1.5	11"	200.0		36.4
1190+77	0042	EASTBOUND	DRIVING	1	35.00	12.00	5 TO 1.5	11"	46.7		8.5
1191+50	0042	EASTBOUND	DRIVING	1	6.00	12.00	5 TO 1.5	11"	8.0		1.5
1245+04	NO	EASTBOUND	DRIVING	3	6.00	12.00	5.00	11"		8.0	2.2
1257+71	NO	EASTBOUND	DRIVING	3	6.00	12.00	5.00	6 1/2"		8.0	2.2
PIATT TOTAL									692.0	56.0	141.6
USE									692.0	56.0	142.0
TOTAL									1403.0	192.0	307.0

SCHEDULE OF QUANTITIES

F.A.I. 74

CLASS A PATCHES, TYPE II, 17 INCH (44200637)

STATION	RUR URB	STRUCTURE/ COUNTY	DIRECTION	LANE	PRIORITY	LENGTH	WIDTH	ROUTE	AREA SQ.YD	TYPE	SAW CUTS (44213200)	TIE BARS 3/4" (44213204)	PATCHING REINFORCEMENT 44213000
											FOOT	EACH	SQ. YD
1645+51	URB	CHAMP.	EASTBOUND	DRIVING	1	10.0	12.0	I-74	13.3	II	68.0	0.0	13.3
1820+07	URB	CHAMP.	WESTBOUND	PASSING	1	6.0	12.0	I-74	8.0	II	60.0	0.0	8.0
URBAN SUB-TOTAL									22.0		128.0	0.0	22.0
1807+48	RUR	CHAMP.	WESTBOUND	PASSING	1	6.0	12.0	I-74	8.0	II	60.0	0.0	8.0
1807+48	RUR	CHAMP.	WESTBOUND	DRIVING	1	6.0	12.0	I-74	8.0	II	60.0	0.0	8.0
RURAL SUB-TOTAL									16.0		120.0	0.0	16.0
1584+84	URB	CHAMP.	WESTBOUND	DRIVING	1	10.0	12.0	I-74	13.3	II	68.0	0.0	13.3
1571+73	URB	CHAMP.	WESTBOUND	DRIVING	1	10.0	12.0	I-74	13.3	II	68.0	0.0	13.3
URBAN SUB-TOTAL									27.0		136.0	0.0	27.0
TOTAL									65.0		384.0	0.0	65.0
USE									65.0		384.0	0.0	65.0

CLASS A PATCHES, TYPE III, 17 INCH (44200641)

STATION	RUR URB	STRUCTURE/ COUNTY	DIRECTION	LANE	PRIORITY	LENGTH	WIDTH	ROUTE	AREA SQ.YD	TYPE	SAW CUTS (44213200)	TIE BARS 3/4" (44213204)	PATCHING REINFORCEMENT 44213000
											FOOT	EACH	SQ. YD
1699+88	URB	CHAMP.	EASTBOUND	DRIVING	1	15.0	12.0	I-74	20.0	III	78.0	0.0	20.0
1515+50	URB	CHAMP.	WESTBOUND	DRIVING	1	12.0	12.0	I-74	16.0	III	72.0	0.0	16.0
TOTAL									36.0		150.0	0.0	36.0
USE									36.0		150.0	0.0	36.0

CLASS A PATCHES, TYPE IV, 17 INCH (44200643)

STATION	RUR URB	STRUCTURE/ COUNTY	DIRECTION	LANE	PRIORITY	LENGTH	WIDTH	ROUTE	AREA SQ.YD	TYPE	SAW CUTS (44213200)	TIE BARS 3/4" (44213204)	PATCHING REINFORCEMENT 44213000
											FOOT	EACH	SQ. YD
1519+89	URB	CHAMP.	WESTBOUND	PASSING	3	80.0	12.0	I-74	106.7	IV	208.0	40.0	106.7
1519+89	URB	CHAMP.	WESTBOUND	DRIVING	3	80.0	12.0	I-74	106.7	IV	208.0	40.0	106.7
TOTAL									214.0		416.0	80.0	214.0
USE									214.0		416.0	80.0	214.0

SCHEDULE OF QUANTITIES

F.A.I. 57/74

CLASS A PATCHES, TYPE II, 13 INCH

(44200610)

STATION	RUR/URB	STRUCTURE/ COUNTY	DIRECTION	LANE	PRIORITY	LENGTH	WIDTH	ROUTE	AREA SQ.YD	TYPE	SAW CUTS (44213200)	TIE BARS 3/4" (44213204)	PATCHING REINFORCEMENT 44213000
											FOOT	EACH	SQ. YD
323+39	URB	CHAMP.	SOUTHBOUND	DRIVING	1	6.0	12.0	I-57	8.0	II	60.0	0.0	8.0
251+06	URB	CHAMP.	SOUTHBOUND	DRIVING	1	6.0	12.0	I-57	8.0	II	60.0	0.0	8.0
URBAN SUB-TOTAL									16.0		120.0	0.0	16.0
240+22	RUR	CHAMP.	SOUTHBOUND	DRIVING	1	10.0	12.0	I-57	13.3	II	68.0	0.0	13.3
121+37	RUR	CHAMP.	SOUTHBOUND	DRIVING	1	6.0	12.0	I-57	8.0	II	60.0	0.0	8.0
RURAL SUB-TOTAL									22.0		128.0	0.0	22.0
TOTAL									38.0		248.0	0.0	38.0
USE									38.0		248.0	0.0	38.0

CLASS A PATCHES, TYPE IV, 13 INCH

(44200614)

STATION	RUR/URB	STRUCTURE/ COUNTY	DIRECTION	LANE	PRIORITY	LENGTH	WIDTH	ROUTE	AREA SQ.YD	TYPE	SAW CUTS (44213200)	TIE BARS 3/4" (44213204)	PATCHING REINFORCEMENT 44213000
											FOOT	EACH	SQ. YD
338+14	URB	CHAMP.	SOUTHBOUND	DRIVING	1	20.0	12.0	I-57	26.7	II	88.0	10.0	26.7
TOTAL									27.0		88.0	10.0	27.0
USE									27.0		88.0	10.0	27.0

CLASS B PATCHES, TYPE II, 14 INCH

(44200637)

STATION	RUR/URB	STRUCTURE/ COUNTY	DIRECTION	LANE	PRIORITY	LENGTH	WIDTH	ROUTE	AREA SQ.YD	TYPE	DOWEL BARS, 1 1/2" 44201299	SAW CUTS (44213200)	TIE BARS 3/4" (44213204)	PAVEMENT FABRIC 44213100
											EACH	FOOT	EACH	SQ. YD
533+17	RUR	CHAMP.	NORTHBOUND	DRIVING	1	10.00	12.00	I-57	13.33	II	20.00	56.00	0.00	0.00
544+48	RUR	CHAMP.	NORTHBOUND	DRIVING	1	10.00	12.00	I-57	13.33	II	20.00	56.00	0.00	0.00
RURAL SUB-TOTAL									27.00		40.00	112.00	0.00	0.00
531+00	URB	CHAMP.	SOUTHBOUND	DRIVING	1	6.00	12.00	I-57	8.00	II	20.00	48.00	0.00	0.00
118+95	URB	EQ. STA.	SOUTHBOUND	PASSING	1	6.00	12.00	I-57	8.00	II	20.00	48.00	0.00	0.00
URBAN SUB-TOTAL									16.00		40.00	96.00	0.00	0.00
1925+00	URB	VERMILION	EASTBOUND	DRIVING	1	6.00	12.00	I-74	8.00	II	20.00	48.00	0.00	0.00
1921+35	URB	VERMILION	WESTBOUND	DRIVING	1	6.00	12.00	I-74	8.00	II	20.00	48.00	0.00	0.00
URBAN SUB-TOTAL									16.00		40.00	96.00	0.00	0.00
TOTAL									59.00		120.00	304.00	0.00	0.00
USE									59.00		120.00	304.00	0.00	0.00

SCHEDULE OF QUANTITIES

F.A.I. 74

CLASS B PATCHES, TYPE III, 14 INCH

(44201023)

STATION	RUR/ URB	STRUCTURE/ COUNTY	DIRECTION	LANE	PRIORITY	LENGTH	WIDTH	ROUTE	AREA SQ.YD	TYPE	DOWEL BARS, 1 1/2"	SAW CUTS	TIE BARS	PAVEMENT
											44201299	(44213200)	(44213204)	FABRIC
											EACH	FOOT	EACH	44213100
1941+17	URB	VERMILION	WESTBOUND	DRIVING	1	15.00	12.00	I-74	20.00	III	20.00	66.00	0.00	20.00
1941+71	URB	VERMILION	WESTBOUND	DRIVING	1	15.00	12.00	I-74	20.00	III	20.00	66.00	0.00	20.00
TOTAL USE									40.00		40.00	132.00	0.00	40.00

CLASS B PATCHES, TYPE IV, 14 INCH

(44201023)

STATION	RUR/ URB	STRUCTURE/ COUNTY	DIRECTION	LANE	PRIORITY	LENGTH	WIDTH	ROUTE	AREA SQ.YD	TYPE	DOWEL BARS, 1 1/2"	SAW CUTS	TIE BARS	PAVEMENT
											44201299	(44213200)	(44213204)	FABRIC
											EACH	FOOT	EACH	44213100
1916+89	URB	VERMILION	EASTBOUND	DRIVING		30.00	12.00	I-74	40.00	IV	30.00	96.00	15.00	40.00
1942+93	URB	VERMILION	WESTBOUND	DRIVING	1	20.00	12.00	I-74	26.67	IV	20.00	76.00	10.00	26.67
TOTAL USE									67.00		50.00	172.00	25.00	67.00

CLASS B PATCHES, TYPE II, 15 INCH

(44201031)

STATION	RUR/ URB	STRUCTURE/ COUNTY	DIRECTION	LANE	PRIORITY	LENGTH	WIDTH	ROUTE	AREA SQ.YD	TYPE	DOWEL BARS, 1 1/2"	SAW CUTS	TIE BARS	PAVEMENT
											(44201299)	(44213200)	(44213204)	FABRIC
											EACH	FOOT	EACH	44213100
914+05	RUR	CHAMP.	WESTBOUND	PASSING	1	6.00	12.00	I-74	8.00	II	20.00	48.00	0.00	0.00
914+05	RUR	CHAMP.	WESTBOUND	DRIVING	1	10.00	12.00	I-74	13.33	II	20.00	56.00	0.00	0.00
RURAL SUB-TOTAL									22.00		40.00	104.00	0.00	0.00
498+50	RUR	CHAMP	NORTHBOUND	PASSING	1	6.00	12.00	I-57	8.00	II	20.00	48.00	0.00	0.00
498+50	RUR	CHAMP	NORTHBOUND	DRIVING	1	6.00	12.00	I-57	8.00	II	20.00	48.00	0.00	0.00
531+26	RUR	CHAMP	NORTHBOUND	PASSING	1	6.00	12.00	I-57	8.00	II	20.00	48.00	0.00	0.00
531+26	RUR	CHAMP	NORTHBOUND	DRIVING	1	6.00	12.00	I-57	8.00	II	20.00	48.00	0.00	0.00
RURAL SUB-TOTAL									32.00		160.00	192.00	0.00	0.00
403+97	URB	CHAMP	NORTHBOUND	DRIVING	1	10.00	12.00	I-57	13.33	II	20.00	56.00	0.00	0.00
429+00	URB	CHAMP	SOUTHBOUND	DRIVING	1	10.00	12.00	I-57	13.33	II	20.00	56.00	0.00	0.00
426+04	URB	CHAMP	SOUTHBOUND	DRIVING	1	6.00	12.00	I-57	8.00	II	20.00	48.00	0.00	0.00
417+06	URB	CHAMP	SOUTHBOUND	DRIVING	1	10.00	12.00	I-57	13.33	II	20.00	56.00	0.00	0.00
URBAN SUB-TOTAL									48.00		80.00	216.00	0.00	0.00
519+61	RUR	EQ. STA.	SOUTHBOUND	PASSING	1	6.00	12.00	I-57	8.00	II	20.00	48.00	0.00	0.00
496+98	RUR	CHAMP	SOUTHBOUND	DRIVING	1	6.00	12.00	I-57	8.00	II	20.00	48.00	0.00	0.00
474+78	RUR	CHAMP	SOUTHBOUND	DRIVING	1	6.00	12.00	I-57	8.00	II	20.00	48.00	0.00	0.00
RURAL SUB-TOTAL									24.00		60.00	144.00	0.00	0.00
TOTAL USE									104.00		300.00	656.00	0.00	0.00

SCHEDULE OF QUANTITIES

F.A.I. 57/74

CLASS B PATCHES, TYPE III, 15 INCH (44201035)

STATION	RUR/ URB	STRUCTURE/ COUNTY	DIRECTION	LANE	PRIORITY	LENGTH	WIDTH	ROUTE	AREA SQ.YD	TYPE	DOWEL BARS, 1 1/2" 44201299	SAW CUTS (44213200)	TIE BARS 3/4" (44213204)	PAVEMENT FABRIC 44213100
											EACH	FOOT	EACH	SQ. YD
402+81	URB	CHAMP	SOUTHBOUND	DRIVING	1	15.00	12.00	I-57	20.00	III	20.00	66.00	0.00	20.00
TOTAL USE									20.00 20.00		20.00 20.00	66.00 66.00	0.00 0.00	20.00 20.00

CLASS B PATCHES, TYPE IV, 15 INCH (44201037)

STATION	RUR/ URB	STRUCTURE/ COUNTY	DIRECTION	LANE	PRIORITY	LENGTH	WIDTH	ROUTE	AREA SQ.YD	TYPE	DOWEL BARS, 1 1/2" 44201299	SAW CUTS (44213200)	TIE BARS 3/4" (44213204)	PAVEMENT FABRIC 44213100
											EACH	FOOT	EACH	SQ. YD
401+33	URB	CHAMP	NORTHBOUND	DRIVING	1	20.00	12.00	I-57	26.67	IV	20.00	76.00	10.00	26.67
403+15	URB	CHAMP	SOUTHBOUND	PASSING	1	25.00	12.00	I-57	33.33	IV	30.00	86.00	13.00	33.33
TOTAL USE									60.00 60.00		50.00 50.00	162.00 162.00	23.00 23.00	60.00 60.00

CLASS B PATCHES, TYPE II, 17 INCH (44201055)

STATION	RUR/ URB	STRUCTURE/ COUNTY	DIRECTION	LANE	PRIORITY	LENGTH	WIDTH	ROUTE	AREA SQ.YD	TYPE	DOWEL BARS, 1 1/2" 44201299	SAW CUTS (44213200)	TIE BARS 3/4" (44213204)	PAVEMENT FABRIC 44213100
											EACH	FOOT	EACH	SQ. YD
860+69	RUR	CHAMP.	WESTBOUND	PASSING	1	6.00	12.00	I-74	8.00	II	20.00	48.00	0.00	0.00
860+69	RUR	CHAMP.	WESTBOUND	DRIVING	1	6.00	12.00	I-74	8.00	II	20.00	48.00	0.00	0.00
RURAL SUB-TOTAL									16.00		40.00	96.00	0.00	0.00
839+05	URB	CHAMP.	WESTBOUND	PASSING	1	6.00	12.00	I-74	8.00	II	20.00	48.00	0.00	0.00
833+13	URB	CHAMP.	WESTBOUND	PASSING	1	6.00	12.00	I-74	8.00	II	20.00	48.00	0.00	0.00
761+78	URB	CHAMP.	WESTBOUND	DRIVING	1	6.00	12.00	I-74	8.00	II	20.00	48.00	0.00	0.00
URBAN SUB-TOTAL									24.00		60.00	144.00	0.00	0.00
702+03	RUR	CHAMP.	WESTBOUND	PASSING	1	6.00	12.00	I-74	8.00	II	20.00	48.00	0.00	0.00
700+00	RUR	CHAMP.	WESTBOUND	PASSING	1	6.00	12.00	I-74	8.00	II	20.00	48.00	0.00	0.00
693+00	RUR	CHAMP.	WESTBOUND	PASSING	1	6.00	12.00	I-74	8.00	II	20.00	48.00	0.00	0.00
RURAL SUB-TOTAL									24.00		60.00	144.00	0.00	0.00

SCHEDULE OF QUANTITIES

F.A.I. 74

CLASS B PATCHES, TYPE II, 17 INCH(cont.)

(44201055)

STATION	RUR/URB	STRUCTURE/COUNTY	DIRECTION	LANE	PRIORITY	LENGTH	WIDTH	ROUTE	AREA SQ.YD	TYPE	DOWEL BARS, 1 1/2" 44201299 EACH	SAW CUTS (44213200) FOOT	TIE BARS 3/4" (44213204) EACH	PAVEMENT FABRIC 44213100 SQ. YD
483+06	URB	CHAMP.	WESTBOUND	DRIVING	1	6.00	12.00	I-74	8.00	II	20.00	48.00	0.00	0.00
443+16	URB	CHAMP.	WESTBOUND	PASSING	1	6.00	12.00	I-74	8.00	II	20.00	48.00	0.00	0.00
430+13	URB	CHAMP.	WESTBOUND	PASSING	1	6.00	12.00	I-74	8.00	II	20.00	48.00	0.00	0.00
URBAN SUB-TOTAL									24.00		60.00	144.00	0.00	0.00
1824+14	RUR	VERMILION	EASTBOUND	DRIVING	1	6.00	12.00	I-74	8.00	II	20.00	48.00	0.00	0.00
1829+75	RUR	VERMILION	EASTBOUND	PASSING	1	6.00	12.00	I-74	8.00	II	20.00	48.00	0.00	0.00
1836+98	RUR	VERMILION	EASTBOUND	PASSING	1	6.00	12.00	I-74	8.00	II	20.00	48.00	0.00	0.00
RURAL SUB-TOTAL									24.00		60.00	144.00	0.00	0.00
1886+29	URB	VERMILION	EASTBOUND	DRIVING	1	10.00	12.00	I-74	13.33	II	20.00	56.00	0.00	0.00
1888+27	URB	VERMILION	EASTBOUND	DRIVING	1	10.00	12.00	I-74	13.33	II	20.00	56.00	0.00	0.00
1889+61	URB	VERMILION	EASTBOUND	DRIVING	1	8.00	12.00	I-74	10.67	II	20.00	52.00	0.00	0.00
1896+07	URB	VERMILION	EASTBOUND	DRIVING	1	8.00	12.00	I-74	10.67	II	20.00	52.00	0.00	0.00
URBAN SUB-TOTAL									48.00		80.00	216.00	0.00	0.00
TOTAL									160.00		360.00	888.00	0.00	0.00
USE									160.00		360.00	888.00	0.00	0.00

CLASS B PATCHES, TYPE III, 17 INCH

(44201057)

STATION	RUR/URB	STRUCTURE/COUNTY	DIRECTION	LANE	PRIORITY	LENGTH	WIDTH	ROUTE	AREA SQ.YD	TYPE	DOWEL BARS, 1 1/2" 44201299 EACH	SAW CUTS (44213200) FOOT	TIE BARS 3/4" (44213204) EACH	PAVEMENT FABRIC 44213100 SQ. YD
737+99	URB	CHAMP.	WESTBOUND	DRIVING	1	15.00	12.00	I-74	20.00	III	20.00	66.00	0.00	20.00
URBAN SUB-TOTAL									20.00		20.00	66.00	0.00	20.00
691+34	RUR	CHAMP.	WESTBOUND	DRIVING	1	12.00	12.00	I-74	16.00	III	20.00	60.00	0.00	16.00
RURAL SUB-TOTAL									16.00		20.00	60.00	0.00	16.00
1831+99	RUR	VERMILION	EASTBOUND	DRIVING	1	12.00	12.00	I-74	16.00	III	20.00	60.00	0.00	16.00
RURAL SUB-TOTAL									16.00		20.00	60.00	0.00	16.00
1884+08	URB	VERMILION	WESTBOUND	DRIVING	1	15.00	12.00	I-74	20.00	III	20.00	66.00	0.00	20.00
URBAN SUB-TOTAL									20.00		20.00	66.00	0.00	20.00
TOTAL									72.00		80.00	252.00	0.00	72.00
USE									72.00		80.00	252.00	0.00	72.00

CLASS B PATCHES, TYPE IV, 17 INCH

(44201053)

STATION	RUR/URB	STRUCTURE/COUNTY	DIRECTION	LANE	PRIORITY	LENGTH	WIDTH	ROUTE	AREA SQ.YD	TYPE	DOWEL BARS, 1 1/2" 44201299 EACH	SAW CUTS (44213200) FOOT	TIE BARS 3/4" (44213204) EACH	PAVEMENT FABRIC 44213100 SQ. YD
691+75	RUR	CHAMP.	WESTBOUND	DRIVING	1	40.00	12.00	I-74	53.33	IV	30.00	116.00	20.00	53.33
RURAL SUB-TOTAL									54.00		30.00	116.00	20.00	54.00
1900+05	URB	VERMILION	EASTBOUND	DRIVING	1	20.00	12.00	I-74	26.67	IV	20.00	76.00	10.00	26.67
2035+08	URB	VERMILION	EASTBOUND	DRIVING	1	20.00	12.00	I-74	26.67	IV	20.00	76.00	10.00	26.67
URBAN SUB-TOTAL									54.00		40.00	152.00	20.00	54.00
TOTAL									108.00		70.00	268.00	40.00	108.00
USE									108.00		70.00	268.00	40.00	108.00

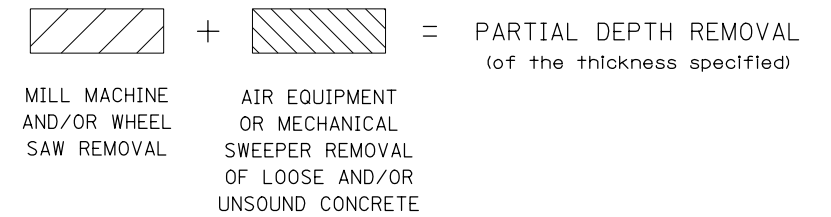
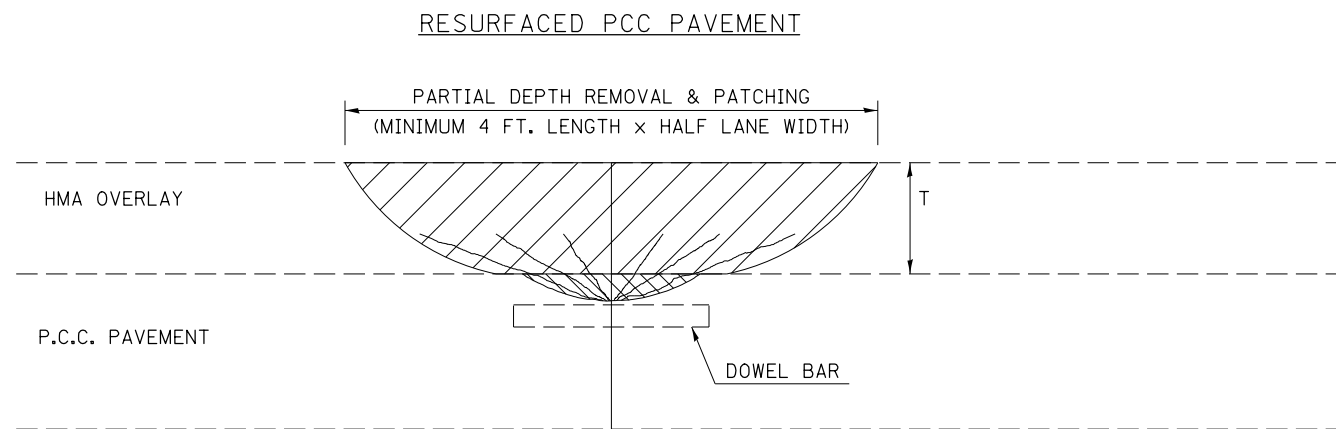

GENERAL NOTES

ALL VOLUME OF PARTIAL DEPTH REMOVAL SHALL BE REPLACED WITH HOT-MIX ASPHALT (HMA) AND PAID FOR AT THE CONTRACT UNIT PRICE PER TON FOR PARTIAL DEPTH PATCHING.

T = THICKNESS OF HMA OVERLAY(S). SEE EXISTING TYPICAL CROSS SECTION.

GENERAL NOTE 406H SHALL INCLUDE MIXTURE REQUIREMENTS FOR PARTIAL DEPTH PATCHING.

HMA REPLACEMENT IN RESURFACED PCC PAVEMENT LOCATIONS SHALL BE ACCORDING TO SECTION 406 OF THE STANDARD SPECIFICATIONS.

DEPTH OF PARTIAL DEPTH REMOVAL DOES NOT EXTEND INTO EXISTING PCC PAVEMENT. WHERE PCC PAVEMENT IS ENCOUNTERED BETWEEN MIN. AND MAX. DEPTHS, THE MILL WILL BE HELD TO A DEPTH WHICH JUST ROUGHENS THE SURFACE OF THE EXISTING PCC.

WHERE REINFORCING STEEL IS ACCIDENTALLY EXPOSED, IT SHALL BE REMOVED IN ACCORDANCE WITH CHECKSHEET #15

TRANSVERSE CONTRACTION JOINT SHOWN - OTHER LOCATIONS SIMILAR.

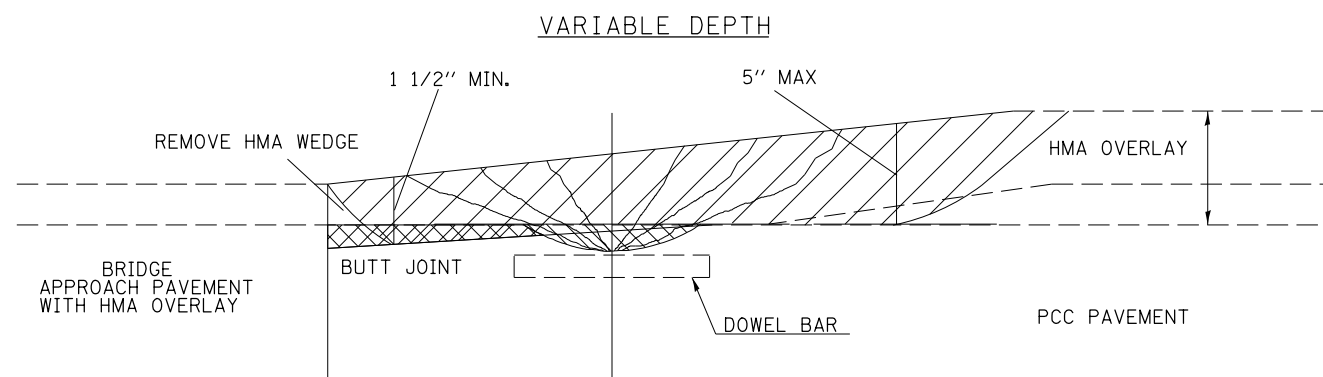

Note: All dimensions are in INCHES (millimeters) unless otherwise shown.

FILE NAME =	USER NAME = leroyme	DESIGNED -	REVISED - 11/06	STATE OF ILLINOIS DEPARTMENT OF TRANSPORTATION	PCC PARTIAL DEPTH HOT-MIX ASPHALT PATCHING	F.A. RTE.	SECTION	COUNTY	TOTAL SHEETS	SHEET NO.	
		DRAWN -	REVISED - 10/10								
		CHECKED -	REVISED -								
		DATE -	REVISED -								
						CONTRACT NO. 70A38					
						SCALE: SHEET NO. OF SHEETS STA. TO STA.		FED. ROAD DIST. NO. ILLINOIS FED. AID PROJECT			