

NORTH CURB LINE

Location	Station	Offset	Theoretical Grade Elevations
West end of W. Appr. Slab	35+36.63	-17.63	398.78
A	35+46.69	-17.79	398.79
B	35+56.75	-17.91	398.80
East end of W. Appr. Slab	35+66.81	-18.00	398.82

NORTH EDGE OF ROADWAY

Location	Station	Offset	Theoretical Grade Elevations
West end of W. Appr. Slab	35+33.49	-12.00	399.01
A	35+43.44	-12.00	399.02
B	35+53.40	-12.00	399.02
East end of W. Appr. Slab	35+63.39	-12.00	399.03

☉ ROADWAY & PROFILE GRADE

Location	Station	Offset	Theoretical Grade Elevations
West end of W. Appr. Slab	35+26.86	0.00	399.54
A	35+36.76	0.00	399.51
B	35+46.67	0.00	399.49
East end of W. Appr. Slab	35+56.60	0.00	399.47

SOUTH EDGE OF ROADWAY

Location	Station	Offset	Theoretical Grade Elevations
West end of W. Appr. Slab	35+20.29	12.00	400.08
A	35+30.13	12.00	400.05
B	35+39.99	12.00	400.00
East end of W. Appr. Slab	35+49.87	12.00	399.95

SOUTH CURB LINE

Location	Station	Offset	Theoretical Grade Elevations
West end of W. Appr. Slab	35+16.60	18.79	400.39
A	35+26.53	18.57	400.36
B	35+36.47	18.38	400.28
East end of W. Appr. Slab	35+46.41	18.22	400.21

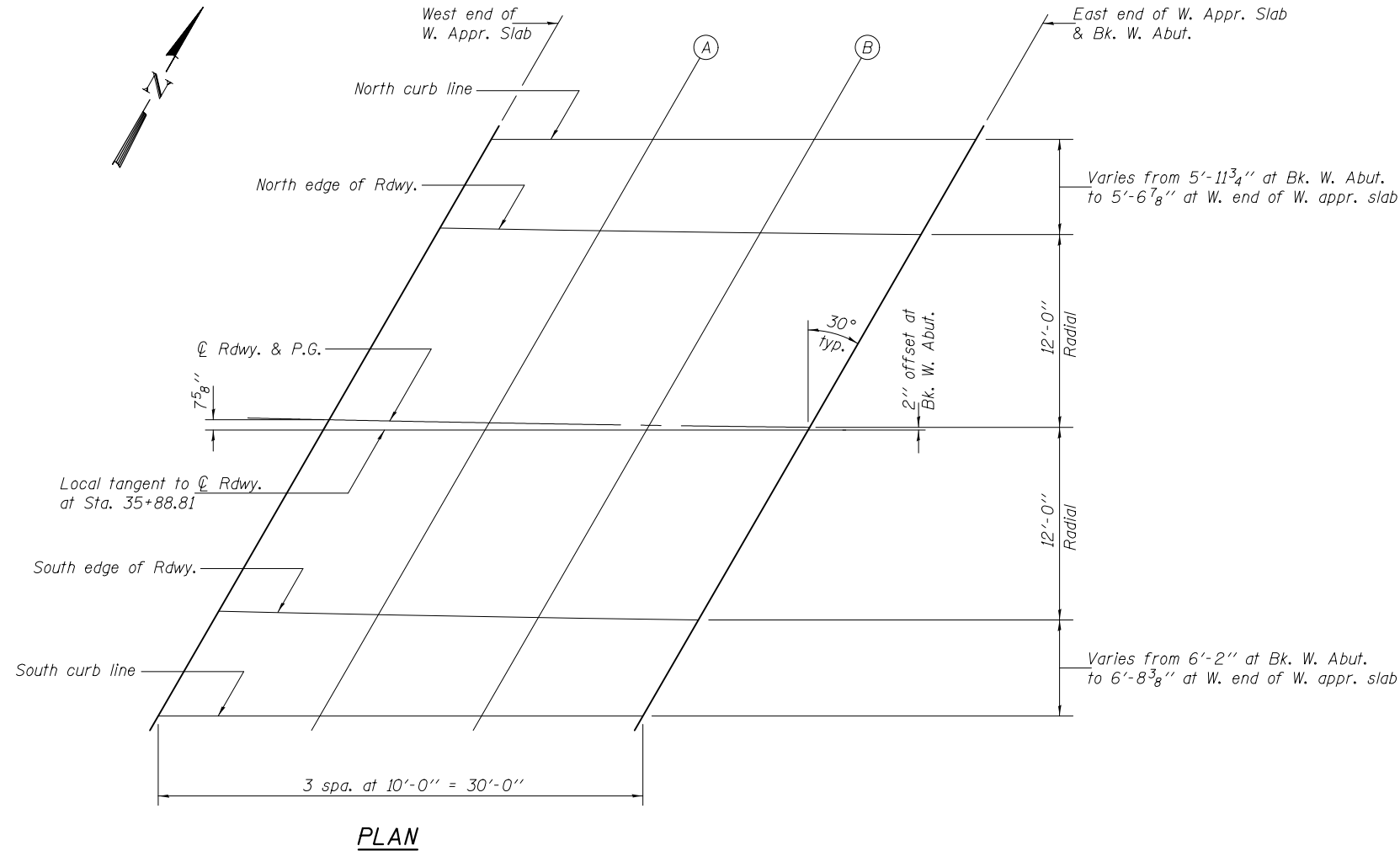

DESIGNED - Curt M. Evoy	EXAMINED - <i>Joanne F. [Signature]</i>	DATE - JANUARY 24, 2014
CHECKED - Phillip Coppernoll	PASSED - <i>Carl [Signature]</i>	REVISED
DRAWN - h.t. duong	ACTING ENGINEER OF BRIDGES AND STRUCTURES	REVISED
CHECKED - FT/GRA		

**STATE OF ILLINOIS
DEPARTMENT OF TRANSPORTATION**

**TOP WEST APPROACH SLAB ELEVATIONS
STRUCTURE NO. 100-0080**

SHEET NO. 5 OF 18 SHEETS

F.A.U. RTE. 9588	SECTION 39B-1	COUNTY WILLIAMSON	TOTAL SHEETS 224	SHEET NO. 80
			CONTRACT NO. 78277	
ILLINOIS FED. AID PROJECT				