

TOP PLAN

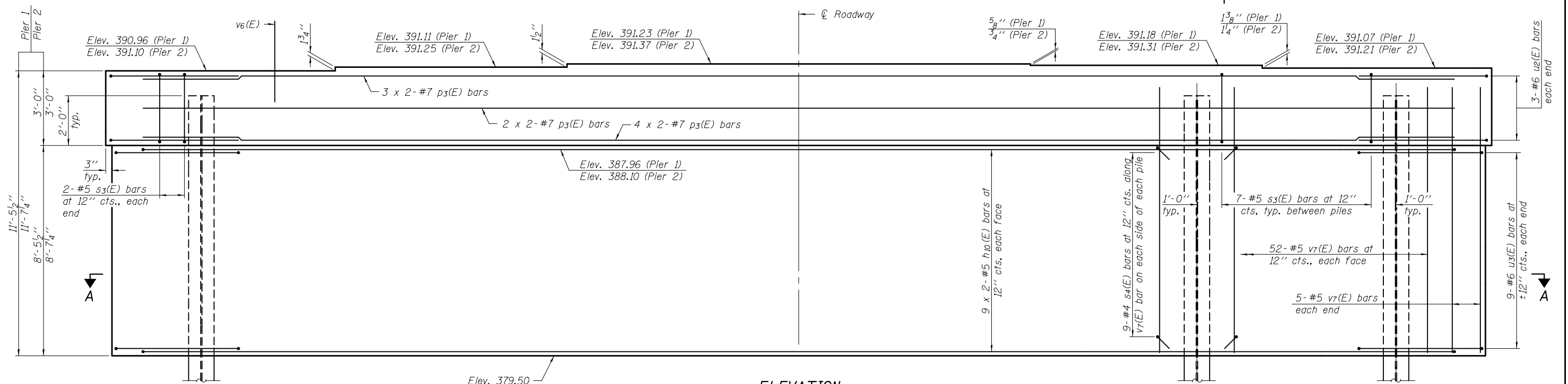

ELEVATION
(Looking East)

Notes:
 Bars indicated thus 4 x 2-#7 etc. indicates
 4 lines of bars with 2 lengths per line.
 See sheet 23 of 26 for Sections A-A and B-B.

MINIMUM BAR LAP

- #5 bar = 2'-10"
- #6 bar = 3'-4"
- #7 bar = 4'-6"

DESIGNED - MARK D. SHAFFER	EXAMINED - <i>James F. Schaff</i> ACTING ENGINEER OF BRIDGE DESIGN	DATE - JANUARY 24, 2014	STATE OF ILLINOIS DEPARTMENT OF TRANSPORTATION	PIERS STRUCTURE NO. 100 - 0081	F.A.U. RTE. 9588	SECTION 39B-2	COUNTY WILLIAMSON	TOTAL SHEETS 224	SHEET NO. 115
CHECKED - STEPHEN M. RYAN	PASSED - <i>Carl Perry</i> ACTING ENGINEER OF BRIDGES AND STRUCTURES	REVISED			CONTRACT NO. 78277				
DRAWN - MICHAEL B. MOSSMAN		REVISED			ILLINOIS FED. AID PROJECT				
CHECKED - F.T. / G.R.A.					SHEET NO. 22 OF 26 SHEETS				