

ITEM NO. 06A

IDOT LETTING: MARCH 3, 2017

MV061
TOTAL SHEETS = 14

CONSTRUCTION PLANS

MAINTENANCE AND REMARKING OF RUNWAY 5-23

**MT. VERNON AIRPORT AUTHORITY
MT. VERNON OUTLAND AIRPORT (MVN)
MT. VERNON, JEFFERSON COUNTY, ILLINOIS**

**SBG PROJECT NO. 3-17-SBGP-120/133
IDA PROJECT NO. MVN-4512**

JANUARY 6, 2017

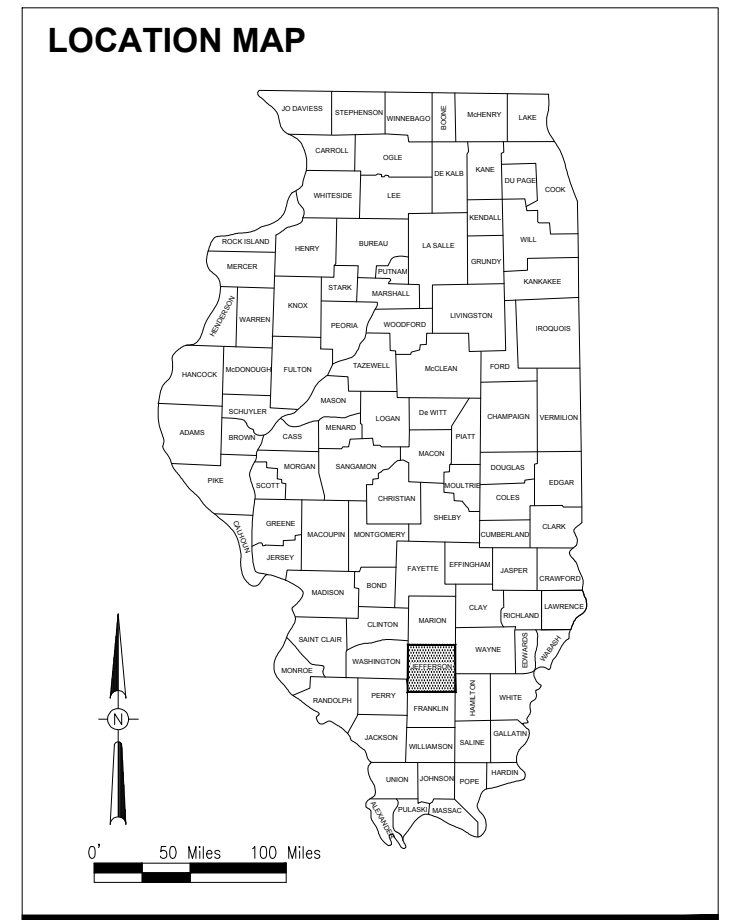

NOTICE TO CONTRACTORS AND BIDDERS

THESE CONSTRUCTION PLANS RELY UPON THE SPECIAL PROVISIONS AND THE SPECIFICATIONS TO PROVIDE FOR A COMPLETE DESCRIPTION OF THE WORK AND CONSTRUCTION REQUIREMENTS. THE PLANS SHALL ONLY BE USED IN COMBINATION WITH ALL CONTRACT DOCUMENTS.

No.	Issue/Description	Sheets Changed	Date	By

Barry S. Stolz

 Barry Stolz, P.E.
 Project Engineer

EXP 11/30/17
 1/5/17
 Date

HANSON
 HANSON PROFESSIONAL SERVICES INC.
 1525 S. 6th Street
 Springfield, IL 62703
 phone: 217-788-2450
 fax: 217-788-2503

Robert A. Waller

 Robert A. Waller, P.E.
 Project Manager

1/4/2017
Date

Mt. Vernon Airport
 MOUNT VERNON AIRPORT AUTHORITY
 100 Aviation Drive
 Mt. Vernon, IL 62864
 Telephone: 618.242.7016

Chris Collins

 Chris Collins
 Airport Manager

1/5/2017
Date

JAN 05 2017 5:01 PM STOLZ01547
 I:\15\JOBS\15A0063\15A0063\CAD\AIRPORT\15A0063\001-CVR.DWG

MT. VERNON AIRPORT



100 AVIATION DRIVE
MT VERNON, IL 62864



MAINTENANCE AND
REMARKING OF
RUNWAY 5/23

IDA No: MVN-4512

Contract No. MV061

NO.	DATE	DESCRIPTION		
		DES	DWN	REV

ISSUE: JANUARY 6, 2017
PROJECT NO: 15A0063
CAD FILE: G-002-FLP.DWG
DESIGN BY: CWS 11/21/2016
DRAWN BY: CWS 11/21/2016
REVIEWED BY: LDH 12/14/2016

SHEET TITLE

SUMMARY OF
QUANTITIES AND
INDEX TO SHEETS

SUMMARY OF QUANTITIES - BASE BID

ITEM NO.	DESCRIPTION	UNIT	TOTAL QUANTITIES	AS BUILT QUANTITIES
AR150520	MOBILIZATION	L.S.	1	
AR201661	CLEAN & SEAL BITUMINOUS CRACKS	L.F.	72,000	
AR620520	PAVEMENT MARKING - WATERBORNE	S.F.	106,255	
AR620525	PAVEMENT MARKING - BLACK BORDER	S.F.	28,413	
AR620900	PAVEMENT MARKING REMOVAL	S.F.	4,060	

SUMMARY OF QUANTITIES - ADDITIVE ALTERNATE BIDS

ITEM NO.	DESCRIPTION	UNIT	TOTAL QUANTITIES	AS BUILT QUANTITIES
	ADDITIVE ALTERNATE NO. 1			
AS201661	CLEAN & SEAL BITUMINOUS CRACKS	L.F.	5,000	
	ADDITIVE ALTERNATE NO. 2			
AT201661	CLEAN & SEAL BITUMINOUS CRACKS	L.F.	5,000	

GENERAL NOTES:

QUANTITIES

PAYMENT WILL BE MADE UNDER THE ITEM NUMBERS, DESCRIPTIONS AND UNITS NOTED IN THE ABOVE TABLE IN ACCORDANCE WITH THE BASIS OF PAYMENT FOR EACH RESPECTIVE WORK ITEM COMPLETED AND ACCEPTED BY THE ENGINEER.

CERTIFIED PAYROLLS

THE RESIDENT ENGINEER **CANNOT** FORWARD CONSTRUCTION REPORTS TO THE ILLINOIS DIVISION OF AERONAUTICS FOR PROCESSING UNTIL ALL **CERTIFIED PAYROLLS** FOR THE PERIOD HAVE BEEN RECEIVED.

MATERIAL CERTIFICATIONS

MATERIALS TO BE INCORPORATED INTO THE PROJECT CANNOT BE USED WITHOUT PRIOR APPROVAL. ALL MATERIALS TO BE USED IN THE PROJECT MUST BE SUBMITTED TO THE RESIDENT ENGINEER FOR APPROVAL. USE OF MATERIALS WITHOUT PRIOR APPROVAL AND ULTIMATELY DETERMINED TO BE UNACCEPTABLE BY THE ILLINOIS DIVISION OF AERONAUTICS ARE SUBJECT TO REMOVAL AND/OR NON-PAYMENT.

INDEX TO SHEETS

SHEET NO.	DESCRIPTION
1	COVER SHEET
2	SUMMARY OF QUANTITIES AND INDEX TO SHEETS
3	SCOPE OF WORK PLAN
4	PROPOSED SAFETY PLAN WORK AREA 1
5	PROPOSED SAFETY PLAN WORK AREA 2
6	PROPOSED SAFETY PLAN WORK AREA 3
7	CONSTRUCTION SAFETY PLAN NOTES AND DETAILS
8	PROPOSED CRACK SEAL PLAN - STA 5+00 - 19+00
9	PROPOSED CRACK SEAL PLAN - STA 19+00 - 43+00
10	PROPOSED CRACK SEAL PLAN - STA 43+00 - 70+00
11	PROPOSED MARKING PLAN - STA 5+00 - 19+00
12	PROPOSED MARKING PLAN - STA 19+00 - 43+00
13	PROPOSED MARKING PLAN - STA 43+00 - 70+00
14	PROPOSED MARKING DETAILS



**MAINTENANCE AND
REMARKING OF
RUNWAY 5/23**

IDA No: MVN-4512

Contract No. MV061

NO.	DATE	DESCRIPTION		
		DES	DWN	REV

ISSUE: JANUARY 6, 2017

PROJECT NO: 15A0063

CAD FILE: G-003-SOW.DWG

DESIGN BY: CWS 10/14/2016

DRAWN BY: CWS 10/14/2016

REVIEWED BY: LDH 12/14/2016

SHEET TITLE

**SCOPE OF WORK
PLAN**

GENERAL NOTES

1. THE SCOPE OF WORK SHEET IS INTENDED ONLY AS A GENERAL DESCRIPTION OF WORK ITEMS AND THEIR APPROXIMATE LOCATIONS AND LIMITS, FOR THE PURPOSE OF UNDERSTANDING THE SCOPE OF THE PROJECT. THIS SHEET SHALL NOT BE USED AS A CONSTRUCTION PLAN. REFER TO THE FOLLOWING PLAN SHEETS FOR DETAILED CONSTRUCTION REQUIREMENTS, LOCATIONS, AND ITEMS OF WORK.
2. THIS WORK FOR THIS PROJECT SHALL CONSIST OF SEALING BITUMINOUS CRACKS IN RUNWAY 5-23, AND MARKING RUNWAY 5-23 AND CONNECTING TAXIWAYS.
3. THE CONTRACTOR SHALL FURNISH ALL LABOR, MATERIAL, EQUIPMENT, AND TRANSPORTATION NECESSARY TO CONSTRUCT ALL ELEMENTS OF THE PROJECT AS DESCRIBED IN THE CONSTRUCTION PLANS AND SPECIFICATIONS.
4. THE RULES, REGULATIONS, AND SPECIFICATIONS ENUMERATED HEREIN SHALL BE CONSIDERED AS MINIMUM REQUIREMENTS. THEY SHALL NOT PROHIBIT THE CONTRACTOR FROM FURNISHING AND INSTALLING HIGHER GRADES OF MATERIAL THAN ARE SPECIFIED HEREIN.
5. IT SHALL BE THE RESPONSIBILITY OF THE CONTRACTOR TO PROTECT, PRESERVE AND REPAIR THE EXISTING AIRFIELD AND ROADWAY PAVEMENTS AT ALL TIMES. THE CONTRACTOR SHALL REPAIR ANY DAMAGE TO EXISTING ELECTRICAL, DRAINAGE, AND PAVEMENT STRUCTURES AT NO ADDITIONAL COST TO THE CONTRACT.
6. NO EQUIPMENT SHALL BE PERMITTED TO CROSS OR USE ANY EXISTING PAVEMENT OUTSIDE THE CONSTRUCTION LIMITS, GENERAL PROJECT AREA OR HAUL ROUTE.
7. CONTRACTOR IS REQUIRED TO PROVIDE THEIR OWN RESTROOM FACILITIES.
8. UNLESS OTHERWISE NOTED, ALL DISTURBED AREAS OUTSIDE OF THE PROPOSED CONSTRUCTION LIMITS SHALL BE GRADED, SEEDED AND/OR HYDROMULCH SEEDED IN ACCORDANCE WITH ITEM 901 AND 908 AT NO ADDITIONAL COST TO THE CONTRACT.
9. ALL WASTE MATERIAL SHALL BE HAULED FROM THE AIRPORT AND PROPERLY DISPOSED OF UNLESS OTHERWISE SPECIFIED HEREIN.
10. THE CONTRACTOR SHALL BE RESPONSIBLE FOR OBTAINING PERMITS FOR HAULING ON PUBLIC ROADS, AS APPLICABLE. THE CONTRACTOR SHALL BE RESPONSIBLE FOR CORRECTING ANY DAMAGES TO ANY PAVEMENTS (PUBLIC OR PRIVATE) CAUSED BY HIS/HER CONSTRUCTION EQUIPMENT OR PERSONNEL.
11. THE OWNER SHALL HAVE THE RIGHT OF FIRST REFUSAL FOR ALL SALVAGEABLE MATERIAL REMOVED ON THE PROJECT.
12. THE CONTRACTOR SHALL COORDINATE WITH THE RESIDENT ENGINEER / TECHNICIAN SO THEY MAY DEVELOP ONE SET OF REDLINED AS-BUILT RECORD DRAWINGS AT THE COMPLETION OF THE PROJECT.
13. THE CONSTRUCTION LIMITS SHALL BE RESTRICTED TO AREAS THAT ARE ABSOLUTELY NECESSARY TO DISTURB TO COMPLETE THE REQUIRED WORK ITEMS. LIMITS SHALL BE COORDINATED WITH THE RESIDENT ENGINEER PRIOR TO BEGINNING ANY WORK.
14. CONTRACTOR SHALL RESTORE TO ORIGINAL CONDITION ALL GRASS, STONE, OR PAVEMENT DISTURBED BY CONTRACTOR'S CONSTRUCTION OPERATIONS, STAGING, AND CONSTRUCTION ACCESS ROUTES. DISTURBED AREAS TO BE REPAIRED, GRADED, AND MULCHED SEEDED IN ACCORDANCE WITH ITEMS 901 AND 908, UNLESS OTHERWISE NOTED. STAGING AREA AND SITE ACCESS RESTORATION SHALL BE INCLUDED IN THE COST OF MOBILIZATION.
15. THE PROJECT PAY ITEMS ARE INTENDED TO BE INCLUSIVE OF ALL WORK TO BE PERFORMED AS SHOWN IN THESE PLANS. ALL INCIDENTAL WORK REQUIRED TO COMPLETE THE PROJECT TO THE SATISFACTION OF THE RESIDENT ENGINEER IS TO BE INCLUDED IN THE COSTS OF PERFORMING THESE ITEMS.
16. ANY UTILITIES DAMAGED DURING CONSTRUCTION SHALL BE REPAIRED AT THE CONTRACTOR'S EXPENSE. CONTRACTOR SHALL COORDINATE WITH THE PROPER PERSONS FOR THE PURPOSE OF LOCATING AND PROTECTING EXISTING UNDERGROUND UTILITIES.
17. THE CONTRACTOR MUST AT ALL TIMES MAINTAIN PROPER DRAINAGE FOR ALL AREAS AFFECTED BY HIS WORK.

AIRPORT EVENT NOTE

1. THE CONTRACTOR SHALL BE AWARE THAT A MAJOR AIRPORT EVENT WILL TAKE PLACE DURING THE WEEKEND OF JULY 22, 2017, DURING WHICH TIME ALL CONSTRUCTION ACTIVITY WILL BE SHUTDOWN TO ALLOW THE UNOBSTRUCTED FLOW OF AIRPORT TRAFFIC. ALL AIRFIELD PAVEMENTS ARE TO BE OPEN TO AIRCRAFT TRAFFIC DURING THIS PERIOD. ALL WORK AREAS MUST BE INTACT AND ALL PAVEMENTS USED BY THE CONTRACTOR SHALL BE LEFT BROOM CLEAN PRIOR TO THE SHUTDOWN PERIOD. THE EXACT TIMING OF THE SHUTDOWN PERIOD WILL BE DISCUSSED AT THE PRECONSTRUCTION CONFERENCE AND DURING CONSTRUCTION AS APPLICABLE. THE CONTRACT TIME WILL BE SUSPENDED FOR THE SHUTDOWN PERIOD.

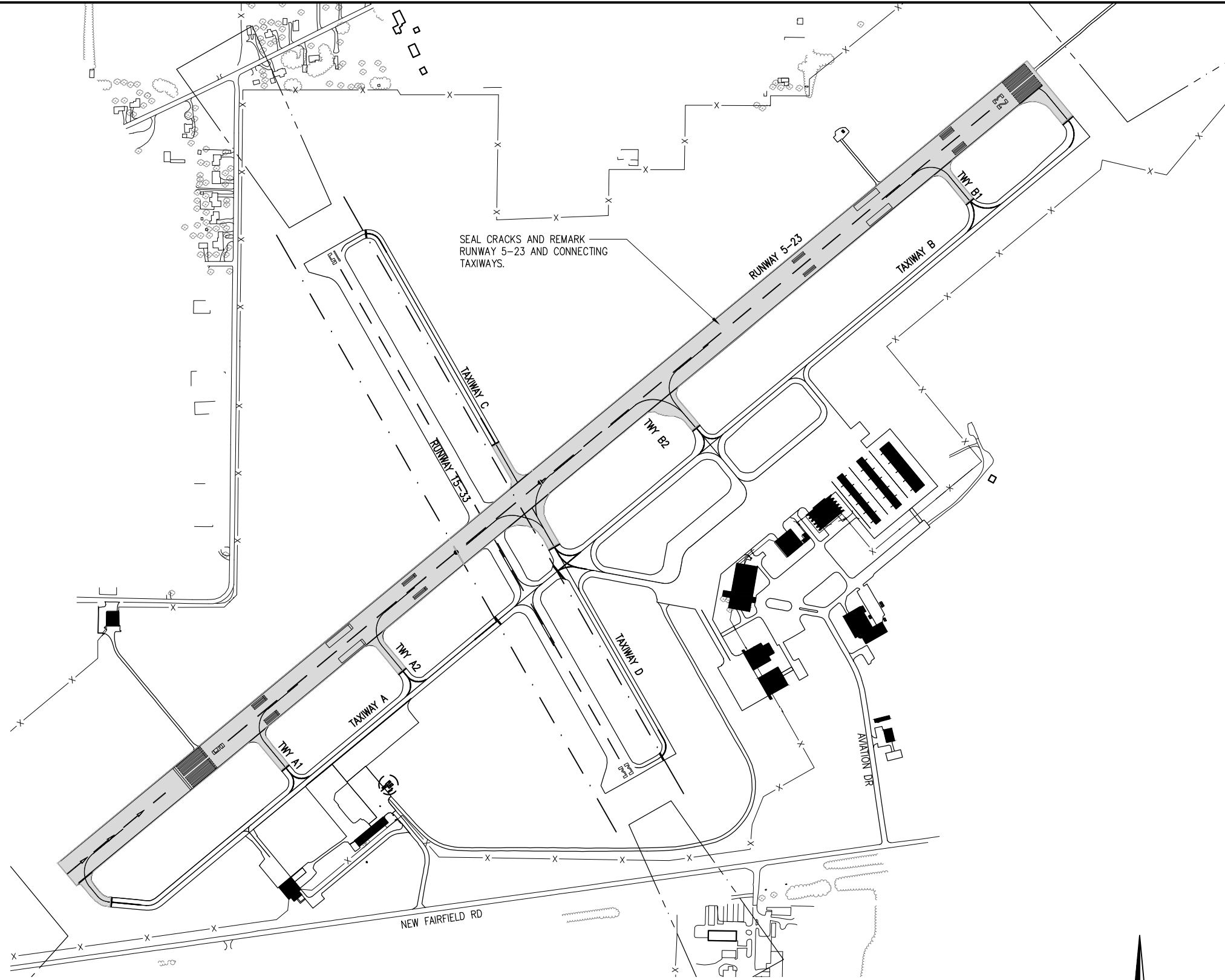

SEAL CRACKS AND REMARK
RUNWAY 5-23 AND CONNECTING
TAXIWAYS.

J.U.L.I.E. INFORMATION
COUNTY _____ JEFFERSON
CITY _____ MT. VERNON
TOWNSHIP _____ MT. VERNON
SECTION NO. _____ 22, 23, 26 & 27
ADDRESS _____ MT. VERNON AIRPORT AUTHORITY
R.R. #4
MT. VERNON, ILLINOIS 62864

LEGEND
[Line] EXISTING IMPROVEMENTS
[Shaded Area] PROPOSED IMPROVEMENTS
[Black Area] EXISTING BUILDINGS

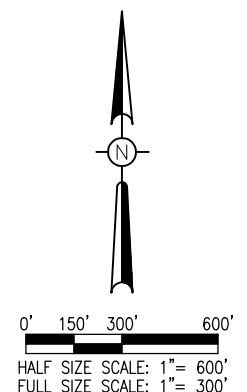



MAINTENANCE AND REMARKING OF RUNWAY 5/23

IDA No: MVN-4512

Contract No. MV061

NO.	DATE	DESCRIPTION		
		DES	DWN	REV
ISSUE: JANUARY 6, 2017				
PROJECT NO: 15A0063				
CAD FILE: G-004-SFY.DWG				
DESIGN BY: CWS 10/14/2016				
DRAWN BY: CWS 10/14/2016				
REVIEWED BY: LDH 12/14/2016				

SHEET TITLE

PROPOSED SAFETY PLAN WORK AREA 1

UTILITY NOTE

THE LOCATION, SIZE, AND TYPE OF MATERIAL OF EXISTING UNDERGROUND AND/OR ABOVEGROUND UTILITIES INDICATED ON THE PLANS ARE NOT REPRESENTED AS BEING ACCURATE, SUFFICIENT OR COMPLETE. NEITHER THE OWNER NOR THE ENGINEER ASSUMES ANY RESPONSIBILITY WHATSOEVER IN RESPECT TO THE ACCURACY, COMPLETENESS, OR SUFFICIENCY OF THE INFORMATION. THERE IS NO GUARANTEE, EITHER EXPRESSED OR IMPLIED, THAT THE LOCATIONS, SIZE AND TYPE OF MATERIAL OF EXISTING UNDERGROUND UTILITIES INDICATED ARE REPRESENTATIVE OF THOSE TO BE ENCOUNTERED IN THE CONSTRUCTION. IT SHALL BE THE CONTRACTOR'S RESPONSIBILITY TO DETERMINE THE ACTUAL LOCATION OF ALL SUCH FACILITIES, INCLUDING SERVICE CONNECTIONS TO UNDERGROUND UTILITIES. PRIOR TO CONSTRUCTION, THE CONTRACTOR SHALL NOTIFY THE UTILITY COMPANIES OF HIS OPERATIONAL PLANS AND SHALL OBTAIN FROM THE RESPECTIVE UTILITY COMPANIES DETAILED INFORMATION AND ASSISTANCE RELATIVE TO THE LOCATION OF THEIR FACILITIES AND THE WORKING SCHEDULE OF THE COMPANIES FOR REMOVAL OR ADJUSTMENT WHERE REQUIRED. IN THE EVENT AN UNEXPECTED UTILITY INTERFERENCE IS ENCOUNTERED DURING CONSTRUCTION, THE CONTRACTOR SHALL IMMEDIATELY NOTIFY THE UTILITY COMPANY OF JURISDICTION. THE OWNER'S REPRESENTATIVE AND/OR THE RESIDENT ENGINEER SHALL ALSO BE IMMEDIATELY NOTIFIED. ANY DAMAGE TO SUCH MAINS AND SERVICES SHALL BE RESTORED TO SERVICE AT ONCE AND PAID FOR BY THE CONTRACTOR AT NO ADDITIONAL COST TO THE CONTRACT. ALL UTILITY CABLES AND LINES SHALL BE LOCATED BY THE RESPECTIVE UTILITY. **CONTACT JULIE (JOINT UTILITY LOCATION INFORMATION FOR EXCAVATORS) FOR UTILITY INFORMATION, PHONE: 1-800-892-0123. ALSO CONTACT AIRPORT DIRECTOR/MANAGER AND AIRPORT PERSONNEL FOR ASSISTANCE IN LOCATING UNDERGROUND AIRPORT CABLES AND/OR UTILITIES. ALSO COORDINATE WORK WITH ALL ABOVEGROUND UTILITIES.**

WORK AREA NOTES

1. THE CONTRACTOR MAY NOT WORK IN MORE THAN ONE AREA AT A TIME.
2. CLOSURE CROSSES AND BARRICADES SHALL BE IN PLACE PRIOR TO BEGINNING CONSTRUCTION.
3. AT ALL TIMES, THE CONTRACTOR'S OPERATIONS SHALL BE SUCH AS TO MINIMIZE CLOSURES.
4. CONTRACTOR SHALL BE REQUIRED TO CONTROL VEHICLE TRAFFIC ON ACTIVE AIRFIELD PAVEMENTS. AIRCRAFT SHALL HAVE THE RIGHT-OF-WAY AT ALL TIMES. PAVEMENTS ARE TO BE KEPT FREE OF DEBRIS AT ALL TIMES.

SAFETY PLAN COMPLIANCE DOCUMENT

PRIOR TO THE ISSUANCE OF A CONSTRUCTION NOTICE-TO-PROCEED (NTP), THE CONTRACTOR SHALL BE RESPONSIBLE FOR PREPARING AND SUBMITTING A SAFETY PLAN COMPLIANCE DOCUMENT IN ACCORDANCE WITH FAA ADVISORY CIRCULAR 150/5370-2F, PARAGRAPH 204B, OR EQUIVALENT SECTION IN SUBSEQUENT/CURRENT ISSUE. THE AIRPORT DIRECTOR SHALL APPROVE THIS DOCUMENT AND SUBMIT TO THE DIVISION OF AERONAUTICS FOR APPROVAL PRIOR TO THE NTP ISSUANCE.

LEGEND

- EXISTING IMPROVEMENTS
- PROPOSED IMPROVEMENTS
- EXISTING BUILDINGS
- PROPOSED EQUIPMENT PARKING AREA
- PROPOSED BARRICADES OR TRAFFIC CONES
- PROPOSED HAUL ROUTE.

J.U.L.I.E. INFORMATION

COUNTY: JEFFERSON
CITY: MT. VERNON
TOWNSHIP: MT. VERNON
SECTION NO.: 22, 23, 26 & 27
ADDRESS: MT. VERNON AIRPORT AUTHORITY
R.R. #4
MT. VERNON, ILLINOIS 62864

ALTERNATE LOCATION FOR RUNWAY CLOSURE CROSS, ONLY WHEN WORKING OVER RUNWAY NUMERALS.

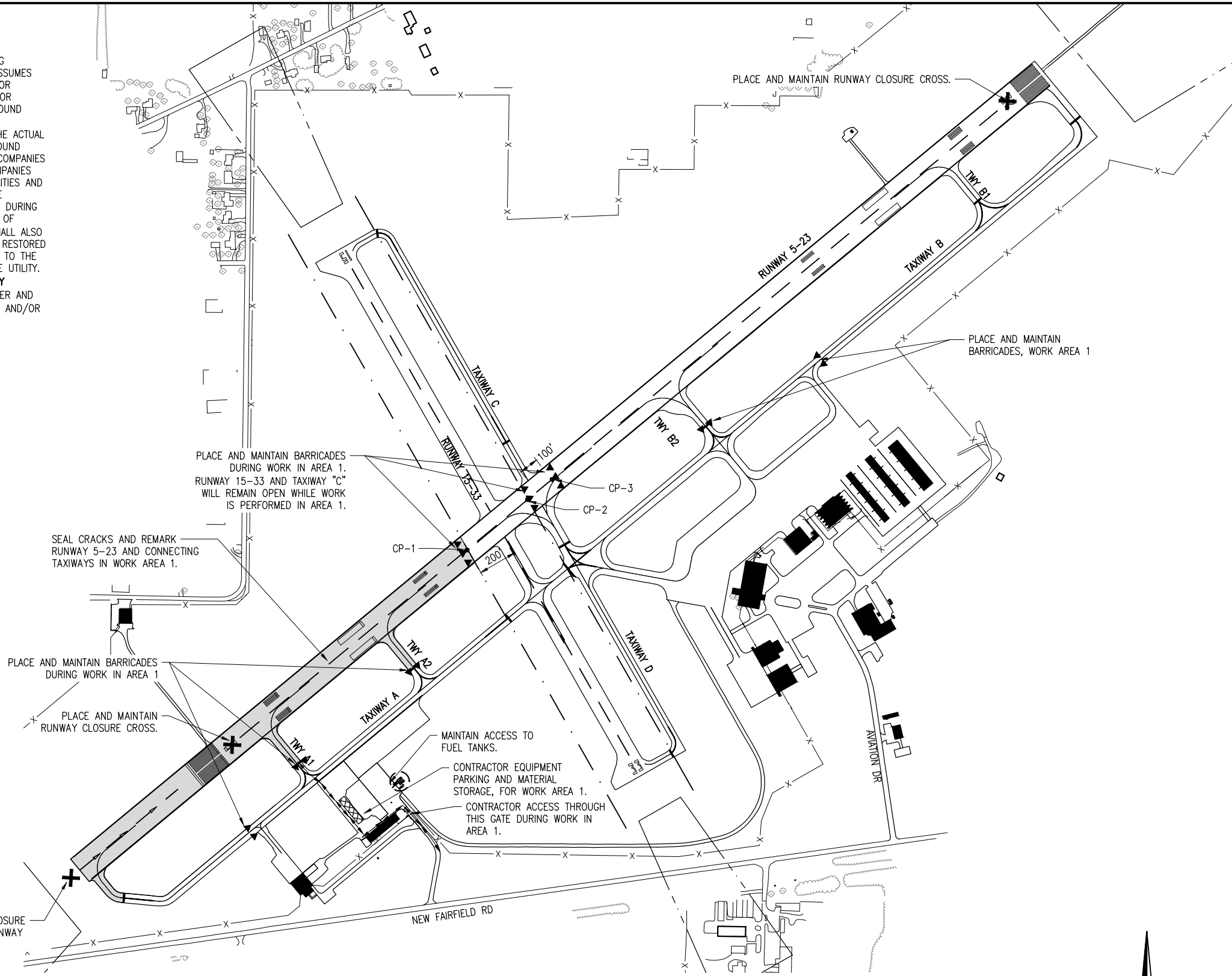

CRITICAL POINT DATA

NO.	DESCRIPTION	LAT.	LONG.	GND. ELEV.	EQP. HT.	EQP. ELEV.
1	BARRICADES ON RWY 5-23 WEST OF RWY 15-33	38° 19' 20.72"	88° 51' 35.20"	472'	25'	497'
2	BARRICADES ON RWY 5-23 WEST OF TWY C	38° 19' 23.29"	88° 51' 31.30"	469'	25'	494'
3	BARRICADES ON RWY 5-23 EAST OF TWY C	38° 19' 24.39"	88° 51' 29.83"	467'	25'	492'

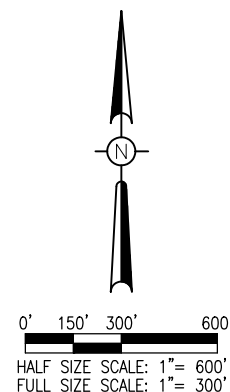



MAINTENANCE AND REMARKING OF RUNWAY 5/23

IDA No: MVN-4512

Contract No. MV061

NO.	DATE	DESCRIPTION		
		DES	DWN	REV

ISSUE: JANUARY 6, 2017
PROJECT NO: 15A0063
CAD FILE: G-004-SFY.DWG
DESIGN BY: CWS 10/14/2016
DRAWN BY: CWS 10/14/2016
REVIEWED BY: LDH 12/14/2016

PROPOSED SAFETY PLAN WORK AREA 2

UTILITY NOTE

THE LOCATION, SIZE, AND TYPE OF MATERIAL OF EXISTING UNDERGROUND AND/OR ABOVEGROUND UTILITIES INDICATED ON THE PLANS ARE NOT REPRESENTED AS BEING ACCURATE, SUFFICIENT OR COMPLETE. NEITHER THE OWNER NOR THE ENGINEER ASSUMES ANY RESPONSIBILITY WHATSOEVER IN RESPECT TO THE ACCURACY, COMPLETENESS, OR SUFFICIENCY OF THE INFORMATION. THERE IS NO GUARANTEE, EITHER EXPRESSED OR IMPLIED, THAT THE LOCATIONS, SIZE AND TYPE OF MATERIAL OF EXISTING UNDERGROUND UTILITIES INDICATED ARE REPRESENTATIVE OF THOSE TO BE ENCOUNTERED IN THE CONSTRUCTION. IT SHALL BE THE CONTRACTOR'S RESPONSIBILITY TO DETERMINE THE ACTUAL LOCATION OF ALL SUCH FACILITIES, INCLUDING SERVICE CONNECTIONS TO UNDERGROUND UTILITIES. PRIOR TO CONSTRUCTION, THE CONTRACTOR SHALL NOTIFY THE UTILITY COMPANIES OF HIS OPERATIONAL PLANS AND SHALL OBTAIN FROM THE RESPECTIVE UTILITY COMPANIES DETAILED INFORMATION AND ASSISTANCE RELATIVE TO THE LOCATION OF THEIR FACILITIES AND THE WORKING SCHEDULE OF THE COMPANIES FOR REMOVAL OR ADJUSTMENT WHERE REQUIRED. IN THE EVENT AN UNEXPECTED UTILITY INTERFERENCE IS ENCOUNTERED DURING CONSTRUCTION, THE CONTRACTOR SHALL IMMEDIATELY NOTIFY THE UTILITY COMPANY OF JURISDICTION. THE OWNER'S REPRESENTATIVE AND/OR THE RESIDENT ENGINEER SHALL ALSO BE IMMEDIATELY NOTIFIED. ANY DAMAGE TO SUCH MAINS AND SERVICES SHALL BE RESTORED TO SERVICE AT ONCE AND PAID FOR BY THE CONTRACTOR AT NO ADDITIONAL COST TO THE CONTRACT. ALL UTILITY CABLES AND LINES SHALL BE LOCATED BY THE RESPECTIVE UTILITY. **CONTACT JULIE (JOINT UTILITY LOCATION INFORMATION FOR EXCAVATORS) FOR UTILITY INFORMATION, PHONE: 1-800-892-0123. ALSO CONTACT AIRPORT DIRECTOR/MANAGER AND AIRPORT PERSONNEL FOR ASSISTANCE IN LOCATING UNDERGROUND AIRPORT CABLES AND/OR UTILITIES. ALSO COORDINATE WORK WITH ALL ABOVEGROUND UTILITIES.**

WORK AREA NOTES

1. THE CONTRACTOR MAY NOT WORK IN MORE THAN ONE AREA AT A TIME.
2. CLOSURE CROSSES AND BARRICADES SHALL BE IN PLACE PRIOR TO BEGINNING CONSTRUCTION.
3. AT ALL TIMES, THE CONTRACTOR'S OPERATIONS SHALL BE SUCH AS TO MINIMIZE CLOSURES.
4. CONTRACTOR SHALL BE REQUIRED TO CONTROL VEHICLE TRAFFIC ON ACTIVE AIRFIELD PAVEMENTS. AIRCRAFT SHALL HAVE THE RIGHT-OF-WAY AT ALL TIMES. PAVEMENTS ARE TO BE KEPT FREE OF DEBRIS AT ALL TIMES.

SAFETY PLAN COMPLIANCE DOCUMENT

PRIOR TO THE ISSUANCE OF A CONSTRUCTION NOTICE-TO-PROCEED (NTP), THE CONTRACTOR SHALL BE RESPONSIBLE FOR PREPARING AND SUBMITTING A SAFETY PLAN COMPLIANCE DOCUMENT IN ACCORDANCE WITH FAA ADVISORY CIRCULAR 150/5370-2F, PARAGRAPH 204B, OR EQUIVALENT SECTION IN SUBSEQUENT/CURRENT ISSUE. THE AIRPORT DIRECTOR SHALL APPROVE THIS DOCUMENT AND SUBMIT TO THE DIVISION OF AERONAUTICS FOR APPROVAL PRIOR TO THE NTP ISSUANCE.

LEGEND

- EXISTING IMPROVEMENTS
- PROPOSED IMPROVEMENTS
- EXISTING BUILDINGS
- PROPOSED EQUIPMENT PARKING AREA
- PROPOSED BARRICADES OR TRAFFIC CONES
- PROPOSED HAUL ROUTE.

J.U.L.I.E. INFORMATION

COUNTY: JEFFERSON
CITY: MT. VERNON
TOWNSHIP: MT. VERNON
SECTION NO.: 22, 23, 26 & 27
ADDRESS: MT. VERNON AIRPORT AUTHORITY
R.R. #4
MT. VERNON, ILLINOIS 62864

CRITICAL POINT DATA

NO.	DESCRIPTION	LAT.	LONG.	GND. ELEV.	EQP. HT.	EQP. ELEV.
1	LIMITS OF WORK AREA 2 CONSTRUCTION	38° 19' 20.72"	88° 51' 35.20"	472'	25'	497'
2	BARRICADES ON RWY 5-23 WEST OF TWY C	38° 19' 23.29"	88° 51' 31.30"	469'	25'	494'
3	LIMITS OF WORK AREA 2 CONSTRUCTION	38° 19' 24.39"	88° 51' 29.83"	467'	25'	492'

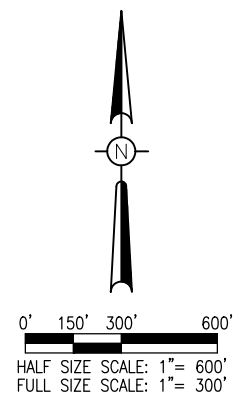
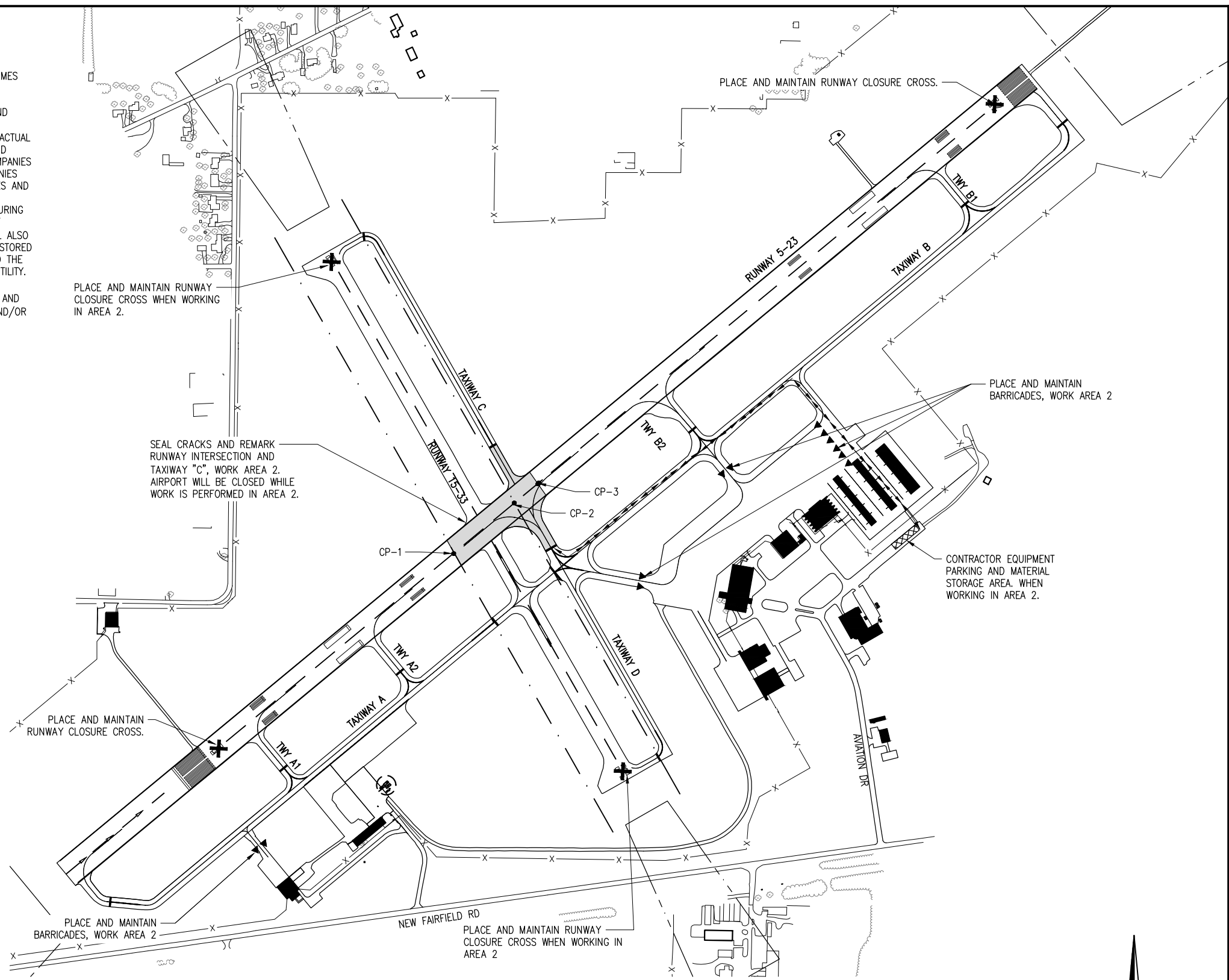

UTILITY NOTE

THE LOCATION, SIZE, AND TYPE OF MATERIAL OF EXISTING UNDERGROUND AND/OR ABOVEGROUND UTILITIES INDICATED ON THE PLANS ARE NOT REPRESENTED AS BEING ACCURATE, SUFFICIENT OR COMPLETE. NEITHER THE OWNER NOR THE ENGINEER ASSUMES ANY RESPONSIBILITY WHATSOEVER IN RESPECT TO THE ACCURACY, COMPLETENESS, OR SUFFICIENCY OF THE INFORMATION. THERE IS NO GUARANTEE, EITHER EXPRESSED OR IMPLIED, THAT THE LOCATIONS, SIZE AND TYPE OF MATERIAL OF EXISTING UNDERGROUND UTILITIES INDICATED ARE REPRESENTATIVE OF THOSE TO BE ENCOUNTERED IN THE CONSTRUCTION. IT SHALL BE THE CONTRACTOR'S RESPONSIBILITY TO DETERMINE THE ACTUAL LOCATION OF ALL SUCH FACILITIES, INCLUDING SERVICE CONNECTIONS TO UNDERGROUND UTILITIES. PRIOR TO CONSTRUCTION, THE CONTRACTOR SHALL NOTIFY THE UTILITY COMPANIES OF HIS OPERATIONAL PLANS AND SHALL OBTAIN FROM THE RESPECTIVE UTILITY COMPANIES DETAILED INFORMATION AND ASSISTANCE RELATIVE TO THE LOCATION OF THEIR FACILITIES AND THE WORKING SCHEDULE OF THE COMPANIES FOR REMOVAL OR ADJUSTMENT WHERE REQUIRED. IN THE EVENT AN UNEXPECTED UTILITY INTERFERENCE IS ENCOUNTERED DURING CONSTRUCTION, THE CONTRACTOR SHALL IMMEDIATELY NOTIFY THE UTILITY COMPANY OF JURISDICTION. THE OWNER'S REPRESENTATIVE AND/OR THE RESIDENT ENGINEER SHALL ALSO BE IMMEDIATELY NOTIFIED. ANY DAMAGE TO SUCH MAINS AND SERVICES SHALL BE RESTORED TO SERVICE AT ONCE AND PAID FOR BY THE CONTRACTOR AT NO ADDITIONAL COST TO THE CONTRACT. ALL UTILITY CABLES AND LINES SHALL BE LOCATED BY THE RESPECTIVE UTILITY. **CONTACT JULIE (JOINT UTILITY LOCATION INFORMATION FOR EXCAVATORS) FOR UTILITY INFORMATION, PHONE: 1-800-892-0123. ALSO CONTACT AIRPORT DIRECTOR/MANAGER AND AIRPORT PERSONNEL FOR ASSISTANCE IN LOCATING UNDERGROUND AIRPORT CABLES AND/OR UTILITIES. ALSO COORDINATE WORK WITH ALL ABOVEGROUND UTILITIES.**

WORK AREA NOTES

1. THE CONTRACTOR MAY NOT WORK IN MORE THAN ONE AREA AT A TIME.
2. CLOSURE CROSSES AND BARRICADES SHALL BE IN PLACE PRIOR TO BEGINNING CONSTRUCTION.
3. AT ALL TIMES, THE CONTRACTOR'S OPERATIONS SHALL BE SUCH AS TO MINIMIZE CLOSURES.
4. CONTRACTOR SHALL BE REQUIRED TO CONTROL VEHICLE TRAFFIC ON ACTIVE AIRFIELD PAVEMENTS. AIRCRAFT SHALL HAVE THE RIGHT-OF-WAY AT ALL TIMES. PAVEMENTS ARE TO BE KEPT FREE OF DEBRIS AT ALL TIMES.

SAFETY PLAN COMPLIANCE DOCUMENT

PRIOR TO THE ISSUANCE OF A CONSTRUCTION NOTICE-TO-PROCEED (NTP), THE CONTRACTOR SHALL BE RESPONSIBLE FOR PREPARING AND SUBMITTING A SAFETY PLAN COMPLIANCE DOCUMENT IN ACCORDANCE WITH FAA ADVISORY CIRCULAR 150/5370-2F, PARAGRAPH 204B, OR EQUIVALENT SECTION IN SUBSEQUENT/CURRENT ISSUE. THE AIRPORT DIRECTOR SHALL APPROVE THIS DOCUMENT AND SUBMIT TO THE DIVISION OF AERONAUTICS FOR APPROVAL PRIOR TO THE NTP ISSUANCE.

LEGEND

- EXISTING IMPROVEMENTS
- PROPOSED IMPROVEMENTS
- EXISTING BUILDINGS
- PROPOSED EQUIPMENT PARKING AREA
- PROPOSED BARRICADES OR TRAFFIC CONES
- PROPOSED HAUL ROUTE.

J.U.L.I.E. INFORMATION

COUNTY _____JEFFERSON
 CITY _____MT. VERNON
 TOWNSHIP _____MT. VERNON
 SECTION NO. _____22, 23, 26 & 27
 ADDRESS _____MT. VERNON AIRPORT AUTHORITY
 R.R. #4
 MT. VERNON, ILLINOIS 62864

CRITICAL POINT DATA

NO.	DESCRIPTION	LAT.	LONG.	GND. ELEV.	EQP. HT.	EQP. ELEV.
1	BARRICADES ON RWY 5-23 WEST OF RWY 15-33	38° 19' 20.72"	88° 51' 35.20"	472'	25'	497'
2	BARRICADES ON RWY 5-23 WEST OF TWY C	38° 19' 23.29"	88° 51' 31.30"	469'	25'	494'
3	BARRICADES ON RWY 5-23 EAST OF TWY C	38° 19' 24.39"	88° 51' 29.83"	467'	25'	492'

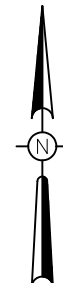
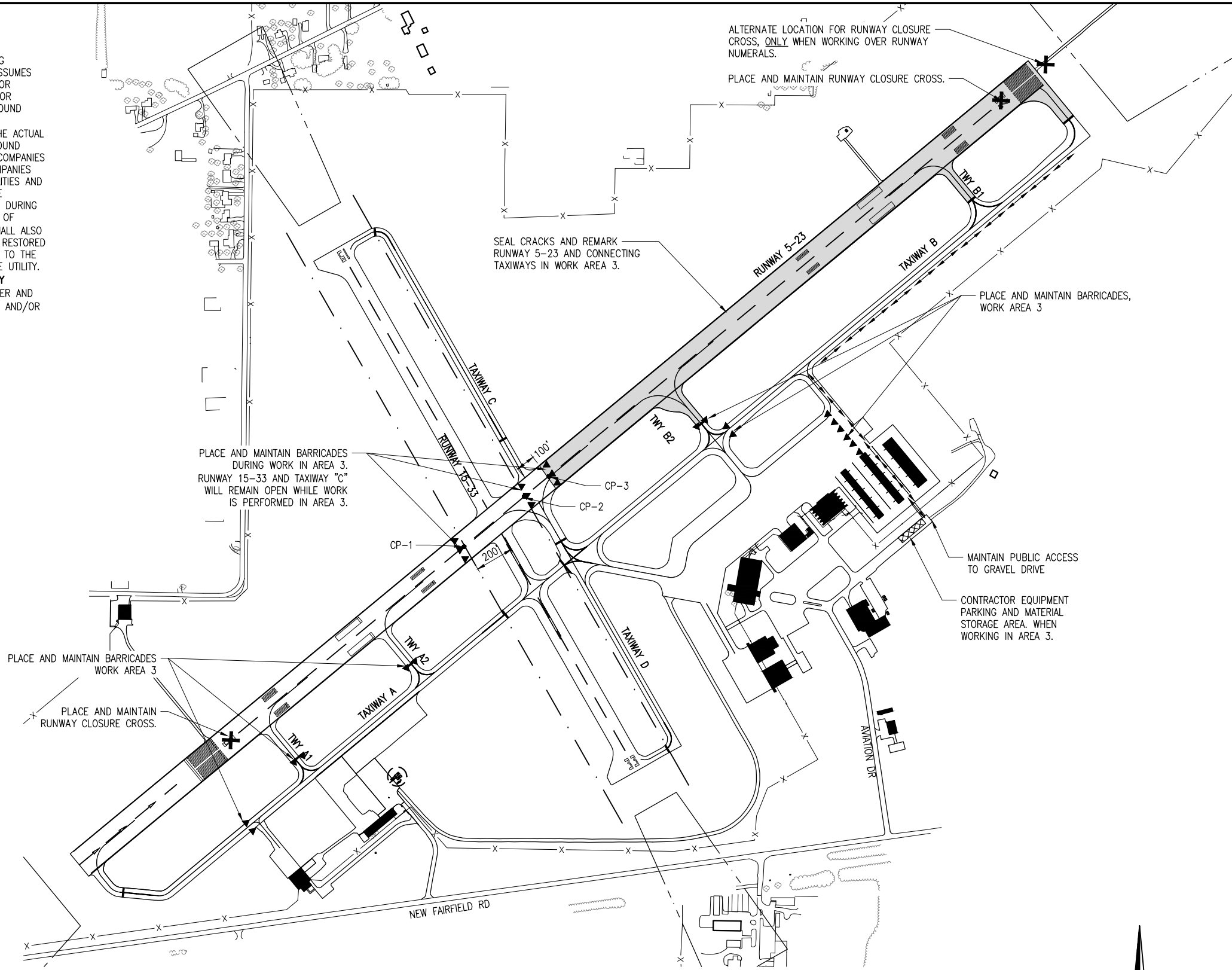

0' 150' 300' 600'
 HALF SIZE SCALE: 1" = 600'
 FULL SIZE SCALE: 1" = 300'



Offices Nationwide
 www.hanson-inc.com

Hanson Professional Services Inc.
 1525 S. 6th Street
 Springfield, IL 62703
 phone: 217-788-2450
 fax: 217-788-2503

Illinois Licensed
 Professional Service Corporation
 #184-001084

MT. VERNON AIRPORT



100 AVIATION DRIVE
 MT VERNON, IL 62864



MAINTENANCE AND REMARKING OF RUNWAY 5/23

IDA No: MVN-4512

Contract No. MV061

NO.	DATE	DESCRIPTION		
		DES	DWN	REV

ISSUE: JANUARY 6, 2017
 PROJECT NO: 15A0063
 CAD FILE: G-004-SFY.DWG
 DESIGN BY: CWS 10/14/2016
 DRAWN BY: CWS 10/14/2016
 REVIEWED BY: LDH 12/14/2016

SHEET TITLE
 PROPOSED SAFETY PLAN WORK AREA 3

SAFETY NOTES

1. FOLLOWING ARE THE CONSTRUCTION SAFETY PROCEDURES THAT THE CONTRACTOR SHALL FOLLOW THROUGHOUT THIS PROJECT. ADDITIONAL REQUIREMENTS ARE SHOWN ON THE PROPOSED SAFETY PLAN SHEETS.
2. ALL PROVISIONS OF THE LATEST EDITION OF FAA ADVISORY CIRCULAR AC 150/5370-2 (CURRENT EDITION), "OPERATIONAL SAFETY ON AIRPORTS DURING CONSTRUCTION", APPLY TO THIS CONTRACT, EXCEPT AS MODIFIED BY THIS SAFETY PLAN, OR AS MODIFIED BY THE OWNER THROUGH THE RESIDENT ENGINEER AT THE PRECONSTRUCTION CONFERENCE, OR DURING THE COURSE OF THE CONTRACT.
3. THE CONTRACTORS SHALL MINIMIZE DISRUPTION OF STANDARD OPERATING PROCEDURES FOR AERONAUTICAL ACTIVITY BY REMAINING WITHIN THE PRESCRIBED STAGING, CONSTRUCTION, AND PHASING AREAS PRESENTED ON THE PROJECT SAFETY AND PHASING PLANS.
4. NO UNAUTHORIZED PERSONNEL SHALL ENTER ANY AREA OF THE AIRPORT THAT COULD POTENTIALLY BE HAZARDOUS. THE AIRPORT MANAGER RESERVES THE RIGHT TO SUSPEND OPERATIONS IN ORDER TO MAINTAIN SAFETY AT THE AIRPORT.
5. CONTRACTOR EQUIPMENT, VEHICLES, AND PROJECT MATERIALS SHALL BE STORED AT THE STAGING AREA SHOWN ON THE PLAN VIEW, EXCEPT AS OTHERWISE PROVIDED FOR AT THE PRECONSTRUCTION CONFERENCE.
6. ALL CONSTRUCTION EQUIPMENT OPERATING IN THE PRESCRIBED CONSTRUCTION AREA IS REQUIRED TO DISPLAY A CHECKERBOARD FLAG PROPERLY LOCATED OR A ROTATING BEACON (STROBE) AS SPECIFIED IN AC 150/5210-5, "PAINTING, MARKING, AND LIGHTING OF VEHICLES USED ON AN AIRPORT" LATEST EDITION.
7. NO CONSTRUCTION MATERIAL STOCKPILES SHALL BE LOCATED WITHIN 250' OF ANY ACTIVE RUNWAY, WITHIN 93' OF ANY OTHER ACTIVE AIRPORT OPERATIONS AREA, OR PENETRATE A PART 77 IMAGINARY SURFACE (PROVIDED BY THE RESIDENT ENGINEER/TECHNICIAN) EXTENDING OUT AND UPWARDS FROM ALL SIDES OF AN ACTIVE RUNWAY.
8. NO OPEN TRENCHES WITHIN 250' OF AN ACTIVE RUNWAY CENTERLINE OR WITHIN 93' OF ANY AIRPORT OPERATIONS AREA WILL BE PERMITTED UNLESS PROPERLY MARKED. OTHER TRENCHES SHALL BE MAINTAINED SAFE, I.E., BARRICADED OR COVERED WITH STEEL PLATES IN ALL OTHER AREAS.
9. OPEN TRENCHES, EXCAVATIONS, AND STOCKPILED MATERIALS AT THE CONSTRUCTION SITE SHOULD BE PROMINENTLY MARKED WITH ORANGE FLAGS AND LIGHTED WITH FLASHING YELLOW LIGHTS DURING HOURS OF RESTRICTED VISIBILITY AND/OR DARKNESS.
10. NO CONSTRUCTION EQUIPMENT GREATER THAN 25' TALL WILL BE PERMITTED ON THE AIRPORT. HOWEVER OTHER EQUIPMENT TALLER THAN 25' MAY BE PERMITTED WITH THE APPROVAL OF THE AIRPORT MANAGER AND AIRSPACE APPROVAL BY THE FAA.
11. NO OPEN FLAME WELDING OR TORCH CUTTING OPERATION IS PERMITTED UNLESS ADEQUATE FIRE AND SAFETY PRECAUTIONS ARE PROVIDED AND HAVE BEEN APPROVED BY THE AIRPORT MANAGER. NO FLARE POTS ARE ALLOWED ON THE PROJECT.
12. SOIL, DEBRIS, AND LOOSE MATERIAL DROPPED OR TRUCKED ONTO AIRPORT ROADS, TAXIWAYS, AND SOD SURFACES, OR WHICH CAN BE BLOWN ONTO SUCH SURFACES, SHALL BE IMMEDIATELY SWEEPED, PICKED UP AND REMOVED, OR PLACED INTO CLOSED CONTAINERS. ANY DAMAGE TO AIRPORT PROPERTY SHALL BE REPAIRED IMMEDIATELY AT NO COST TO THE OWNER.
13. EACH CONTRACTOR SHALL BE RESPONSIBLE FOR LOCATING AND MAINTAINING AIRPORT LIGHTING AND NAVIGATIONAL ELECTRICAL SYSTEMS DURING CONSTRUCTION. A CONTACT PERSON AND TELEPHONE NUMBER FOR 24 HOUR EMERGENCY IMMEDIATE REPAIR SHALL BE SUBMITTED TO THE AIRPORT MANAGER AND RESIDENT ENGINEER/TECHNICIAN. HAUL ROUTES CROSSING PAVEMENT, DRAINAGE, MISCELLANEOUS. STRUCTURES AND/OR AIRFIELD CABLES SHALL BE PROTECTED FROM DAMAGE.
14. ALL AIRCRAFT AND AIRPORT OPERATIONS HAVE THE RIGHT-OF-WAY. CONTRACTOR TO YIELD TO VEHICLES AND REMAIN CLEAR AT ALL TIMES.
15. CONTRACTOR SHALL PLACE, SECURE, AND MAINTAIN LIGHTED BARRICADES AND CLOSURE CROSSES WHEN A RUNWAY/TAXIWAY/APRON IS CLOSED OR AS REQUIRED BY THE PLANS AND DESIGNATED BY THE RESIDENT ENGINEER/TECHNICIAN.
16. CONTRACTOR SHALL MARK HAZARDOUS AREAS WITH STEADY-BURNING OR FLASHING RED LIGHTS DURING PERIODS OF LOW VISIBILITY AS REQUIRED.
17. THE CONTRACTOR SHALL PERIODICALLY PERFORM ONSITE INSPECTIONS THROUGHOUT THE DURATION OF THE PROJECT WITH THE IMMEDIATE REMEDY OF ANY DIFFERENCES, WHETHER CAUSED BY NEGLIGENCE, OVERSIGHT, OR PROJECT SCOPE CHANGE.
18. CONTRACTOR SHALL MOVE MAINTENANCE OF TRAFFIC COMPONENTS AT THE WRITTEN DIRECTION OF THE RESIDENT ENGINEER/TECHNICIAN AT NO ADDITIONAL COST.
19. CONTRACTOR SHALL NOT REMOVE THE BARRICADES WITHOUT THE APPROVAL BY THE RESIDENT ENGINEER/TECHNICIAN.
20. CONTRACTOR SHALL MAINTAIN FLASHERS, SIGNS AND/OR BARRICADES AS REQUIRED BY THE PLANS, CITY OR COUNTY REGULATIONS OR CONTRACTOR ACTIVITIES. CONTRACTOR SHALL OBTAIN ANY AND ALL REQUIRED LOCAL PERMITS UNLESS SPECIFIED OTHERWISE.
21. THE CONTRACTOR SHALL UTILIZE WATER AND/OR CHEMICALS APPROVED BY THE RESIDENT ENGINEER/TECHNICIAN AS NECESSARY TO CONTROL DUST.
22. NO CONSTRUCTION VEHICLES SHALL BE DRIVEN ACROSS ANY ACTIVE RUNWAY, INCLUDING TURF RUNWAYS. CONSTRUCTION EQUIPMENT OR CONSTRUCTION ACTIVITY WILL NOT BE PERMITTED WITHIN 250' OF ANY ACTIVE RUNWAY CENTERLINE OR WITHIN 93' OF ANY OTHER ACTIVE AIRPORT TAXIWAY OR APRON. HOWEVER, CONSTRUCTION MAY BE PERMITTED IN THESE AREAS IF THE CONTRACTOR HAS GAINED APPROVAL FROM THE AIRPORT MANAGER AT LEAST 7 DAYS IN ADVANCE OF THE SCHEDULED CONSTRUCTION PERIOD AND THE OPERATIONAL AREA IS CLOSED TO TRAFFIC AND PROPER NOTAMS ARE ISSUED BY THE AIRPORT MANAGER TO THE APPROPRIATE FLIGHT SERVICE STATION.
23. UNLESS SPECIFIED OTHERWISE, COST FOR THE ABOVE IS TO BE CONSIDERED INCIDENTAL TO THE PROJECT. SEPARATE PAYMENT SHALL NOT BE MADE.

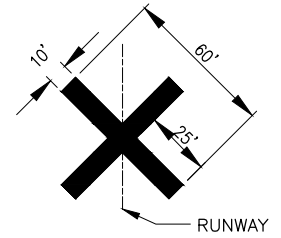

CLOSURE CROSS MARKER DETAIL

TEMPORARY CLOSURE CROSS MARKING SHALL BE "AVIATION YELLOW". TEMPORARY CLOSURE CROSS MARKINGS SHALL BE CONSTRUCTED OF PLYWOOD OR APPROVED FABRIC AND SHALL BE SECURED TO PAVEMENT BY SANDBAGS OR OTHER APPROVED METHOD. RUNWAY CLOSURE CROSS MARKINGS SHALL BE LIGHTED DURING DARKNESS AND PERIODS OF REDUCED VISIBILITY. DEVICES SHALL CONFORM TO THE FAA ADVISORY CIRCULARS 150/5345-55A SPECIFICATION FOR L-893, LIGHTED VISUAL AID TO INDICATE TEMPORARY RUNWAY CLOSURE (WHERE SPECIFIED).

RUNWAY/TAXIWAY CLOSURES

1. THE CONTRACTOR SHALL COMMUNICATE AND COORDINATE WITH THE RESIDENT ENGINEER/TECHNICIAN AND THE AIRPORT MANAGER FOR THE CLOSURE OF THESE RUNWAYS. THE AIRPORT MANAGER WILL ISSUE APPLICABLE NOTAM'S TO OPEN AND CLOSE THE AFFECTED PAVEMENTS.
2. THE CONTRACTOR SHALL PROVIDE, PLACE, SECURE, MAINTAIN AND REMOVE THE BARRICADES AND CLOSURE CROSSES THROUGHOUT THE PROJECT.
3. THE CONTRACTOR SHALL COORDINATE WITH THE AIRPORT MANAGER AND RESIDENT ENGINEER/TECHNICIAN PRIOR TO THE REMOVAL OF ANY BARRICADE OR CROSS.
4. COST FOR PROVIDING, PLACING, MAINTAINING, RELOCATING AND REMOVING THE CROSSES SHALL BE INCLUDED IN ITEM AR150520 MOBILIZATION.

BARRICADE NOTES

1. CLOSED AIRFIELD PHASING AREAS, OPEN TRENCHES, AND STOCKPILED MATERIALS AT THE CONSTRUCTION SITE SHALL BE PROMINENTLY MARKED WITH LIGHTED BARRICADES WITH STEADY BURNING OR FLASHING RED LIGHTS AS SPECIFIED IN 150/5370-2, "OPERATIONAL SAFETY ON AIRPORT DURING CONSTRUCTION, LATEST EDITION. LIGHTED BARRICADES MUST BE NO TALLER THAN 18" (EXCLUSIVE OF SUPPLEMENTARY LIGHTS AND FLAGS) ON THE TAXIWAYS AND COMPLY WITH ADVISORY CIRCULAR 150/5370-2, LATEST EDITION. CONTRACTOR SHALL NIGHT CHECK BARRICADES DAILY FOR PROPER OPERATION.
2. BARRICADES SHALL BE SPACED END TO END THE WIDTH OF THE PAVEMENT IN 4' INCREMENTS. BARRICADES ARE TO BE SET BACK 93' FROM THE ACTIVE TAXIWAY CENTERLINE OR AS SHOWN ON THE PLANS.
3. CONSTRUCTION RED WARNING LIGHT: THESE ARE PORTABLE, LENS DIRECTED, ENCLOSED LIGHTS. THE COLOR OF THE LIGHT EMITTED SHALL BE RED. THEY MAY BE USED IN EITHER A STEADY BURN (TYPE C) OR LOW INTENSITY FLASHING MODE (TYPE A) UNLESS NOTED OTHERWISE.
4. THE LIGHTING SHALL BE MAINTAINED IN OPERATION DURING THE HOURS OF DARKNESS BETWEEN 1/2 HOUR AFTER SUNSET AND 1/2 HOUR BEFORE SUNRISE AND WHEN CONDITIONS EXIST WHICH TEND TO OBSCURE VISION.
5. BARRICADES SHALL BE SECURED TO THE GROUND BY APPROVED METHODS TO PREVENT MOVEMENT BY PROP WASH, JET BLAST OR OTHER WIND CURRENTS.
6. THE ONLY COLOR COMBINATION ON BARRICADES IS ORANGE AND WHITE. THE ORANGE STRIPES SHALL BE ENCAPSULATED LENS REFLECTIVE SHEETING. THE WHITE STRIPES SHALL BE EITHER ENCAPSULATED OR ENCLOSED LENS REFLECTIVE SHEETING AND MUST BE IN ACCEPTABLE CONDITION.
7. COST FOR PROVIDING, PLACING, MAINTAINING, AND REMOVING BARRICADES SHALL BE INCLUDED IN ITEM AR150520 MOBILIZATION.



MAINTENANCE AND REMARKING OF RUNWAY 5/23

IDA No: MVN-4512

Contract No. MV061

NO.	DATE	DESCRIPTION		
		DES	DWN	REV

ISSUE: JANUARY 6, 2017
PROJECT NO: 15A0063
CAD FILE: G-004-SFY.DWG
DESIGN BY: CWS 10/14/2016
DRAWN BY: CWS 10/14/2016
REVIEWED BY: LDH 12/14/2016

SHEET TITLE

CONSTRUCTION SAFETY PLAN NOTES AND DETAILS



MAINTENANCE AND REMARKING OF RUNWAY 5/23

IDA No: MVN-4512

Contract No. MV061

NO.	DATE	DESCRIPTION		
		DES	DWN	REV

ISSUE: JANUARY 6, 2017
PROJECT NO: 15A0063
CAD FILE: C-103-CRKS.LDWG
DESIGN BY: CWS 11/01/2016
DRAWN BY: CWS 11/01/2016
REVIEWED BY: LDH 12/14/2016

SHEET TITLE

PROPOSED CRACK SEAL PLAN - STA 5+00 - 19+00

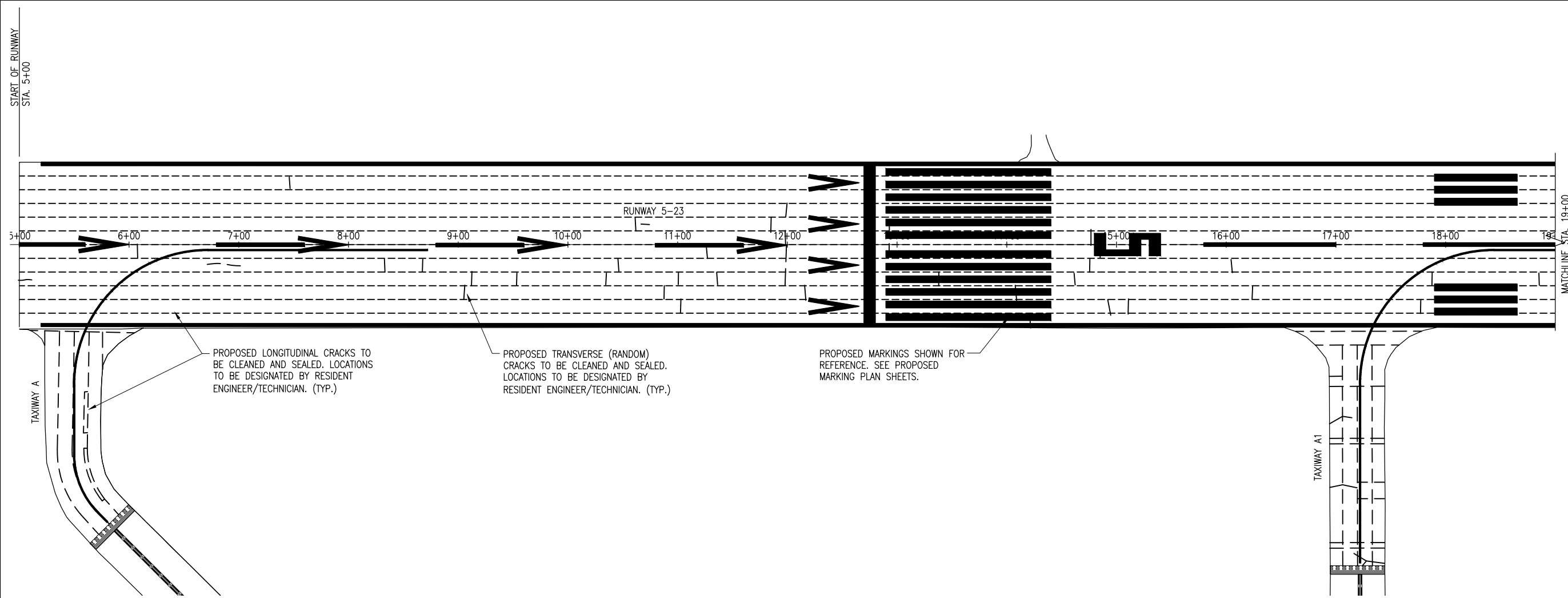

PROPOSED LONGITUDINAL CRACKS TO BE CLEANED AND SEALED. LOCATIONS TO BE DESIGNATED BY RESIDENT ENGINEER/TECHNICIAN. (TYP.)

PROPOSED TRANSVERSE (RANDOM) CRACKS TO BE CLEANED AND SEALED. LOCATIONS TO BE DESIGNATED BY RESIDENT ENGINEER/TECHNICIAN. (TYP.)

PROPOSED MARKINGS SHOWN FOR REFERENCE. SEE PROPOSED MARKING PLAN SHEETS.

CLEAN & SEAL BITUMINOUS CRACKS NOTES:

1. THE EXACT AMOUNT OF CRACKS TO BE CLEANED & SEALED WILL BE THE NUMBER OF LINEAR FEET OF CRACKS MARKED BY THE RESIDENT ENGINEER/TECHNICIAN AT THE TIME OF CONSTRUCTION.
2. ALL CRACKS DESIGNATED BY THE RESIDENT ENGINEER/TECHNICIAN FOR REPAIR WILL BE COMPLETED AS STATED IN THE SPECIAL PROVISIONS.
3. THE PAVEMENT CONDITIONS AND CRACKS WERE IDENTIFIED AND LOCATED AS SHOWN DURING A SITE INSPECTION ON NOVEMBER 4, 2016.
4. THE PROPOSED CLEANING & SEALING OF THE IDENTIFIED CRACKS SHALL BE PERFORMED PRIOR TO THE APPLICATION OF THE PAVEMENT MARKINGS
5. THE BITUMINOUS CRACK CLEANING & SEALING WILL BE PAID FOR UNDER ITEM: AR201661 - CLEAN & SEAL BITUMINOUS CRACKS - PER L.F.

LEGEND

— EXISTING IMPROVEMENTS

- - - BITUMINOUS CRACKS TO BE CLEANED AND SEALED

0' 25' 50' 100'

HALF SIZE SCALE: 1" = 100'
FULL SIZE SCALE: 1" = 50'

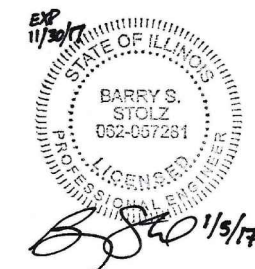

**MAINTENANCE AND
REMARKING OF
RUNWAY 5/23**

IDA No: MVN-4512

Contract No. MV061

NO.	DATE	DESCRIPTION		
		DES	DWN	REV

ISSUE: JANUARY 6, 2017

PROJECT NO: 15A0063

CAD FILE: C-103-CRKS.LDWG

DESIGN BY: CWS 11/01/2016

DRAWN BY: CWS 11/01/2016

REVIEWED BY: LDH 12/14/2016

SHEET TITLE

**PROPOSED CRACK
SEAL PLAN - STA
19+00 - 43+00**

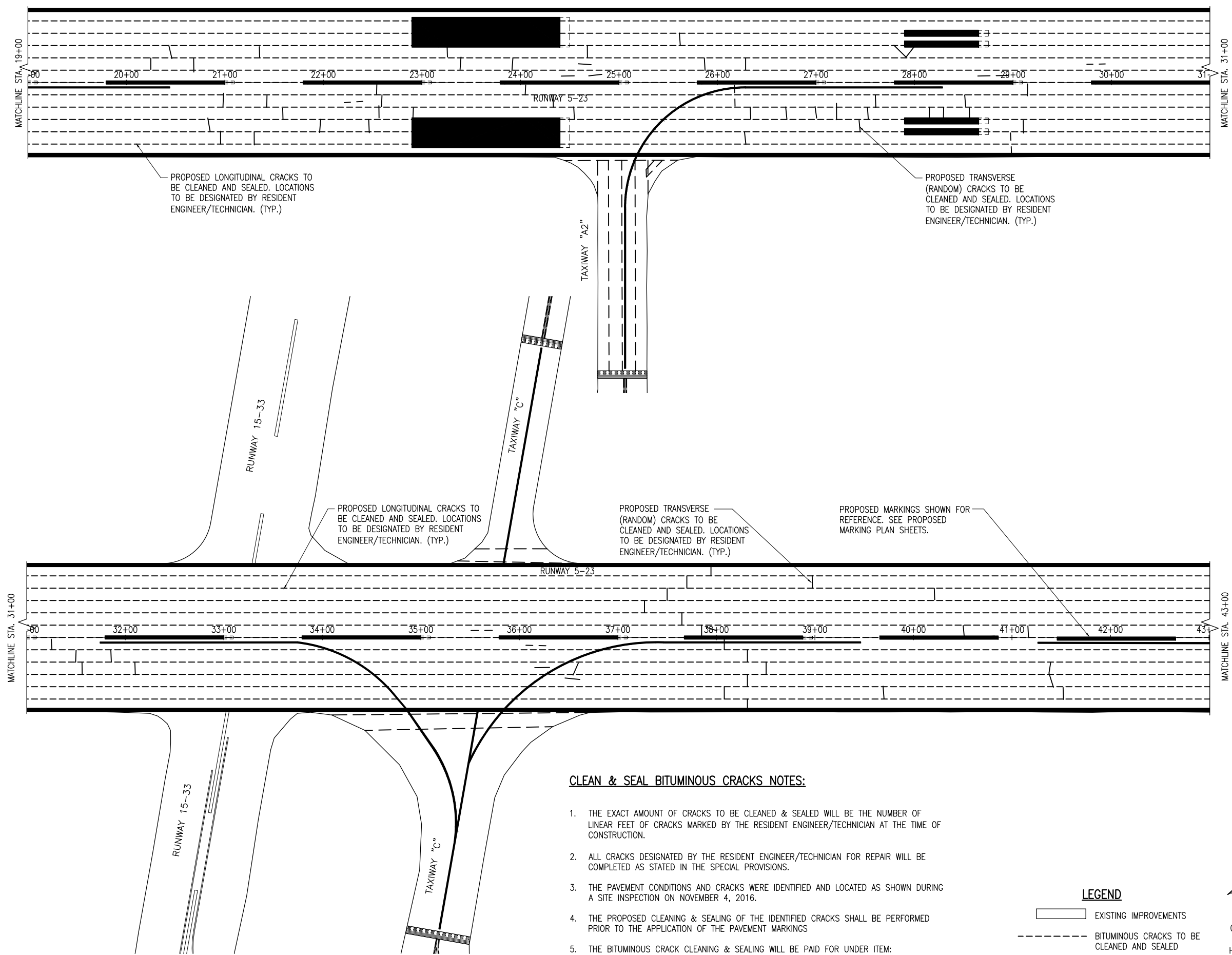
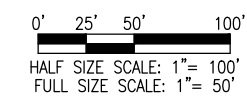
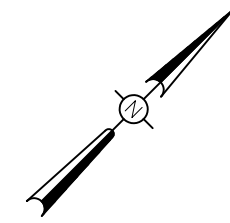

PROPOSED LONGITUDINAL CRACKS TO BE CLEANED AND SEALED. LOCATIONS TO BE DESIGNATED BY RESIDENT ENGINEER/TECHNICIAN. (TYP.)

PROPOSED TRANSVERSE (RANDOM) CRACKS TO BE CLEANED AND SEALED. LOCATIONS TO BE DESIGNATED BY RESIDENT ENGINEER/TECHNICIAN. (TYP.)

PROPOSED LONGITUDINAL CRACKS TO BE CLEANED AND SEALED. LOCATIONS TO BE DESIGNATED BY RESIDENT ENGINEER/TECHNICIAN. (TYP.)

PROPOSED TRANSVERSE (RANDOM) CRACKS TO BE CLEANED AND SEALED. LOCATIONS TO BE DESIGNATED BY RESIDENT ENGINEER/TECHNICIAN. (TYP.)

PROPOSED MARKINGS SHOWN FOR REFERENCE. SEE PROPOSED MARKING PLAN SHEETS.

CLEAN & SEAL BITUMINOUS CRACKS NOTES:

1. THE EXACT AMOUNT OF CRACKS TO BE CLEANED & SEALED WILL BE THE NUMBER OF LINEAR FEET OF CRACKS MARKED BY THE RESIDENT ENGINEER/TECHNICIAN AT THE TIME OF CONSTRUCTION.
2. ALL CRACKS DESIGNATED BY THE RESIDENT ENGINEER/TECHNICIAN FOR REPAIR WILL BE COMPLETED AS STATED IN THE SPECIAL PROVISIONS.
3. THE PAVEMENT CONDITIONS AND CRACKS WERE IDENTIFIED AND LOCATED AS SHOWN DURING A SITE INSPECTION ON NOVEMBER 4, 2016.
4. THE PROPOSED CLEANING & SEALING OF THE IDENTIFIED CRACKS SHALL BE PERFORMED PRIOR TO THE APPLICATION OF THE PAVEMENT MARKINGS
5. THE BITUMINOUS CRACK CLEANING & SEALING WILL BE PAID FOR UNDER ITEM: AR201661 - CLEAN & SEAL BITUMINOUS CRACKS - PER L.F.

LEGEND

- EXISTING IMPROVEMENTS
- BITUMINOUS CRACKS TO BE CLEANED AND SEALED

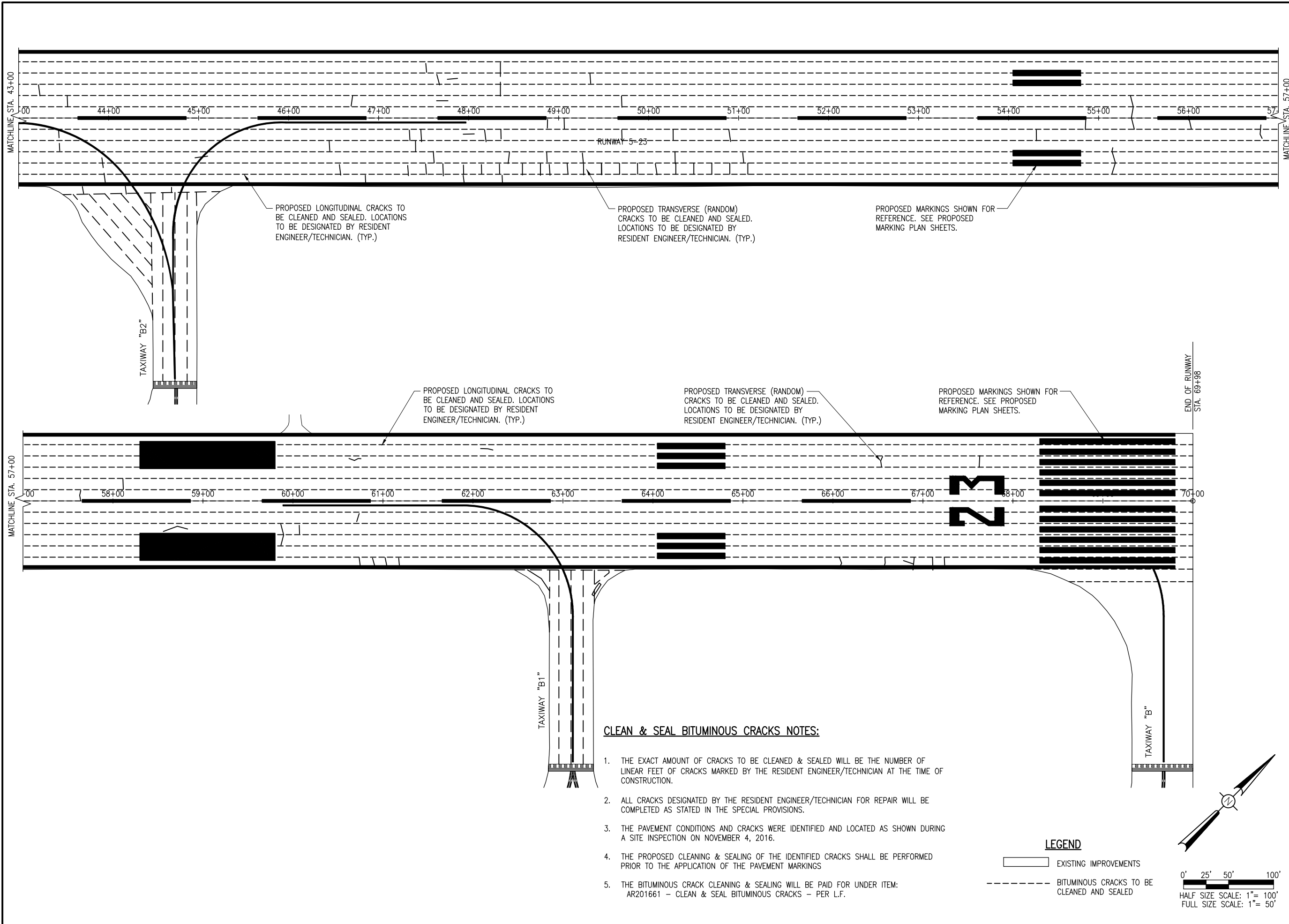

PROPOSED LONGITUDINAL CRACKS TO BE CLEANED AND SEALED. LOCATIONS TO BE DESIGNATED BY RESIDENT ENGINEER/TECHNICIAN. (TYP.)

PROPOSED TRANSVERSE (RANDOM) CRACKS TO BE CLEANED AND SEALED. LOCATIONS TO BE DESIGNATED BY RESIDENT ENGINEER/TECHNICIAN. (TYP.)

PROPOSED MARKINGS SHOWN FOR REFERENCE. SEE PROPOSED MARKING PLAN SHEETS.

PROPOSED LONGITUDINAL CRACKS TO BE CLEANED AND SEALED. LOCATIONS TO BE DESIGNATED BY RESIDENT ENGINEER/TECHNICIAN. (TYP.)

PROPOSED TRANSVERSE (RANDOM) CRACKS TO BE CLEANED AND SEALED. LOCATIONS TO BE DESIGNATED BY RESIDENT ENGINEER/TECHNICIAN. (TYP.)

PROPOSED MARKINGS SHOWN FOR REFERENCE. SEE PROPOSED MARKING PLAN SHEETS.

CLEAN & SEAL BITUMINOUS CRACKS NOTES:

1. THE EXACT AMOUNT OF CRACKS TO BE CLEANED & SEALED WILL BE THE NUMBER OF LINEAR FEET OF CRACKS MARKED BY THE RESIDENT ENGINEER/TECHNICIAN AT THE TIME OF CONSTRUCTION.
2. ALL CRACKS DESIGNATED BY THE RESIDENT ENGINEER/TECHNICIAN FOR REPAIR WILL BE COMPLETED AS STATED IN THE SPECIAL PROVISIONS.
3. THE PAVEMENT CONDITIONS AND CRACKS WERE IDENTIFIED AND LOCATED AS SHOWN DURING A SITE INSPECTION ON NOVEMBER 4, 2016.
4. THE PROPOSED CLEANING & SEALING OF THE IDENTIFIED CRACKS SHALL BE PERFORMED PRIOR TO THE APPLICATION OF THE PAVEMENT MARKINGS
5. THE BITUMINOUS CRACK CLEANING & SEALING WILL BE PAID FOR UNDER ITEM:
AR201661 - CLEAN & SEAL BITUMINOUS CRACKS - PER L.F.

LEGEND

- EXISTING IMPROVEMENTS
- BITUMINOUS CRACKS TO BE CLEANED AND SEALED

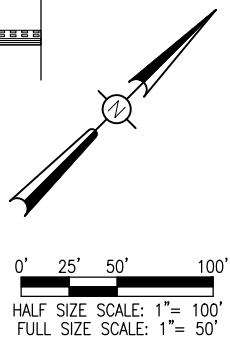

JAN 05, 2017, 4:33 PM SCHUB01446
I:\5\JOBS\15A00631\5A00631\CAD\AIRPORT\ISHEETC-103-CRKS\LDWG

MAINTENANCE AND REMARKING OF RUNWAY 5/23

IDA No: MVN-4512

Contract No. MV061

NO.	DATE	DESCRIPTION		
		DES	DWN	REV
ISSUE: JANUARY 6, 2017				
PROJECT NO: 15A0063				
CAD FILE: C-103-CRKS\LDWG				
DESIGN BY: CWS 11/01/2016				
DRAWN BY: CWS 11/01/2016				
REVIEWED BY: LDH 12/14/2016				

SHEET TITLE

PROPOSED CRACK SEAL PLAN - STA 43+00 - 70+00



**MAINTENANCE AND
REMARKING OF
RUNWAY 5/23**

IDA No: MVN-4512

Contract No. MV061

NO.	DATE	DESCRIPTION		
		DES	DWN	REV

ISSUE: JANUARY 6, 2017

PROJECT NO: 15A0063

CAD FILE: C-102-MRK.DWG

DESIGN BY: CWS 11/01/2016

DRAWN BY: CWS 11/01/2016

REVIEWED BY: LDH 12/14/2016

SHEET TITLE

**PROPOSED MARKING
PLAN - STA 5+00 -
19+00**

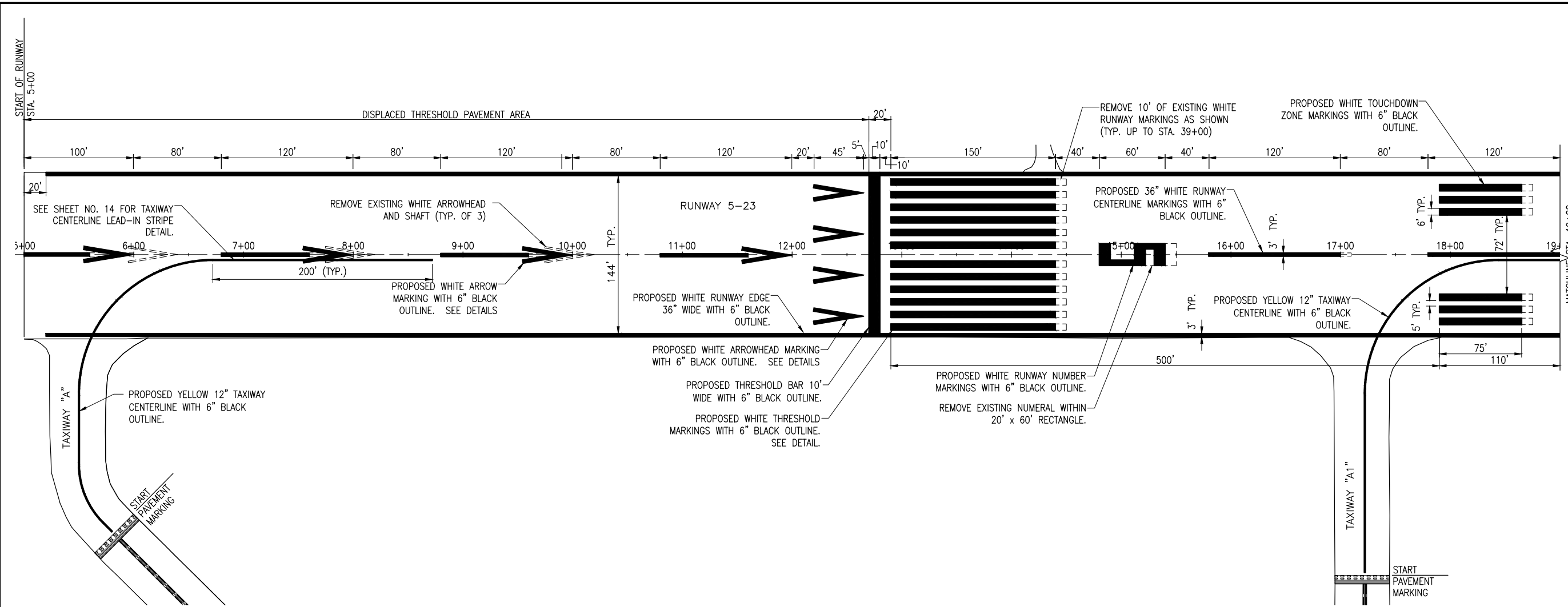

PAVEMENT MARKINGS			
DESCRIPTION	UNIT AREA	NO. REQ.	TOTAL AREA
NUMERAL NO. 2	652	1	652
NUMERAL NO. 3	633	1	633
NUMERAL NO. 5	750	1	750
DISPLACED THRESHOLD BAR	1,440	1	1,440
THRESHOLD STRIPE	862.5	24	20,700
AIMING POINT MARKING	4,500	4	18,000
TOUCH DOWN ZONE MARKERS	450	20	9,000
RUNWAY EDGE STRIPE	19,380	2	38,760
5-23 RWY. CENTERLINE STRIPE	360	26	9,360
ARROWHEAD	220	8	1,760
ARROW SHAFT	120	3	360
ARROW SHAFT	90	1	90
TOTAL WHITE			101,505
TAXIWAY CENTERLINE STRIPE	4,750	1	4,750
TOTAL YELLOW			4,750
NUMERAL NO. 2	106	1	106
NUMERAL NO. 3	103	1	103
NUMERAL NO. 5	111	1	111
DISPLACED THRESHOLD BAR	154	1	154
THRESHOLD STRIPE	156	24	3,744
AIMING POINT MARKING	181	4	724
TOUCH DOWN ZONE MARKERS	82	20	1,640
RUNWAY EDGE STRIPE	6,463.5	2	12,927
5-23 RWY. CENTERLINE STRIPE	124	26	3,224
ARROWHEAD	77.25	8	618
ARROW SHAFT	82.5	3	247.5
ARROW SHAFT	62.5	1	62.5
TAXIWAY CENTERLINE STRIPE	4,752	1	4,752
TOTAL BLACK			28,413
TOTAL MARKING			134,668

620-PAVEMENT MARKING-WATERBORNE NOTES

1. THE PAVEMENT MARKING-WATERBORNE (620) SHALL BE PLACED IN ACCORDANCE WITH ITEM 620 "PAVEMENT MARKING" AS STATED ON PAGE 272 OF THE ILLINOIS STANDARD SPECIFICATIONS FOR CONSTRUCTION OF AIRPORTS, ADOPTED APRIL 1, 2012.
2. THIS ITEM SHALL CONSIST OF RUNWAY MARKING AND TAXIWAY CENTERLINE MARKING IN ACCORDANCE WITH THESE SPECIFICATIONS AND AT THE LOCATIONS SHOWN ON THE CONSTRUCTION PLANS. ALL MARKING WILL BE WHITE AND YELLOW IN COLOR WITH A 6-IN BLACK BORDER. THE PROPOSED PAVEMENT MARKING WILL BE APPLIED IN TWO APPLICATIONS.
3. ANY MATERIAL DELIVERED THAT FAILS TO MEET THE SPECIFICATIONS SHALL BE DISPOSED OF BY THE VENDOR AND IMMEDIATELY REPLACED WITH ACCEPTABLE MATERIAL ENTIRELY AT THE VENDOR'S EXPENSE, INCLUDING HANDLING AND TRANSPORTATION CHARGES.
4. IF THE CONTRACTOR ELECTS TO "BLOCK PAINT" THE BLACK PAINT AND THEN PAINT EITHER YELLOW OR WHITE PAINT OVER THE BLACK PAINT; ONLY THE VISIBLE 6" BLACK OUTLINE WILL BE ELIGIBLE FOR PAYMENT.
5. CUT-OFF SHEETS WILL BE REQUIRED TO INSURE STRAIGHT EDGES.
6. THE PROPOSED MARKING WILL BE PAID FOR UNDER ITEM:
AR620520 PAVEMENT MARKING-WATERBORNE ___ PER S.F.
AR620525 PAVEMENT MARKING-BLACK BORDER ___ PER S.F.

LEGEND

- EXISTING PAVEMENT
- EXISTING MARKING
- EXISTING MARKING TO BE REMOVED
- PROPOSED MARKING

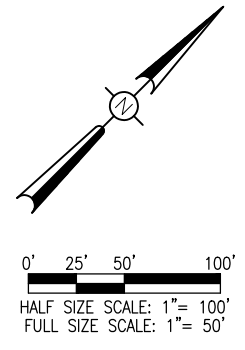



**MAINTENANCE AND
REMARKING OF
RUNWAY 5/23**

IDA No: MVN-4512

Contract No. MV061

NO.	DATE	DESCRIPTION		
		DES	DWN	REV

ISSUE: JANUARY 6, 2017
PROJECT NO: 15A0063
CAD FILE: C-102-MRK.DWG
DESIGN BY: CWS 11/01/2016
DRAWN BY: CWS 11/01/2016
REVIEWED BY: LDH 12/14/2016

SHEET TITLE

**PROPOSED MARKING
PLAN - STA 19+00 -
43+00**

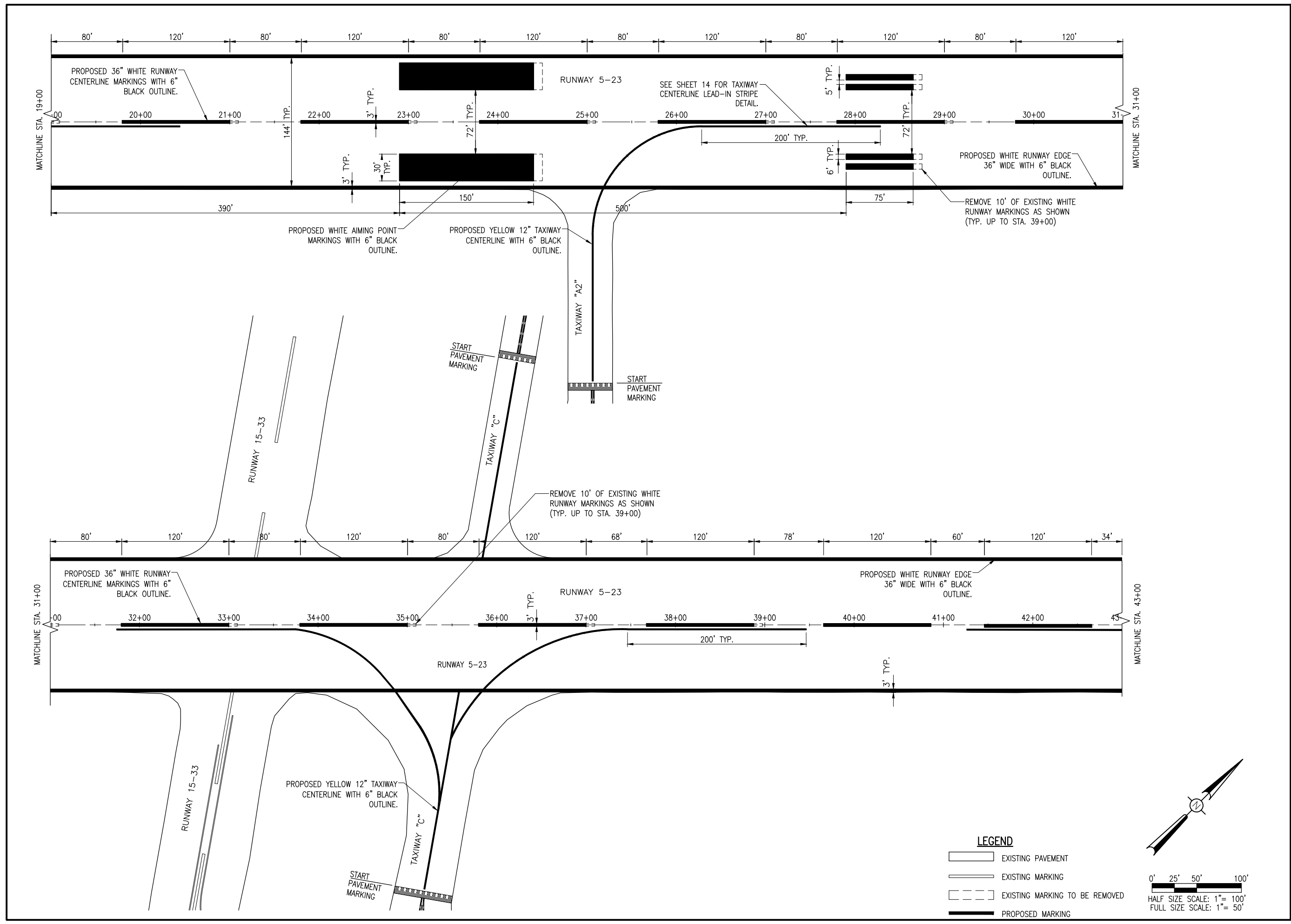

JAN 05, 2017, 4:34 PM, SCHUB01446, I:\5\JOBS\15A0063\CAD\AIRPORT\ISHEET\C-102-MRK.DWG

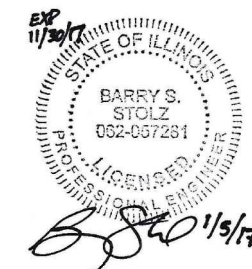

**MAINTENANCE AND
REMARKING OF
RUNWAY 5/23**

IDA No: MVN-4512

Contract No. MV061

NO.	DATE	DESCRIPTION		
		DES	DWN	REV

ISSUE: JANUARY 6, 2017

PROJECT NO: 15A0063

CAD FILE: C-102-MRK.DWG

DESIGN BY: CWS 11/01/2016

DRAWN BY: CWS 11/01/2016

REVIEWED BY: LDH 12/14/2016

SHEET TITLE

**PROPOSED MARKING
PLAN - STA 43+00 -
70+00**

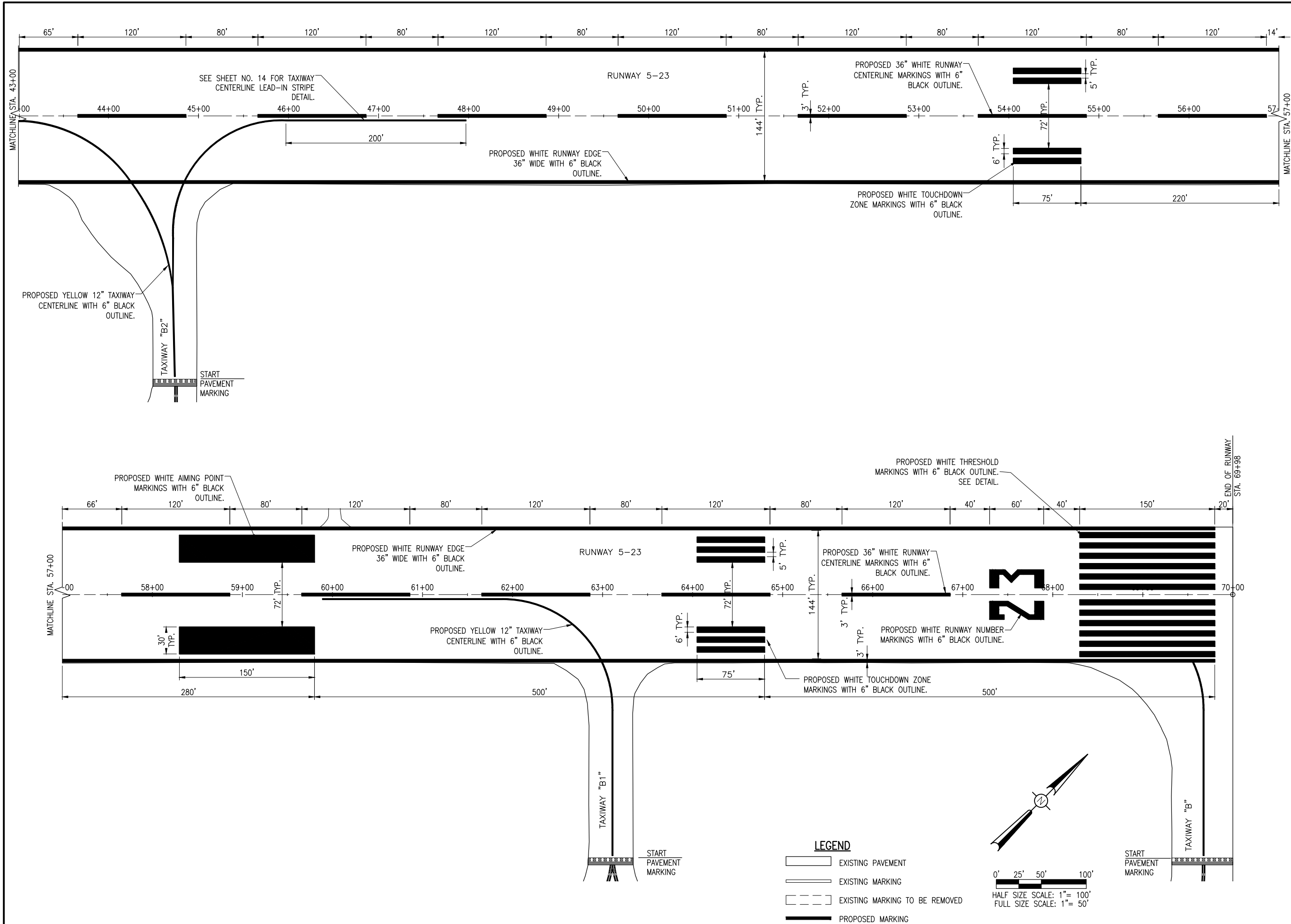

LEGEND

- EXISTING PAVEMENT
- EXISTING MARKING
- EXISTING MARKING TO BE REMOVED
- PROPOSED MARKING

0' 25' 50' 100'

HALF SIZE SCALE: 1" = 100'
FULL SIZE SCALE: 1" = 50'

JAN 05, 2017, 4:34 PM, SCHUB01446, I:\5\JOBS\15A0063\15A0063\CAD\AIRPORT\ISHEET\C-102-MRK.DWG

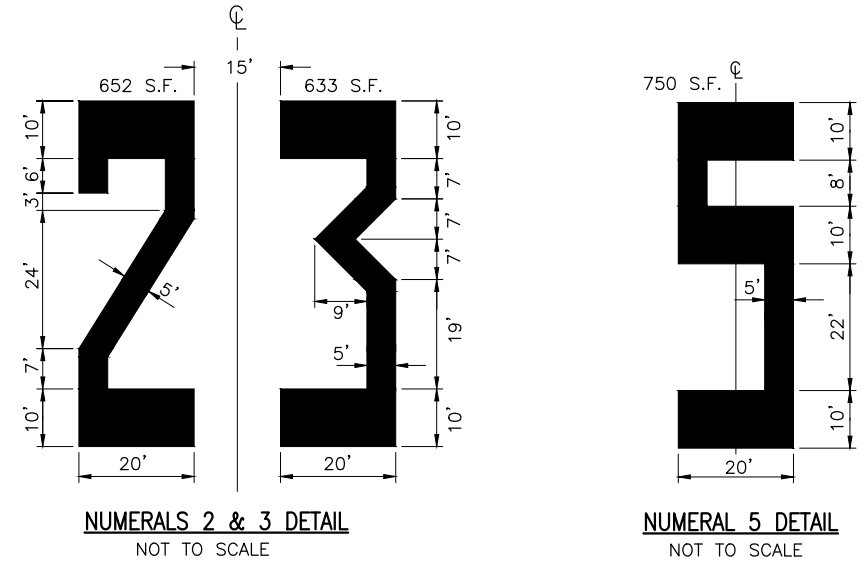

NUMERALS 2 & 3 DETAIL
NOT TO SCALE

NUMERAL 5 DETAIL
NOT TO SCALE

RUNWAY DESIGNATION MARKING NOTES:

1. ALL NUMERAL MARKING WILL BE WHITE IN COLOR WITH A 6" BLACK OUTLINE.
2. NUMERALS ARE HORIZONTALLY SPACED 15 FEET APART.
3. DOUBLE DIGIT NUMERAL DESIGNATIONS ARE CENTERED ON THE RUNWAY PAVEMENT CENTERLINE BASED ON THE CENTER OF THE OUTER EDGES OF THE TWO NUMERALS.

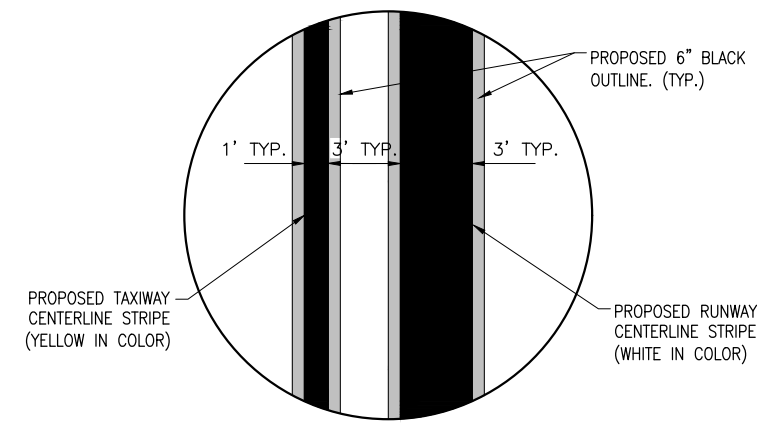

TAXIWAY CENTERLINE LEAD-IN DETAIL
NOT TO SCALE

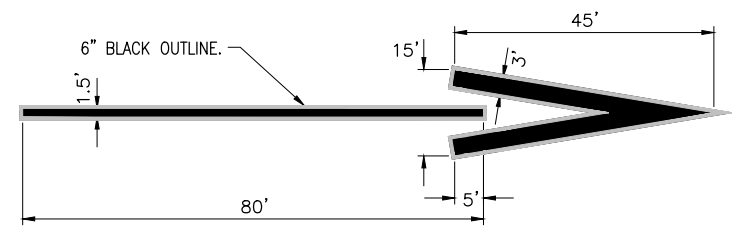

ARROW DETAIL
NOT TO SCALE

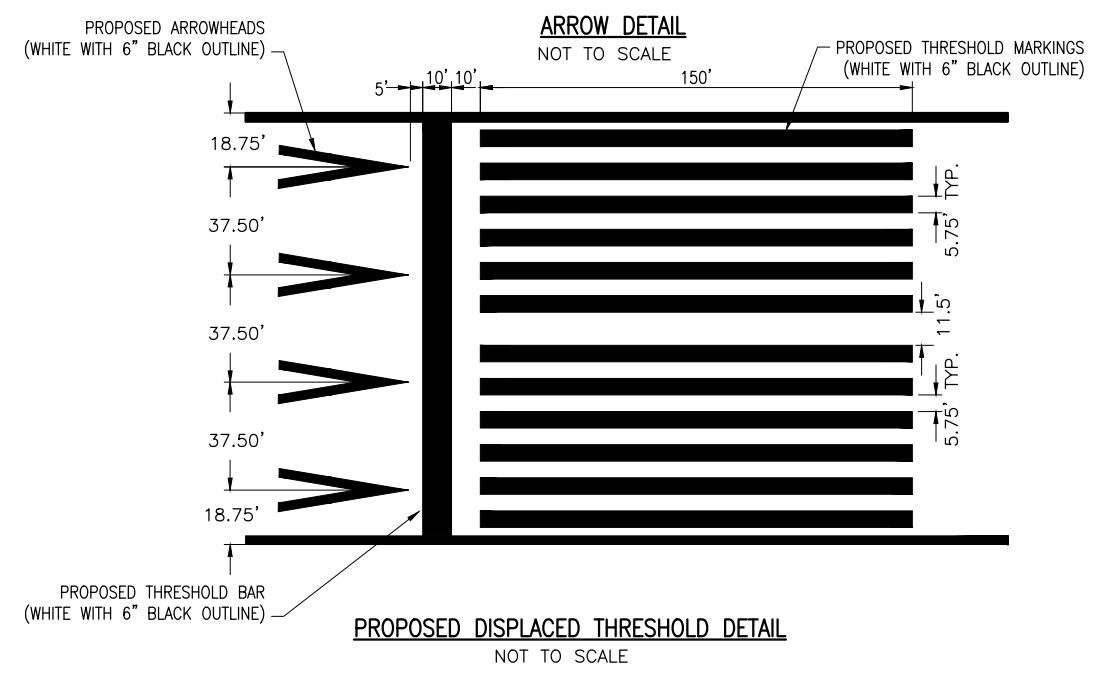

PROPOSED DISPLACED THRESHOLD DETAIL
NOT TO SCALE

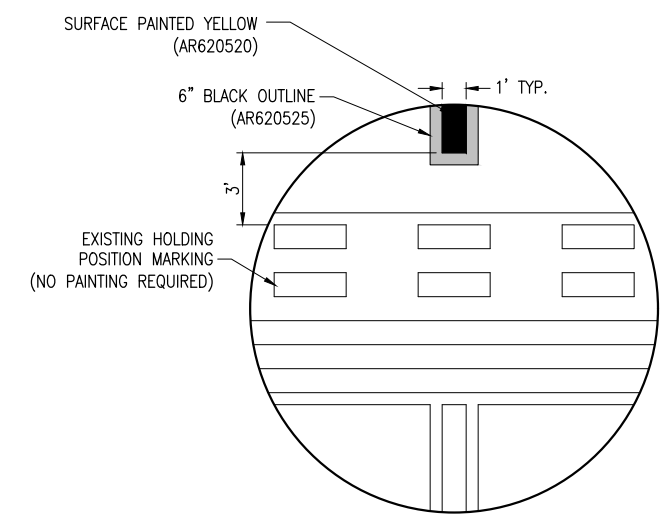

HOLDING POSITION DETAIL
NOT TO SCALE

MAINTENANCE AND REMARKING OF RUNWAY 5/23

IDA No: MVN-4512

Contract No. MV061

NO.	DATE	DESCRIPTION		
		DES	DWN	REV

ISSUE: JANUARY 6, 2017
PROJECT NO: 15A0063
CAD FILE: C-102-MRK.DWG
DESIGN BY: CWS 11/01/2016
DRAWN BY: CWS 11/01/2016
REVIEWED BY: LDH 12/14/2016

PROPOSED MARKING DETAILS