

F.A.S. RTE.	SECTION	COUNTY	TOTAL SHEETS	SHEET NO.
2320	113X-N	WILL	133	31
STA.		TO STA.		
FED. ROAD DIST. NO.		ILLINOIS FED. AID PROJECT		

IL. RTE. 129

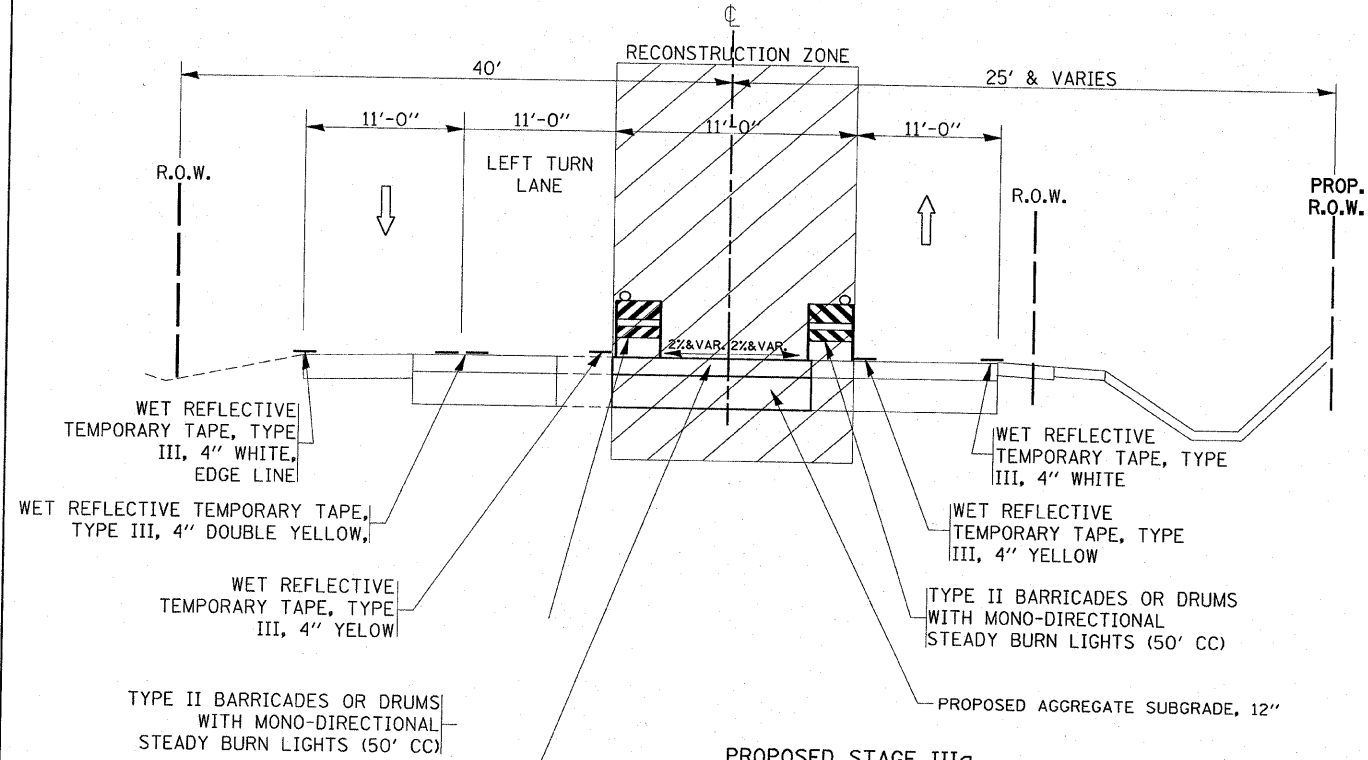

PROPOSED STAGE IIIa
ILL RTE. 129
STA 91+42 TO 105+24.10 (RESURFACING AND WIDENING)

PAVEMENT RECONSTRUCTION AREA:
PROPOSED HOT-MIX ASPHALT BINDER COURSE, IL-19, N70, 11 1/2" (STA 94+12 TO 96+80 AND STA 100+50 TO STA 102+54)

PAVEMENT WIDENING AREA:
PROPOSED HOT-MIX ASPHALT BASE COURSE WIDENING, IL-19, 10 3/4" (STA 91+42 TO STA 94+12) AND STA 102+54 TO STA 105+24.10)

IL. RTE. 129

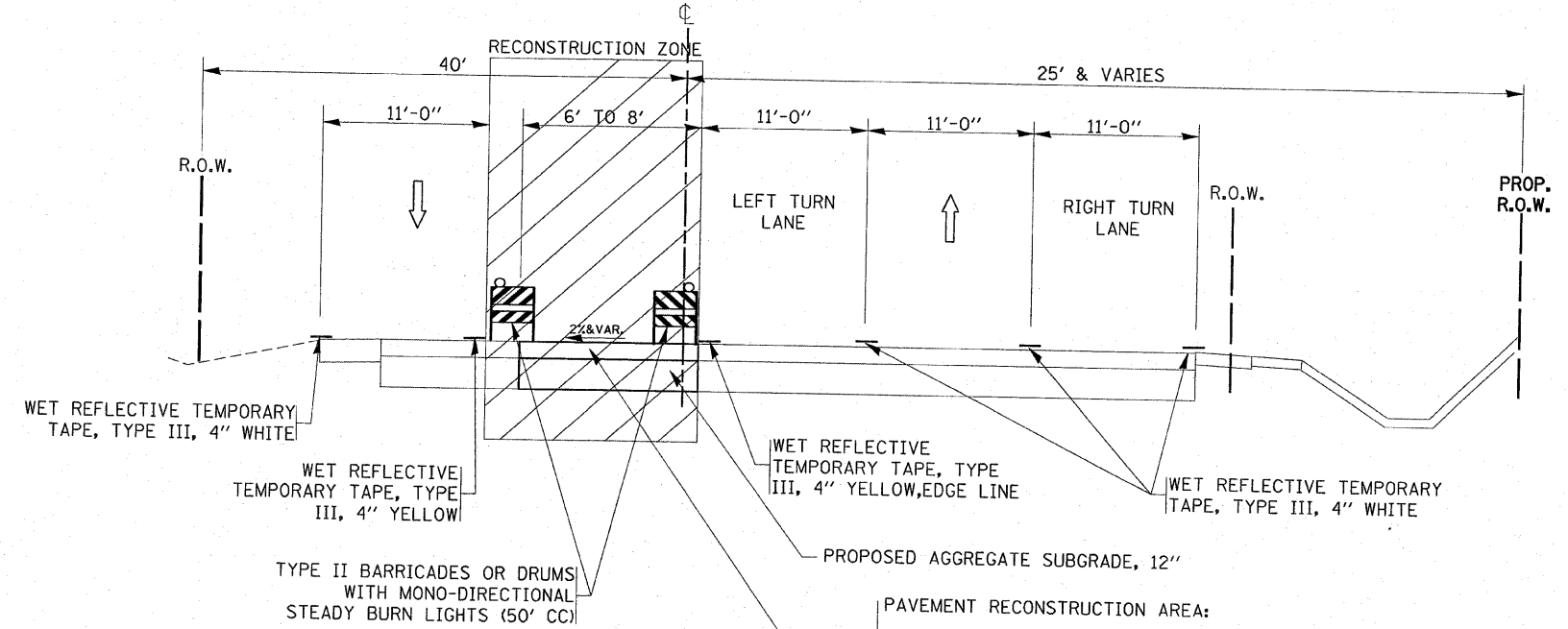

PROPOSED STAGE IIIb
ILL RTE. 129
STA 91+42 TO 105+24.10 (RESURFACING AND WIDENING)

PAVEMENT RECONSTRUCTION AREA:
PROPOSED HOT-MIX ASPHALT BINDER COURSE, IL-19, N70, 11 1/2" (STA 94+12 TO 96+80 AND STA 100+50 TO STA 102+54)

PAVEMENT WIDENING AREA:
PROPOSED HOT-MIX ASPHALT BASE COURSE WIDENING, IL-19, 10 3/4" (STA 91+42 TO STA 94+12) AND STA 102+54 TO STA 105+24.10)

IL. RTE. 129

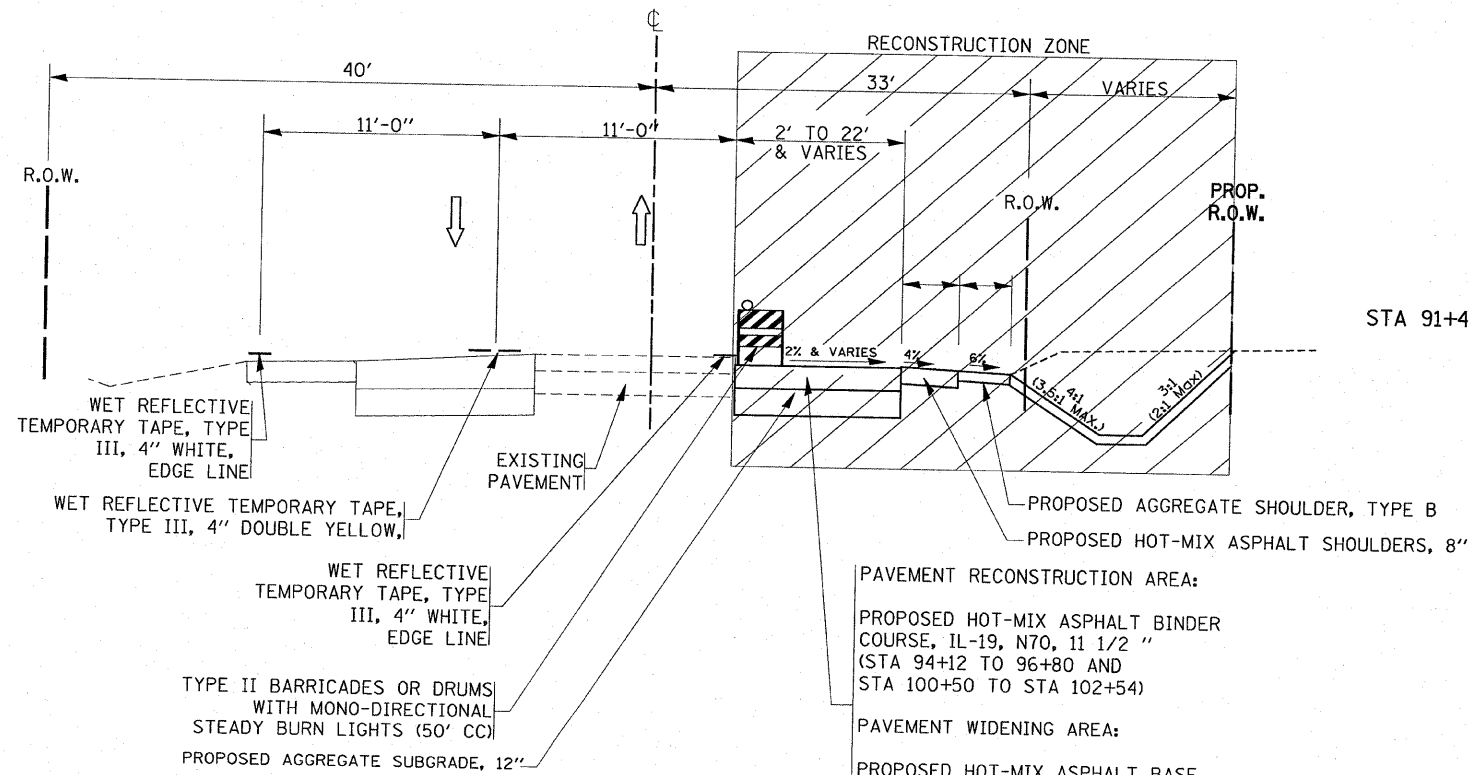

PROPOSED STAGE III
ILL RTE. 129
STA 91+42 TO 105+24.10 (RESURFACING AND WIDENING)

PAVEMENT RECONSTRUCTION AREA:
PROPOSED HOT-MIX ASPHALT BINDER COURSE, IL-19, N70, 11 1/2" (STA 94+12 TO 96+80 AND STA 100+50 TO STA 102+54)

PAVEMENT WIDENING AREA:
PROPOSED HOT-MIX ASPHALT BASE COURSE WIDENING, IL-19, 10 3/4" (STA 91+42 TO STA 94+12) AND STA 102+54 TO STA 105+24.10)

REVISIONS	
NAME	DATE

ILLINOIS DEPARTMENT OF TRANSPORTATION
ILLINOIS 113 AT
ILLINOIS 129 AND ILLINOIS 53
EXISTING AND PROPOSED
STAGE III (a & b)

SCALE: VERT. _____
HORIZ. _____

DATE _____ DRAWN BY _____
CHECKED BY _____

PLOT DATE = 6/28/2007
FILE NAME = \\GIS\113\stage3.a12.dgn
PLOT SCALE = 500000
USER NAME = hmdanah