

F.A.S. RTE.	SECTION	COUNTY	TOTAL SHEETS	SHEET NO.
2320	113X-N	WILL	133	47
STA.		TO STA.		
FED. ROAD DIST. NO.		ILLINOIS FED. AID PROJECT		

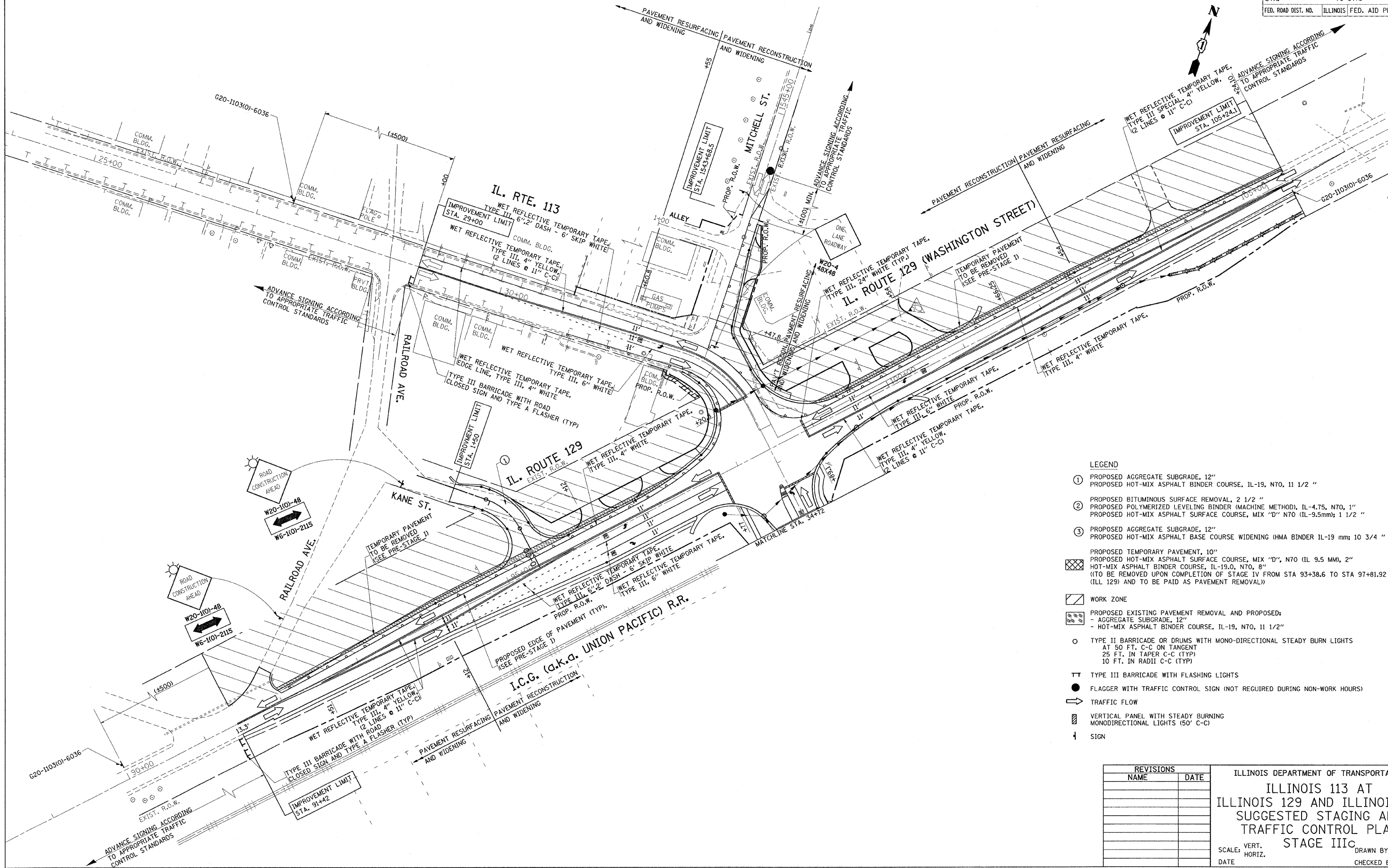

LEGEND

- ① PROPOSED AGGREGATE SUBGRADE, 12"
PROPOSED HOT-MIX ASPHALT BINDER COURSE, IL-19, N70, 11 1/2 "
- ② PROPOSED BITUMINOUS SURFACE REMOVAL, 2 1/2 "
PROPOSED POLYMERIZED LEVELING BINDER (MACHINE METHOD), IL-4.75, N70, 1"
PROPOSED HOT-MIX ASPHALT SURFACE COURSE, MIX "D" N70 (IL-9.5mm); 1 1/2 "
- ③ PROPOSED AGGREGATE SUBGRADE, 12"
PROPOSED HOT-MIX ASPHALT BASE COURSE WIDENING (HMA BINDER IL-19 mm; 10 3/4 "
- ▨ PROPOSED TEMPORARY PAVEMENT, 10"
PROPOSED HOT-MIX ASPHALT SURFACE COURSE, MIX "D", N70 (IL 9.5 MM), 2"
HOT-MIX ASPHALT BINDER COURSE, IL-19.0, N70, 8"
(TO BE REMOVED UPON COMPLETION OF STAGE IV FROM STA 93+38.6 TO STA 97+81.92 (ILL 129) AND TO BE PAID AS PAVEMENT REMOVAL))
- ▨ WORK ZONE
- ▨ PROPOSED EXISTING PAVEMENT REMOVAL AND PROPOSED:
- AGGREGATE SUBGRADE, 12"
- HOT-MIX ASPHALT BINDER COURSE, IL-19, N70, 11 1/2"
- TYPE II BARRICADE OR DRUMS WITH MONO-DIRECTIONAL STEADY BURN LIGHTS
AT 50 FT. C-C ON TANGENT
25 FT. IN TAPER C-C (TYP)
10 FT. IN RADII C-C (TYP)
- TT TYPE III BARRICADE WITH FLASHING LIGHTS
- FLAGGER WITH TRAFFIC CONTROL SIGN (NOT REQUIRED DURING NON-WORK HOURS)
- ➔ TRAFFIC FLOW
- ▨ VERTICAL PANEL WITH STEADY BURNING MONODIRECTIONAL LIGHTS (50' C-C)
- ⊥ SIGN

REVISIONS	
NAME	DATE

ILLINOIS DEPARTMENT OF TRANSPORTATION
**ILLINOIS 113 AT
 ILLINOIS 129 AND ILLINOIS 53
 SUGGESTED STAGING AND
 TRAFFIC CONTROL PLAN
 STAGE IIIc**
 SCALE: VERT. _____
 DATE _____ HORIZ. _____
 DRAWN BY _____
 CHECKED BY _____

PLOT DATE = 6/29/2007
 FILE NAME = c:\p113\stage3\stage3_012.dgn
 PLOT SCALE = 1" = 40'
 USER NAME = hbandaran